

LOCATION DRAWING NEWTON 1-4H

SECTION 4
TOWNSHIP 9 NORTH
RANGE 61 WEST

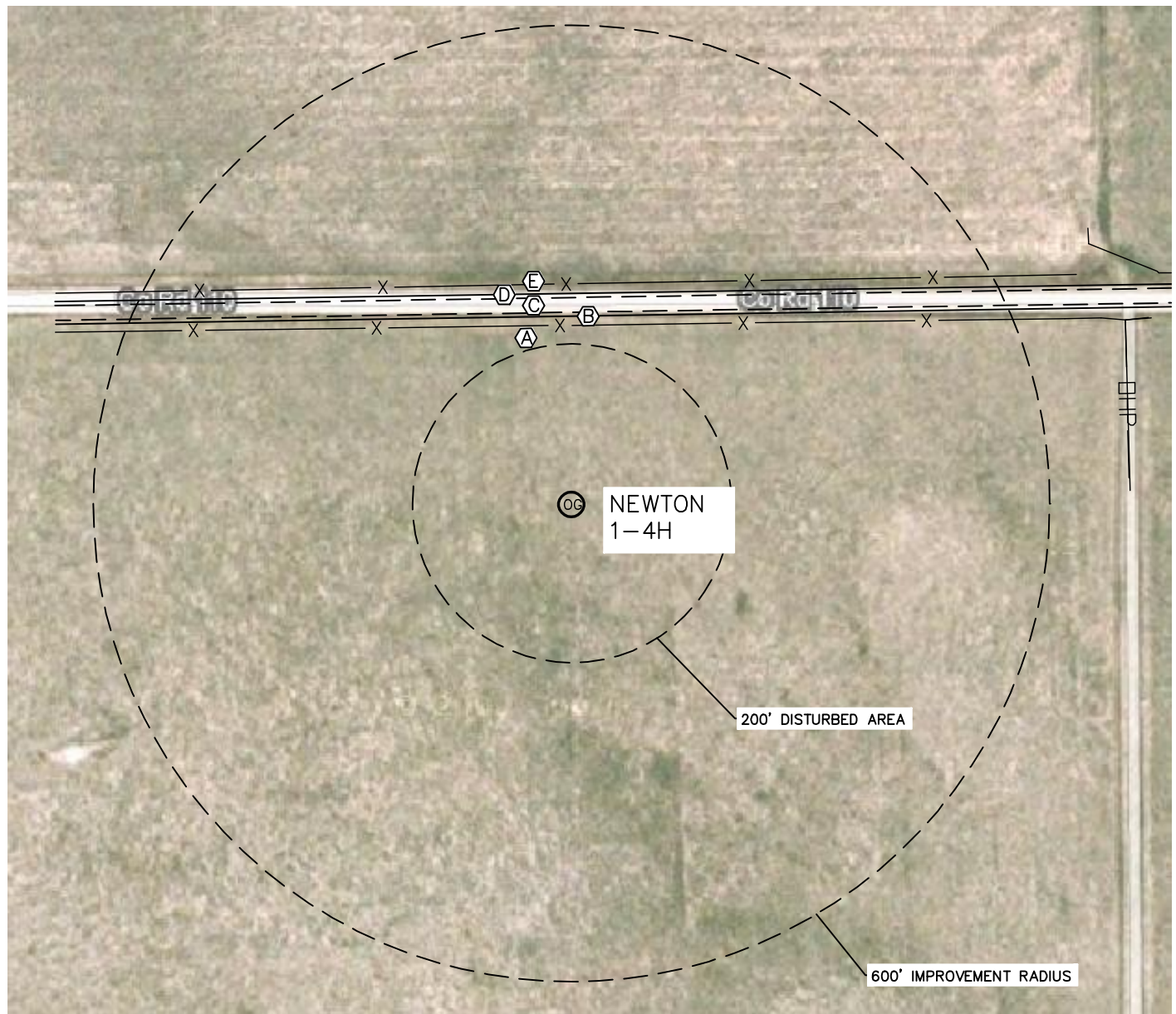

IMPROVEMENTS:

- | | |
|-------------------------------|-------------------------|
| Ⓐ ROW FENCE 225' N | Ⓓ ROADSIDE DITCH 264' N |
| Ⓑ ROADSIDE DITCH 236' N | Ⓔ ROW FENCE 277' N |
| Ⓒ WELD COUNTY ROAD 110 250' N | |

NEAREST: BUILDING 5280'+, PUBLIC ROAD 250' N, ABOVE GROUND UTILITY 700' E,
RAILROAD 5280'+, PROPERTY LINE 250' N

NOTE

The size, type and location of underground utilities shown hereon are approximate, and are based on markings made by utility locate companies. It is not guaranteed that all utilities have been located. It shall be the responsibility of the contractor to verify the existence of all underground utilities in the area of the work before commencing new construction.

