

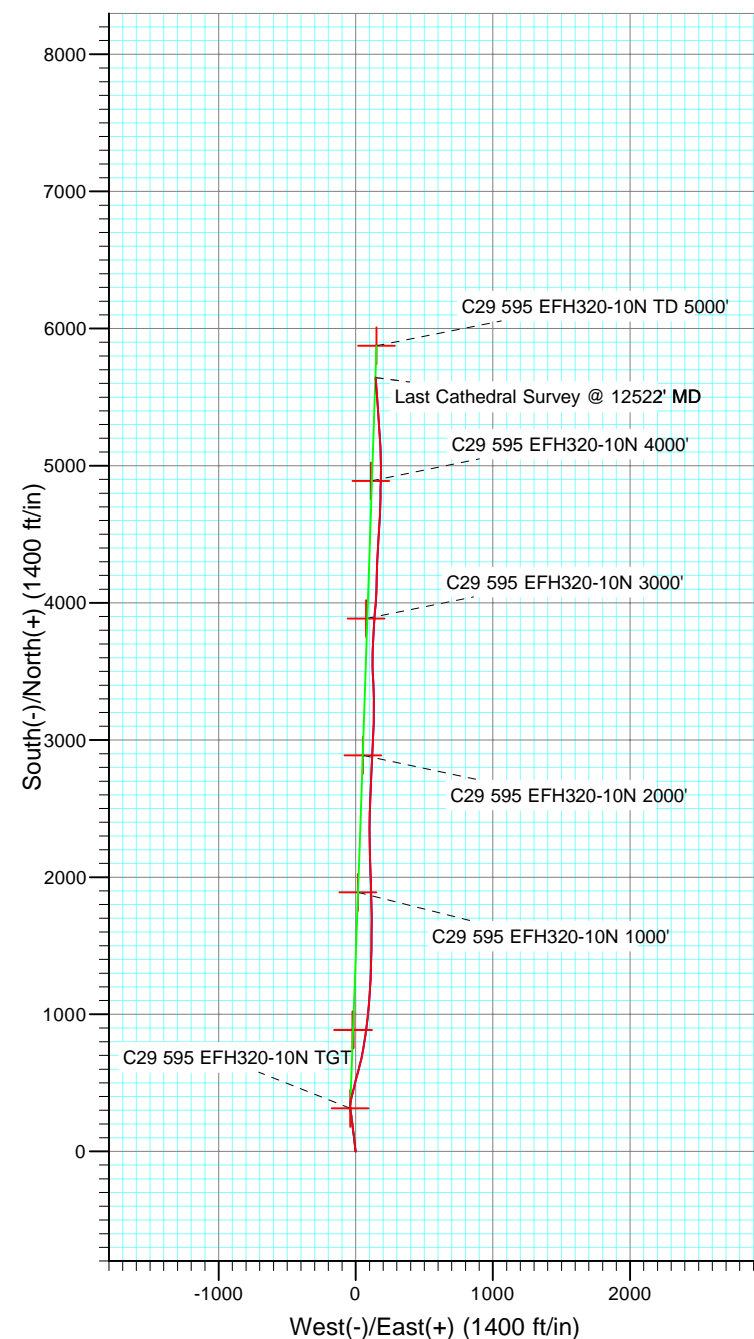

Project: North Piceance
Site: C29 595 (NENW Sec29-T5S-R95W)
Well: N.P EFH320-10N C29 595
Wellbore: DD
Design: Final

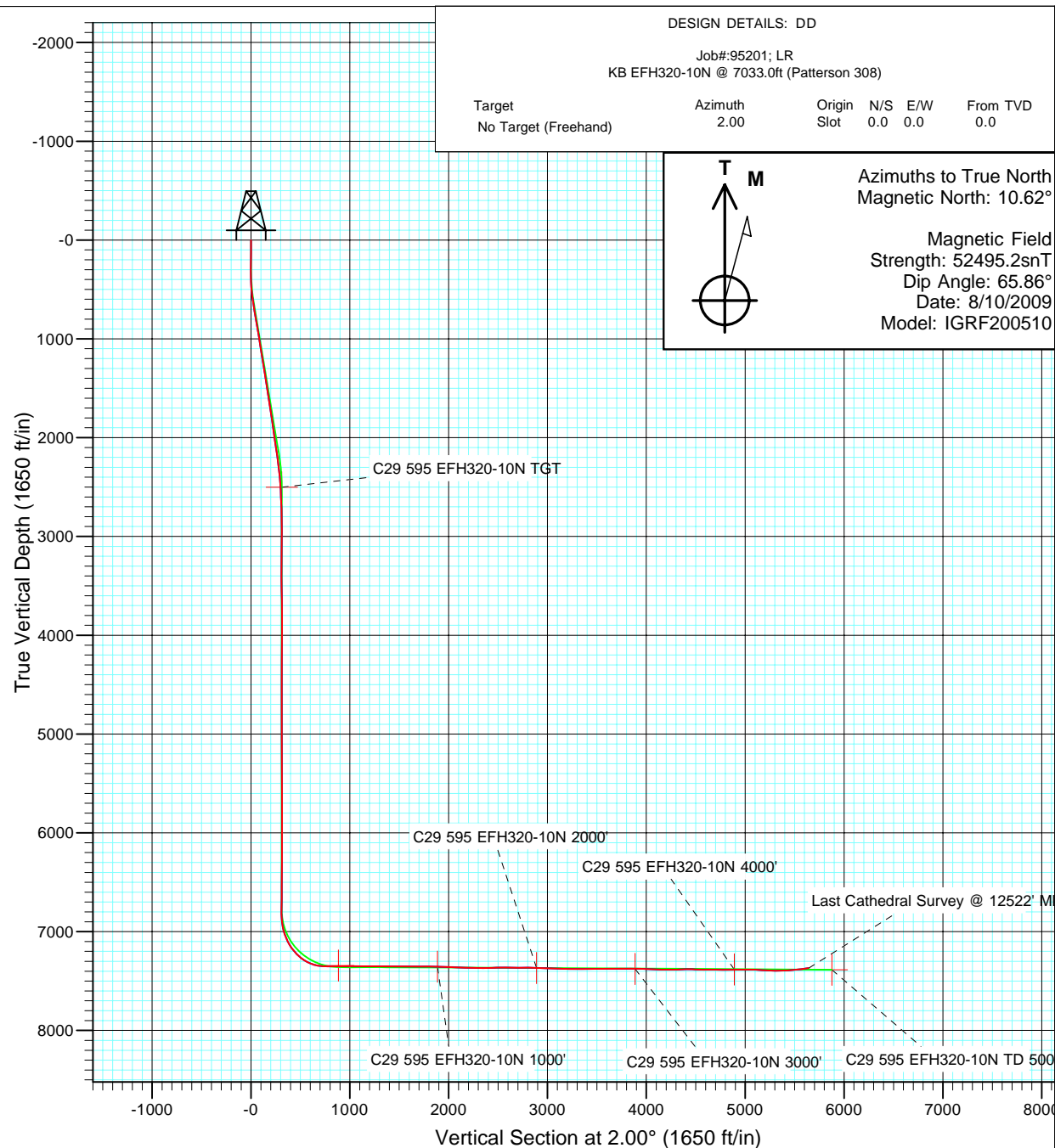

Directional Plus

Survey Report

Company:	EnCana Oil & Gas (USA) Inc	Local Co-ordinate Reference:	Well N.P EFH320-10N C29 595
Project:	North Piceance	TVD Reference:	KB EFH320-10N @ 7033.0ft (Patterson 308)
Site:	C29 595 (NENW Sec29-T5S-R95W)	MD Reference:	KB EFH320-10N @ 7033.0ft (Patterson 308)
Well:	N.P EFH320-10N C29 595	North Reference:	True
Wellbore:	DD	Survey Calculation Method:	Minimum Curvature
Design:	DD	Database:	EDM 2003.21 US Multi User Db

Project	North Piceance		
Map System:	US State Plane 1983	System Datum:	Mean Sea Level
Geo Datum:	North American Datum 1983		
Map Zone:	Colorado Central Zone		

Site		C29 595 (NENW Sec29-T5S-R95W)			
Site Position:		Northing:	1,650,184.70 ft	Latitude:	39° 35' 24.74 N
From:	Lat/Long	Easting:	2,273,122.40 ft	Longitude:	108° 4' 46.43 W
Position Uncertainty:	0.0 ft	Slot Radius:	in	Grid Convergence:	-1.63 °

Well	N.P EFH320-10N C29 595					
Well Position	+N/-S	0.0 ft	Northing:	1,650,195.64 ft	Latitude:	39° 35' 24.84 N
	+E/-W	0.0 ft	Easting:	2,273,088.28 ft	Longitude:	108° 4' 46.87 W
Position Uncertainty		0.0 ft	Wellhead Elevation:	ft	Ground Level:	7,010.0 ft

Wellbore	DD				
Magnetics	Model Name	Sample Date	Declination (°)	Dip Angle (°)	Field Strength (nT)
	IGRF200510	8/10/2009	10.62	65.86	52,495

Design	DD				
Audit Notes:					
Version:	1.0	Phase:	ACTUAL	Tie On Depth:	0.0
Vertical Section:	Depth From (TVD)	+N/-S	+E/-W	Direction	
	(ft)	(ft)	(ft)	(°)	
	0.0	0.0	0.0	2.00	

Survey Program	Date	12/1/2009			
From (ft)	To (ft)	Survey (Wellbore)	Tool Name	Description	
238.0	12,522.0	Survey #1 (DD)	MWD	Geolink MWD	

Survey										
Measured Depth (ft)	Inclination (°)	Azimuth (°)	Vertical Depth (ft)	+N/-S (ft)	+E/-W (ft)	Vertical Section (ft)	Dogleg Rate (°/100ft)	Build Rate (°/100ft)	Formations / Comments	
0.0	0.00	0.00	0.0	0.0	0.0	0.0	0.00	0.00		
238.0	0.50	196.20	238.0	-1.0	-0.3	-1.0	0.21	0.21		
268.0	0.50	187.00	268.0	-1.3	-0.3	-1.3	0.27	0.00		
299.0	0.30	224.50	299.0	-1.4	-0.4	-1.5	1.03	-0.65		
330.0	0.30	280.60	330.0	-1.5	-0.6	-1.5	0.91	0.00		
360.0	0.90	327.20	360.0	-1.3	-0.8	-1.3	2.42	2.00		
391.0	1.50	341.30	391.0	-0.7	-1.0	-0.7	2.14	1.94		
422.0	2.30	349.60	422.0	0.3	-1.3	0.3	2.72	2.58		
453.0	3.40	352.30	452.9	1.8	-1.5	1.8	3.57	3.55		
483.0	4.40	353.60	482.9	3.9	-1.7	3.8	3.35	3.33		
514.0	5.80	353.30	513.7	6.6	-2.1	6.5	4.52	4.52		
544.0	6.70	355.70	543.6	9.8	-2.4	9.8	3.12	3.00		
575.0	7.60	355.20	574.3	13.7	-2.7	13.6	2.91	2.90		

Directional Plus

Survey Report

Company:	EnCana Oil & Gas (USA) Inc	Local Co-ordinate Reference:	Well N.P EFH320-10N C29 595
Project:	North Piceance	TVD Reference:	KB EFH320-10N @ 7033.0ft (Patterson 308)
Site:	C29 595 (NENW Sec29-T5S-R95W)	MD Reference:	KB EFH320-10N @ 7033.0ft (Patterson 308)
Well:	N.P EFH320-10N C29 595	North Reference:	True
Wellbore:	DD	Survey Calculation Method:	Minimum Curvature
Design:	DD	Database:	EDM 2003.21 US Multi User Db

Survey									
Measured Depth (ft)	Inclination (°)	Azimuth (°)	Vertical Depth (ft)	+N/-S (ft)	+E/-W (ft)	Vertical Section (ft)	Dogleg Rate (°/100ft)	Build Rate (°/100ft)	Formations / Comments
670.0	9.40	351.40	668.3	27.6	-4.4	27.5	1.98	1.89	
761.0	9.30	349.50	758.1	42.2	-6.8	41.9	0.36	-0.11	
853.0	10.00	351.70	848.8	57.4	-9.3	57.1	0.86	0.76	
945.0	9.80	356.10	939.4	73.1	-11.0	72.7	0.85	-0.22	
1,036.0	9.60	355.90	1,029.1	88.4	-12.1	88.0	0.22	-0.22	
1,128.0	9.00	355.20	1,119.9	103.2	-13.2	102.7	0.66	-0.65	
1,220.0	9.10	354.90	1,210.7	117.7	-14.5	117.1	0.12	0.11	
1,311.0	9.10	351.40	1,300.6	131.9	-16.2	131.3	0.61	0.00	
1,403.0	9.10	351.80	1,391.4	146.3	-18.3	145.6	0.07	0.00	
1,495.0	9.40	353.40	1,482.2	161.0	-20.2	160.2	0.43	0.33	
1,587.0	9.10	353.00	1,573.0	175.7	-22.0	174.8	0.33	-0.33	
1,678.0	9.00	351.70	1,662.9	189.9	-23.9	188.9	0.25	-0.11	
1,762.0	8.40	352.40	1,745.9	202.5	-25.6	201.4	0.73	-0.71	
1,862.0	7.80	351.80	1,844.9	216.4	-27.6	215.3	0.61	-0.60	
1,954.0	8.30	352.20	1,936.0	229.2	-29.4	228.0	0.55	0.54	
2,045.0	8.50	354.40	2,026.1	242.4	-30.9	241.2	0.42	0.22	
2,070.0	8.60	354.40	2,050.8	246.1	-31.3	244.8	0.40	0.40	
2,166.0	9.10	353.70	2,145.6	260.8	-32.8	259.5	0.53	0.52	
2,258.0	7.40	349.60	2,236.7	273.8	-34.7	272.4	1.95	-1.85	
2,350.0	7.20	349.20	2,327.9	285.3	-36.8	283.9	0.22	-0.22	
2,441.0	4.90	352.30	2,418.4	294.8	-38.4	293.2	2.55	-2.53	
2,533.0	2.90	356.20	2,510.2	301.0	-39.1	299.4	2.19	-2.17	
2,625.0	2.50	357.40	2,602.1	305.3	-39.3	303.8	0.44	-0.43	
2,716.0	2.70	355.10	2,693.0	309.4	-39.6	307.9	0.25	0.22	
2,808.0	1.10	318.20	2,785.0	312.2	-40.4	310.6	2.10	-1.74	
2,900.0	1.20	320.30	2,876.9	313.6	-41.6	312.0	0.12	0.11	
2,992.0	0.60	166.40	2,968.9	313.9	-42.1	312.3	1.91	-0.65	
3,083.0	0.60	157.60	3,059.9	313.0	-41.8	311.4	0.10	0.00	
3,175.0	0.50	151.80	3,151.9	312.2	-41.4	310.6	0.12	-0.11	
3,267.0	0.60	165.20	3,243.9	311.4	-41.1	309.8	0.18	0.11	
3,358.0	0.60	155.40	3,334.9	310.5	-40.8	308.9	0.11	0.00	
3,450.0	0.70	38.70	3,426.9	310.5	-40.2	308.9	1.20	0.11	
3,542.0	0.90	22.90	3,518.9	311.6	-39.6	310.0	0.32	0.22	
3,633.0	0.70	11.90	3,609.9	312.8	-39.2	311.3	0.28	-0.22	
3,725.0	0.70	11.10	3,701.9	313.9	-39.0	312.4	0.01	0.00	
3,817.0	0.60	15.00	3,793.9	314.9	-38.8	313.4	0.12	-0.11	
3,908.0	0.40	253.00	3,884.9	315.3	-38.9	313.7	0.97	-0.22	
4,000.0	0.50	243.00	3,976.9	315.0	-39.6	313.4	0.14	0.11	
4,091.0	0.40	234.40	4,067.9	314.7	-40.2	313.1	0.13	-0.11	
4,183.0	0.50	237.90	4,159.9	314.3	-40.8	312.6	0.11	0.11	
4,275.0	0.40	229.80	4,251.9	313.8	-41.4	312.2	0.13	-0.11	
4,367.0	0.30	253.20	4,343.9	313.6	-41.9	311.9	0.19	-0.11	
4,458.0	0.20	261.50	4,434.9	313.5	-42.3	311.8	0.12	-0.11	
4,550.0	0.30	265.10	4,526.9	313.4	-42.7	311.7	0.11	0.11	
4,641.0	0.10	301.40	4,617.9	313.4	-43.0	311.8	0.25	-0.22	
4,733.0	0.20	313.80	4,709.9	313.6	-43.1	311.9	0.11	0.11	
4,825.0	0.20	302.20	4,801.9	313.8	-43.4	312.1	0.04	0.00	
4,917.0	0.40	292.00	4,893.9	314.0	-43.8	312.3	0.22	0.22	
5,008.0	0.50	268.60	4,984.9	314.1	-44.5	312.4	0.23	0.11	
5,100.0	0.60	260.80	5,076.9	314.0	-45.4	312.2	0.14	0.11	
5,192.0	0.90	268.60	5,168.9	313.9	-46.6	312.1	0.34	0.33	
5,283.0	0.60	297.10	5,259.8	314.1	-47.7	312.3	0.52	-0.33	
5,375.0	0.90	91.50	5,351.8	314.3	-47.4	312.5	1.59	0.33	

Directional Plus

Survey Report

Company:	EnCana Oil & Gas (USA) Inc	Local Co-ordinate Reference:	Well N.P EFH320-10N C29 595
Project:	North Piceance	TVD Reference:	KB EFH320-10N @ 7033.0ft (Patterson 308)
Site:	C29 595 (NENW Sec29-T5S-R95W)	MD Reference:	KB EFH320-10N @ 7033.0ft (Patterson 308)
Well:	N.P EFH320-10N C29 595	North Reference:	True
Wellbore:	DD	Survey Calculation Method:	Minimum Curvature
Design:	DD	Database:	EDM 2003.21 US Multi User Db

Survey									
Measured Depth (ft)	Inclination (°)	Azimuth (°)	Vertical Depth (ft)	+N/-S (ft)	+E/-W (ft)	Vertical Section (ft)	Dogleg Rate (°/100ft)	Build Rate (°/100ft)	Formations / Comments
5,467.0	0.90	90.20	5,443.8	314.3	-46.0	312.5	0.02	0.00	
5,558.0	0.70	79.80	5,534.8	314.4	-44.7	312.6	0.27	-0.22	
5,650.0	1.00	85.40	5,626.8	314.6	-43.4	312.9	0.34	0.33	
5,742.0	1.00	85.50	5,718.8	314.7	-41.8	313.0	0.00	0.00	
5,834.0	0.80	85.70	5,810.8	314.8	-40.3	313.2	0.22	-0.22	
5,925.0	0.80	86.20	5,901.8	314.9	-39.1	313.3	0.01	0.00	
6,017.0	0.80	85.90	5,993.8	315.0	-37.8	313.5	0.00	0.00	
6,109.0	0.70	258.10	6,085.8	314.9	-37.7	313.4	1.63	-0.11	
6,200.0	1.00	260.90	6,176.8	314.7	-39.0	313.1	0.33	0.33	
6,292.0	1.10	263.50	6,268.7	314.4	-40.7	312.8	0.12	0.11	
6,384.0	1.10	253.50	6,360.7	314.1	-42.4	312.4	0.21	0.00	
6,476.0	0.40	216.00	6,452.7	313.6	-43.5	311.9	0.89	-0.76	
6,567.0	0.40	192.00	6,543.7	313.0	-43.7	311.3	0.18	0.00	
6,685.0	0.40	219.00	6,661.7	312.3	-44.1	310.6	0.16	0.00	
6,780.0	1.10	191.90	6,756.7	311.1	-44.5	309.4	0.81	0.74	
6,810.0	1.80	197.10	6,786.7	310.4	-44.7	308.7	2.37	2.33	
6,840.0	0.60	124.70	6,816.7	309.9	-44.7	308.1	5.72	-4.00	
6,851.0	1.20	47.30	6,827.7	309.9	-44.5	308.2	11.08	5.45	
6,881.0	3.90	18.60	6,857.7	311.1	-44.0	309.4	9.68	9.00	
6,911.0	6.30	12.20	6,887.5	313.7	-43.3	312.0	8.21	8.00	
6,942.0	8.70	9.00	6,918.3	317.7	-42.6	316.0	7.86	7.74	
6,972.0	11.00	5.70	6,947.8	322.7	-41.9	321.1	7.89	7.67	
6,987.0	12.10	4.40	6,962.5	325.7	-41.7	324.1	7.54	7.33	
7,032.0	16.10	4.30	7,006.2	336.7	-40.8	335.0	8.89	8.89	
7,062.0	19.60	5.90	7,034.7	345.8	-40.0	344.2	11.78	11.67	
7,092.0	22.80	7.60	7,062.7	356.6	-38.7	355.0	10.86	10.67	
7,123.0	26.10	10.50	7,090.9	369.2	-36.7	367.7	11.32	10.65	
7,153.0	29.50	12.60	7,117.4	383.0	-33.9	381.5	11.79	11.33	
7,183.0	33.00	14.20	7,143.1	398.1	-30.3	396.8	11.99	11.67	
7,214.0	36.70	14.00	7,168.5	415.3	-25.9	414.1	11.94	11.94	
7,244.0	39.30	14.60	7,192.1	433.2	-21.4	432.1	8.75	8.67	
7,269.0	42.00	14.70	7,211.1	448.9	-17.3	448.0	10.80	10.80	
7,284.0	43.90	14.60	7,222.1	458.8	-14.7	458.0	12.67	12.67	
7,305.0	46.80	14.00	7,236.8	473.3	-11.0	472.6	13.96	13.81	
7,335.0	50.50	14.00	7,256.7	495.1	-5.5	494.6	12.33	12.33	
7,365.0	54.50	14.40	7,274.9	518.2	0.3	517.9	13.38	13.33	
7,396.0	58.80	15.20	7,292.0	543.2	6.9	543.1	14.04	13.87	
7,426.0	63.10	15.10	7,306.5	568.5	13.8	568.7	14.34	14.33	
7,456.0	67.10	15.50	7,319.1	594.8	20.9	595.1	13.39	13.33	
7,487.0	71.40	14.00	7,330.1	622.8	28.3	623.4	14.59	13.87	
7,517.0	76.30	13.20	7,338.5	650.8	35.1	651.6	16.53	16.33	
7,532.0	78.50	12.60	7,341.7	665.1	38.4	666.0	15.18	14.67	
7,547.0	80.90	11.70	7,344.4	679.5	41.5	680.5	17.05	16.00	
7,568.0	84.00	10.40	7,347.2	699.9	45.5	701.1	15.99	14.76	
7,599.0	87.80	9.60	7,349.4	730.4	50.8	731.7	12.53	12.26	
7,629.0	89.00	10.10	7,350.2	759.9	56.0	761.4	4.33	4.00	
7,660.0	90.10	9.10	7,350.5	790.5	61.1	792.1	4.80	3.55	
7,691.0	90.40	8.70	7,350.3	821.1	65.9	822.9	1.61	0.97	
7,722.0	90.90	8.10	7,350.0	851.8	70.4	853.7	2.52	1.61	
7,752.0	90.30	7.70	7,349.7	881.5	74.6	883.5	2.40	-2.00	
7,782.0	89.80	7.60	7,349.7	911.2	78.6	913.4	1.70	-1.67	
7,814.0	90.20	7.50	7,349.7	942.9	82.8	945.3	1.29	1.25	
7,844.0	89.80	6.70	7,349.7	972.7	86.5	975.1	2.98	-1.33	

Directional Plus

Survey Report

Company:	EnCana Oil & Gas (USA) Inc	Local Co-ordinate Reference:	Well N.P EFH320-10N C29 595
Project:	North Piceance	TVD Reference:	KB EFH320-10N @ 7033.0ft (Patterson 308)
Site:	C29 595 (NENW Sec29-T5S-R95W)	MD Reference:	KB EFH320-10N @ 7033.0ft (Patterson 308)
Well:	N.P EFH320-10N C29 595	North Reference:	True
Wellbore:	DD	Survey Calculation Method:	Minimum Curvature
Design:	DD	Database:	EDM 2003.21 US Multi User Db

Survey									
Measured Depth (ft)	Inclination (°)	Azimuth (°)	Vertical Depth (ft)	+N/-S (ft)	+E/-W (ft)	Vertical Section (ft)	Dogleg Rate (°/100ft)	Build Rate (°/100ft)	Formations / Comments
7,874.0	90.10	5.80	7,349.7	1,002.5	89.7	1,005.0	3.16	1.00	
7,904.0	89.90	5.30	7,349.7	1,032.4	92.6	1,035.0	1.80	-0.67	
7,936.0	90.40	5.10	7,349.6	1,064.3	95.5	1,066.9	1.68	1.56	
7,966.0	89.90	4.50	7,349.5	1,094.1	98.1	1,096.9	2.60	-1.67	
8,028.0	90.40	4.50	7,349.4	1,156.0	102.9	1,158.8	0.81	0.81	
8,088.0	90.10	3.20	7,349.1	1,215.8	106.9	1,218.8	2.22	-0.50	
8,150.0	90.20	1.70	7,348.9	1,277.8	109.6	1,280.8	2.42	0.16	
8,212.0	88.80	0.30	7,349.5	1,339.7	110.7	1,342.8	3.19	-2.26	
8,273.0	88.80	1.00	7,350.7	1,400.7	111.4	1,403.8	1.15	0.00	
8,304.0	89.30	0.40	7,351.3	1,431.7	111.7	1,434.8	2.52	1.61	
8,396.0	89.70	1.00	7,352.1	1,523.7	112.9	1,526.7	0.78	0.43	
8,457.0	89.80	1.00	7,352.3	1,584.7	113.9	1,587.7	0.16	0.16	
8,518.0	89.40	0.70	7,352.8	1,645.7	114.8	1,648.7	0.82	-0.66	
8,579.0	90.20	359.00	7,353.0	1,706.7	114.7	1,709.7	3.08	1.31	
8,609.0	90.80	358.80	7,352.7	1,736.7	114.1	1,739.6	2.11	2.00	
8,639.0	89.80	359.50	7,352.5	1,766.7	113.7	1,769.6	4.07	-3.33	
8,671.0	89.20	0.10	7,352.8	1,798.7	113.6	1,801.5	2.65	-1.87	
8,701.0	88.20	0.00	7,353.5	1,828.7	113.6	1,831.5	3.35	-3.33	
8,731.0	88.90	0.00	7,354.3	1,858.7	113.6	1,861.5	2.33	2.33	
8,763.0	88.50	359.30	7,355.0	1,890.7	113.4	1,893.5	2.52	-1.25	
8,811.0	88.20	358.30	7,356.4	1,938.6	112.4	1,941.4	2.17	-0.62	
8,857.0	88.00	357.70	7,357.9	1,984.6	110.8	1,987.2	1.37	-0.43	
8,902.0	87.80	356.90	7,359.6	2,029.5	108.7	2,032.0	1.83	-0.44	
8,947.0	87.20	357.70	7,361.5	2,074.4	106.5	2,076.8	2.22	-1.33	
8,993.0	87.80	358.00	7,363.5	2,120.3	104.8	2,122.7	1.46	1.30	
9,038.0	88.40	358.20	7,365.0	2,165.3	103.3	2,167.6	1.41	1.33	
9,084.0	88.90	358.20	7,366.1	2,211.2	101.9	2,213.4	1.09	1.09	
9,129.0	89.30	358.90	7,366.8	2,256.2	100.7	2,258.4	1.79	0.89	
9,174.0	89.40	358.80	7,367.3	2,301.2	99.8	2,303.3	0.31	0.22	
9,220.0	90.30	359.90	7,367.4	2,347.2	99.3	2,349.2	3.09	1.96	
9,252.0	91.30	0.70	7,367.0	2,379.2	99.5	2,381.2	4.00	3.12	
9,282.0	91.90	1.60	7,366.1	2,409.2	100.1	2,411.2	3.60	2.00	
9,311.0	92.20	1.40	7,365.1	2,438.1	100.8	2,440.2	1.24	1.03	
9,341.0	91.40	2.30	7,364.2	2,468.1	101.8	2,470.2	4.01	-2.67	
9,371.0	89.80	2.80	7,363.9	2,498.1	103.1	2,500.2	5.59	-5.33	
9,401.0	89.50	2.50	7,364.0	2,528.0	104.5	2,530.2	1.41	-1.00	
9,431.0	89.60	2.60	7,364.3	2,558.0	105.9	2,560.2	0.47	0.33	
9,461.0	90.00	2.70	7,364.4	2,588.0	107.3	2,590.2	1.37	1.33	
9,492.0	89.90	1.70	7,364.4	2,619.0	108.4	2,621.1	3.24	-0.32	
9,538.0	89.30	2.40	7,364.7	2,664.9	110.1	2,667.1	2.00	-1.30	
9,583.0	89.80	2.30	7,365.1	2,709.9	111.9	2,712.1	1.13	1.11	
9,632.0	90.30	1.70	7,365.0	2,758.9	113.6	2,761.1	1.59	1.02	
9,674.0	89.80	2.80	7,365.0	2,800.8	115.3	2,803.1	2.88	-1.19	
9,719.0	88.80	3.30	7,365.6	2,845.8	117.7	2,848.1	2.48	-2.22	
9,764.0	88.10	2.70	7,366.8	2,890.7	120.0	2,893.1	2.05	-1.56	
9,810.0	88.20	3.40	7,368.3	2,936.6	122.5	2,939.1	1.54	0.22	
9,855.0	87.60	3.50	7,369.9	2,981.5	125.2	2,984.0	1.35	-1.33	
9,900.0	87.60	3.10	7,371.8	3,026.4	127.8	3,029.0	0.89	0.00	
9,946.0	88.40	2.40	7,373.4	3,072.3	130.0	3,074.9	2.31	1.74	
9,991.0	88.20	1.70	7,374.7	3,117.2	131.6	3,119.9	1.62	-0.44	
10,037.0	88.90	0.80	7,375.9	3,163.2	132.6	3,165.9	2.48	1.52	
10,082.0	89.70	0.20	7,376.4	3,208.2	133.0	3,210.9	2.22	1.78	
10,128.0	89.70	359.60	7,376.7	3,254.2	132.9	3,256.9	1.30	0.00	

Directional Plus

Survey Report

Company: EnCana Oil & Gas (USA) Inc
Project: North Piceance
Site: C29 595 (NENW Sec29-T5S-R95W)
Well: N.P EFH320-10N C29 595
Wellbore: DD
Design: DD

Local Co-ordinate Reference: Well N.P EFH320-10N C29 595
TVD Reference: KB EFH320-10N @ 7033.0ft (Patterson 308)
MD Reference: KB EFH320-10N @ 7033.0ft (Patterson 308)
North Reference: True
Survey Calculation Method: Minimum Curvature
Database: EDM 2003.21 US Multi User Db

Survey

Measured Depth (ft)	Inclination (°)	Azimuth (°)	Vertical Depth (ft)	+N/-S (ft)	+E/-W (ft)	Vertical Section (ft)	Dogleg Rate (°/100ft)	Build Rate (°/100ft)	Formations / Comments
10,173.0	89.60	358.30	7,377.0	3,299.2	132.1	3,301.8	2.90	-0.22	
10,218.0	89.70	357.00	7,377.2	3,344.2	130.2	3,346.7	2.90	0.22	
10,264.0	90.00	357.30	7,377.4	3,390.1	128.0	3,392.5	0.92	0.65	
10,309.0	90.30	357.30	7,377.2	3,435.0	125.8	3,437.3	0.67	0.67	
10,354.0	91.00	358.10	7,376.7	3,480.0	124.0	3,482.2	2.36	1.56	
10,400.0	90.80	359.50	7,376.0	3,526.0	123.1	3,528.1	3.07	-0.43	
10,445.0	90.70	0.20	7,375.4	3,571.0	122.9	3,573.1	1.57	-0.22	
10,490.0	90.50	0.30	7,374.9	3,616.0	123.1	3,618.1	0.50	-0.44	
10,536.0	90.60	0.80	7,374.5	3,662.0	123.6	3,664.1	1.11	0.22	
10,581.0	90.60	2.90	7,374.0	3,706.9	125.0	3,709.1	4.67	0.00	
10,626.0	89.70	3.50	7,373.9	3,751.9	127.5	3,754.0	2.40	-2.00	
10,672.0	90.00	4.10	7,374.0	3,797.8	130.6	3,800.0	1.46	0.65	
10,717.0	89.70	4.00	7,374.1	3,842.7	133.8	3,845.0	0.70	-0.67	
10,763.0	88.50	3.80	7,374.9	3,888.5	136.9	3,891.0	2.64	-2.61	
10,808.0	87.80	4.00	7,376.3	3,933.4	140.0	3,935.9	1.62	-1.56	
10,853.0	87.90	4.40	7,378.0	3,978.3	143.3	3,980.8	0.92	0.22	
10,889.0	88.10	3.90	7,379.3	4,014.2	145.9	4,016.8	1.50	0.56	
10,938.0	88.10	3.80	7,380.9	4,063.0	149.1	4,065.7	0.20	0.00	
10,998.0	88.20	2.20	7,382.8	4,122.9	152.3	4,125.7	2.67	0.17	
11,029.0	88.50	0.70	7,383.7	4,153.9	153.1	4,156.7	4.93	0.97	
11,060.0	88.80	0.50	7,384.5	4,184.9	153.4	4,187.7	1.16	0.97	
11,121.0	90.50	0.60	7,384.8	4,245.9	154.0	4,248.6	2.79	2.79	
11,152.0	91.30	2.00	7,384.3	4,276.8	154.7	4,279.6	5.20	2.58	
11,183.0	92.50	3.00	7,383.3	4,307.8	156.0	4,310.6	5.04	3.87	
11,213.0	91.60	3.80	7,382.2	4,337.7	157.8	4,340.6	4.01	-3.00	
11,244.0	91.40	4.00	7,381.4	4,368.6	159.9	4,371.6	0.91	-0.65	
11,278.0	91.30	3.70	7,380.6	4,402.6	162.2	4,405.5	0.93	-0.29	
11,305.0	90.50	3.60	7,380.2	4,429.5	163.9	4,432.5	2.99	-2.96	
11,336.0	88.70	3.60	7,380.4	4,460.4	165.9	4,463.5	5.81	-5.81	
11,367.0	87.10	3.70	7,381.6	4,491.4	167.8	4,494.5	5.17	-5.16	
11,397.0	87.30	2.60	7,383.0	4,521.3	169.5	4,524.4	3.72	0.67	
11,428.0	87.60	2.30	7,384.4	4,552.2	170.8	4,555.4	1.37	0.97	
11,459.0	90.20	4.00	7,385.0	4,583.2	172.5	4,586.4	10.02	8.39	
11,489.0	90.50	2.90	7,384.8	4,613.1	174.3	4,616.4	3.80	1.00	
11,520.0	91.70	4.50	7,384.2	4,644.0	176.3	4,647.4	6.45	3.87	
11,568.0	88.70	1.70	7,384.0	4,691.9	178.9	4,695.3	8.55	-6.25	
11,614.0	89.20	0.40	7,384.9	4,737.9	179.8	4,741.3	3.03	1.09	
11,644.0	88.40	0.40	7,385.5	4,767.9	180.0	4,771.3	2.67	-2.67	
11,705.0	90.30	0.90	7,386.2	4,828.9	180.7	4,832.3	3.22	3.11	
11,757.0	89.50	1.40	7,386.3	4,880.9	181.7	4,884.3	1.81	-1.54	
11,787.0	91.00	1.40	7,386.2	4,910.9	182.4	4,914.3	5.00	5.00	
11,817.0	93.00	1.30	7,385.1	4,940.9	183.1	4,944.2	6.67	6.67	
11,841.0	92.20	0.50	7,384.0	4,964.8	183.5	4,968.2	4.71	-3.33	
11,886.0	90.00	358.50	7,383.2	5,009.8	183.1	5,013.2	6.61	-4.89	
11,932.0	90.00	359.80	7,383.2	5,055.8	182.4	5,059.1	2.83	0.00	
11,977.0	86.70	356.70	7,384.5	5,100.8	181.1	5,104.0	10.06	-7.33	
12,022.0	85.70	356.70	7,387.4	5,145.6	178.5	5,148.7	2.22	-2.22	
12,068.0	87.00	357.60	7,390.4	5,191.4	176.2	5,194.4	3.43	2.83	
12,113.0	86.50	356.90	7,392.9	5,236.3	174.0	5,239.2	1.91	-1.11	
12,159.0	87.90	356.20	7,395.2	5,282.2	171.3	5,284.9	3.40	3.04	
12,204.0	89.70	355.20	7,396.1	5,327.0	167.9	5,329.6	4.58	4.00	
12,249.0	91.30	355.20	7,395.7	5,371.9	164.1	5,374.3	3.56	3.56	
12,295.0	94.10	355.90	7,393.6	5,417.7	160.6	5,420.0	6.27	6.09	

Directional Plus

Survey Report

Company:	EnCana Oil & Gas (USA) Inc	Local Co-ordinate Reference:	Well N.P EFH320-10N C29 595
Project:	North Piceance	TVD Reference:	KB EFH320-10N @ 7033.0ft (Patterson 308)
Site:	C29 595 (NENW Sec29-T5S-R95W)	MD Reference:	KB EFH320-10N @ 7033.0ft (Patterson 308)
Well:	N.P EFH320-10N C29 595	North Reference:	True
Wellbore:	DD	Survey Calculation Method:	Minimum Curvature
Design:	DD	Database:	EDM 2003.21 US Multi User Db

Survey									
Measured Depth (ft)	Inclination (°)	Azimuth (°)	Vertical Depth (ft)	+N/-S (ft)	+E/-W (ft)	Vertical Section (ft)	Dogleg Rate (°/100ft)	Build Rate (°/100ft)	Formations / Comments
12,340.0	95.90	356.80	7,389.6	5,462.4	157.7	5,464.6	4.47	4.00	
12,385.0	96.30	356.80	7,384.9	5,507.1	155.2	5,509.2	0.89	0.89	
12,431.0	97.00	356.60	7,379.5	5,552.7	152.6	5,554.6	1.58	1.52	
12,522.0	98.50	354.50	7,367.3	5,642.6	145.6	5,644.2	2.82	1.65	Last Cathedral Survey @ 12522' MD

Targets									
Target Name	Dip Angle (°)	Dip Dir. (°)	TVD (ft)	+N/-S (ft)	+E/-W (ft)	Northing (ft)	Easting (ft)	Latitude	Longitude
C29 595 EFH320-10N T - hit/miss target - Shape									
- survey misses target center by 233.3ft at 12522.0ft MD (7367.3 TVD, 5642.6 N, 145.6 E)									
- Point									
C29 595 EFH320-10N T - survey misses target center by 12.6ft at 2524.6ft MD (2501.9 TVD, 300.6 N, -39.1 E)									
- Point									
C29 595 EFH320-10N 1 - survey misses target center by 98.8ft at 8761.7ft MD (7355.0 TVD, 1889.3 N, 113.4 E)									
- Point									
C29 595 EFH320-10N 4 - survey misses target center by 72.0ft at 11763.1ft MD (7386.3 TVD, 4887.0 N, 181.9 E)									
- Point									
C29 595 EFH320-10N L - survey misses target center by 90.8ft at 7744.0ft MD (7349.7 TVD, 873.5 N, 73.5 E)									
- Point									
C29 595 EFH320-10N 3 - survey misses target center by 60.8ft at 10755.3ft MD (7374.7 TVD, 3880.9 N, 136.4 E)									
- Point									
C29 595 EFH320-10N L - survey misses target center by 98.0ft at 7743.1ft MD (7349.7 TVD, 872.6 N, 73.4 E)									
- Point									
C29 595 EFH320-10N 2 - survey misses target center by 68.4ft at 9758.1ft MD (7366.6 TVD, 2884.8 N, 119.8 E)									
- Point									

Survey Annotations					
Measured Depth (ft)	Vertical Depth (ft)	Local Coordinates		Comment	
		+N/-S (ft)	+E/-W (ft)		
12,522.0	7,367.3	5,642.6	145.6	Last Cathedral Survey @ 12522' MD	

Checked By: _____ Approved By: _____ Date: _____