

CHEVRON USA, INC.

ADDENDUM TO LEGAL PLAT FOR

EMERALD #93X & #94X

SECTION 26, T2N, R103W, 6th P.M.

SE 1/4 SE 1/4



SCALE: 1" = 200'
DATE: 10-21-10
DRAWN BY: S.L.

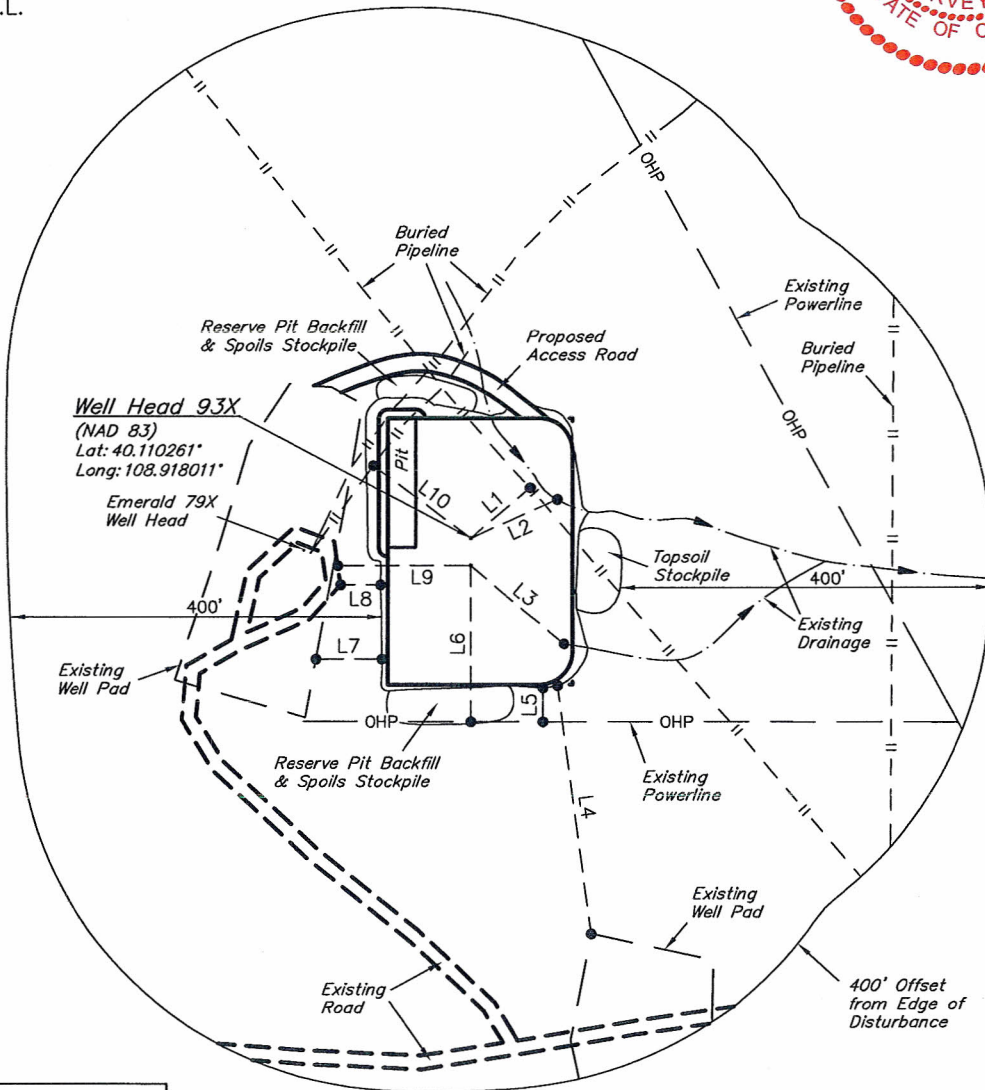

LINE TABLE

| LINE | DIRECTION | LENGTH |
|------|-------------|---------|
| L1 | N37°01'57"E | 84.36' |
| L2 | N53°07'51"E | 102.36' |
| L3 | S62°30'29"E | 132.21' |
| L4 | S20°31'56"E | 272.71' |
| L5 | S12°48'58"E | 37.29' |
| L6 | S12°48'58"E | 170.70' |
| L7 | S77°11'02"W | 71.92' |
| L8 | N77°11'02"E | 43.66' |
| L9 | S77°11'02"W | 144.49' |
| L10 | N66°05'38"W | 132.03' |