

Project: Weld County, CO (NAD 83)
Site: Sec. 24-T4N-R64W
Well: State C24-99HZ
Wellbore: Plan A (PERMITTING PLAN ONLY)
Design: Plan A - Rev 0

Noble Energy

HALLIBURTON
Sperry Drilling

SECTION DETAILS

Sec	MD	Inc	Azi	TVD	+N/-S	+E/-W	DLeg	TFace	VSec	Target
1	0.00	0.00	0.00	0.00	0.00	0.00	0.00	0.00	0.00	
2	5853.33	0.00	0.00	5853.33	0.00	0.00	0.00	0.00	0.00	
3	6915.83	85.00	93.55	6566.80	-40.48	652.52	8.00	93.55	653.78	
4	6990.83	85.00	93.55	6573.34	-45.11	727.09	0.00	0.00	728.49	
5	7059.58	90.50	93.55	6576.04	-49.36	795.63	8.00	0.00	797.16	
6	10843.69	90.50	93.55	6543.01	-283.66	4572.33	0.00	0.00	4581.12	State C24-99HZ_PlanA - Rev0_BHL Tgt

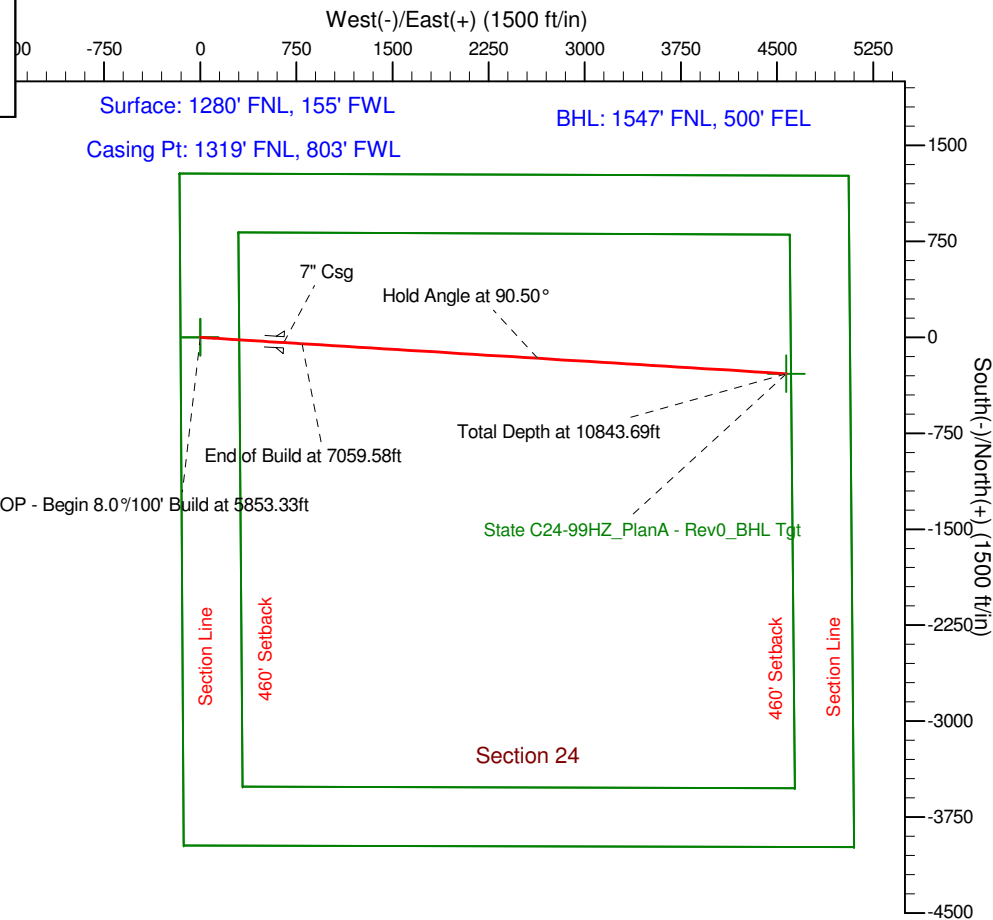
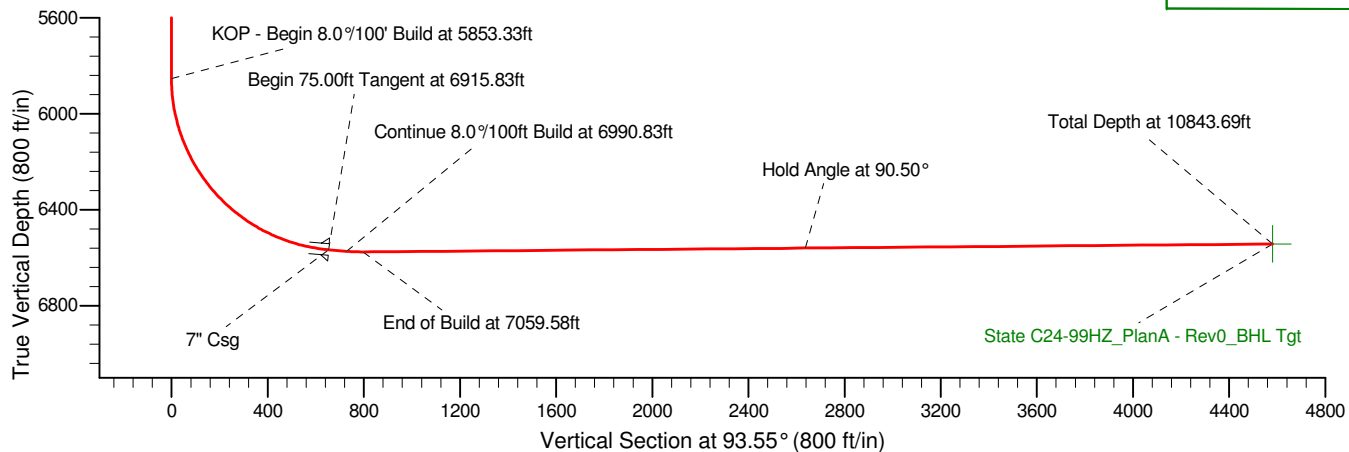
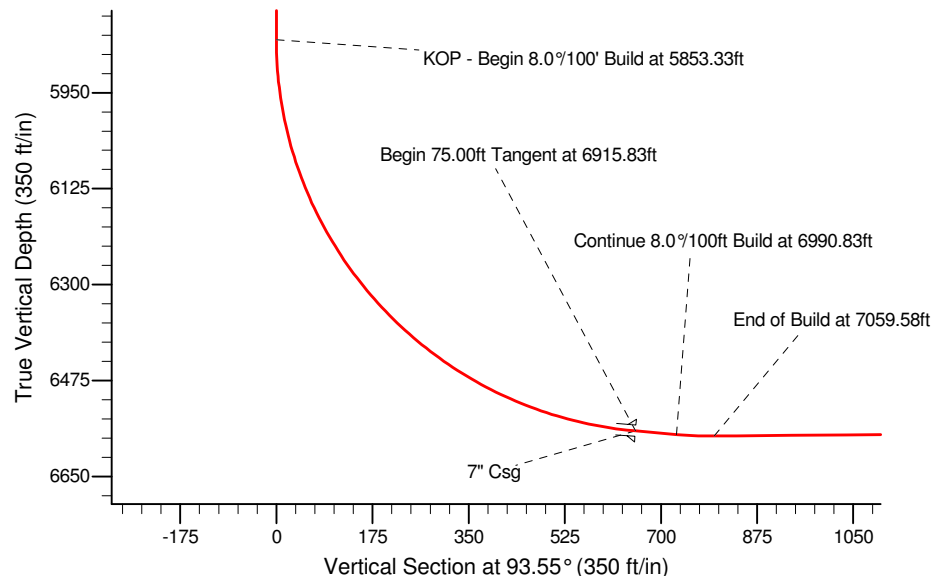

WELL DETAILS: State C24-99HZ

Ground Level: 4664.00			
Northing 1354261.96	Easting 3276713.77	Latitude 40° 18' 5.760 N	Longitude 104° 30' 28.332 W

Plan: Plan A - Rev 0 (State C24-99HZ/Plan A (PERMITTING PLAN ONLY))

Created By: Jay Lantz Date: 9:39, November 18 2010

Checked: _____ Date: _____

Reviewed: _____ Date: _____

Approved: _____ Date: _____