

KERR MCGEE OIL & GAS ONSHORE LP

Location: COLORADO Slot: SLOT#18 MIRACLE 10-12 (2484'FSL & 2611'FEL)
 Field: LARIMER COUNTY Well: MIRACLE 10-12
 Facility: SEC.12-T5N-R68W Wellbore: MIRACLE 10-12 PWB

Plot reference wellpath is MIRACLE 10-12 (REV-A.0) PWP	
True vertical depths are referenced to XTREME 6 (RT)	Grid System: NAD83 / Lambert Colorado State Planes, Northern Zone (501), US feet
Measured depths are referenced to XTREME 6 (RT)	North Reference: True north
XTREME 6 (RT) to Mean Sea Level: 4979 feet	Scale: True distance
Mean Sea Level to Mud line (Facility: SEC.12-T5N-R68W): 0 feet	Depths are in feet
Coordinates are in feet referenced to Slot	Created by: nistale on 10/26/2010

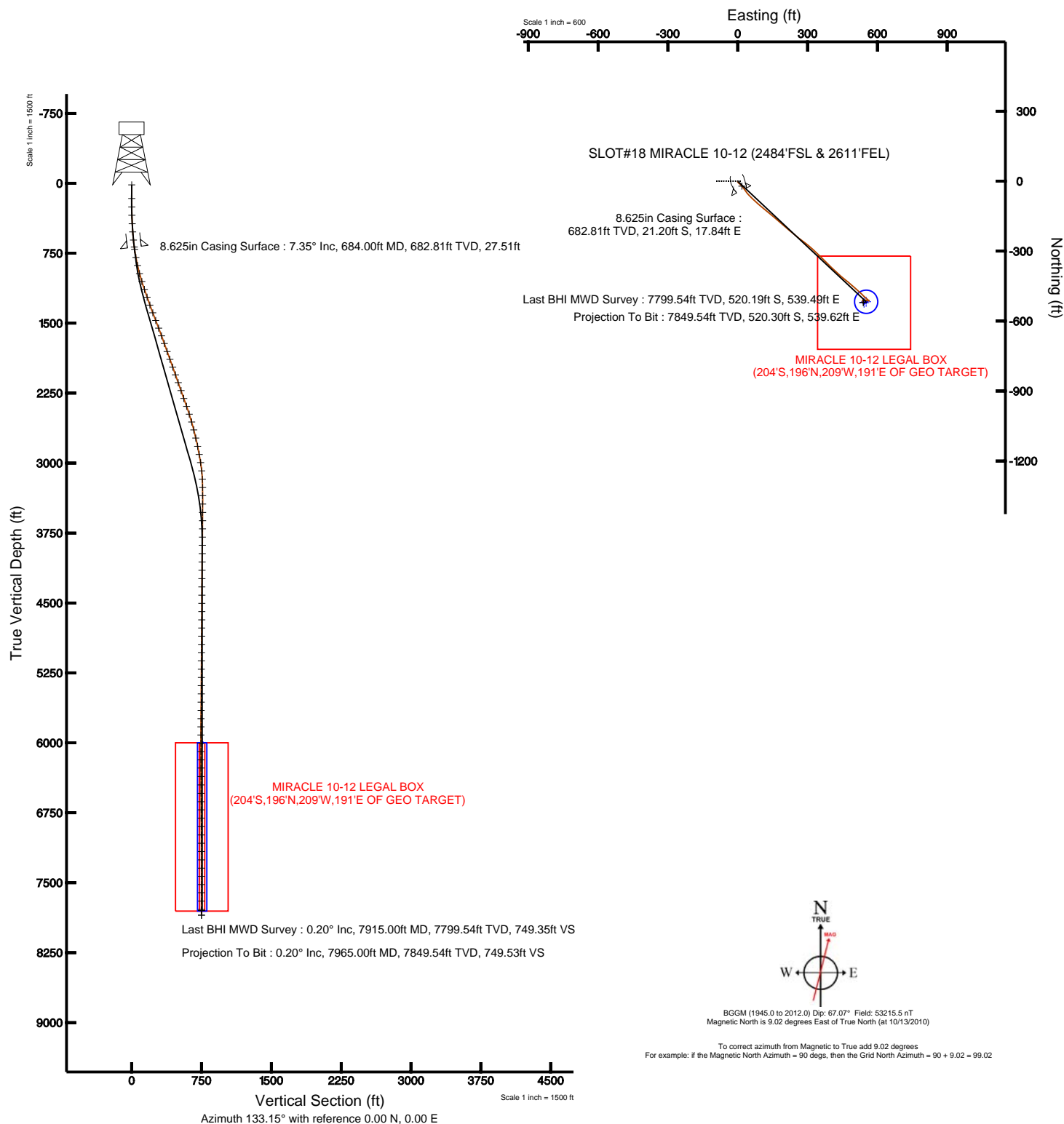



Actual Wellpath Report

MIRACLE 10-12 AWB_awp

Page 1 of 5



INTEQ

REFERENCE WELLPATH IDENTIFICATION

Operator	KERR MCGEE OIL & GAS ONSHORE LP	Slot	SLOT#18 MIRACLE 10-12 (2484'FSL & 2611'FEL)
Area	COLORADO	Well	MIRACLE 10-12
Field	LARIMER COUNTY	Wellbore	MIRACLE 10-12 AWB
Facility	SEC.12-T5N-R68W		

REPORT SETUP INFORMATION

Projection System	NAD83 / Lambert Colorado State Planes, Northern Zone (501), US feet	Software System	WellArchitect® 2.0
North Reference	True	User	Nistale
Scale	0.999961	Report Generated	10/26/2010 at 4:11:55 PM
Convergence at slot	0.35° East	Database/Source file	Denver Server/MIRACLE_10-12_AWB.xml

WELLPATH LOCATION

	Local coordinates		Grid coordinates		Geographic coordinates	
	North[ft]	East[ft]	Easting[USft]	Northing[USft]	Latitude	Longitude
Slot Location	46.38	-2335.48	3152084.90	1394095.41	40°24'50.069"N	104°57'13.748"W
Facility Reference Pt			3154420.53	1394063.64	40°24'49.612"N	104°56'43.555"W
Field Reference Pt			3154420.53	1394063.64	40°24'49.612"N	104°56'43.555"W

WELLPATH DATUM

Calculation method	Minimum curvature	XTREME 6 (RT) to Facility Vertical Datum	4979.00ft
Horizontal Reference Pt	Slot	XTREME 6 (RT) to Mean Sea Level	4979.00ft
Vertical Reference Pt	XTREME 6 (RT)	Facility Vertical Datum to Mud Line (Facility)	0.00ft
MD Reference Pt	XTREME 6 (RT)	Section Origin	N 0.00, E 0.00 ft
Field Vertical Reference	Mean Sea Level	Section Azimuth	133.15°



Actual Wellpath Report

MIRACLE 10-12 AWB_awp

Page 2 of 5



INTEQ

REFERENCE WELLPATH IDENTIFICATION

Operator	KERR MCGEE OIL & GAS ONSHORE LP	Slot	SLOT#18 MIRACLE 10-12 (2484'FSL & 2611'FEL)
Area	COLORADO	Well	MIRACLE 10-12
Field	LARIMER COUNTY	Wellbore	MIRACLE 10-12 AWB
Facility	SEC.12-T5N-R68W		

WELLPATH DATA (92 stations) † = interpolated/extrapolated station

MD [ft]	Inclination [°]	Azimuth [°]	TVD [ft]	Vert Sect [ft]	North [ft]	East [ft]	DLS [°/100ft]	Comments
0.00†	0.000	182.700	0.00	0.00	0.00	0.00	0.00	
16.00	0.000	182.700	16.00	0.00	0.00	0.00	0.00	
162.00	0.400	182.700	162.00	0.33	-0.51	-0.02	0.27	
253.00	0.400	209.400	253.00	0.61	-1.10	-0.19	0.20	
342.00	1.300	161.300	341.99	1.58	-2.33	-0.02	1.21	
433.00	2.700	139.500	432.93	4.62	-4.94	1.70	1.72	
520.00	4.600	134.500	519.75	10.14	-8.94	5.52	2.21	
608.00	6.300	133.500	607.35	18.50	-14.74	11.54	1.93	
709.00	7.700	138.800	707.59	30.77	-23.65	20.02	1.53	
798.00	10.900	145.700	795.42	44.92	-35.09	28.69	3.80	
885.00	12.200	141.900	880.65	62.04	-49.12	39.00	1.73	
975.00	15.500	135.900	968.03	83.46	-65.24	53.24	3.99	
1063.00	17.500	132.400	1052.40	108.44	-82.61	71.19	2.54	
1152.00	18.300	130.700	1137.10	135.78	-100.74	91.67	1.07	
1241.00	20.000	129.600	1221.17	164.93	-119.56	113.99	1.95	
1331.00	19.500	128.900	1305.87	195.27	-138.80	137.54	0.61	
1419.00	21.200	131.700	1388.38	225.83	-158.61	160.85	2.23	
1507.00	21.300	130.300	1470.40	257.70	-179.53	184.92	0.59	
1595.00	20.800	131.000	1552.52	289.28	-200.12	208.90	0.64	
1683.00	20.200	129.600	1634.95	320.05	-220.06	232.40	0.88	
1771.00	19.600	127.900	1717.70	349.92	-238.81	255.76	0.95	
1862.00	19.600	127.200	1803.42	380.30	-257.41	279.96	0.26	
1951.00	20.000	129.600	1887.16	410.33	-276.14	303.58	1.02	
2040.00	19.400	133.100	1970.96	440.31	-295.94	326.10	1.49	
2128.00	19.600	132.800	2053.91	469.68	-315.96	347.60	0.25	
2217.00	19.700	134.900	2137.73	499.60	-336.69	369.18	0.80	
2307.00	19.500	136.700	2222.51	529.76	-358.33	390.22	0.71	
2396.00	19.300	131.400	2306.47	559.29	-378.87	411.45	1.99	
2486.00	19.400	132.400	2391.38	589.10	-398.78	433.64	0.38	
2575.00	18.500	128.900	2475.56	617.96	-417.62	455.55	1.63	
2663.00	16.100	130.000	2559.58	644.07	-434.23	475.76	2.75	
2751.00	14.000	131.700	2644.55	666.90	-449.16	493.06	2.44	
2841.00	13.200	130.300	2732.03	688.05	-463.04	509.02	0.96	
2931.00	12.000	132.100	2819.86	707.67	-475.96	523.80	1.40	
3020.00	10.500	136.300	2907.15	725.02	-488.03	536.27	1.92	
3109.00	8.800	131.000	2994.89	739.92	-498.36	547.01	2.15	
3199.00	6.000	128.200	3084.13	751.48	-505.79	555.91	3.14	
3289.00	3.300	143.300	3173.83	758.72	-510.77	561.15	3.27	
3377.00	0.100	133.800	3261.78	761.29	-512.86	562.72	3.64	
3465.00	0.300	102.600	3349.78	761.57	-512.96	563.00	0.25	
3554.00	0.200	332.500	3438.78	761.62	-512.88	563.16	0.51	
3644.00	0.200	300.500	3528.78	761.32	-512.66	562.95	0.12	
3733.00	0.400	283.900	3617.78	760.90	-512.50	562.51	0.24	
3821.00	0.600	289.200	3705.77	760.21	-512.28	561.78	0.23	
3909.00	0.600	279.400	3793.77	759.41	-512.05	560.89	0.12	



Actual Wellpath Report

MIRACLE 10-12 AWB_awp

Page 3 of 5



INTEQ

REFERENCE WELLPATH IDENTIFICATION

Operator	KERR MCGEE OIL & GAS ONSHORE LP	Slot	SLOT#18 MIRACLE 10-12 (2484'FSL & 2611'FEL)
Area	COLORADO	Well	MIRACLE 10-12
Field	LARIMER COUNTY	Wellbore	MIRACLE 10-12 AWB
Facility	SEC.12-T5N-R68W		

WELLPATH DATA (92 stations)

MD [ft]	Inclination [°]	Azimuth [°]	TVD [ft]	Vert Sect [ft]	North [ft]	East [ft]	DLS [°/100ft]	Comments
3997.00	0.800	285.000	3881.76	758.48	-511.82	559.84	0.24	
4086.00	1.100	280.100	3970.75	757.22	-511.51	558.40	0.35	
4176.00	1.000	269.900	4060.73	755.92	-511.36	556.77	0.24	
4265.00	1.100	256.500	4149.72	754.88	-511.56	555.16	0.30	
4355.00	1.600	257.900	4239.69	753.69	-512.02	553.09	0.56	
4444.00	0.400	144.400	4328.68	753.29	-512.53	552.06	2.02	
4532.00	0.100	274.800	4416.68	753.53	-512.78	552.16	0.54	
4620.00	0.400	334.200	4504.68	753.18	-512.50	551.95	0.41	
4708.00	0.200	310.100	4592.68	752.74	-512.12	551.70	0.26	
4797.00	0.400	295.600	4681.68	752.29	-511.89	551.30	0.24	
4884.00	0.500	299.100	4768.68	751.63	-511.57	550.69	0.12	
4972.00	0.400	286.100	4856.67	750.99	-511.30	550.06	0.16	
5060.00	0.600	278.000	4944.67	750.34	-511.15	549.31	0.24	
5148.00	0.600	288.200	5032.66	749.54	-510.94	548.42	0.12	
5237.00	0.700	270.900	5121.66	748.72	-510.79	547.43	0.25	
5326.00	0.400	262.500	5210.65	748.12	-510.82	546.58	0.35	
5415.00	0.400	242.600	5299.65	747.82	-511.00	546.00	0.16	
5503.00	0.800	243.500	5387.65	747.50	-511.42	545.17	0.45	
5591.00	0.800	240.700	5475.64	747.10	-511.99	544.09	0.04	
5680.00	1.000	272.000	5564.63	746.33	-512.27	542.77	0.59	
5769.00	0.800	281.800	5653.62	745.22	-512.11	541.38	0.28	
5857.00	0.500	283.600	5741.61	744.36	-511.90	540.41	0.34	
5944.00	0.600	285.700	5828.61	743.62	-511.69	539.60	0.12	
6032.00	0.500	242.100	5916.60	743.09	-511.74	538.82	0.48	
6121.00	0.500	230.900	6005.60	742.91	-512.17	538.18	0.11	
6210.00	0.500	226.700	6094.60	742.83	-512.68	537.59	0.04	
6299.00	0.500	196.800	6183.59	742.98	-513.32	537.20	0.29	
6387.00	0.500	187.600	6271.59	743.38	-514.07	537.03	0.09	
6477.00	0.500	188.000	6361.59	743.83	-514.84	536.93	0.00	
6568.00	0.300	196.800	6452.58	744.17	-515.46	536.80	0.23	
6657.00	0.400	171.800	6541.58	744.51	-516.00	536.78	0.20	
6747.00	0.600	194.000	6631.58	744.99	-516.76	536.71	0.31	
6835.00	0.500	184.100	6719.58	745.45	-517.59	536.57	0.16	
6924.00	0.400	151.800	6808.57	745.99	-518.25	536.69	0.30	
7015.00	0.400	153.500	6899.57	746.59	-518.82	536.98	0.01	
7104.00	0.600	145.400	6988.57	747.34	-519.48	537.39	0.24	
7193.00	1.100	116.600	7077.56	748.61	-520.25	538.42	0.72	
7282.00	0.800	72.700	7166.55	749.74	-520.44	539.77	0.86	
7371.00	0.200	230.900	7255.54	750.02	-520.36	540.25	1.11	
7460.00	0.300	317.700	7344.54	749.77	-520.28	539.97	0.39	
7548.00	0.200	1.300	7432.54	749.44	-519.96	539.82	0.24	
7636.00	0.100	306.500	7520.54	749.26	-519.76	539.76	0.19	
7724.00	0.300	233.000	7608.54	749.14	-519.85	539.51	0.33	
7813.00	0.100	127.400	7697.54	749.18	-520.04	539.39	0.38	
7904.00	0.100	165.100	7788.54	749.33	-520.17	539.47	0.07	



Actual Wellpath Report

MIRACLE 10-12 AWB_awp

Page 4 of 5



INTEQ

REFERENCE WELLPATH IDENTIFICATION

Operator	KERR MCGEE OIL & GAS ONSHORE LP	Slot	SLOT#18 MIRACLE 10-12 (2484'FSL & 2611'FEL)
Area	COLORADO	Well	MIRACLE 10-12
Field	LARIMER COUNTY	Wellbore	MIRACLE 10-12 AWB
Facility	SEC.12-T5N-R68W		

WELLPATH DATA (92 stations)

MD [ft]	Inclination [°]	Azimuth [°]	TVD [ft]	Vert Sect [ft]	North [ft]	East [ft]	DLS [°/100ft]	Comments
7915.00	0.200	131.000	7799.54	749.35	-520.19	539.49	1.18	Last BHI MWD Survey
7965.00	0.200	131.000	7849.54	749.53	-520.30	539.62	0.00	Projection To Bit

HOLE & CASING SECTIONS Ref Wellbore: MIRACLE 10-12 AWB Ref Wellpath: MIRACLE 10-12 AWB_awp

String/Diameter	Start MD [ft]	End MD [ft]	Interval [ft]	Start TVD [ft]	End TVD [ft]	Start N/S [ft]	Start E/W [ft]	End N/S [ft]	End E/W [ft]
12.25in Open Hole	16.00	684.00	668.00	16.00	682.81	0.00	0.00	-21.20	17.84
8.625in Casing Surface	16.00	684.00	668.00	16.00	682.81	0.00	0.00	-21.20	17.84
7.875in Open Hole	684.00	7965.00	7281.00	682.81	7849.54	-21.20	17.84	-520.30	539.62

TARGETS

Name	MD [ft]	TVD [ft]	North [ft]	East [ft]	Grid East [srv ft]	Grid North [srv ft]	Latitude	Longitude	Shape
MIRACLE 10-12 GEO TARGET 50' RADIUS (1977'FSL & 2051'FEL, REV-1)		6000.00	-517.32	551.93	3152639.98	1393581.53	40°24'44.957"N	104°57'06.613"W	circle
MIRACLE 10-12 LEGAL BOX (204'S,196'N,209'W,191'E OF GEO TARGET)		6000.00	-521.32	542.93	3152631.00	1393577.47	40°24'44.917"N	104°57'06.730"W	square

WELLPATH COMPOSITION Ref Wellbore: MIRACLE 10-12 AWB Ref Wellpath: MIRACLE 10-12 AWB_awp

Start MD [ft]	End MD [ft]	Positional Uncertainty Model	Log Name/Comment	Wellbore
16.00	608.00	NaviTrak (Standard)	BHI MWD Surveys 12.25 HOLE <0' - 608'>	MIRACLE 10-12 AWB
608.00	7915.00	NaviTrak (Standard)	BHI MWD Surveys 7.875 HOLE <709' - 7965'>	MIRACLE 10-12 AWB
7915.00	7965.00	Blind Drilling (std)	Projection to bit	MIRACLE 10-12 AWB



Actual Wellpath Report

MIRACLE 10-12 AWB_awp

Page 5 of 5



INTEQ

REFERENCE WELLPATH IDENTIFICATION

Operator	KERR MCGEE OIL & GAS ONSHORE LP	Slot	SLOT#18 MIRACLE 10-12 (2484'FSL & 2611'FEL)
Area	COLORADO	Well	MIRACLE 10-12
Field	LARIMER COUNTY	Wellbore	MIRACLE 10-12 AWB
Facility	SEC.12-T5N-R68W		

WELLPATH COMMENTS

MD [ft]	Inclination [°]	Azimuth [°]	TVD [ft]	Comment
7915.00	0.200	131.000	7799.54	Last BHI MWD Survey
7965.00	0.200	131.000	7849.54	Projection To Bit