

Steil Surveying Services, LLC

1102 West 19th Street P.O. BOX 2073

Cheyenne, Wyoming 82009

VISIBLE IMPROVEMENTS

THIS MAP DOES NOT REPRESENT A BOUNDARY SURVEY

SECTION 36
TOWNSHIP 5 NORTH
RANGE 66 WEST

DATE: 05/18/2010

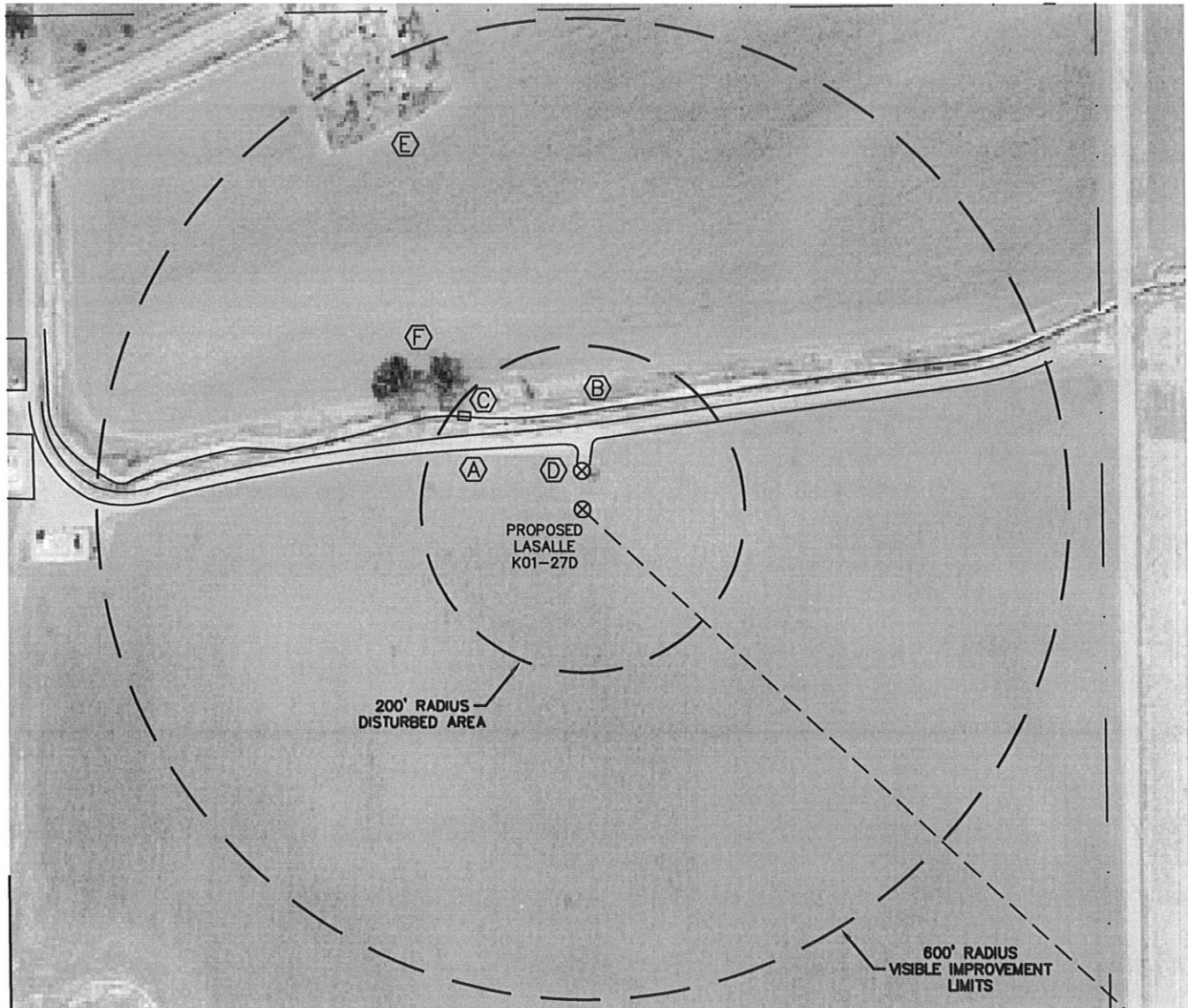

IMPROVEMENTS:

- (A) DIRT ROAD - 55'+/- NORTH
- (B) CANAL - 118'+/- NORTH
- (C) BRIDGE - 151'+/- NORTHWEST
- (D) EXISTING REHMER NO. 1 - 47' NORTH
- (E) HEDGE ROW - 530'+/- NORTHWEST
- (F) TREES - 220'+/- NORTHWEST

THE NEAREST OVERHEAD POWER LINE IS 650'+/- EAST

NOTICE: According to Colorado law you MUST commence any legal action based upon any defect in this W.L.C. within three years after you first discover such defect. In no event may any action based upon any defect in this W.L.C. be commenced more than ten years from this sold date of the certification shown hereon.

