

Steil Surveying Services, LLC

1102 West 19th Street P.O. BOX 2073

Cheyenne, Wyoming 82009

PRODUCTION FACILITY LOCATION DRAWING

FOR THE PROPOSED ALOYSIUS C34-99HZ WELL

THIS MAP DOES NOT REPRESENT A BOUNDARY SURVEY

DATE: 09/16/2010

SECTION 34
TOWNSHIP 4 NORTH
RANGE 64 WEST

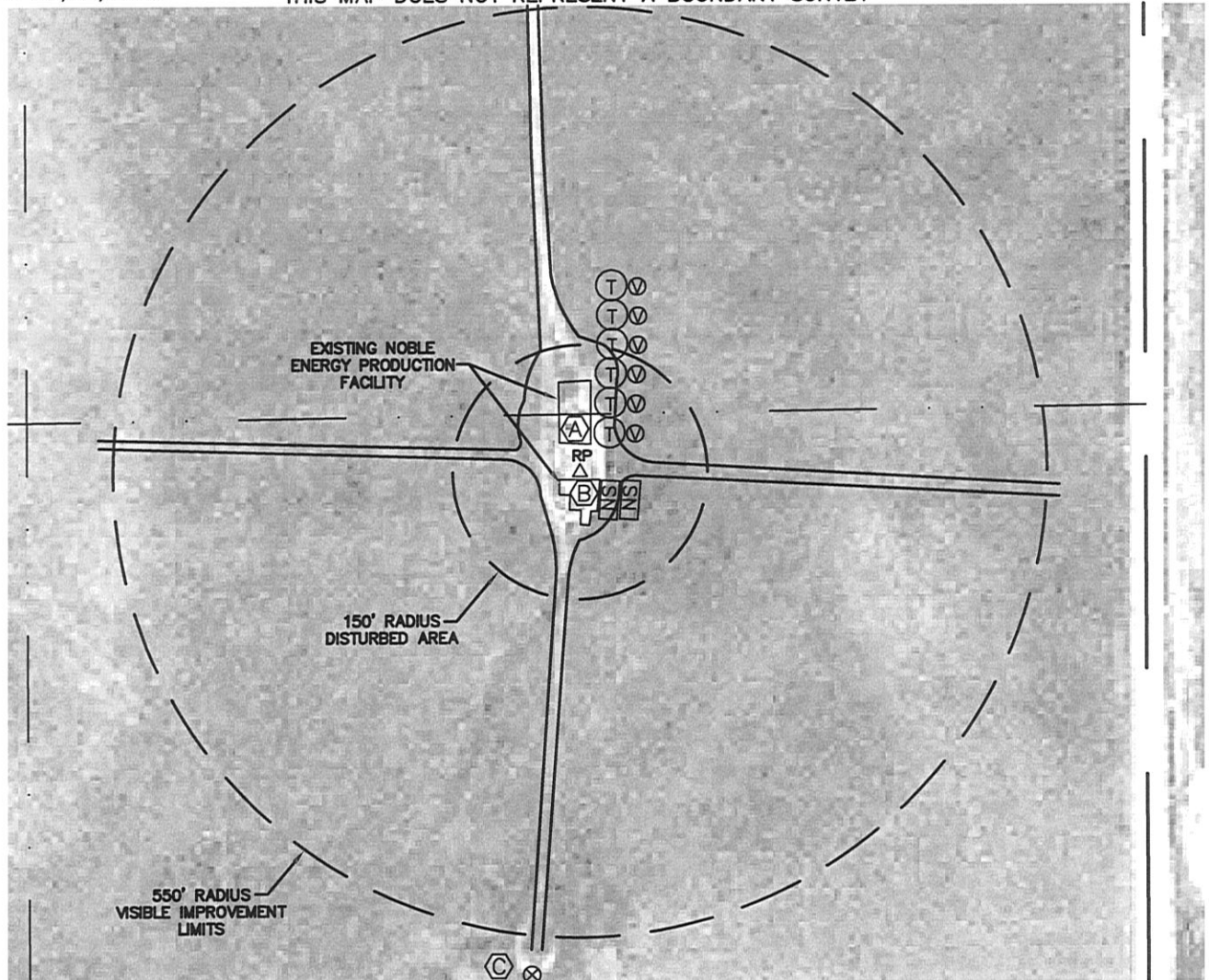

REFERENCE POINT LOCATION:

LAT: N 40.26519, LONG: W 104.53004

PDOP: 1.8, ELEV 4694'

SE/4SE/4 SEC 34, 1251' FSL, 667' FEL

DISTANCE TO PROPOSED WELL: 696' NORTH

ASSOCIATED NEW WELL:

ALOYSIUS C34-99HZ, ALOYSIUS C34-22D

ASSOCIATED NOBLE ENERGY EXISTING WELLS:

ALOYSIUS C34-2, ALOYSIUS C34-9
ALOYSIUS C34-15, ALOYSIUS C34-23
GUTTERSEN D3-27

NEAREST PROPERTY LINE: 667' EAST

NEAREST OVERHEAD POWER LINE:
640' EAST

NEAREST BUILDING: 230'+/- NORTHWEST

NEAREST RAILROAD: MORE THAN ONE MILE

WEST EDGE OF GRAVEL COUNTY ROAD NO. 57: 655' EAST

IMPROVEMENTS:

- (A) EXISTING TANKS - 34' NORTH
- (B) EXISTING SEPARATOR - 9' SOUTH
- (C) EXISTING ALOYSIUS C34-2 WELL - 596' SOUTH

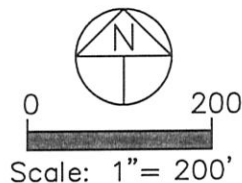

NOTE: Distances shown are to the proposed production facility reference point and were scaled from Weld County aerial photography. Improvements not shown on aerial photography were field verified.

LEGEND:

- △ REFERENCE POINT
- ⊙ PROPOSED WATER VAULT
- ⊙ PROPOSED TANK
- ⊙ PROPOSED SEPARATOR