



September 20, 2010

Department of Natural Resources
Oil and Gas Conservation Commission
The Chancery Building
1120 Lincoln St., Suite 801
Denver, CO 80203

Re: **20 Day Certification Letter - 318A-e**
SEKICH 39-18
Township 3 North, Range 67 West, Section 18: NE/4SE/4
Unit Spacing: 03N-67W-17 W/2SW/4; 03N-67W-18 E/2SE/4
Weld County, Colorado

Ladies/Gentlemen:

Kerr McGee Oil and Gas Onshore LP ("KMG") hereby certify to the Director that KMG owns one-hundred percent (100%) of the mineral rights in the proposed spacing unit. Therefore, KMG respectfully requests the Director to approve the boundary well.

If you have any questions or issues regarding this permit, please contact Cheryl Light at (720) 929-6461.

Very truly yours,

KERR-McGEE OIL AND GAS ONSHORE LP

A handwritten signature in blue ink, appearing to read "Rebecca Heim".

Rebecca Heim
Regulatory Analyst II

Enclosure

WELL LOCATION CERTIFICATE: SEKICH 39-18

SECTION 18, TOWNSHIP 3 NORTH, RANGE 67 WEST, 6TH P.M.

NW SEC. 18
2" ALUM. CAP
LS 23500

S 87°03'32" E 2526.82'

S 89°10'56" E 2639.48'

N ¼ SEC. 18
2 ½" ALUM. CAP
LS 30462

NE SEC. 18
2 ½" ALUM. CAP
LS 23501

NOTES:

THIS IS A DIRECTIONAL WELL
BH LOCATION TO BE 1300' FSL & 50' FEL
BH LOCATION PROVIDED BY CLIENT.
LAND SURFACE USE- IRRIGATED CROPLAND
TWINNING-PROPOSED WELL SEKICH 32-17
TO BE 16' W
PROPOSED WELL SEKICH 32-17 TO BE
1592' FSL & 1242' FEL
SEE ATTACHED MAP FOR ADDITIONAL
IMPROVEMENTS WITHIN 400'.

W ¼ SEC. 18
2" ALUM. CAP
LS 23500

SURFACE LOCATION

GROUND ELEVATION= 4865'
NAD83
LATITUDE= 40.223111°
LONGITUDE= 104.927661°

BOTTOM HOLE LOCATION

NAD83
LATITUDE= 40.222199°
LONGITUDE= 104.923452°

PDOP= 2.31
GPS OPERATOR: CHRIS PEARSON

SW SEC. 18
2 ½" ALUM. CAP
LS 16847

N 88°25'24" W 2532.13'

S ¼ SEC. 18
2" ALUM. CAP
LS 23500

N 88°26'09" W 2630.68'

SE SEC. 18
FOUND
#6 REBAR

WELL **SEKICH 39-18** TO BE LOCATED 1592' FSL AND 1226' FEL, SECTION 18, T3N, R67W OF THE 6th P.M.

LEGEND

⊕ = EXISTING MONUMENT ♦ = BOTTOM HOLE BH = BOTTOM HOLE
● = PROPOSED WELL ◆ = EXISTING WELL

0 500 1000
SCALE: 1"=1000'



NOTES:

- THIS SURVEY WAS DONE BY GPS METHODS AND CONFORMS TO THE MINIMUM STANDARDS SET BY THE C.O.G.C.C., RULE NO. 215
- ELEVATIONS SHOWN AT THE WELL HEAD, AS WELL AS HORIZONTAL CONTROL, ARE BASED ON GPS-RTK VALUES DERIVED FROM DOING 2-HOUR STATIC GPS SESSIONS AND REDUCTIONS USING O.P.U.S. SOLUTIONS.
VERTICAL = NAVD83; HORIZONTAL = NAD83/92
- THE BEARINGS SHOWN HEREON ARE BASED ON GPS OBSERVATIONS BETWEEN THE MONUMENTS SHOWN HEREON AS FOUND ON THE FIELD DATE BELOW.
- DISTANCES SHOWN ARE AT GROUND LEVEL, AS MEASURED IN THE FIELD, WITH TIES TO WELLS MEASURED AT A PERPENDICULAR TO SECTION LINES.

I, JERRY F. HARCEK JR., A LICENSED PROFESSIONAL LAND SURVEYOR IN THE STATE OF COLORADO DO HEREBY CERTIFY TO **KERR-MCGEE OIL & GAS ONSHORE LP**, THAT THE SURVEY AND WELL LOCATION CERTIFICATE SHOWN HEREON WERE DONE BY ME OR UNDER MY DIRECT SUPERVISION AND THAT THE DRAWING SHOWN HEREON ACCURATELY DEPICTS THE PROPOSED LOCATION OF THE WELL **SEKITCH 39-18**. THIS CERTIFICATE DOES NOT REPRESENT A LAND SURVEY PLAT OR IMPROVEMENT SURVEY PLAT AS DEFINED BY C.R.S. 38-51-102 AND CANNOT BE RELIED UPON TO DETERMINE OWNERSHIP.

JERRY F. HARCEK JR., PLS 34997
COLORADO LICENSED PROFESSIONAL LAND SURVEYOR
FOR AND ON BEHALF OF P.F.S., LLC

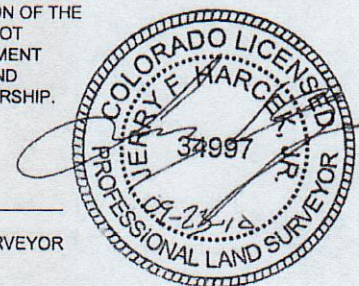

PREPARED BY:



FIELD DATE:
06-18-10

DRAWING DATE:
09-22-10

BY:
CAM

WELL NAME:
SEKICH 39-18

SURFACE LOCATION:

WELD COUNTY, COLORADO

NE ¼ 1/4 SEC. 18, T3N, R67W

NOTICE: ACCORDING TO COLORADO LAW YOU MUST COMMENCE ANY LEGAL ACTION BASED UPON ANY DEFECT IN THIS SURVEY WITHIN THREE YEARS AFTER YOU FIRST DISCOVER SUCH DEFECT. IN NO EVENT MAY ANY ACTION BASED UPON ANY DEFECT IN THIS SURVEY BE COMMENCED MORE THAN TEN YEARS FROM THIS SAID DATE OF THIS CERTIFICATION SHOWN HEREON.

SEKICH 39-18 NESE Sec. 18 T3N-R67W

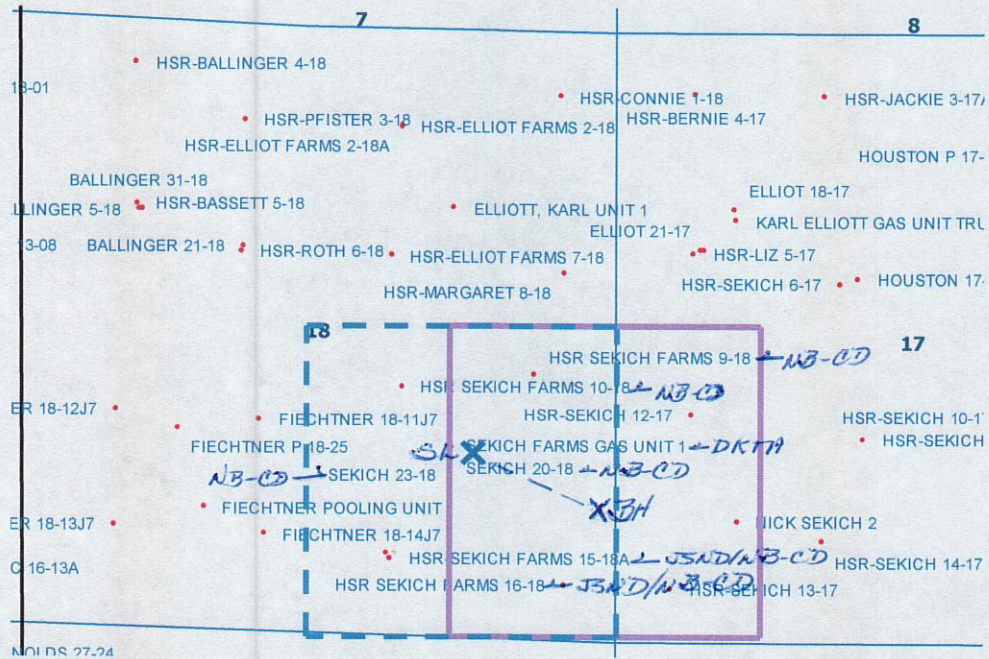

LEGEND



Proposed 160 acre Spacing Unit (Solid line).



Bottom Hole Located SE/4SE/4, Sec. 18-T3N-R67W (Dashed line).

This 1/4 Section has less than 8 bottom hole wells producing from the Codell, Niobrara & J Sand Formations.