

Location Drawing

WASTE 18-21

Multi Well Pad

SE¼ NW¼ SECTION 21, TOWNSHIP 1 NORTH, RANGE 68 WEST OF THE 6TH PRINCIPAL MERIDIAN

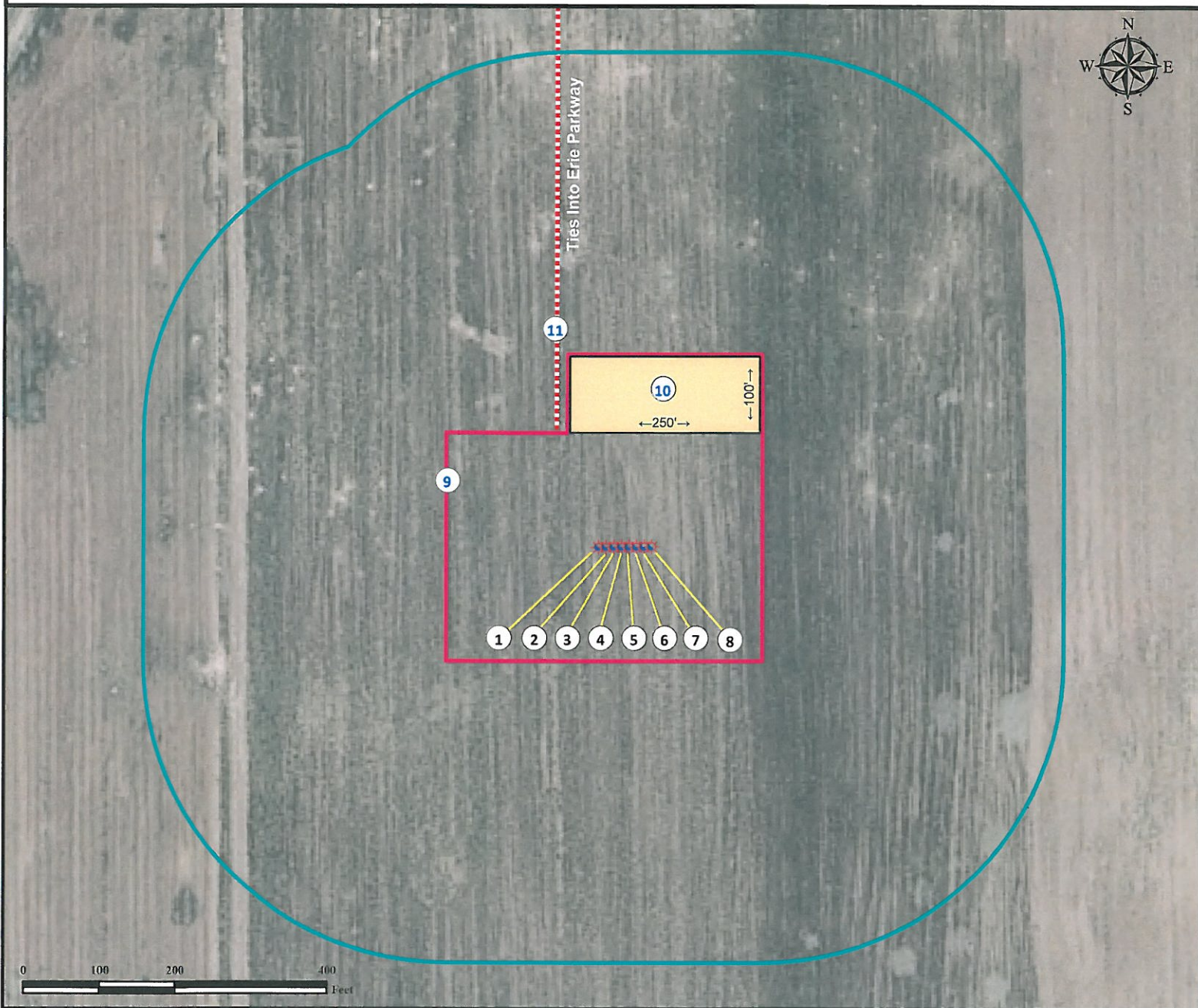

- | | | |
|-------------------------------|-------------------------------|--|
| 1. Proposed Well WASTE 5-21. | 5. Proposed Well WASTE 18-21. | 9. Operational Disturbance Area. |
| 2. Proposed Well WASTE 31-21. | 6. Proposed Well WASTE 3-21. | 10. Proposed Facility is ±150' N. |
| 3. Proposed Well WASTE 30-21. | 7. Proposed Well WASTE 25-21. | 11. Access Road. |
| 4. Proposed Well WASTE 4-21. | 8. Proposed Well WASTE 6-21. | There are No Visible Improvements Within a 400ft Radius of the Operational Disturbance Area. |

Legend

- | | | | |
|--|---------------|--|-------------------|
| | Proposed Well | | Disturbance Area |
| | Access Road | | 400' Radius |
| | | | Proposed Facility |

Reference Location

All Measurements are Made from Reference Well
WASTE 18-21
LAT: 40.038504° LONG: -105.011506°
Elevation: 5212.92476



Use our resources to find yours!
www.petro-fs.com
(303) 928-7128

Field Date: 07/16/2010
Drafting Date: 08/27/2010
Drafter: DMM
Checked By: BHF

Surface Use: Open Field

Data Sources:
Aerial courtesy of NAIP (2009)

Prepared for:
KERR-MCGEE OIL & GAS ONSHORE LP