

**EOG RESOURCES, INC.**  
**LION CREEK #07-24H**  
LOCATED IN WELD COUNTY, COLORADO  
SECTION 24, T11N, R64W, 6th P.M.

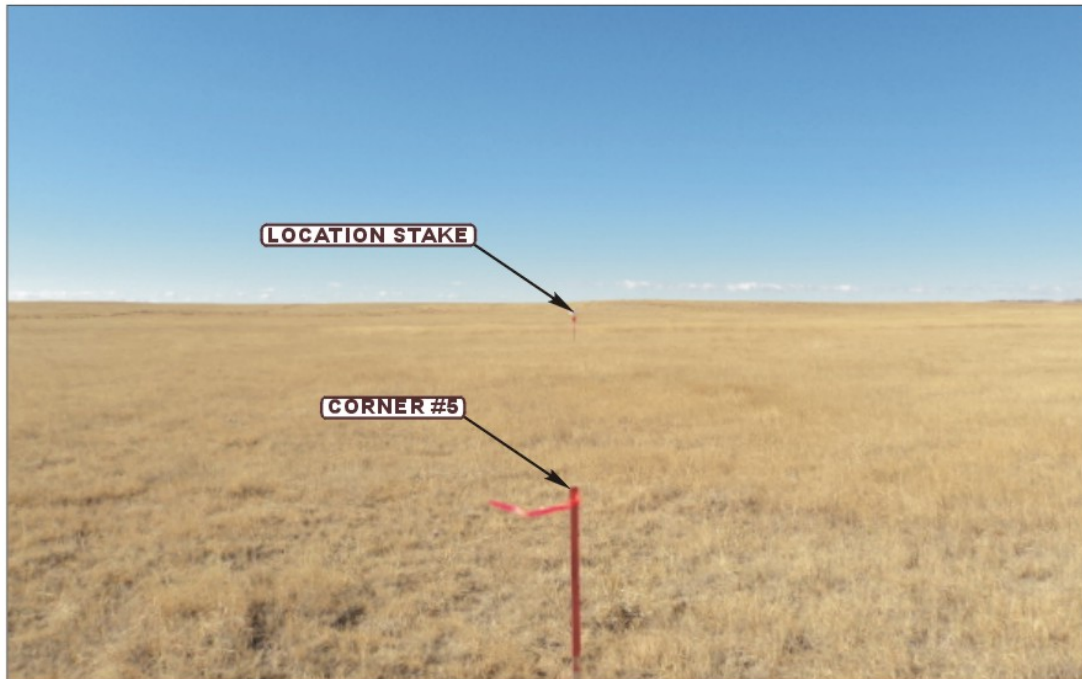

PHOTO: VIEW FROM CORNER #5 TO LOCATION STAKE

CAMERA ANGLE: NORTHEASTERLY



PHOTO: VIEW FROM BEGINNING OF PROPOSED ACCESS

CAMERA ANGLE: NORTHERLY



- Since 1964 -



Uintah Engineering & Land Surveying

85 South 200 East Vernal, Utah 84078  
435-789-1017 FAX (435) 789-1813

**LOCATION  
PHOTOS**

**11 04 10**  
MONTH DAY YEAR

TAKEN BY: G.M.

DRAWN BY: Z.L.

REVISED: 00-00-00

PHOTO  
**P 1**

**EOG RESOURCES, INC.**  
**LION CREEK #07-24H**  
**LOCATED IN WELD COUNTY, COLORADO**  
**SECTION 24, T11N, R64W, 6th P.M.**

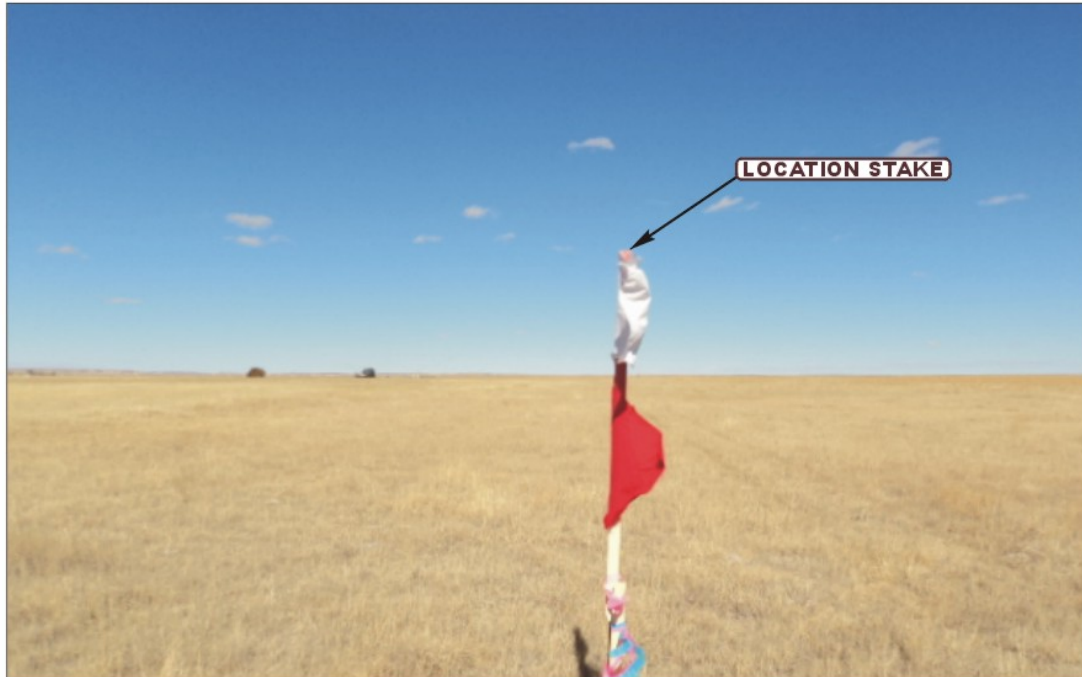

**PHOTO: VIEW OF LOCATION STAKE**

**CAMERA ANGLE: NORTHERLY**



**PHOTO: VIEW OF LOCATION STAKE**

**CAMERA ANGLE: EASTERLY**



- Since 1964 -



Uintah Engineering & Land Surveying  
85 South 200 East Vernal, Utah 84078  
435-789-1017 FAX (435) 789-1813

**LOCATION  
PHOTOS**

**11 04 10**  
MONTH DAY YEAR

TAKEN BY: G.M.

DRAWN BY: Z.L.

REVISED: 00-00-00

**PHOTO  
P 2**



**EOG RESOURCES, INC.**  
**LION CREEK #07-24H**  
**LOCATED IN WELD COUNTY, COLORADO**  
**SECTION 24, T11N, R64W, 6th P.M.**

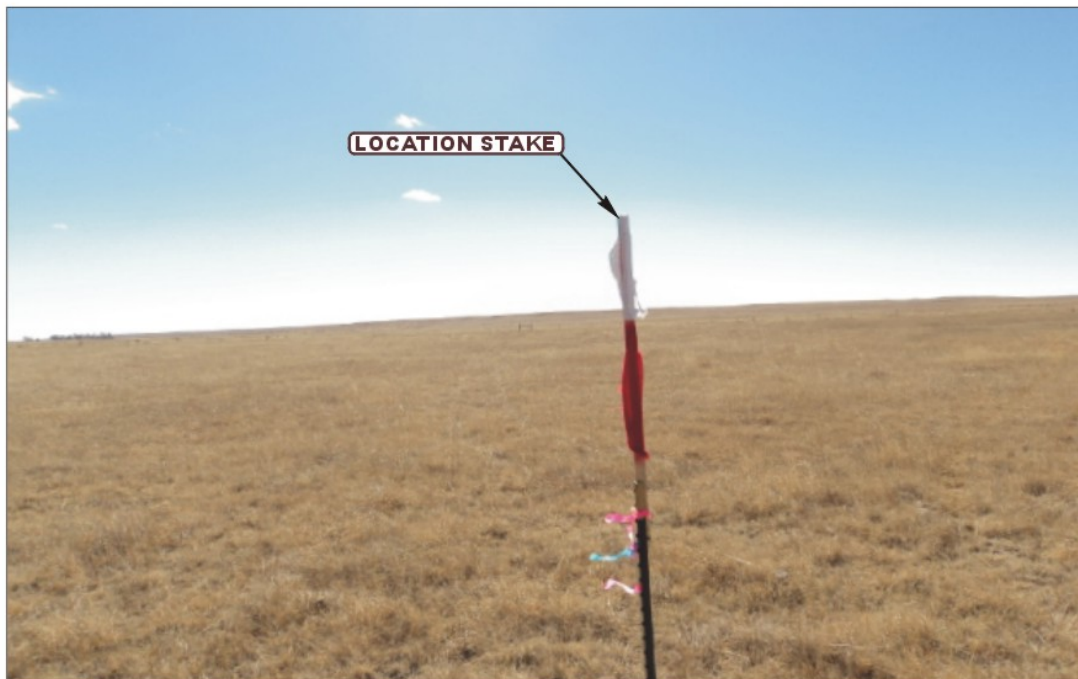

PHOTO: VIEW OF LOCATION STAKE

CAMERA ANGLE: SOUTHERLY



PHOTO: VIEW OF LOCATION STAKE

CAMERA ANGLE: WESTERLY



Uintah Engineering & Land Surveying  
85 South 200 East Vernal, Utah 84078  
435-789-1017 FAX (435) 789-1813

**LOCATION  
PHOTOS**

**11** **04** **10**  
MONTH DAY YEAR

TAKEN BY: G.M.

DRAWN BY: Z.L.

REVISED: 00-00-00

PHOTO  
**P 3**