



# KERR MCGEE

Location: COLORADO Slot: SLOT#17 NRC 16-9 (1086°FSL & 1501°FEL)  
Field: WELD COUNTY (KERR MCGEE) Well: NRC 16-9  
Facility: SEC.09-T1N-R67W Wellbore: NRC 16-9 PWB



Plot reference wellpath is NRC 16-9 (REV-A.0) PWP	
True vertical depths are referenced to XTREME 12 (RT)	Grid System: NAD83 / Lambert Colorado State Planes, Northern Zone (501), US feet
Measured depths are referenced to XTREME 12 (RT)	North Reference: True north
XTREME 12 (RT) to Mean Sea Level: 5040 feet	Scale: True distance
Mean Sea Level to Mud line (Facility: SEC.09-T1N-R67W): 0 feet	Depths are in feet
Coordinates are in feet referenced to Slot	Created by: Hegghad on 9/26/2019

Well Profile Data							
Design Comment	MD (ft)	Inc (°)	Az (°)	TVD (ft)	Local N (ft)	Local E (ft)	DLS (°100ft)
Tie On	15.00	0.000	116.894	15.00	0.00	0.00	0.00
End of Tangent	300.00	0.000	116.894	300.00	0.00	0.00	0.00
End of Build	700.00	6.000	116.894	699.27	-9.47	18.66	1.50
End of Tangent	1085.00	6.000	116.894	1082.16	-27.67	54.55	0.00
End of Build (S)	1551.67	13.000	116.894	1542.14	-62.49	123.20	1.50
End of Tangent (S)	4690.92	13.000	116.894	4600.93	-381.92	753.00	0.00
Drop (S)	5557.59	0.000	116.894	5460.18	-426.21	840.31	1.50
End of Tangent	8602.40	0.000	116.894	8505.00	-426.21	840.31	0.00

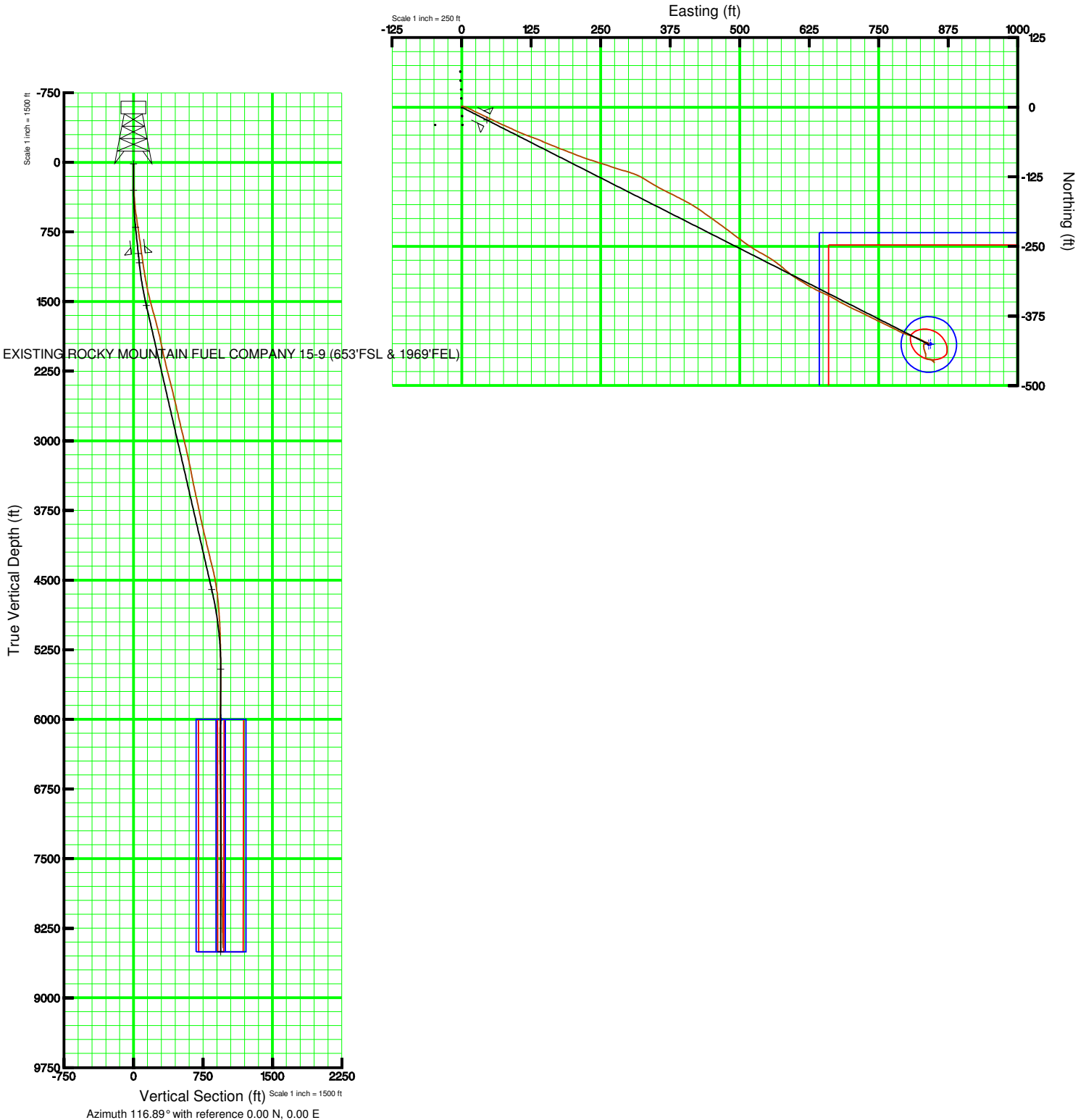

# Actual Wellpath Report

NRC 16-9 AWB\_AWP

Page 1 of 4

**INTEQ**

REFERENCE WELLPATH IDENTIFICATION			
Operator	KERR MCGEE	Slot	SLOT#17 NRC 16-9 (1086'FSL & 1501'FEL)
Area	COLORADO	Well	NRC 16-9
Field	WELD COUNTY (KERR MCGEE)	Wellbore	NRC 16-9 AWB
Facility	SEC.09-T1N-R67W		

REPORT SETUP INFORMATION			
Projection System	NAD83 / Lambert Colorado State Planes, Northern Zone (501), US feet	Software System	WellArchitect® 2.0
North Reference	True	User	Leigshad
Scale	0.999962	Report Generated	9/27/2010 at 10:17:11 AM
Convergence at slot	0.39° East	Database/Source file	WellArchitectDB/NRC_16-9_AWB.xml

WELLPATH LOCATION						
	Local coordinates		Grid coordinates		Geographic coordinates	
	North[ft]	East[ft]	Easting[USft]	Northing[USft]	Latitude	Longitude
Slot Location	-2530.00	185.58	3170269.19	1265743.08	40°03'40.504"N	104°53'30.041"W
Facility Reference Pt			3170066.29	1268271.65	40°04'05.506"N	104°53'32.428"W
Field Reference Pt			3197771.84	1268891.29	40°04'09.600"N	104°47'36.000"W

WELLPATH DATUM			
Calculation method	Minimum curvature	XTREME 12 (RT) to Facility Vertical Datum	5040.00ft
Horizontal Reference Pt	Slot	XTREME 12 (RT) to Mean Sea Level	5040.00ft
Vertical Reference Pt	XTREME 12 (RT)	Facility Vertical Datum to Mud Line (Facility)	0.00ft
MD Reference Pt	XTREME 12 (RT)	Section Origin	N 0.00, E 0.00 ft
Field Vertical Reference	Mean Sea Level	Section Azimuth	116.89°

# Actual Wellpath Report

NRC 16-9 AWB\_AWP

Page 2 of 4

INTEQ

REFERENCE WELLPATH IDENTIFICATION			
Operator	KERR MCGEE	Slot	SLOT#17 NRC 16-9 (1086'FSL & 1501'FEL)
Area	COLORADO	Well	NRC 16-9
Field	WELD COUNTY (KERR MCGEE)	Wellbore	NRC 16-9 AWB
Facility	SEC.09-T1N-R67W		

WELLPATH DATA (85 stations) † = interpolated/extrapolated station							
MD [ft]	Inclination [°]	Azimuth [°]	TVD [ft]	Vert Sect [ft]	North [ft]	East [ft]	DLS [°/100ft]
0.00†	0.000	358.800	0.00	0.00	0.00	0.00	0.00
15.00	0.000	358.800	15.00	0.00	0.00	0.00	0.00
149.00	1.100	358.800	148.99	-0.61	1.29	-0.03	0.82
241.00	1.100	95.500	240.98	-0.20	2.08	0.83	1.79
333.00	3.800	108.100	332.89	3.64	1.05	4.61	2.98
425.00	5.200	113.100	424.60	10.81	-1.53	11.34	1.58
516.00	7.100	117.900	515.08	20.55	-5.78	20.11	2.16
607.00	8.200	115.900	605.27	32.66	-11.25	30.92	1.24
698.00	8.400	114.800	695.31	45.79	-16.87	42.79	0.28
789.00	8.300	116.200	785.35	59.00	-22.56	54.72	0.25
880.00	8.200	114.800	875.41	72.05	-28.18	66.50	0.25
975.00	8.100	113.400	969.45	85.51	-33.68	78.79	0.23
1052.00	7.100	114.800	1045.77	95.68	-37.83	88.09	1.32
1143.00	9.200	115.500	1135.84	108.57	-43.32	99.76	2.31
1234.00	9.600	110.300	1225.62	123.38	-49.09	113.45	1.03
1325.00	10.600	109.600	1315.21	139.22	-54.53	128.45	1.11
1416.00	12.600	114.100	1404.35	157.44	-61.39	145.40	2.41
1506.00	14.900	111.700	1491.77	178.77	-69.68	165.11	2.63
1597.00	16.100	110.600	1579.46	202.96	-78.44	187.79	1.36
1688.00	15.100	111.700	1667.10	227.31	-87.26	210.62	1.15
1779.00	14.800	107.100	1755.03	250.57	-95.06	232.74	1.34
1869.00	14.500	107.800	1842.10	273.02	-101.89	254.45	0.39
1960.00	11.900	109.900	1930.69	293.59	-108.57	274.13	2.90
2050.00	11.900	104.300	2018.76	311.85	-114.02	291.84	1.28
2142.00	13.500	111.000	2108.51	331.80	-120.21	311.06	2.36
2232.00	13.400	121.500	2196.05	352.64	-129.42	329.77	2.71
2323.00	14.500	120.800	2284.37	374.52	-140.77	348.54	1.22
2414.00	13.800	115.900	2372.61	396.74	-151.34	368.09	1.52
2505.00	14.700	117.300	2460.81	419.14	-161.38	388.12	1.06
2596.00	13.400	118.000	2549.09	441.23	-171.62	407.69	1.44
2686.00	13.200	125.000	2636.68	461.83	-182.41	425.31	1.80
2777.00	13.200	125.000	2725.27	482.40	-194.33	442.33	0.00
2868.00	13.300	126.400	2813.85	503.01	-206.50	459.27	0.37
2959.00	13.500	126.400	2902.37	523.81	-219.02	476.25	0.22
3049.00	13.900	127.100	2989.81	544.81	-231.77	493.32	0.48
3140.00	13.500	126.100	3078.22	566.05	-244.63	510.62	0.51
3231.00	12.300	120.800	3166.93	586.21	-255.85	527.53	1.85
3322.00	12.100	118.000	3255.87	605.41	-265.29	544.28	0.69
3413.00	11.200	124.300	3345.00	623.71	-274.75	560.00	1.71
3503.00	11.000	130.300	3433.32	640.74	-285.23	573.77	1.30
3594.00	12.700	129.200	3522.38	658.96	-297.16	588.15	1.88
3685.00	12.300	121.900	3611.23	678.39	-308.61	604.13	1.79
3776.00	11.900	121.100	3700.20	697.40	-318.58	620.39	0.48
3867.00	12.400	116.200	3789.17	716.53	-327.74	637.19	1.26
3958.00	12.300	114.100	3878.06	735.98	-336.01	654.81	0.51

# Actual Wellpath Report

NRC 16-9 AWB\_AWP

Page 3 of 4

INTEQ

REFERENCE WELLPATH IDENTIFICATION			
Operator	KERR MCGEE	Slot	SLOT#17 NRC 16-9 (1086'FSL & 1501'FEL)
Area	COLORADO	Well	NRC 16-9
Field	WELD COUNTY (KERR MCGEE)	Wellbore	NRC 16-9 AWB
Facility	SEC.09-T1N-R67W		

WELLPATH DATA (85 stations)							
MD [ft]	Inclination [°]	Azimuth [°]	TVD [ft]	Vert Sect [ft]	North [ft]	East [ft]	DLS [°/100ft]
4048.00	12.500	120.800	3965.97	755.27	-344.91	671.92	1.61
4139.00	14.000	117.300	4054.54	776.10	-355.00	690.17	1.87
4230.00	13.600	115.200	4142.92	797.81	-364.61	709.63	0.70
4321.00	13.600	116.600	4231.37	819.20	-373.95	728.88	0.36
4412.00	13.600	116.000	4319.82	840.60	-383.43	748.06	0.16
4502.00	14.000	115.500	4407.22	862.06	-392.76	767.40	0.46
4593.00	9.600	118.700	4496.27	880.66	-401.15	783.99	4.89
4684.00	9.100	109.200	4586.07	895.37	-407.16	797.45	1.78
4775.00	6.100	108.500	4676.26	907.29	-411.06	808.83	3.30
4865.00	5.200	109.600	4765.82	916.07	-413.95	817.21	1.01
4956.00	4.000	114.800	4856.53	923.33	-416.66	823.97	1.39
5047.00	3.900	119.400	4947.31	929.59	-419.51	829.55	0.37
5138.00	1.800	113.400	5038.19	934.11	-421.60	833.56	2.33
5229.00	1.200	106.400	5129.16	936.48	-422.43	835.79	0.69
5318.00	1.000	118.100	5218.15	938.17	-423.06	837.36	0.34
5410.00	0.900	121.500	5310.13	939.69	-423.82	838.69	0.12
5546.00	0.300	127.100	5446.13	941.11	-424.59	839.88	0.44
5682.00	0.400	264.200	5582.12	941.06	-424.85	839.70	0.48
5818.00	0.700	269.500	5718.12	939.92	-424.91	838.39	0.22
5954.00	1.100	313.800	5854.10	937.93	-424.01	836.62	0.57
6090.00	0.900	246.700	5990.09	936.00	-423.53	834.70	0.82
6227.00	0.600	258.600	6127.07	934.75	-424.10	833.00	0.25
6363.00	0.600	205.200	6263.07	934.21	-424.88	832.00	0.40
6499.00	1.000	195.300	6399.05	934.47	-426.67	831.39	0.31
6635.00	1.600	177.400	6535.02	935.64	-429.72	831.16	0.53
6771.00	1.500	169.000	6670.97	937.67	-433.36	831.59	0.18
6907.00	1.900	162.600	6806.91	940.34	-437.26	832.60	0.33
7043.00	1.600	158.400	6942.85	943.34	-441.17	833.97	0.24
7179.00	1.000	184.100	7078.81	945.22	-444.12	834.59	0.60
7316.00	1.000	172.800	7215.79	946.35	-446.50	834.65	0.14
7452.00	1.400	182.000	7351.76	947.72	-449.34	834.74	0.33
7588.00	0.900	118.700	7487.74	949.48	-451.51	835.62	0.94
7724.00	1.400	94.400	7623.71	952.09	-452.15	838.21	0.51
7860.00	1.100	104.000	7759.68	954.89	-452.60	841.14	0.27
7997.00	0.900	103.900	7896.66	957.22	-453.17	843.46	0.15
8133.00	0.700	117.300	8032.64	959.09	-453.81	845.23	0.20
8269.00	0.700	122.900	8168.63	960.75	-454.64	846.67	0.05
8405.00	1.000	137.000	8304.62	962.69	-455.96	848.18	0.27
8515.00	1.700	148.900	8414.59	964.98	-458.06	849.67	0.68
8565.00	1.700	148.900	8464.57	966.23	-459.33	850.44	0.00

# Actual Wellpath Report

NRC 16-9 AWB\_AWP

Page 4 of 4

INTEQ

REFERENCE WELLPATH IDENTIFICATION			
Operator	KERR MCGEE	Slot	SLOT#17 NRC 16-9 (1086'FSL & 1501'FEL)
Area	COLORADO	Well	NRC 16-9
Field	WELD COUNTY (KERR MCGEE)	Wellbore	NRC 16-9 AWB
Facility	SEC.09-T1N-R67W		

TARGETS									
Name	MD [ft]	TVD [ft]	North [ft]	East [ft]	Grid East [srv ft]	Grid North [srv ft]	Latitude	Longitude	Shape
NRC 16-9 GEO TARGET 50' RADIUS (660'FSL & 660'FEL, REV-1)		6000.00	-426.21	840.31	3171112.38	1265322.66	40°03'36.292"N	104°53'19.234"W	circle
NRC 16-9 LEGAL BOX (199'S, 201'N, 197'W,203'E)		6000.00	-425.21	843.31	3171115.37	1265323.68	40°03'36.301"N	104°53'19.195"W	square

WELLPATH COMPOSITION					Ref Wellbore: NRC 16-9 AWB	Ref Wellpath: NRC 16-9 AWB_AWP
Start MD [ft]	End MD [ft]	Positional Uncertainty Model		Log Name/Comment		Wellbore
15.00	975.00	NaviTrak (Standard)		12 1/4 Surface Section		NRC 16-9 AWB
975.00	8515.00	NaviTrak (Standard)		6 3/4 Production section		NRC 16-9 AWB
8515.00	8565.00	Blind Drilling (std)		Projection to bit		NRC 16-9 AWB