

RICHTER USX AB27-05

Steil Surveying Services, LLC

1102 West 19th Street P.O. BOX 2073

Cheyenne, Wyoming 82009

LOCATION DRAWING

DATE: 09/23/2010

THIS MAP DOES NOT REPRESENT A BOUNDARY SURVEY

SECTION 27
TOWNSHIP 7 NORTH
RANGE 64 WEST

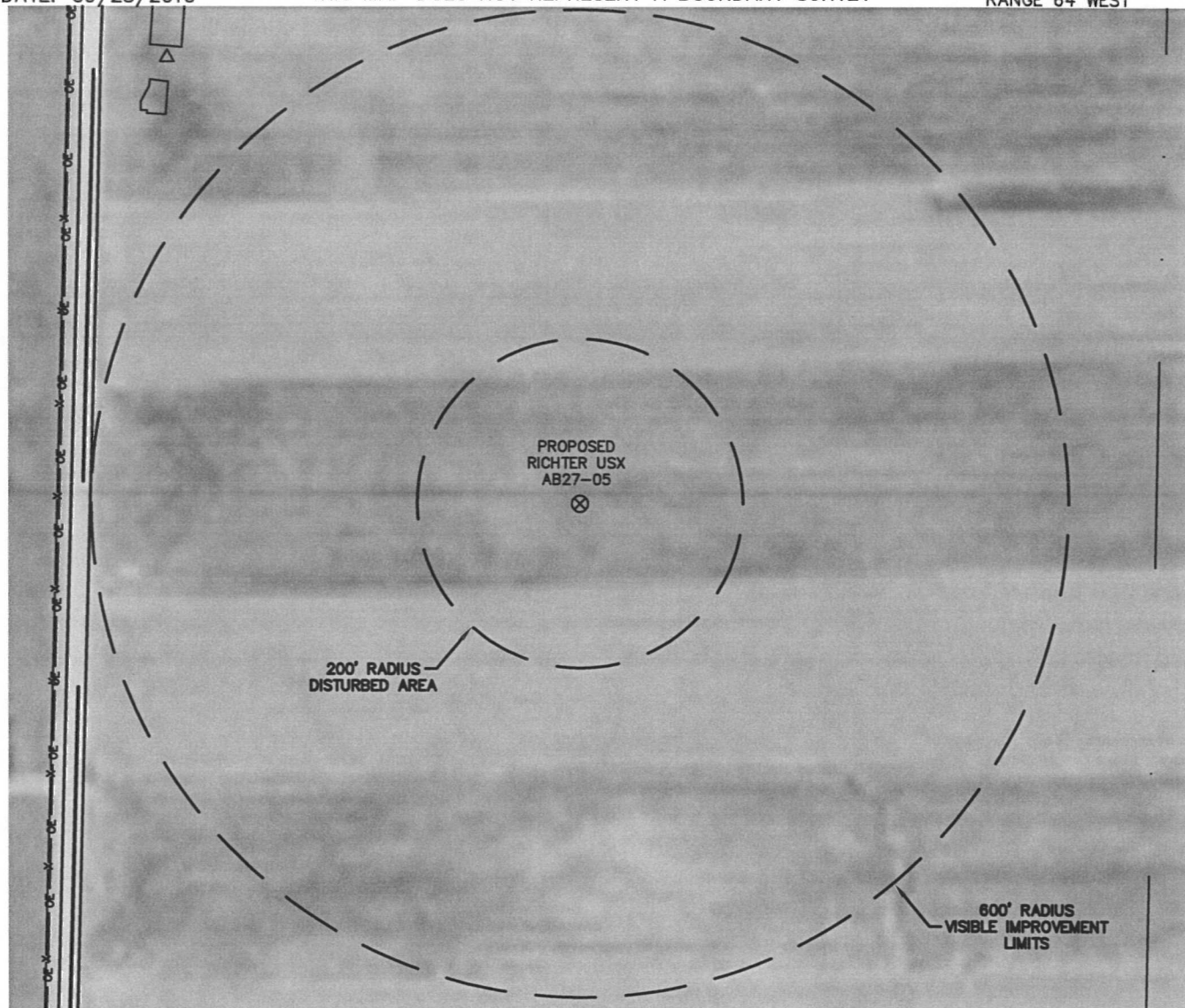

NEW WELL DATA

ELEV = 4903', PDOP: 2.0

SW $\frac{1}{4}$ NW $\frac{1}{4}$ SEC 27

1980' FNL, 610' FWL

LAT: N 40.54600

LONG: W 104.54322

NEAREST PROP LINE: 610' WEST

NEAREST RAILROAD: MORE THAN ONE MILE AWAY

NEAREST BUILDING: 730'+/- SOUTHWEST

THE EAST EDGE OF GRAVEL COUNTY ROAD

NO. 55: 601' WEST

THERE ARE NO VISIBLE IMPROVEMENTS WITHIN 600'.

THE NEAREST OVERHEAD POWER LINE IS 640' WEST.

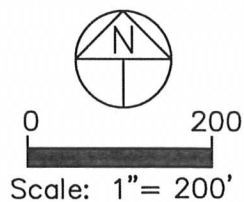

NOTICE: According to Colorado law you MUST commence any legal action based upon any defect in this W.L.C. within three years after you first discover such defect. In no event may any action based upon any defect in this W.L.C. be commenced more than ten years from this sold date of the certification shown hereon.