

Location Drawing

Steil Surveying Services, LLC

1102 West 19th Street P.O. BOX 2073

Cheyenne, Wyoming 82009

VISIBLE IMPROVEMENTS

DATE: 07/07/2010

THIS MAP DOES NOT REPRESENT A BOUNDARY SURVEY

SECTION 9
TOWNSHIP 6 NORTH
RANGE 63 WEST

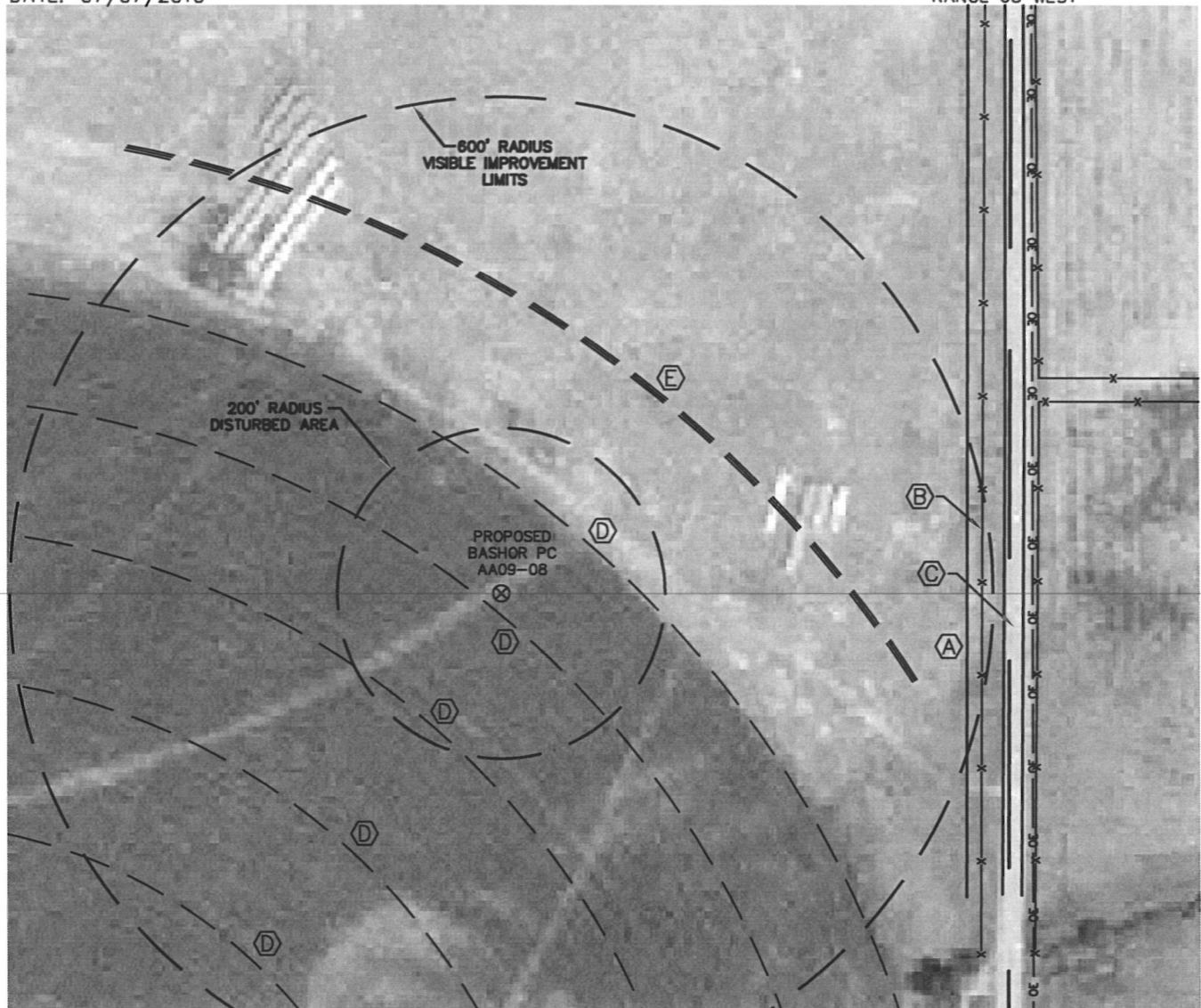

IMPROVEMENTS:

- (A) BURIED GAS LINE - 568' EAST
- (B) FENCE LINES - 587' EAST
- (C) GRAVEL COUNTY ROAD NO. 67 - 613' EAST
- (D) IRRIGATION WHEEL TRACKS - 21', 178', 357' & 536' SOUTHWEST
IRRIGATION WHEEL TRACKS - 114', 304', 307' & 310' NORTHEAST

THE NEAREST OVERHEAD POWER LINE IS 648' EAST.

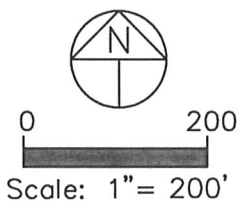

NOTICE: According to Colorado law you MUST commence any legal action based upon any defect in this W.L.C. within three years after you first discover such defect. In no event may any action based upon any defect in this W.L.C. be commenced more than ten years from this sold date of the certification shown hereon.