

EOG RESOURCES, INC.  
LION CREEK #02-13H  
SECTION 13, T11N, R64W, 6th P.M.

PROCEED IN A WESTERLY DIRECTION FROM HEREFORD, COLORADO ALONG COUNTY ROAD 136 APPROXIMATELY 1.5 MILES TO THE JUNCTION OF COUNTY ROAD 136 AND HIGHWAY 77 TO THE SOUTH; TURN LEFT AND PROCEED IN A SOUTHERLY DIRECTION APPROXIMATELY 2.0 MILES TO THE JUNCTION OF COUNTY ROAD 77 AND COUNTY ROAD 132 TO THE WEST; TURN RIGHT AND PROCEED IN A WESTERLY DIRECTION APPROXIMATELY 5.0 MILES TO THE JUNCTION OF COUNTY ROAD 132 AND COUNTY ROAD 67 TO THE SOUTH; TURN LEFT AND PROCEED IN A SOUTHERLY DIRECTION APPROXIMATELY 2.0 MILES TO THE JUNCTION OF COUNTY ROAD 67 AND COUNTY ROAD 128 TO THE WEST; TURN RIGHT AND PROCEED IN A WESTERLY DIRECTION APPROXIMATELY 3.0 MILES TO THE BEGINNING OF THE PROPOSED ACCESS ROAD TO THE NORTH; FOLLOW ROAD FLAGS IN A NORTHERLY DIRECTION APPROXIMATELY 300' TO THE PROPOSED LOCATION.

TOTAL DISTANCE FROM HEREFORD, COLORADO TO THE PROPOSED LOCATION IS APPROXIMATELY 13.5 MILES.

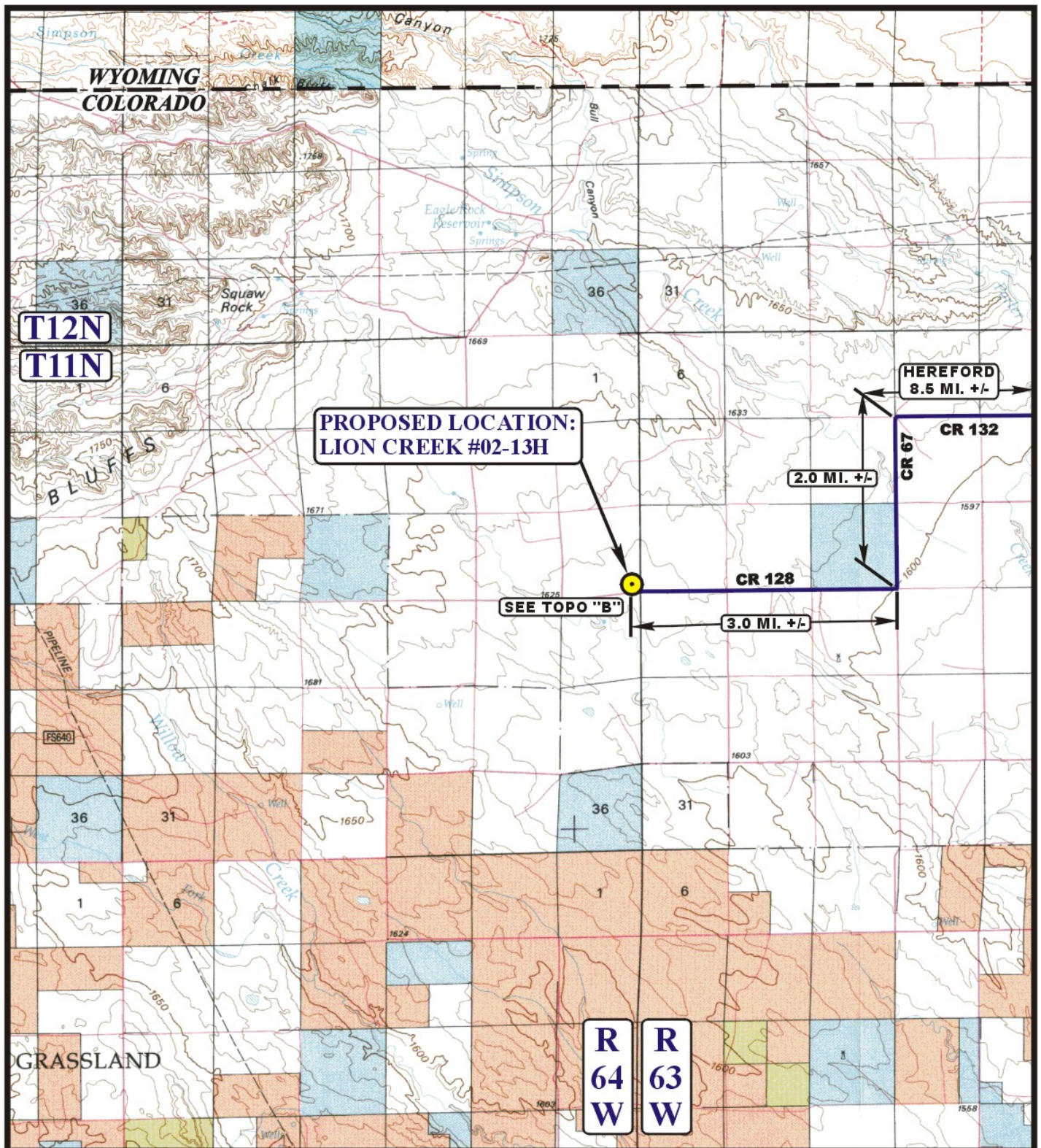

LEGEND:

● PROPOSED LOCATION



EOG RESOURCES, INC.

LION CREEK #02-13H  
SECTION 13, T11N, R64W, 6th P.M.  
501' FSL 501' FEL



Uintah Engineering & Land Surveying  
85 South 200 East Vernal, Utah 84078  
(435) 789-1017 \* FAX (435) 789-1813

ACCESS ROAD  
MAP

05 13 10  
MONTH DAY YEAR

SCALE: 1:100,000

DRAWN BY: Z.L.

REVISED: 00-00-00





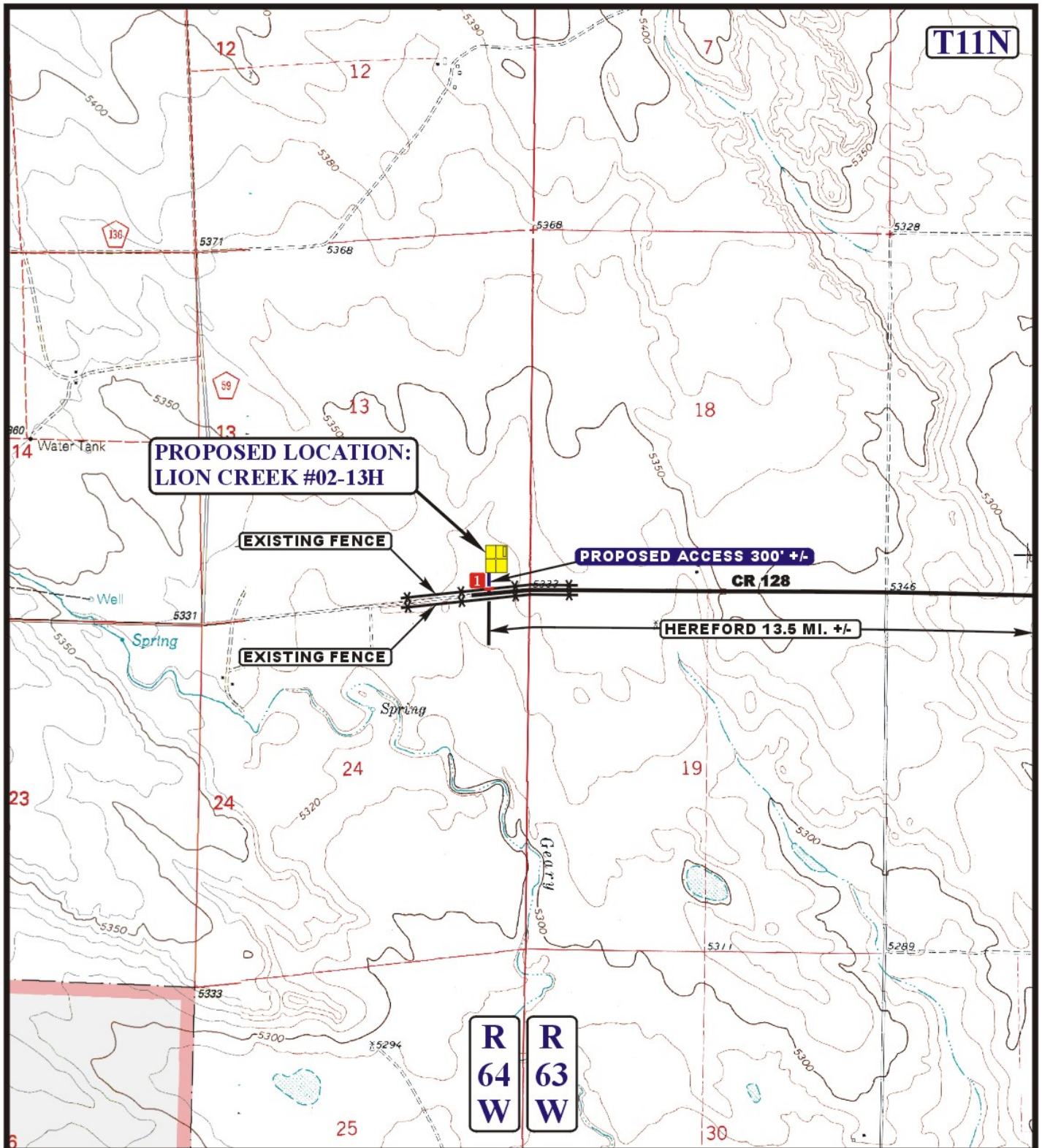

# **LEGEND:**

- EXISTING ROAD
- PROPOSED ACCESS ROAD
- EXISTING FENCE
- INSTALL CATTLE GUARD

**EOG RESOURCES, INC.**

**LION CREEK #02-13H**  
**SECTION 13, T11N, R64W, 6th P.M.**  
**501' FSL 501' FEL**



Uintah Engineering & Land Surveying  
 85 South 200 East Vernal, Utah 84078  
 (435) 789-1017 \* FAX (435) 789-1813



**ACCESS ROAD  
MAP**

**05 13 10**  
 MONTH DAY YEAR

SCALE: 1" = 2000'

DRAWN BY: Z.L.

REVISED: 00-00-00

**B**  
 TOPO