

EOG RESOURCES, INC.
LION CREEK #02-13H
LOCATED IN WELD COUNTY, COLORADO
SECTION 13, T11N, R64W, 6th P.M.

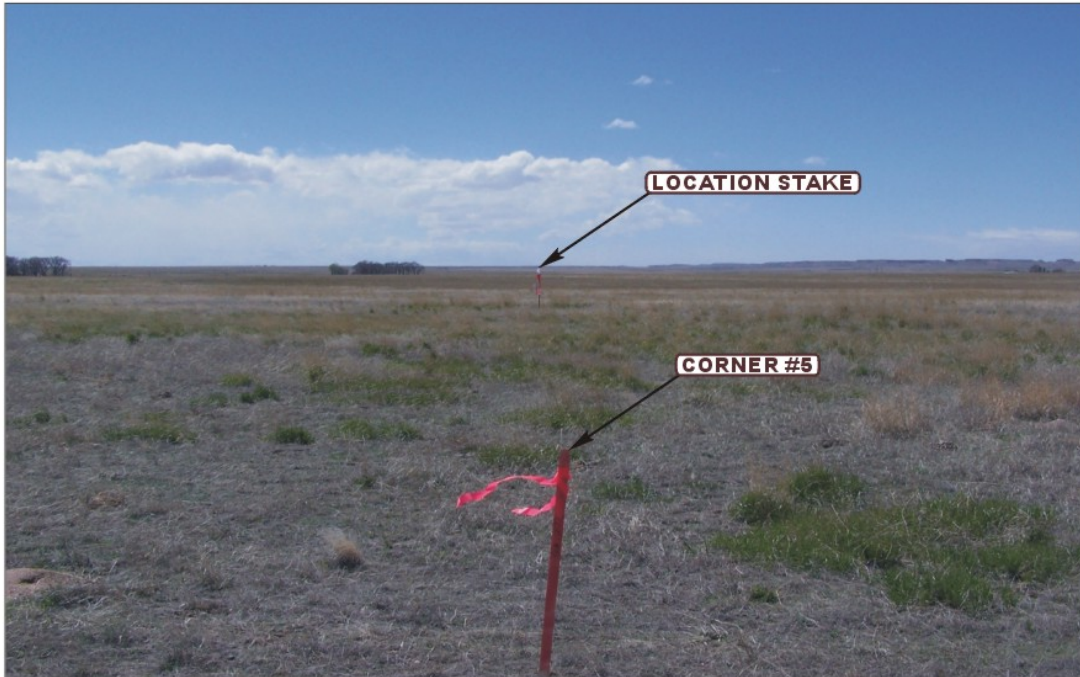

PHOTO: VIEW FROM CORNER #5 TO LOCATION STAKE

CAMERA ANGLE: WESTERLY



PHOTO: VIEW FROM BEGINNING OF PROPOSED ACCESS

CAMERA ANGLE: NORTHERLY



- Since 1964 -



Uintah Engineering & Land Surveying

85 South 200 East Vernal, Utah 84078
435-789-1017 FAX (435) 789-1813

**LOCATION
PHOTOS**

05 **13** **10**
MONTH DAY YEAR

TAKEN BY: B.H.

DRAWN BY: Z.L.

REVISED: 00-00-00

PHOTO
P 1

EOG RESOURCES, INC.
LION CREEK #02-13H
LOCATED IN WELD COUNTY, COLORADO
SECTION 13, T11N, R64W, 6th P.M.



PHOTO: VIEW OF LOCATION STAKE

CAMERA ANGLE: NORTHERLY



PHOTO: VIEW OF LOCATION STAKE

CAMERA ANGLE: EASTERLY



- Since 1964 -



Uintah Engineering & Land Surveying
85 South 200 East Vernal, Utah 84078
435-789-1017 FAX (435) 789-1813

**LOCATION
PHOTOS**

05 **13** **10**
MONTH DAY YEAR

TAKEN BY: B.H. DRAWN BY: Z.L. REVISED: 00-00-00

PHOTO
P 2

EOG RESOURCES, INC.
LION CREEK #02-13H
LOCATED IN WELD COUNTY, COLORADO
SECTION 13, T11N, R64W, 6th P.M.



PHOTO: VIEW OF LOCATION STAKE

CAMERA ANGLE: SOUTHERLY



PHOTO: VIEW OF LOCATION STAKE

CAMERA ANGLE: WESTERLY



- Since 1964 -

UELS Uintah Engineering & Land Surveying
85 South 200 East Vernal, Utah 84078
435-789-1017 FAX (435) 789-1813

**LOCATION
PHOTOS**

05 **13** **10**
MONTH DAY YEAR

TAKEN BY: B.H.

DRAWN BY: Z.L.

REVISED: 00-00-00

PHOTO
P 3