

Critter Creek 25-30H
Sec. 30-T11N-R63W
Weld County,CO

Surface Location

NAD 1927 (NADCON CONUS) Colorado North 501
Ground Elevation: 5263.00 Rig @ 5285.00ft (TBD)
Northing 567648.07 Easting 2285473.86 Latitude 40°53' 13.314 N Longitude 104°28' 3.303 W

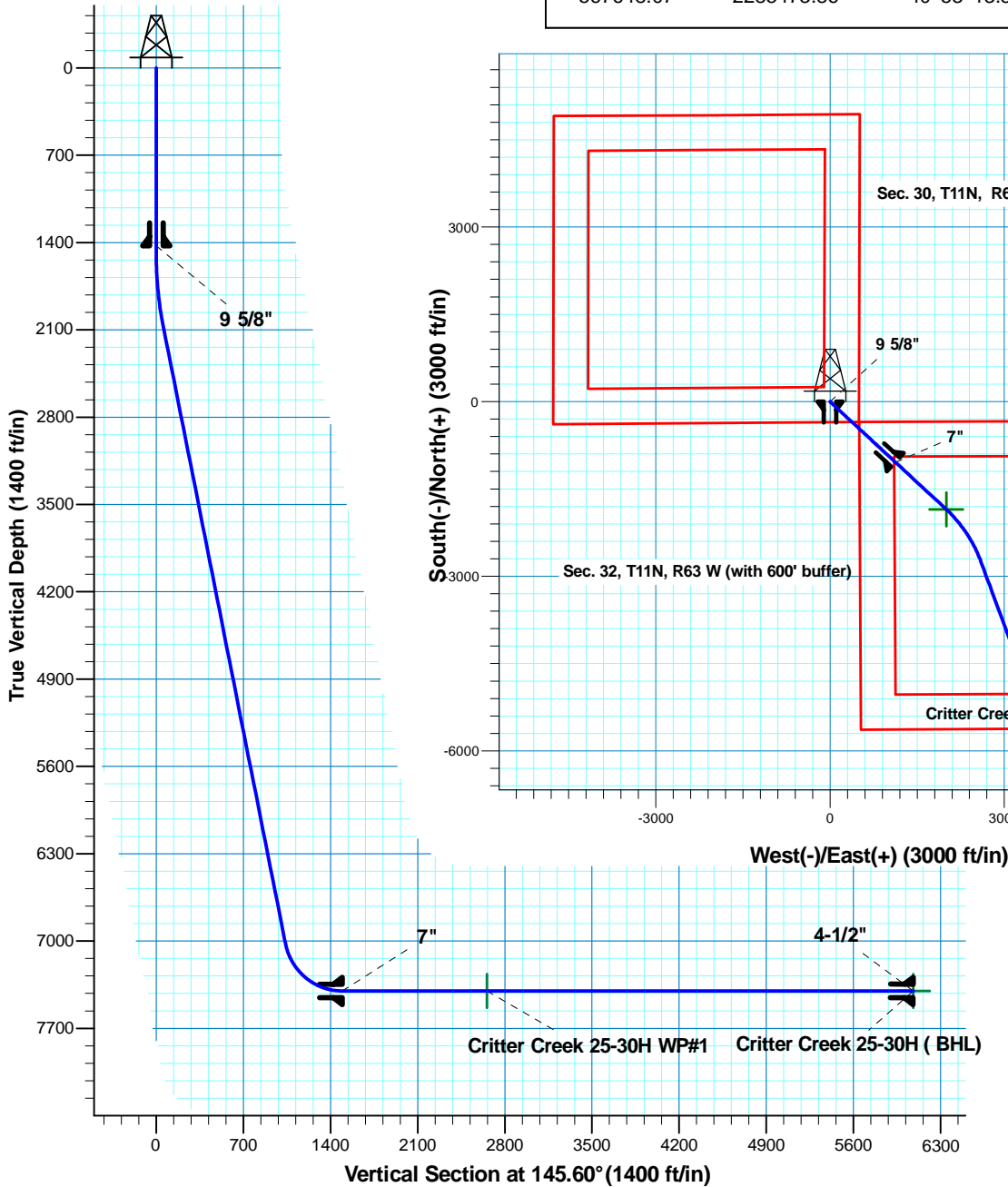

Project: DJ-Hereford Ranch
Site: Critter Creek 25-30H
Well: Critter Creek 25-30H
Plan: APD Directional Plan



Azimuths to True North
Magnetic North: 8.79°
Magnetic Field
Strength: 53500.0snT
Dip Angle: 67.52°
Date: 10/25/2010
Model: IGRF200510

SECTION DETAILS										
Sec	MD	Inc	Azi	TVD	+N/-S	+E/-W	Dleg	TFace	VSect	Target
1	0.00	0.00	0.00	0.00	0.00	0.00	0.00	0.00	0.00	
2	1500.00	0.00	0.00	1500.00	0.00	0.00	0.00	0.00	0.00	
3	2075.00	11.50	132.77	2071.15	-39.05	42.22	2.00	132.77	56.08	
4	7123.94	11.50	132.77	7018.73	-722.62	781.12	0.00	0.00	1037.57	
5	7778.10	90.00	132.77	7401.00	-1040.35	1124.57	12.00	0.00	1493.78	
6	8970.69	90.00	132.77	7401.00	-1850.21	2000.00	0.00	0.00	2656.62	Critter Creek 25-30H WP#1
7	10048.60	90.00	159.72	7401.00	-2738.19	2593.41	2.50	90.00	3724.55	
8	12477.62	90.00	159.71	7401.00	-5016.57	3435.50	0.00	-90.00	6080.18	Critter Creek 25-30H (BHL)
TARGET DETAILS										
Name	TVD	+N/-S	+E/-W	Northing	Easting	Latitude	Longitude	Shape		
Critter Creek 25-30H (BHL)	7401.00	-5016.57	3435.50	562671.85	2288967.52	40°52' 23.744 N	104°27' 18.585 W	Point		
Critter Creek 25-30H WP#1	7401.00	-1850.21	2000.00	565821.28	2287495.26	40°52' 55.032 N	104°27' 37.267 W	Point		

EOG Resources, Inc.

**DJ-Hereford Ranch
Crittter Creek 25-30H
Crittter Creek 25-30H**

Original Wellbore

Plan: APD Directional Plan

Standard Planning Report

26 October, 2010

Halliburton Company

Planning Report

Database:	EOG Database	Local Co-ordinate Reference:	Well Critter Creek 25-30H
Company:	EOG Resources, Inc.	TVD Reference:	Rig @ 5285.00ft (TBD)
Project:	DJ-Hereford Ranch	MD Reference:	Rig @ 5285.00ft (TBD)
Site:	Critter Creek 25-30H	North Reference:	True
Well:	Critter Creek 25-30H	Survey Calculation Method:	Minimum Curvature
Wellbore:	Original Wellbore		
Design:	APD Directional Plan		

Project	DJ-Hereford Ranch		
Map System:	US State Plane 1927 (Exact solution)	System Datum:	Mean Sea Level
Geo Datum:	NAD 1927 (NADCON CONUS)		
Map Zone:	Colorado North 501		

Site		Critter Creek 25-30H, Section 30, T11N, R63W			
Site Position:		Northing:	567,648.08 usft	Latitude:	40° 53' 13.314 N
From:	Map	Easting:	2,285,473.86 usft	Longitude:	104° 28' 3.303 W
Position Uncertainty:	0.00 ft	Slot Radius:	13.200 in	Grid Convergence:	0.67 °

Well	Critter Creek 25-30H					
Well Position	+N/-S	0.00 ft	Northing:	567,648.08 usft	Latitude:	40° 53' 13.314 N
	+E/-W	0.00 ft	Easting:	2,285,473.86 usft	Longitude:	104° 28' 3.303 W
Position Uncertainty		0.00 ft	Wellhead Elevation:		Ground Level:	5,263.00 ft

Wellbore	Original Wellbore				
Magnetics	Model Name	Sample Date	Declination (°)	Dip Angle (°)	Field Strength (nT)
	IGRF200510	10/25/2010	8.79	67.52	53,500

Design	APD Directional Plan				
Audit Notes:					
Version:	1.0	Phase:	PLAN	Tie On Depth:	0.00
Vertical Section:	Depth From (TVD)	+N/-S	+E/-W	Direction	
	(ft)	(ft)	(ft)	(°)	
	0.00	0.00	0.00	145.60	

Plan Sections										
Measured Depth (ft)	Inclination (°)	Azimuth (°)	Vertical Depth (ft)	+N/-S (ft)	+E/-W (ft)	Dogleg Rate (°/100ft)	Build Rate (°/100ft)	Turn Rate (°/100ft)	TFO (°)	Target
0.00	0.00	0.00	0.00	0.00	0.00	0.00	0.00	0.00	0.00	
1,500.00	0.00	0.00	1,500.00	0.00	0.00	0.00	0.00	0.00	0.00	
2,075.00	11.50	132.77	2,071.15	-39.05	42.22	2.00	2.00	0.00	132.77	
7,123.94	11.50	132.77	7,018.73	-722.62	781.12	0.00	0.00	0.00	0.00	
7,778.11	90.00	132.77	7,401.00	-1,040.35	1,124.57	12.00	12.00	0.00	0.00	
8,970.69	90.00	132.77	7,401.00	-1,850.21	2,000.00	0.00	0.00	0.00	0.00	Critter Creek 25-30H '
10,048.60	90.00	159.72	7,401.00	-2,738.19	2,593.41	2.50	0.00	2.50	90.00	
12,477.62	90.00	159.71	7,401.00	-5,016.57	3,435.50	0.00	0.00	0.00	-90.00	Critter Creek 25-30H '

Halliburton Company

Planning Report

Database:	EOG Database	Local Co-ordinate Reference:	Well Critter Creek 25-30H
Company:	EOG Resources, Inc.	TVD Reference:	Rig @ 5285.00ft (TBD)
Project:	DJ-Hereford Ranch	MD Reference:	Rig @ 5285.00ft (TBD)
Site:	Critter Creek 25-30H	North Reference:	True
Well:	Critter Creek 25-30H	Survey Calculation Method:	Minimum Curvature
Wellbore:	Original Wellbore		
Design:	APD Directional Plan		

Planned Survey									
Measured Depth (ft)	Inclination (°)	Azimuth (°)	Vertical Depth (ft)	+N/-S (ft)	+E/-W (ft)	Vertical Section (ft)	Dogleg Rate (°/100ft)	Build Rate (°/100ft)	Turn Rate (°/100ft)
0.00	0.00	0.00	0.00	0.00	0.00	0.00	0.00	0.00	0.00
100.00	0.00	0.00	100.00	0.00	0.00	0.00	0.00	0.00	0.00
200.00	0.00	0.00	200.00	0.00	0.00	0.00	0.00	0.00	0.00
300.00	0.00	0.00	300.00	0.00	0.00	0.00	0.00	0.00	0.00
400.00	0.00	0.00	400.00	0.00	0.00	0.00	0.00	0.00	0.00
500.00	0.00	0.00	500.00	0.00	0.00	0.00	0.00	0.00	0.00
600.00	0.00	0.00	600.00	0.00	0.00	0.00	0.00	0.00	0.00
700.00	0.00	0.00	700.00	0.00	0.00	0.00	0.00	0.00	0.00
800.00	0.00	0.00	800.00	0.00	0.00	0.00	0.00	0.00	0.00
900.00	0.00	0.00	900.00	0.00	0.00	0.00	0.00	0.00	0.00
1,000.00	0.00	0.00	1,000.00	0.00	0.00	0.00	0.00	0.00	0.00
1,100.00	0.00	0.00	1,100.00	0.00	0.00	0.00	0.00	0.00	0.00
1,200.00	0.00	0.00	1,200.00	0.00	0.00	0.00	0.00	0.00	0.00
1,300.00	0.00	0.00	1,300.00	0.00	0.00	0.00	0.00	0.00	0.00
1,400.00	0.00	0.00	1,400.00	0.00	0.00	0.00	0.00	0.00	0.00
1,425.00	0.00	0.00	1,425.00	0.00	0.00	0.00	0.00	0.00	0.00
9 5/8"									
1,500.00	0.00	0.00	1,500.00	0.00	0.00	0.00	0.00	0.00	0.00
1,600.00	2.00	132.77	1,599.98	-1.19	1.28	1.70	2.00	2.00	0.00
1,700.00	4.00	132.77	1,699.84	-4.74	5.12	6.80	2.00	2.00	0.00
1,800.00	6.00	132.77	1,799.45	-10.66	11.52	15.30	2.00	2.00	0.00
1,900.00	8.00	132.77	1,898.70	-18.93	20.47	27.18	2.00	2.00	0.00
2,000.00	10.00	132.77	1,997.47	-29.55	31.95	42.44	2.00	2.00	0.00
2,075.00	11.50	132.77	2,071.15	-39.05	42.22	56.08	2.00	2.00	0.00
2,100.00	11.50	132.77	2,095.65	-42.44	45.88	60.94	0.00	0.00	0.00
2,200.00	11.50	132.77	2,193.64	-55.98	60.51	80.38	0.00	0.00	0.00
2,300.00	11.50	132.77	2,291.63	-69.51	75.15	99.82	0.00	0.00	0.00
2,400.00	11.50	132.77	2,389.62	-83.05	89.78	119.25	0.00	0.00	0.00
2,500.00	11.50	132.77	2,487.62	-96.59	104.42	138.69	0.00	0.00	0.00
2,600.00	11.50	132.77	2,585.61	-110.13	119.05	158.13	0.00	0.00	0.00
2,700.00	11.50	132.77	2,683.60	-123.67	133.69	177.57	0.00	0.00	0.00
2,800.00	11.50	132.77	2,781.59	-137.21	148.32	197.01	0.00	0.00	0.00
2,900.00	11.50	132.77	2,879.59	-150.74	162.96	216.45	0.00	0.00	0.00
3,000.00	11.50	132.77	2,977.58	-164.28	177.59	235.89	0.00	0.00	0.00
3,100.00	11.50	132.77	3,075.57	-177.82	192.23	255.33	0.00	0.00	0.00
3,200.00	11.50	132.77	3,173.56	-191.36	206.87	274.77	0.00	0.00	0.00
3,300.00	11.50	132.77	3,271.55	-204.90	221.50	294.21	0.00	0.00	0.00
3,400.00	11.50	132.77	3,369.55	-218.44	236.14	313.65	0.00	0.00	0.00
3,500.00	11.50	132.77	3,467.54	-231.97	250.77	333.09	0.00	0.00	0.00
3,600.00	11.50	132.77	3,565.53	-245.51	265.41	352.53	0.00	0.00	0.00
3,700.00	11.50	132.77	3,663.52	-259.05	280.04	371.97	0.00	0.00	0.00
3,800.00	11.50	132.77	3,761.52	-272.59	294.68	391.41	0.00	0.00	0.00
3,900.00	11.50	132.77	3,859.51	-286.13	309.31	410.85	0.00	0.00	0.00
4,000.00	11.50	132.77	3,957.50	-299.66	323.95	430.28	0.00	0.00	0.00
4,100.00	11.50	132.77	4,055.49	-313.20	338.58	449.72	0.00	0.00	0.00
4,200.00	11.50	132.77	4,153.49	-326.74	353.22	469.16	0.00	0.00	0.00
4,300.00	11.50	132.77	4,251.48	-340.28	367.85	488.60	0.00	0.00	0.00
4,400.00	11.50	132.77	4,349.47	-353.82	382.49	508.04	0.00	0.00	0.00
4,500.00	11.50	132.77	4,447.46	-367.36	397.12	527.48	0.00	0.00	0.00
4,600.00	11.50	132.77	4,545.46	-380.89	411.76	546.92	0.00	0.00	0.00
4,700.00	11.50	132.77	4,643.45	-394.43	426.40	566.36	0.00	0.00	0.00
4,800.00	11.50	132.77	4,741.44	-407.97	441.03	585.80	0.00	0.00	0.00
4,900.00	11.50	132.77	4,839.43	-421.51	455.67	605.24	0.00	0.00	0.00
5,000.00	11.50	132.77	4,937.43	-435.05	470.30	624.68	0.00	0.00	0.00

Halliburton Company

Planning Report

Database:	EOG Database	Local Co-ordinate Reference:	Well Critter Creek 25-30H
Company:	EOG Resources, Inc.	TVD Reference:	Rig @ 5285.00ft (TBD)
Project:	DJ-Hereford Ranch	MD Reference:	Rig @ 5285.00ft (TBD)
Site:	Critter Creek 25-30H	North Reference:	True
Well:	Critter Creek 25-30H	Survey Calculation Method:	Minimum Curvature
Wellbore:	Original Wellbore		
Design:	APD Directional Plan		

Planned Survey									
Measured Depth (ft)	Inclination (°)	Azimuth (°)	Vertical Depth (ft)	+N/-S (ft)	+E/-W (ft)	Vertical Section (ft)	Dogleg Rate (°/100ft)	Build Rate (°/100ft)	Turn Rate (°/100ft)
5,100.00	11.50	132.77	5,035.42	-448.58	484.94	644.12	0.00	0.00	0.00
5,200.00	11.50	132.77	5,133.41	-462.12	499.57	663.56	0.00	0.00	0.00
5,300.00	11.50	132.77	5,231.40	-475.66	514.21	683.00	0.00	0.00	0.00
5,400.00	11.50	132.77	5,329.40	-489.20	528.84	702.44	0.00	0.00	0.00
5,500.00	11.50	132.77	5,427.39	-502.74	543.48	721.88	0.00	0.00	0.00
5,600.00	11.50	132.77	5,525.38	-516.28	558.11	741.31	0.00	0.00	0.00
5,700.00	11.50	132.77	5,623.37	-529.81	572.75	760.75	0.00	0.00	0.00
5,800.00	11.50	132.77	5,721.37	-543.35	587.38	780.19	0.00	0.00	0.00
5,900.00	11.50	132.77	5,819.36	-556.89	602.02	799.63	0.00	0.00	0.00
6,000.00	11.50	132.77	5,917.35	-570.43	616.65	819.07	0.00	0.00	0.00
6,100.00	11.50	132.77	6,015.34	-583.97	631.29	838.51	0.00	0.00	0.00
6,200.00	11.50	132.77	6,113.34	-597.51	645.92	857.95	0.00	0.00	0.00
6,300.00	11.50	132.77	6,211.33	-611.04	660.56	877.39	0.00	0.00	0.00
6,400.00	11.50	132.77	6,309.32	-624.58	675.20	896.83	0.00	0.00	0.00
6,500.00	11.50	132.77	6,407.31	-638.12	689.83	916.27	0.00	0.00	0.00
6,600.00	11.50	132.77	6,505.31	-651.66	704.47	935.71	0.00	0.00	0.00
6,700.00	11.50	132.77	6,603.30	-665.20	719.10	955.15	0.00	0.00	0.00
6,800.00	11.50	132.77	6,701.29	-678.73	733.74	974.59	0.00	0.00	0.00
6,900.00	11.50	132.77	6,799.28	-692.27	748.37	994.03	0.00	0.00	0.00
7,000.00	11.50	132.77	6,897.28	-705.81	763.01	1,013.47	0.00	0.00	0.00
7,100.00	11.50	132.77	6,995.27	-719.35	777.64	1,032.91	0.00	0.00	0.00
7,123.94	11.50	132.77	7,018.73	-722.62	781.12	1,037.57	0.00	0.00	0.01
7,200.00	20.63	132.77	7,091.74	-736.89	796.55	1,058.07	12.00	12.00	0.00
7,300.00	32.63	132.77	7,180.97	-767.27	829.39	1,101.69	12.00	12.00	0.00
7,400.00	44.63	132.77	7,258.95	-809.59	875.13	1,162.45	12.00	12.00	0.00
7,500.00	56.63	132.77	7,322.27	-861.99	931.78	1,237.68	12.00	12.00	0.00
7,600.00	68.63	132.77	7,368.17	-922.18	996.84	1,324.11	12.00	12.00	0.00
7,700.00	80.63	132.77	7,394.63	-987.54	1,067.49	1,417.96	12.00	12.00	0.00
7,778.11	90.00	132.77	7,401.00	-1,040.35	1,124.57	1,493.78	12.00	12.00	0.00
7"									
7,800.00	90.00	132.77	7,401.00	-1,055.22	1,140.65	1,515.13	0.00	0.00	0.00
7,900.00	90.00	132.77	7,401.00	-1,123.12	1,214.05	1,612.63	0.00	0.00	0.00
8,000.00	90.00	132.77	7,401.00	-1,191.03	1,287.46	1,710.14	0.00	0.00	0.00
8,100.00	90.00	132.77	7,401.00	-1,258.94	1,360.86	1,807.64	0.00	0.00	0.00
8,200.00	90.00	132.77	7,401.00	-1,326.85	1,434.27	1,905.15	0.00	0.00	0.00
8,300.00	90.00	132.77	7,401.00	-1,394.76	1,507.68	2,002.66	0.00	0.00	0.00
8,400.00	90.00	132.77	7,401.00	-1,462.67	1,581.08	2,100.16	0.00	0.00	0.00
8,500.00	90.00	132.77	7,401.00	-1,530.57	1,654.49	2,197.67	0.00	0.00	0.00
8,600.00	90.00	132.77	7,401.00	-1,598.48	1,727.89	2,295.17	0.00	0.00	0.00
8,700.00	90.00	132.77	7,401.00	-1,666.39	1,801.30	2,392.68	0.00	0.00	0.00
8,800.00	90.00	132.77	7,401.00	-1,734.30	1,874.71	2,490.19	0.00	0.00	0.00
8,900.00	90.00	132.77	7,401.00	-1,802.21	1,948.11	2,587.69	0.00	0.00	0.00
8,970.69	90.00	132.77	7,401.00	-1,850.21	2,000.00	2,656.62	0.00	0.00	0.00
Critter Creek 25-30H WP#1									
9,000.00	90.00	133.50	7,401.00	-1,870.25	2,021.39	2,685.24	2.50	0.00	2.50
9,100.00	90.00	136.00	7,401.00	-1,940.66	2,092.40	2,783.45	2.50	0.00	2.50
9,200.00	90.00	138.50	7,401.00	-2,014.09	2,160.26	2,882.38	2.50	0.00	2.50
9,300.00	90.00	141.00	7,401.00	-2,090.41	2,224.87	2,981.85	2.50	0.00	2.50
9,400.00	90.00	143.50	7,401.00	-2,169.48	2,286.08	3,081.68	2.50	0.00	2.50
9,500.00	90.00	146.00	7,401.00	-2,251.14	2,343.78	3,181.66	2.50	0.00	2.50
9,600.00	90.00	148.50	7,401.00	-2,335.24	2,397.86	3,281.61	2.50	0.00	2.50
9,700.00	90.00	151.00	7,401.00	-2,421.62	2,448.23	3,381.34	2.50	0.00	2.50
9,800.00	90.00	153.50	7,401.00	-2,510.12	2,494.78	3,480.65	2.50	0.00	2.50
9,900.00	90.00	156.00	7,401.00	-2,600.56	2,537.43	3,579.37	2.50	0.00	2.50

Halliburton Company

Planning Report

Database:	EOG Database	Local Co-ordinate Reference:	Well Critter Creek 25-30H
Company:	EOG Resources, Inc.	TVD Reference:	Rig @ 5285.00ft (TBD)
Project:	DJ-Hereford Ranch	MD Reference:	Rig @ 5285.00ft (TBD)
Site:	Critter Creek 25-30H	North Reference:	True
Well:	Critter Creek 25-30H	Survey Calculation Method:	Minimum Curvature
Wellbore:	Original Wellbore		
Design:	APD Directional Plan		

Planned Survey									
Measured Depth (ft)	Inclination (°)	Azimuth (°)	Vertical Depth (ft)	+N/-S (ft)	+E/-W (ft)	Vertical Section (ft)	Dogleg Rate (°/100ft)	Build Rate (°/100ft)	Turn Rate (°/100ft)
10,000.00	90.00	158.50	7,401.00	-2,692.78	2,576.09	3,677.30	2.50	0.00	2.50
10,048.60	90.00	159.72	7,401.00	-2,738.19	2,593.41	3,724.55	2.50	0.00	2.50
10,100.00	90.00	159.72	7,401.00	-2,786.40	2,611.23	3,774.40	0.00	0.00	0.00
10,200.00	90.00	159.72	7,401.00	-2,880.20	2,645.89	3,871.37	0.00	0.00	0.00
10,300.00	90.00	159.72	7,401.00	-2,974.00	2,680.55	3,968.35	0.00	0.00	0.00
10,400.00	90.00	159.72	7,401.00	-3,067.80	2,715.22	4,065.33	0.00	0.00	0.00
10,500.00	90.00	159.72	7,401.00	-3,161.60	2,749.88	4,162.31	0.00	0.00	0.00
10,600.00	90.00	159.72	7,401.00	-3,255.40	2,784.54	4,259.28	0.00	0.00	0.00
10,700.00	90.00	159.72	7,401.00	-3,349.20	2,819.21	4,356.26	0.00	0.00	0.00
10,800.00	90.00	159.72	7,401.00	-3,443.00	2,853.87	4,453.24	0.00	0.00	0.00
10,900.00	90.00	159.72	7,401.00	-3,536.80	2,888.54	4,550.22	0.00	0.00	0.00
11,000.00	90.00	159.72	7,401.00	-3,630.60	2,923.20	4,647.20	0.00	0.00	0.00
11,100.00	90.00	159.72	7,401.00	-3,724.40	2,957.87	4,744.17	0.00	0.00	0.00
11,200.00	90.00	159.72	7,401.00	-3,818.19	2,992.54	4,841.15	0.00	0.00	0.00
11,300.00	90.00	159.72	7,401.00	-3,911.99	3,027.20	4,938.13	0.00	0.00	0.00
11,400.00	90.00	159.72	7,401.00	-4,005.79	3,061.87	5,035.11	0.00	0.00	0.00
11,500.00	90.00	159.72	7,401.00	-4,099.59	3,096.54	5,132.09	0.00	0.00	0.00
11,600.00	90.00	159.71	7,401.00	-4,193.39	3,131.21	5,229.07	0.00	0.00	0.00
11,700.00	90.00	159.71	7,401.00	-4,287.19	3,165.88	5,326.05	0.00	0.00	0.00
11,800.00	90.00	159.71	7,401.00	-4,380.98	3,200.55	5,423.03	0.00	0.00	0.00
11,900.00	90.00	159.71	7,401.00	-4,474.78	3,235.22	5,520.00	0.00	0.00	0.00
12,000.00	90.00	159.71	7,401.00	-4,568.58	3,269.89	5,616.98	0.00	0.00	0.00
12,100.00	90.00	159.71	7,401.00	-4,662.37	3,304.56	5,713.96	0.00	0.00	0.00
12,200.00	90.00	159.71	7,401.00	-4,756.17	3,339.24	5,810.94	0.00	0.00	0.00
12,300.00	90.00	159.71	7,401.00	-4,849.97	3,373.91	5,907.92	0.00	0.00	0.00
12,400.00	90.00	159.71	7,401.00	-4,943.76	3,408.58	6,004.90	0.00	0.00	0.00
12,477.62	90.00	159.71	7,401.00	-5,016.57	3,435.50	6,080.18	0.00	0.00	0.00
Critter Creek 25-30H (BHL)									

Design Targets									
Target Name	Dip Angle (°)	Dip Dir. (°)	TVD (ft)	+N/-S (ft)	+E/-W (ft)	Northing (usft)	Easting (usft)	Latitude	Longitude
- hit/miss target									
- Shape									
Critter Creek 25-30H (B	0.00	0.00	7,401.00	-5,016.57	3,435.50	562,671.86	2,288,967.52	40° 52' 23.744 N	104° 27' 18.585 W
- plan hits target center									
- Point									
Critter Creek 25-30H WF	0.00	0.00	7,401.00	-1,850.21	2,000.00	565,821.28	2,287,495.26	40° 52' 55.032 N	104° 27' 37.267 W
- plan hits target center									
- Point									

Casing Points					
Measured Depth (ft)	Vertical Depth (ft)	Name	Casing Diameter (in)	Hole Diameter (in)	
1,425.00	1,425.00	9 5/8"	9.625	13.500	
7,778.11	7,401.00	7"	7.000	8.750	
12,477.62	7,401.00	4-1/2"	4.500	6.000	

Halliburton Company

Planning Report

Database:	EOG Database	Local Co-ordinate Reference:	Well Critter Creek 25-30H
Company:	EOG Resources, Inc.	TVD Reference:	Rig @ 5285.00ft (TBD)
Project:	DJ-Hereford Ranch	MD Reference:	Rig @ 5285.00ft (TBD)
Site:	Critter Creek 25-30H	North Reference:	True
Well:	Critter Creek 25-30H	Survey Calculation Method:	Minimum Curvature
Wellbore:	Original Wellbore		
Design:	APD Directional Plan		

Formations						
Measured Depth (ft)	Vertical Depth (ft)	Name	Lithology	Dip (°)	Dip Direction (°)	
0.00	0.00	WHITE RIVER		0.00		
851.00	851.00	FOX HILLS		0.00		
1,137.00	1,137.00	PIERRE SHALE		0.00		
3,632.11	3,597.00	TERRY SS	Sandstone	0.00		
4,280.12	4,232.00	HYGIENE	Sandstone	0.00		
7,398.67	7,258.00	SHARON SPRINGS		0.00		
7,501.33	7,323.00	NIOBRARA	Shale	0.00		
7,544.53	7,345.00	B1 CHALK		0.00		
7,639.42	7,381.00	B CHALK	Chalk	0.00		
7,778.11	7,401.00	TARGET ZONE		0.00		