

KERR MCGEE OIL & GAS ONSHORE LP

Location: COLORADO Slot: SLOT#09 NRC 41-8 (1550'FNL & 1532'FEL)
 Field: WELD COUNTY (KERR MCGEE) Well: NRC 41-8
 Facility: SEC.08-T1N-R67W Wellbore: NRC 41-8 PWB

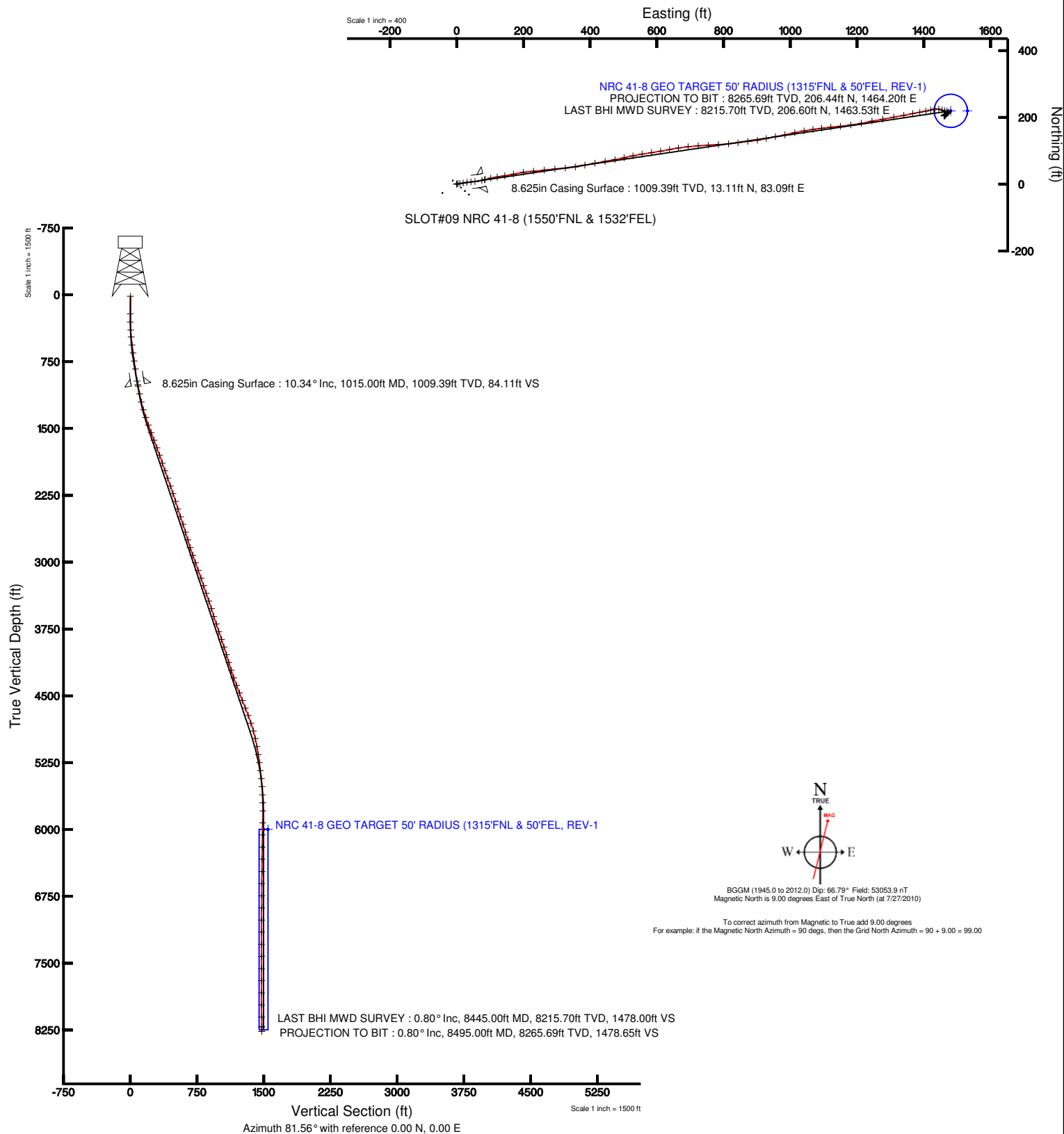

Plot reference wellpath is NRC 41-8 (REV-B.0) PWP	
True vertical depths are referenced to XTREME 12 (RT)	Grid System: NAD83 / Lambert Colorado State Planes, Northern Zone (501), US feet
Measured depths are referenced to XTREME 12 (RT)	North Reference: True north
XTREME 12 (RT) to Mean Sea Level: 5023 feet	Scale: True distance
Mean Sea Level to Mud line (Facility: SEC.08-T1N-R67W): 0 feet	Depths are in feet
Coordinates are in feet referenced to Slot	Created by: bensjaj on 7/28/2010





Actual Wellpath Report

NRC 41-8 AWP

Page 1 of 5



INTEQ

REFERENCE WELLPATH IDENTIFICATION

Operator	KERR MCGEE OIL & GAS ONSHORE LP	Slot	SLOT#09 NRC 41-8 (1550'FNL & 1532'FEL)
Area	COLORADO	Well	NRC 41-8
Field	WELD COUNTY (KERR MCGEE)	Wellbore	NRC 41-8
Facility	SEC.08-T1N-R67W		

REPORT SETUP INFORMATION

Projection System	NAD83 / Lambert Colorado State Planes, Northern Zone (501), US feet	Software System	WellArchitect® 2.0
North Reference	True	User	Bensjacj
Scale	0.999962	Report Generated	7/28/2010 at 11:36:23 AM
Convergence at slot	0.38° East	Database/Source file	WA_Denver/NRC_41-8.xml

WELLPATH LOCATION

	Local coordinates		Grid coordinates		Geographic coordinates	
	North[ft]	East[ft]	Easting[USft]	Northing[USft]	Latitude	Longitude
Slot Location	2689.20	-122.31	3164959.82	1268364.68	40°04'06.766"N	104°54'38.102"W
Facility Reference Pt			3165100.01	1265676.46	40°03'40.190"N	104°54'36.529"W
Field Reference Pt			3197771.84	1268891.29	40°04'09.600"N	104°47'36.000"W

WELLPATH DATUM

Calculation method	Minimum curvature	XTREME 12 (RT) to Facility Vertical Datum	5023.00ft
Horizontal Reference Pt	Slot	XTREME 12 (RT) to Mean Sea Level	5023.00ft
Vertical Reference Pt	XTREME 12 (RT)	Facility Vertical Datum to Mud Line (Facility)	0.00ft
MD Reference Pt	XTREME 12 (RT)	Section Origin	N 0.00, E 0.00 ft
Field Vertical Reference	Mean Sea Level	Section Azimuth	81.56°



Actual Wellpath Report

NRC 41-8 AWP

Page 2 of 5



INTEQ

REFERENCE WELLPATH IDENTIFICATION			
Operator	KERR MCGEE OIL & GAS ONSHORE LP	Slot	SLOT#09 NRC 41-8 (1550'FNL & 1532'FEL)
Area	COLORADO	Well	NRC 41-8
Field	WELD COUNTY (KERR MCGEE)	Wellbore	NRC 41-8
Facility	SEC.08-T1N-R67W		

WELLPATH DATA (86 stations) † = interpolated/extrapolated station								
MD [ft]	Inclination [°]	Azimuth [°]	TVD [ft]	Vert Sect [ft]	North [ft]	East [ft]	DLS [°/100ft]	Comments
0.00†	0.000	287.500	0.00	0.00	0.00	0.00	0.00	
15.00	0.000	287.500	15.00	0.00	0.00	0.00	0.00	
212.00	0.600	287.500	212.00	-0.93	0.31	-0.98	0.30	
304.00	1.200	79.000	303.99	-0.40	0.64	-0.50	1.90	
395.00	3.700	81.400	394.90	3.49	1.26	3.34	2.75	
471.00	5.200	83.600	470.67	9.38	2.01	9.19	1.99	
563.00	7.100	80.400	562.14	19.24	3.42	18.94	2.10	
654.00	7.600	82.500	652.39	30.88	5.15	30.45	0.62	
744.00	7.700	84.300	741.59	42.85	6.52	42.35	0.29	
835.00	8.100	85.000	831.72	55.34	7.69	54.80	0.45	
970.00	9.800	76.500	965.08	76.28	11.20	75.45	1.59	
1028.00	10.500	75.100	1022.17	86.45	13.71	85.36	1.28	
1119.00	11.100	76.900	1111.56	103.42	17.83	101.90	0.76	
1210.00	13.600	80.400	1200.45	122.85	21.60	120.99	2.87	
1300.00	16.100	82.500	1287.44	145.91	24.99	143.80	2.84	
1391.00	18.300	77.200	1374.37	172.77	29.80	170.24	2.97	
1482.00	19.700	81.800	1460.41	202.36	35.16	199.36	2.25	
1572.00	20.300	84.600	1544.99	233.12	38.79	229.92	1.26	
1663.00	21.400	84.200	1630.03	265.47	41.95	262.15	1.22	
1754.00	20.300	84.200	1715.07	297.82	45.23	294.37	1.21	
1845.00	19.800	85.700	1800.55	328.97	47.98	325.45	0.79	
1936.00	18.700	80.700	1886.47	358.93	51.49	355.22	2.18	
2027.00	19.500	77.600	1972.46	388.67	57.11	384.45	1.42	
2118.00	19.800	80.700	2058.16	419.23	62.86	414.49	1.19	
2209.00	19.600	79.300	2143.84	449.89	68.19	444.70	0.56	
2300.00	18.800	80.100	2229.77	479.80	73.54	474.14	0.93	
2391.00	17.100	77.200	2316.34	507.80	79.03	501.64	2.11	
2482.00	17.500	78.300	2403.23	534.80	84.77	528.08	0.57	
2573.00	18.500	81.100	2489.77	562.90	89.78	555.74	1.45	
2663.00	18.400	80.400	2575.15	591.38	94.35	583.86	0.27	
2754.00	17.300	80.700	2661.77	619.27	98.93	611.37	1.21	
2845.00	16.800	79.000	2748.77	645.94	103.63	637.63	0.78	
2936.00	18.000	81.800	2835.60	673.14	108.15	664.46	1.61	
3027.00	19.700	83.600	2921.72	702.53	111.86	693.62	1.97	
3117.00	19.600	85.500	3006.48	732.75	114.74	723.75	0.72	
3208.00	19.800	86.400	3092.15	763.33	116.90	754.34	0.40	
3299.00	19.600	87.100	3177.83	793.88	118.64	784.97	0.34	
3390.00	18.200	85.000	3263.92	823.26	120.65	814.37	1.71	
3480.00	19.400	81.400	3349.12	852.24	124.11	843.16	1.85	
3571.00	19.300	83.900	3434.98	882.38	127.97	873.05	0.92	
3662.00	17.100	81.100	3521.42	910.79	131.64	901.23	2.60	
3753.00	17.800	77.200	3608.24	938.04	136.79	928.01	1.50	
3843.00	18.700	80.400	3693.71	966.18	142.25	955.65	1.50	
3934.00	19.000	77.900	3779.83	995.55	147.78	984.52	0.95	
4025.00	18.800	76.500	3865.93	1024.94	154.31	1013.26	0.54	



Actual Wellpath Report

NRC 41-8 AWP

Page 3 of 5



INTEQ

REFERENCE WELLPATH IDENTIFICATION			
Operator	KERR MCGEE OIL & GAS ONSHORE LP	Slot	SLOT#09 NRC 41-8 (1550'FNL & 1532'FEL)
Area	COLORADO	Well	NRC 41-8
Field	WELD COUNTY (KERR MCGEE)	Wellbore	NRC 41-8
Facility	SEC.08-T1N-R67W		

WELLPATH DATA (86 stations)								
MD [ft]	Inclination [°]	Azimuth [°]	TVD [ft]	Vert Sect [ft]	North [ft]	East [ft]	DLS [°/100ft]	Comments
4116.00	17.800	81.800	3952.33	1053.45	159.72	1041.29	2.13	
4207.00	17.100	80.700	4039.14	1080.74	163.86	1068.26	0.85	
4297.00	17.100	83.200	4125.16	1107.20	167.57	1094.46	0.82	
4388.00	17.600	83.600	4212.02	1134.32	170.69	1121.41	0.56	
4479.00	19.600	84.600	4298.27	1163.31	173.66	1150.28	2.23	
4570.00	21.000	82.200	4383.61	1194.86	177.31	1181.64	1.79	
4660.00	20.600	79.300	4467.75	1226.81	182.44	1213.17	1.23	
4751.00	21.100	78.600	4552.79	1259.16	188.65	1244.96	0.61	
4841.00	22.300	80.000	4636.41	1292.41	194.81	1277.66	1.45	
4932.00	20.400	80.000	4721.16	1325.53	200.57	1310.28	2.09	
5023.00	19.100	79.000	4806.81	1356.26	206.16	1340.52	1.48	
5114.00	15.600	78.300	4893.65	1383.36	211.48	1367.12	3.85	
5204.00	12.500	80.400	4980.95	1405.18	215.56	1388.58	3.49	
5295.00	10.500	79.000	5070.12	1423.31	218.79	1406.43	2.22	
5386.00	8.600	74.800	5159.86	1438.35	222.16	1421.14	2.22	
5477.00	7.800	79.300	5249.93	1451.28	225.09	1433.77	1.13	
5567.00	7.300	105.400	5339.17	1462.62	224.70	1445.29	3.82	
5658.00	6.000	104.600	5429.56	1472.28	221.97	1455.47	1.43	
5749.00	4.300	106.700	5520.19	1479.75	219.79	1463.34	1.88	
5840.00	3.400	108.500	5610.98	1485.24	217.95	1469.16	1.00	
5930.00	2.400	115.200	5700.87	1489.19	216.30	1473.40	1.17	
6021.00	1.200	238.200	5791.84	1489.90	214.99	1474.32	3.53	
6156.00	1.300	228.700	5926.81	1487.32	213.23	1471.96	0.17	
6291.00	1.100	229.100	6061.78	1484.94	211.37	1469.83	0.15	
6427.00	0.900	233.300	6197.76	1482.90	209.88	1467.99	0.16	
6563.00	0.900	231.200	6333.74	1481.03	208.57	1466.30	0.02	
6702.00	0.600	221.700	6472.73	1479.53	207.35	1464.97	0.23	
6838.00	0.600	244.900	6608.72	1478.31	206.51	1463.85	0.18	
6974.00	0.400	233.300	6744.72	1477.21	205.93	1462.82	0.16	
7110.00	0.200	191.100	6880.71	1476.71	205.41	1462.40	0.21	
7247.00	0.200	221.400	7017.71	1476.45	205.00	1462.19	0.08	
7383.00	0.100	143.300	7153.71	1476.32	204.72	1462.11	0.15	
7519.00	0.100	24.800	7289.71	1476.44	204.73	1462.23	0.13	
7655.00	0.200	269.900	7425.71	1476.27	204.84	1462.04	0.19	
7791.00	0.200	265.300	7561.71	1475.80	204.82	1461.57	0.01	
7927.00	0.100	331.100	7697.71	1475.52	204.91	1461.27	0.13	
8064.00	0.200	51.600	7834.71	1475.69	205.16	1461.40	0.15	
8200.00	0.200	11.300	7970.71	1475.97	205.54	1461.63	0.10	
8336.00	0.700	47.700	8106.71	1476.74	206.33	1462.29	0.41	
8445.00	0.800	103.600	8215.70	1478.00	206.60	1463.53	0.65	LAST BHI MWD SURVEY
8495.00	0.800	103.600	8265.69	1478.65	206.44	1464.20	0.00	PROJECTION TO BIT



Actual Wellpath Report

NRC 41-8 AWP

Page 4 of 5



INTEQ

REFERENCE WELLPATH IDENTIFICATION

Operator	KERR MCGEE OIL & GAS ONSHORE LP	Slot	SLOT#09 NRC 41-8 (1550'FNL & 1532'FEL)
Area	COLORADO	Well	NRC 41-8
Field	WELD COUNTY (KERR MCGEE)	Wellbore	NRC 41-8
Facility	SEC.08-T1N-R67W		

HOLE & CASING SECTIONS Ref Wellbore: NRC 41-8 Ref Wellpath: NRC 41-8 AWP

String/Diameter	Start MD [ft]	End MD [ft]	Interval [ft]	Start TVD [ft]	End TVD [ft]	Start N/S [ft]	Start E/W [ft]	End N/S [ft]	End E/W [ft]
12.25in Open Hole	15.00	1025.00	1010.00	15.00	1019.22	0.00	0.00	13.57	84.83
8.625in Casing Surface	15.00	1015.00	1000.00	15.00	1009.39	0.00	0.00	13.11	83.09
7.875in Open Hole	1015.00	8495.00	7480.00	1009.39	8265.69	13.11	83.09	206.44	1464.20

TARGETS

Name	MD [ft]	TVD [ft]	North [ft]	East [ft]	Grid East [srv ft]	Grid North [srv ft]	Latitude	Longitude	Shape
NRC 41-8 GEO TARGET 50' RADIUS (1315'FNL & 50'FEL, REV-1)		6000.00	219.71	1481.41	3166439.68	1268594.22	40°04'08.936"N	104°54'19.048"W	circle
NRC 41-8 HARDLINE 50'E OF GEO TARGET		6000.00	219.71	1531.41	3166489.68	1268594.55	40°04'08.936"N	104°54'18.404"W	point

WELLPATH COMPOSITION Ref Wellbore: NRC 41-8 Ref Wellpath: NRC 41-8 AWP

Start MD [ft]	End MD [ft]	Positional Uncertainty Model	Log Name/Comment	Wellbore
15.00	8445.00	NaviTrak (Standard)	BHI MWD SURVEYS <212-8445>	NRC 41-8
8445.00	8495.00	Blind Drilling (std)	Projection to bit	NRC 41-8



Actual Wellpath Report

NRC 41-8 AWP

Page 5 of 5



INTEQ

REFERENCE WELLPATH IDENTIFICATION

Operator	KERR MCGEE OIL & GAS ONSHORE LP	Slot	SLOT#09 NRC 41-8 (1550'FNL & 1532'FEL)
Area	COLORADO	Well	NRC 41-8
Field	WELD COUNTY (KERR MCGEE)	Wellbore	NRC 41-8
Facility	SEC.08-T1N-R67W		

WELLPATH COMMENTS

MD [ft]	Inclination [°]	Azimuth [°]	TVD [ft]	Comment
8445.00	0.800	103.600	8215.70	LAST BHI MWD SURVEY
8495.00	0.800	103.600	8265.69	PROJECTION TO BIT