

BMP Plan

Wiepking-Fullerton Energy, L.L.C.
4600 S. Downing St.
Englewood, CO 80113
303-789-1798
303-761-9067 (fax)

Certification to Discharge
Under
CDPS General Permit COR-03000
Stormwater Discharges Associated with Construction

Certification Number COR 39788

Napali # 2 well
T10S, R55W
Sec. 17: SE1/4SW1/4
Lincoln County, Colorado

Description of Well Site and Construction Area

1-3 acre site with access road for drilling of oil and gas well. Terrain is flat with native grass and sagebrush. No receiving waters will be affected by well pad. Silt fences will be installed on low side site of drill site. Drilling pits closed and reclaimed with the drillsite. Topsoil will be separated and spread on drill site as final operation before reseeding operations which will be completed within 6 months weather permitting. To prevent soil erosion site will be disked and straw crimped in or manure spread.

Stormwater Management Plan (SWMP) is on file in Wiepking-Fullerton Energy, L.L.C. office.

Spill Prevention, Control and Countermeasure Plan is on file in Wiepking-Fullerton Energy, L.L.C. office.



Job # 10177-Napali #2

Inv # 1316

Physical Address: 401 Arapahoe St.
Mail to: Box 384 Kiowa, CO 80117
Ph. 303-621-8672 - Fax 303-621-2717
www.highprairiesurvey.com

High Prairie Surveying of Kiowa, Colorado has in accordance with a request from **Jack Fincham, Wiepking Fullerton Energy** has determined the location of **Napali #2** to be **660 feet FSL**, and **1980 feet FWL**, (90° off Section lines) of **SECTION 17**, Township **10s**, Range **55w** of the 6th Principal Meridian, **Lincoln County**, Colorado.

Date: Staked on 10-11-10 drawn on 10-12-10.

Re: Staked by Keith Westfall
Drawn: Drawn by Elijah Frane

Topo Exhibit

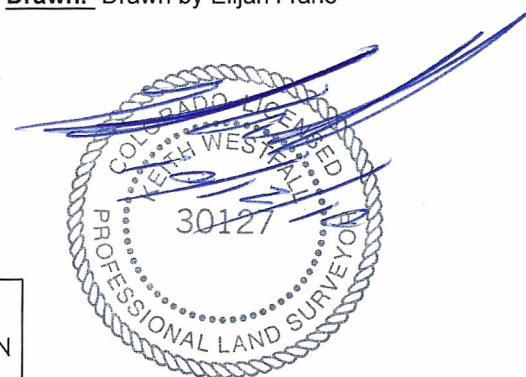

Wiepking Fullerton
SW 1/4 Sec. 17-10s-55w
Napali #2
Lincoln. Co, Colorado

