



Antero Resources

BAT 44B-18-07-95 (111282)



PLAN VIEW

Project: Monument Ridge
 Site: Monument Ridge Pad
 Well: BAT 44B-18-07-95 (111282)
 Wellbore: BAT 44B
 Design: BAT 44B P01

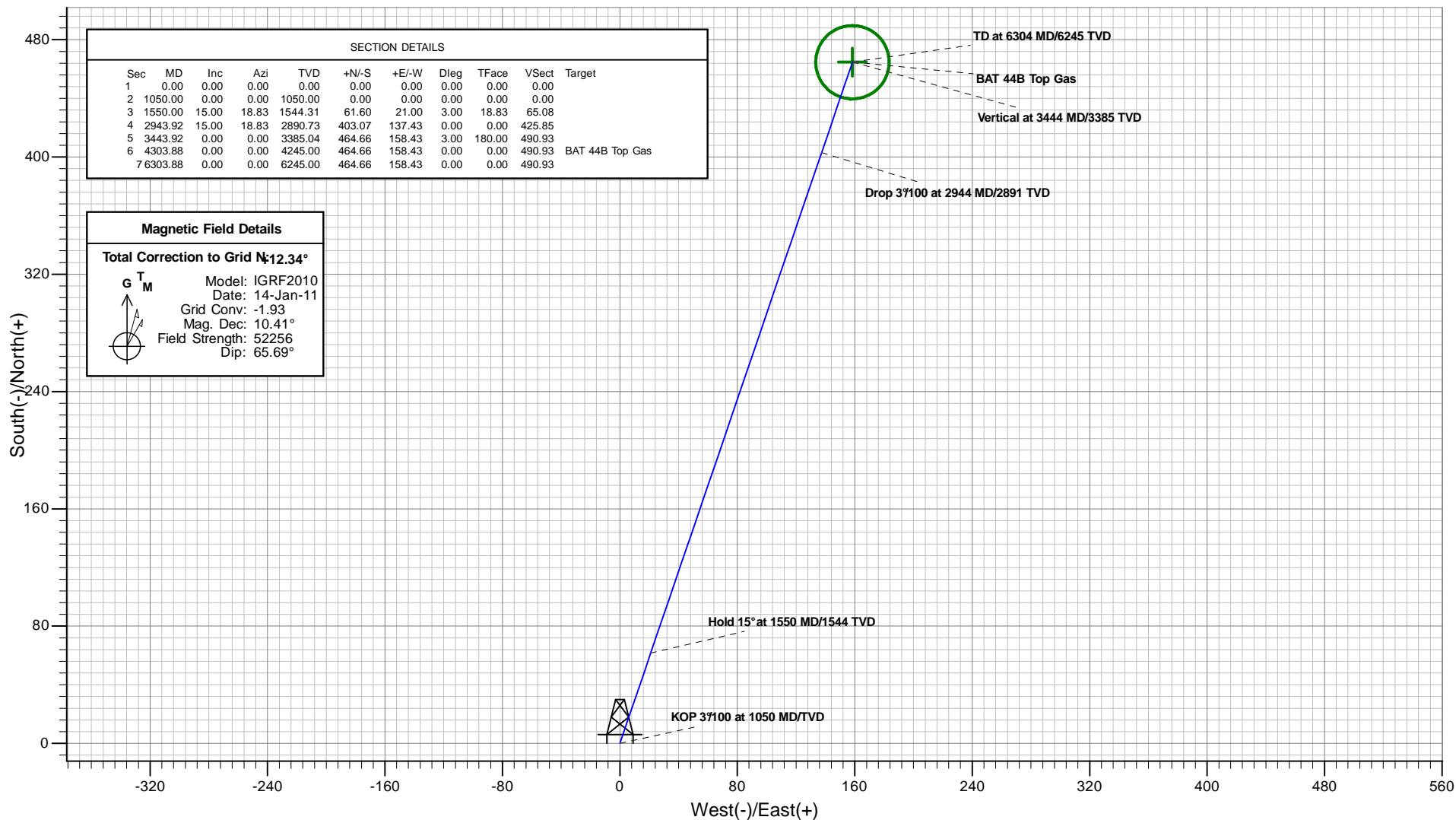

SECTION DETAILS										
Sec	MD	Inc	Azi	TVD	+N/-S	+E/-W	Dleg	TFace	VSec	Target
1	0.00	0.00	0.00	0.00	0.00	0.00	0.00	0.00	0.00	
2	1050.00	0.00	0.00	1050.00	0.00	0.00	0.00	0.00	0.00	
3	1550.00	15.00	18.83	1544.31	61.60	21.00	3.00	18.83	65.08	
4	2943.92	15.00	18.83	2890.73	403.07	137.43	0.00	0.00	425.85	
5	3443.92	0.00	0.00	3385.04	464.66	158.43	3.00	180.00	490.93	BAT 44B Top Gas
6	4303.88	0.00	0.00	4245.00	464.66	158.43	0.00	0.00	490.93	
7	6303.88	0.00	0.00	6245.00	464.66	158.43	0.00	0.00	490.93	

Magnetic Field Details	
Total Correction to Grid N: 12.34°	
G	T
M	
Model: IGRF2010	
Date: 14-Jan-11	
Grid Conv: -1.93	
Mag. Dec: 10.41°	
Field Strength: 52256	
Dip: 65.69°	

Plan: BAT 44B P01
 Created By: ARK Directional Services
 Date: 8:36, October 15 2010

PROJECT DETAILS: Monument Ridge

Geodetic System: Universal Transverse Mercator
 Datum: NAD83 Colorado - HARN
 Ellipsoid: GRS 1980
 Zone: Zone 13N (108 W to 102 W)
 System Datum: Mean Sea Level

REFERENCE INFORMATION

Co-ordinate (N/E) Reference: Well BAT 44B-18-07-95 (111282), Grid North
 Vertical (TVD) Reference: KB @ 5465.00ft (Original Well Elev)
 Section (VS) Reference: Slot - (0.00N, 0.00E)
 Measured Depth Reference: KB @ 5465.00ft (Original Well Elev)
 Calculation Method: Minimum Curvature



VERTICAL SECTION VIEW

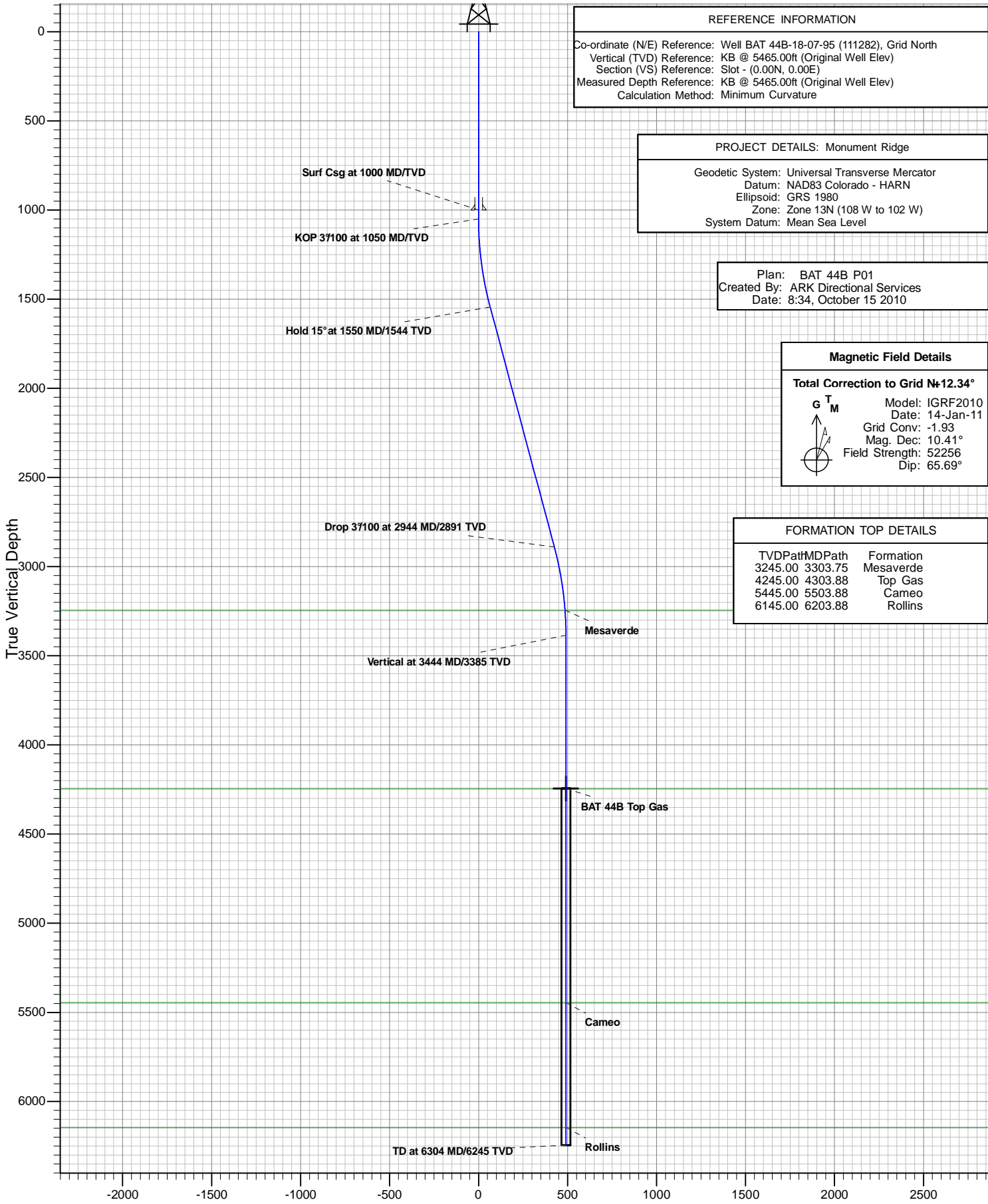

REFERENCE INFORMATION
Co-ordinate (N/E) Reference: Well BAT 44B-18-07-95 (111282), Grid North
Vertical (TVD) Reference: KB @ 5465.00ft (Original Well Elev)
Section (VS) Reference: Slot - (0.00N, 0.00E)
Measured Depth Reference: KB @ 5465.00ft (Original Well Elev)
Calculation Method: Minimum Curvature

PROJECT DETAILS: Monument Ridge
Geodetic System: Universal Transverse Mercator
Datum: NAD83 Colorado - HARN
Ellipsoid: GRS 1980
Zone: Zone 13N (108 W to 102 W)
System Datum: Mean Sea Level

Plan: BAT 44B P01
Created By: ARK Directional Services
Date: 8:34, October 15 2010

Magnetic Field Details												
Total Correction to Grid N=12.34°												
<table border="0"> <tr> <td style="text-align: center;">G T M</td> <td>Model: IGRF2010</td> </tr> <tr> <td style="text-align: center;">↑</td> <td>Date: 14-Jan-11</td> </tr> <tr> <td style="text-align: center;">↙</td> <td>Grid Conv: -1.93</td> </tr> <tr> <td style="text-align: center;">↘</td> <td>Mag. Dec: 10.41°</td> </tr> <tr> <td style="text-align: center;">↻</td> <td>Field Strength: 52256</td> </tr> <tr> <td style="text-align: center;">↻</td> <td>Dip: 65.69°</td> </tr> </table>	G T M	Model: IGRF2010	↑	Date: 14-Jan-11	↙	Grid Conv: -1.93	↘	Mag. Dec: 10.41°	↻	Field Strength: 52256	↻	Dip: 65.69°
G T M	Model: IGRF2010											
↑	Date: 14-Jan-11											
↙	Grid Conv: -1.93											
↘	Mag. Dec: 10.41°											
↻	Field Strength: 52256											
↻	Dip: 65.69°											

FORMATION TOP DETAILS	
TVDPatMDPPath	Formation
3245.00 3303.75	Mesaverde
4245.00 4303.88	Top Gas
5445.00 5503.88	Cameo
6145.00 6203.88	Rollins

Vertical Section at 18.83°

Antero Resources

**Monument Ridge
Monument Ridge Pad
BAT 44B-18-07-95 (111282)**

BAT 44B

Plan: BAT 44B P01

Standard Planning Report - Geographic

15 October, 2010

ARK Directional Services

Planning Report - Geographic

Database:	EDM SERVER DB	Local Co-ordinate Reference:	Well BAT 44B-18-07-95 (111282)
Company:	Antero Resources	TVD Reference:	KB @ 5465.00ft (Original Well Elev)
Project:	Monument Ridge	MD Reference:	KB @ 5465.00ft (Original Well Elev)
Site:	Monument Ridge Pad	North Reference:	Grid
Well:	BAT 44B-18-07-95 (111282)	Survey Calculation Method:	Minimum Curvature
Wellbore:	BAT 44B		
Design:	BAT 44B P01		

Project	Monument Ridge		
Map System:	Universal Transverse Mercator	System Datum:	Mean Sea Level
Geo Datum:	NAD83 Colorado - HARN		
Map Zone:	Zone 13N (108 W to 102 W)		

Site	Monument Ridge Pad				
Site Position:		Northing:	14,334,067.020 usft	Latitude:	39.431305000°N
From:	Lat/Long	Easting:	783,868.932 usft	Longitude:	108.033251000°W
Position Uncertainty:	0.00 ft	Slot Radius:	13.20 in	Grid Convergence:	-1.93 °

Well	BAT 44B-18-07-95 (111282)					
Well Position	+N/-S	0.00 ft	Northing:	14,334,041.839 usft	Latitude:	39.431238000°N
	+E/-W	0.00 ft	Easting:	783,891.271 usft	Longitude:	108.033169000°W
Position Uncertainty		0.00 ft	Wellhead Elevation:		Ground Level:	5,441.00 ft

Wellbore	BAT 44B				
Magnetics	Model Name	Sample Date	Declination (°)	Dip Angle (°)	Field Strength (nT)
	IGRF2010	2011/01/14	10.41	65.69	52,256

Design	BAT 44B P01				
Audit Notes:					
Version:	Phase:	PROTOTYPE	Tie On Depth:	0.00	
Vertical Section:	Depth From (TVD) (ft)	+N/-S (ft)	+E/-W (ft)	Direction (°)	
	4,245.00	0.00	0.00	18.83	

Plan Sections										
Measured Depth (ft)	Inclination (°)	Azimuth (°)	Vertical Depth (ft)	+N/-S (ft)	+E/-W (ft)	Dogleg Rate (°/100ft)	Build Rate (°/100ft)	Turn Rate (°/100ft)	TFO (°)	Target
0.00	0.00	0.00	0.00	0.00	0.00	0.00	0.00	0.00	0.00	
1,050.00	0.00	0.00	1,050.00	0.00	0.00	0.00	0.00	0.00	0.00	
1,550.00	15.00	18.83	1,544.31	61.60	21.00	3.00	3.00	0.00	18.83	
2,943.92	15.00	18.83	2,890.73	403.07	137.43	0.00	0.00	0.00	0.00	
3,443.92	0.00	0.00	3,385.04	464.66	158.43	3.00	-3.00	0.00	180.00	
4,303.88	0.00	0.00	4,245.00	464.66	158.43	0.00	0.00	0.00	0.00	BAT 44B Top Gas
6,303.88	0.00	0.00	6,245.00	464.66	158.43	0.00	0.00	0.00	0.00	

ARK Directional Services

Planning Report - Geographic

Database:	EDM SERVER DB	Local Co-ordinate Reference:	Well BAT 44B-18-07-95 (111282)
Company:	Antero Resources	TVD Reference:	KB @ 5465.00ft (Original Well Elev)
Project:	Monument Ridge	MD Reference:	KB @ 5465.00ft (Original Well Elev)
Site:	Monument Ridge Pad	North Reference:	Grid
Well:	BAT 44B-18-07-95 (111282)	Survey Calculation Method:	Minimum Curvature
Wellbore:	BAT 44B		
Design:	BAT 44B P01		

Planned Survey										
Measured Depth (ft)	Inclination (°)	Azimuth (°)	Vertical Depth (ft)	+N/-S (ft)	+E/-W (ft)	Map Northing (usft)	Map Easting (usft)	Latitude	Longitude	
0.00	0.00	0.00	0.00	0.00	0.00	14,334,041.839	783,891.271	39.431238000°N	108.033169000°W	
100.00	0.00	0.00	100.00	0.00	0.00	14,334,041.839	783,891.271	39.431238000°N	108.033169000°W	
200.00	0.00	0.00	200.00	0.00	0.00	14,334,041.839	783,891.271	39.431238000°N	108.033169000°W	
300.00	0.00	0.00	300.00	0.00	0.00	14,334,041.839	783,891.271	39.431238000°N	108.033169000°W	
400.00	0.00	0.00	400.00	0.00	0.00	14,334,041.839	783,891.271	39.431238000°N	108.033169000°W	
500.00	0.00	0.00	500.00	0.00	0.00	14,334,041.839	783,891.271	39.431238000°N	108.033169000°W	
600.00	0.00	0.00	600.00	0.00	0.00	14,334,041.839	783,891.271	39.431238000°N	108.033169000°W	
700.00	0.00	0.00	700.00	0.00	0.00	14,334,041.839	783,891.271	39.431238000°N	108.033169000°W	
800.00	0.00	0.00	800.00	0.00	0.00	14,334,041.839	783,891.271	39.431238000°N	108.033169000°W	
900.00	0.00	0.00	900.00	0.00	0.00	14,334,041.839	783,891.271	39.431238000°N	108.033169000°W	
1,000.00	0.00	0.00	1,000.00	0.00	0.00	14,334,041.839	783,891.271	39.431238000°N	108.033169000°W	
Surf Csg at 1000 MD/TVD										
1,050.00	0.00	0.00	1,050.00	0.00	0.00	14,334,041.839	783,891.271	39.431238000°N	108.033169000°W	
KOP 3°/100 at 1050 MD/TVD										
1,100.00	1.50	18.83	1,099.99	0.62	0.21	14,334,042.458	783,891.482	39.431239719°N	108.033168327°W	
1,200.00	4.50	18.83	1,199.85	5.57	1.90	14,334,047.411	783,893.171	39.431253459°N	108.033162944°W	
1,300.00	7.50	18.83	1,299.29	15.46	5.27	14,334,057.303	783,896.544	39.431280901°N	108.033152193°W	
1,400.00	10.50	18.83	1,398.04	30.27	10.32	14,334,072.108	783,901.592	39.431321971°N	108.033136103°W	
1,500.00	13.50	18.83	1,495.85	49.95	17.03	14,334,091.785	783,908.300	39.431376555°N	108.033114719°W	
1,550.00	15.00	18.83	1,544.31	61.60	21.00	14,334,103.433	783,912.272	39.431408869°N	108.033102059°W	
Hold 15° at 1550 MD/1544 TVD										
1,600.00	15.00	18.83	1,592.60	73.84	25.18	14,334,115.682	783,916.448	39.431442848°N	108.033088747°W	
1,700.00	15.00	18.83	1,689.20	98.34	33.53	14,334,140.179	783,924.801	39.431510804°N	108.033062124°W	
1,800.00	15.00	18.83	1,785.79	122.84	41.88	14,334,164.676	783,933.153	39.431578761°N	108.033035500°W	
1,900.00	15.00	18.83	1,882.38	147.33	50.23	14,334,189.173	783,941.506	39.431646718°N	108.033008876°W	
2,000.00	15.00	18.83	1,978.97	171.83	58.59	14,334,213.670	783,949.858	39.431714675°N	108.032982253°W	
2,100.00	15.00	18.83	2,075.57	196.33	66.94	14,334,238.167	783,958.211	39.431782632°N	108.032955629°W	
2,200.00	15.00	18.83	2,172.16	220.83	75.29	14,334,262.665	783,966.563	39.431850588°N	108.032929005°W	
2,300.00	15.00	18.83	2,268.75	245.32	83.64	14,334,287.162	783,974.916	39.431918545°N	108.032902381°W	
2,400.00	15.00	18.83	2,365.34	269.82	92.00	14,334,311.659	783,983.268	39.431986502°N	108.032875757°W	
2,500.00	15.00	18.83	2,461.94	294.32	100.35	14,334,336.156	783,991.620	39.432054459°N	108.032849133°W	
2,600.00	15.00	18.83	2,558.53	318.81	108.70	14,334,360.653	783,999.973	39.432122416°N	108.032822509°W	
2,700.00	15.00	18.83	2,655.12	343.31	117.05	14,334,385.150	784,008.325	39.432190372°N	108.032795885°W	
2,800.00	15.00	18.83	2,751.72	367.81	125.41	14,334,409.647	784,016.678	39.432258329°N	108.032769261°W	
2,900.00	15.00	18.83	2,848.31	392.31	133.76	14,334,434.144	784,025.030	39.432326286°N	108.032742637°W	
2,943.92	15.00	18.83	2,890.73	403.07	137.43	14,334,444.903	784,028.698	39.432356131°N	108.032730944°W	
Drop 3°/100 at 2944 MD/2891 TVD										
3,000.00	13.32	18.83	2,945.11	416.05	141.85	14,334,457.886	784,033.125	39.432392149°N	108.032716833°W	
3,100.00	10.32	18.83	3,042.98	435.43	148.46	14,334,477.268	784,039.734	39.432445915°N	108.032695768°W	
3,200.00	7.32	18.83	3,141.78	449.94	153.41	14,334,491.775	784,044.680	39.432486159°N	108.032680001°W	
3,300.00	4.32	18.83	3,241.26	459.53	156.68	14,334,501.368	784,047.951	39.432512769°N	108.032669576°W	
3,303.75	4.20	18.83	3,245.00	459.79	156.77	14,334,501.632	784,048.041	39.432513502°N	108.032669289°W	
Mesaverde										
3,400.00	1.32	18.83	3,341.12	464.18	158.27	14,334,506.020	784,049.537	39.432525674°N	108.032664520°W	
3,443.92	0.00	0.00	3,385.04	464.66	158.43	14,334,506.498	784,049.700	39.432527000°N	108.032664000°W	
Vertical at 3444 MD/3385 TVD										
3,500.00	0.00	0.00	3,441.12	464.66	158.43	14,334,506.498	784,049.700	39.432527000°N	108.032664000°W	
3,600.00	0.00	0.00	3,541.12	464.66	158.43	14,334,506.498	784,049.700	39.432527000°N	108.032664000°W	
3,700.00	0.00	0.00	3,641.12	464.66	158.43	14,334,506.498	784,049.700	39.432527000°N	108.032664000°W	
3,800.00	0.00	0.00	3,741.12	464.66	158.43	14,334,506.498	784,049.700	39.432527000°N	108.032664000°W	
3,900.00	0.00	0.00	3,841.12	464.66	158.43	14,334,506.498	784,049.700	39.432527000°N	108.032664000°W	
4,000.00	0.00	0.00	3,941.12	464.66	158.43	14,334,506.498	784,049.700	39.432527000°N	108.032664000°W	
4,100.00	0.00	0.00	4,041.12	464.66	158.43	14,334,506.498	784,049.700	39.432527000°N	108.032664000°W	
4,200.00	0.00	0.00	4,141.12	464.66	158.43	14,334,506.498	784,049.700	39.432527000°N	108.032664000°W	

ARK Directional Services

Planning Report - Geographic

Database:	EDM SERVER DB	Local Co-ordinate Reference:	Well BAT 44B-18-07-95 (111282)
Company:	Antero Resources	TVD Reference:	KB @ 5465.00ft (Original Well Elev)
Project:	Monument Ridge	MD Reference:	KB @ 5465.00ft (Original Well Elev)
Site:	Monument Ridge Pad	North Reference:	Grid
Well:	BAT 44B-18-07-95 (111282)	Survey Calculation Method:	Minimum Curvature
Wellbore:	BAT 44B		
Design:	BAT 44B P01		

Planned Survey										
Measured Depth (ft)	Inclination (°)	Azimuth (°)	Vertical Depth (ft)	+N/-S (ft)	+E/-W (ft)	Map Northing (usft)	Map Easting (usft)	Latitude	Longitude	
4,300.00	0.00	0.00	4,241.12	464.66	158.43	14,334,506.498	784,049.700	39.432527000°N	108.032664000°W	
4,303.88	0.00	0.00	4,245.00	464.66	158.43	14,334,506.498	784,049.700	39.432527000°N	108.032664000°W	
Top Gas										
4,400.00	0.00	0.00	4,341.12	464.66	158.43	14,334,506.498	784,049.700	39.432527000°N	108.032664000°W	
4,500.00	0.00	0.00	4,441.12	464.66	158.43	14,334,506.498	784,049.700	39.432527000°N	108.032664000°W	
4,600.00	0.00	0.00	4,541.12	464.66	158.43	14,334,506.498	784,049.700	39.432527000°N	108.032664000°W	
4,700.00	0.00	0.00	4,641.12	464.66	158.43	14,334,506.498	784,049.700	39.432527000°N	108.032664000°W	
4,800.00	0.00	0.00	4,741.12	464.66	158.43	14,334,506.498	784,049.700	39.432527000°N	108.032664000°W	
4,900.00	0.00	0.00	4,841.12	464.66	158.43	14,334,506.498	784,049.700	39.432527000°N	108.032664000°W	
5,000.00	0.00	0.00	4,941.12	464.66	158.43	14,334,506.498	784,049.700	39.432527000°N	108.032664000°W	
5,100.00	0.00	0.00	5,041.12	464.66	158.43	14,334,506.498	784,049.700	39.432527000°N	108.032664000°W	
5,200.00	0.00	0.00	5,141.12	464.66	158.43	14,334,506.498	784,049.700	39.432527000°N	108.032664000°W	
5,300.00	0.00	0.00	5,241.12	464.66	158.43	14,334,506.498	784,049.700	39.432527000°N	108.032664000°W	
5,400.00	0.00	0.00	5,341.12	464.66	158.43	14,334,506.498	784,049.700	39.432527000°N	108.032664000°W	
5,500.00	0.00	0.00	5,441.12	464.66	158.43	14,334,506.498	784,049.700	39.432527000°N	108.032664000°W	
5,503.88	0.00	0.00	5,445.00	464.66	158.43	14,334,506.498	784,049.700	39.432527000°N	108.032664000°W	
Cameo										
5,600.00	0.00	0.00	5,541.12	464.66	158.43	14,334,506.498	784,049.700	39.432527000°N	108.032664000°W	
5,700.00	0.00	0.00	5,641.12	464.66	158.43	14,334,506.498	784,049.700	39.432527000°N	108.032664000°W	
5,800.00	0.00	0.00	5,741.12	464.66	158.43	14,334,506.498	784,049.700	39.432527000°N	108.032664000°W	
5,900.00	0.00	0.00	5,841.12	464.66	158.43	14,334,506.498	784,049.700	39.432527000°N	108.032664000°W	
6,000.00	0.00	0.00	5,941.12	464.66	158.43	14,334,506.498	784,049.700	39.432527000°N	108.032664000°W	
6,100.00	0.00	0.00	6,041.12	464.66	158.43	14,334,506.498	784,049.700	39.432527000°N	108.032664000°W	
6,200.00	0.00	0.00	6,141.12	464.66	158.43	14,334,506.498	784,049.700	39.432527000°N	108.032664000°W	
6,203.88	0.00	0.00	6,145.00	464.66	158.43	14,334,506.498	784,049.700	39.432527000°N	108.032664000°W	
Rollins										
6,300.00	0.00	0.00	6,241.12	464.66	158.43	14,334,506.498	784,049.700	39.432527000°N	108.032664000°W	
6,303.88	0.00	0.00	6,245.00	464.66	158.43	14,334,506.498	784,049.700	39.432527000°N	108.032664000°W	
TD at 6304 MD/6245 TVD										

Design Targets										
Target Name	Dip Angle (°)	Dip Dir. (°)	TVD (ft)	+N/-S (ft)	+E/-W (ft)	Northing (usft)	Easting (usft)	Latitude	Longitude	
BAT 44B Top Gas - hit/miss target - Shape - plan hits target center - Circle (radius 25.00)	0.00	0.00	4,245.00	464.66	158.43	14,334,506.498	784,049.700	39.432527000°N	108.032664000°W	

Casing Points					
Measured Depth (ft)	Vertical Depth (ft)	Name	Casing Diameter (in)	Hole Diameter (in)	
1,000.00	1,000.00	Surf Csg at 1000 MD/TVD	5.50	6.00	

ARK Directional Services

Planning Report - Geographic

Database:	EDM SERVER DB	Local Co-ordinate Reference:	Well BAT 44B-18-07-95 (111282)
Company:	Antero Resources	TVD Reference:	KB @ 5465.00ft (Original Well Elev)
Project:	Monument Ridge	MD Reference:	KB @ 5465.00ft (Original Well Elev)
Site:	Monument Ridge Pad	North Reference:	Grid
Well:	BAT 44B-18-07-95 (111282)	Survey Calculation Method:	Minimum Curvature
Wellbore:	BAT 44B		
Design:	BAT 44B P01		

Formations					
Measured Depth (ft)	Vertical Depth (ft)	Name	Lithology	Dip (°)	Dip Direction (°)
3,303.75	3,245.00	Mesaverde			
4,303.88	4,245.00	Top Gas			
5,503.88	5,445.00	Cameo			
6,203.88	6,145.00	Rollins			

Plan Annotations					
Measured Depth (ft)	Vertical Depth (ft)	Local Coordinates		Comment	
		+N/-S (ft)	+E/-W (ft)		
1,050.00	1,050.00	0.00	0.00	KOP 3°/100 at 1050 MD/TVD	
1,550.00	1,544.31	61.60	21.00	Hold 15° at 1550 MD/1544 TVD	
2,943.92	2,890.73	403.07	137.43	Drop 3°/100 at 2944 MD/2891 TVD	
3,443.92	3,385.04	464.66	158.43	Vertical at 3444 MD/3385 TVD	
6,303.88	6,245.00	464.66	158.43	TD at 6304 MD/6245 TVD	