

SHL GM 22-26 LAT./LONG. (NAD83)

N39°29'58.87256" (N39.499687")
W108°05'15.77489" (W108.087715")

CSP (NAD 83)
N=1617288.96
E=2269882.53

BHL GM 22-26 LAT./LONG. (NAD83)

N39°29'51.13216" (N39.497537")
W108°04'38.91636" (W108.077477")

CSP (NAD 83)
N=1616424.00
E=2272748.30

LEGEND

- FOUND MONUMENT
- CALCULATED MONUMENT
- ⊙ WELL LOCATION
- BOTTOM HOLE
- SHL - SURFACE HOLE LOCATION
- BHL - BOTTOM HOLE LOCATION
- BC - BRASS CAP
- GLO - GENERAL LAND OFFICE SURVEY

NOTES:

- 1) GPS OPERATOR GEOFFREY PAPPAS OBSERVED A PDOP OF 3.063.
- 2) ALL GPS OBSERVATIONS ARE IN COMPLIANCE WITH COGCC RULE 215.
- 3) ALL DISTANCES ARE NAD83 COLORADO STATE PLANE, CENTRAL ZONE (SEA LEVEL).
- 4) THIS PLAT COMPLIES WITH COGCC RULE 303C.
- 5) NO VISIBLE IMPROVEMENTS WITHIN 400' OF WELL HEAD.
- 6) VEGETATION: SCRUB OAK, SAGE, NATIVE SHRUBS & GRASSES
- 7) BOTTOM HOLE LOCATION COORDINATES PROVIDED BY WILLIAMS PRODUCTION, RMT.

BASIS OF BEARING/DATUM

A GPS OBSERVATION FROM NGS PID
AJ3465 (FABER)

BASIS OF ELEVATION

A GPS OBSERVATION FROM NGS PID
AJ3465 (FABER). SAID ELEVATION IS
5186.22'.

DIMENSIONAL TIES

ALL DIMENSIONAL TIES TO SECTION
LINES ARE MEASURED PERPENDICULAR
TO THE SECTION LINE.

SURVEYORS CERTIFICATE:

This is to certify that this exhibit was prepared
and location as shown was staked on the ground
from actual surveys made by me or under my
direct supervision.

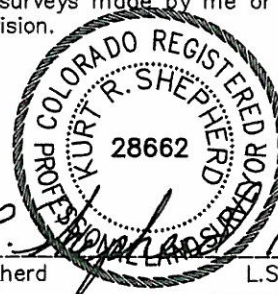

Kurt R. Shepherd
On behalf of
Del-Mont Consultants Inc.

L.S. 28662

DATE REVISED: 2010-10-07

DEL-MONT CONSULTANTS IS PROVIDING GRADING DESIGN FOR THIS PROJECT THAT PROVIDES DIMENSIONS AND VOLUME INFORMATION FOR CONSTRUCTION.



DEL-MONT CONSULTANTS, INC.
ENGINEERING • SURVEYING • PLANNING
125 Colorado Ave. • Montrose, CO 81401 • (970) 249-2251 • (970) 249-2242 fax
www.del-mont.com • service@del-mont.com

SECTIONS 22,23,26&27, T6S, R96W, 6TH P.M.

WELL LOCATION PLAT

GM 22-26

WELL PAD MV 23-27

GARFIELD COUNTY, CO

WILLIAMS PRODUCTION, RMT

DESIGNED BY: MGW
SCALE: 1"=800'
CHECKED BY: KS
FILE NAME: 10030C-MV23-27 PAD SITE



DMC JOB NO: 10030
DATE ISSUED: 2008-11-04
DATE SURVEYED: 2008-09-29
PLAT: 1 of 9