

SHL GM 421-26 LAT./LONG. (NAD83)
 N39°29'58.76458" (N39.499657")
 W108°05'15.95783" (W108.087766")
 CSP (NAD 83)
 N=1617278.45
 E=2269867.89

BHL GM 421-26 LAT./LONG. (NAD83)
 N39°29'53.73059" (N39.498258")
 W108°04'51.00697" (W108.080835")
 CSP (NAD 83)
 N=1616713.70
 E=2271808.40

EXXON-MOBIL
GM 421-26
 WELL PAD MV 23-27
 GRADED ELEVATION: 5769.50'

BASIS OF BEARING/DATUM
 A GPS OBSERVATION FROM NGS PID
 AJ3465 (FABER)

BASIS OF ELEVATION
 A GPS OBSERVATION FROM NGS PID
 AJ3465 (FABER). SAID ELEVATION IS
 5186.22'.

DIMENSIONAL TIES
 ALL DIMENSIONAL TIES TO SECTION
 LINES ARE MEASURED PERPENDICULAR
 TO THE SECTION LINE.

SURVEYORS CERTIFICATE:

This is to certify that this exhibit was prepared and location as shown was staked on the ground from actual surveys made by me or under my direct supervision.

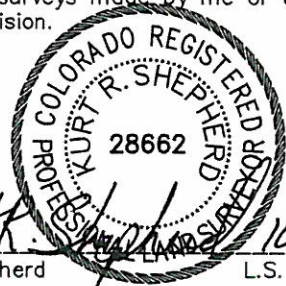

Kurt R. Shepherd
 On behalf of
 Del-Mont Consultants Inc.
 DATE REVISED: 2010-10-07

- LEGEND**
- FOUND MONUMENT
 - CALCULATED MONUMENT
 - ◆ WELL LOCATION
 - BOTTOM HOLE
 - SHL - SURFACE HOLE LOCATION
 - BHL - BOTTOM HOLE LOCATION
 - BC - BRASS CAP
 - GLO - GENERAL LAND OFFICE SURVEY

- NOTES:**
- 1) GPS OPERATOR GEOFFREY PAPPAS OBSERVED A PDOP OF 3.063.
 - 2) ALL GPS OBSERVATIONS ARE IN COMPLIANCE WITH COGCC RULE 215.
 - 3) ALL DISTANCES ARE NAD83 COLORADO STATE PLANE, CENTRAL ZONE (SEA LEVEL).
 - 4) THIS PLAT COMPLIES WITH COGCC RULE 303c.
 - 5) NO VISIBLE IMPROVEMENTS WITHIN 400' OF WELL HEAD.
 - 6) VEGETATION: SCRUB OAK, SAGE, NATIVE SHRUBS & GRASSES
 - 7) BOTTOM HOLE LOCATION COORDINATES PROVIDED BY WILLIAMS PRODUCTION, RMT.

DEL-MONT CONSULTANTS IS PROVIDING GRADING DESIGN FOR THIS PROJECT THAT PROVIDES DIMENSIONS AND VOLUME INFORMATION FOR CONSTRUCTION.

DMC DEL-MONT CONSULTANTS, INC. ENGINEERING • SURVEYING • PLANNING 122 Colorado Ave. • Montrose, CO 81401 • (970) 249-2291 • (970) 249-2242 www.del-mont.com • service@del-mont.com	
DESIGNED BY MGW	SCALE 1"=800'
CHECKED BY KS	FILE NAME: 10030C-MV 23-27 PAD SITE

SECTIONS 22,23,26&27, T6S, R96W, 6TH P.M.
WELL LOCATION PLAT
GM 421-26
WELL PAD MV 23-27
GARFIELD COUNTY, CO
WILLIAMS PRODUCTION, RMT

DMC JOB NO	10030
DATE ISSUED	2008-11-04
DATE SURVEYED	2008-09-29
PLAT	1 of 9