

KERR MCGEE OIL & GAS ONSHORE LP

Location: COLORADO Slot: SLOT#03 NRC 10-8 (1043'FSL & 1381'FEL)
 Field: WELD COUNTY (KERR MCGEE) Well: NRC 10-8
 Facility: SEC.08-T1N-R67W Wellbore: NRC 10-8 PWB

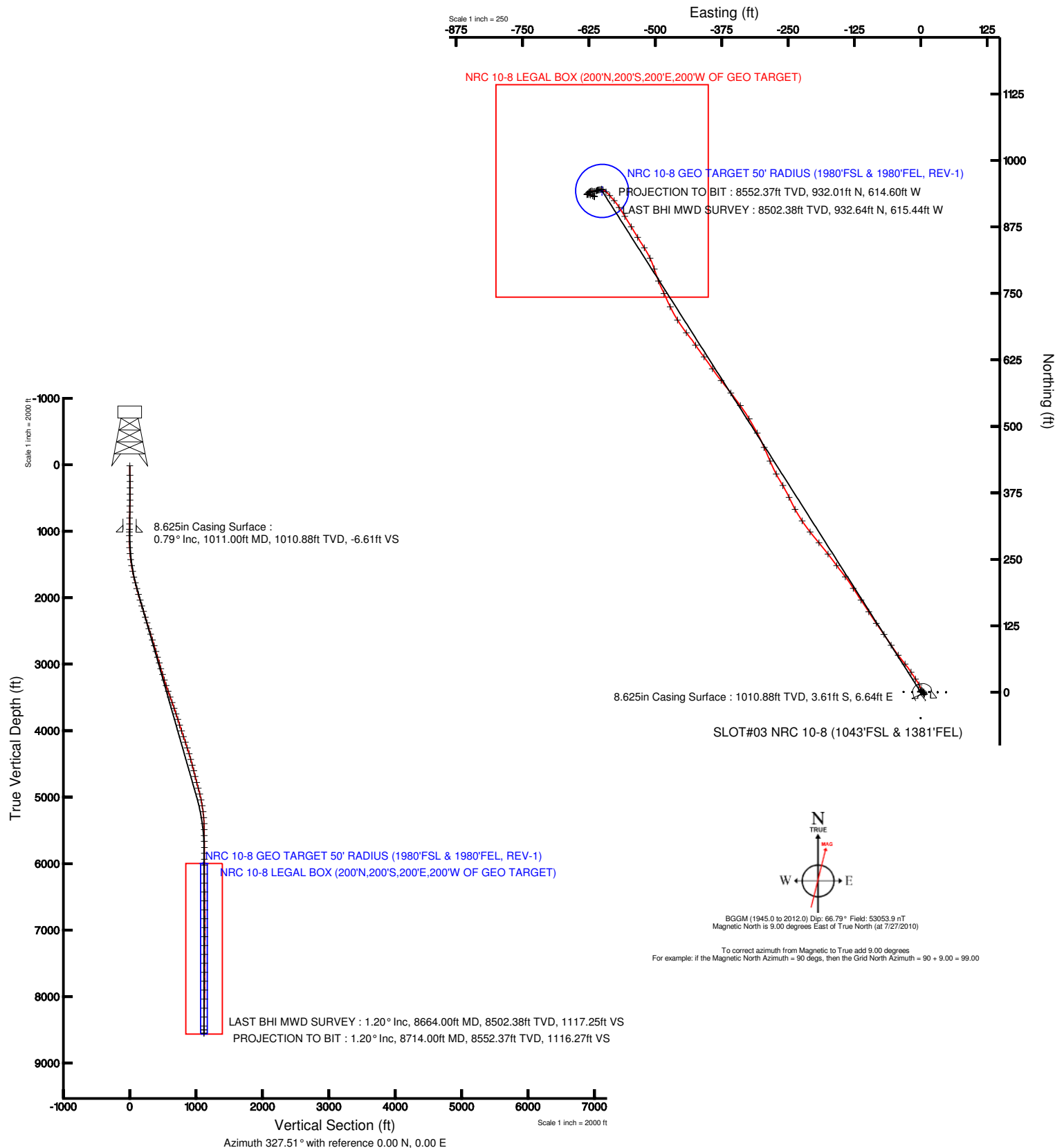

Plot reference wellpath is NRC 10-8 (REV-B.0) PWP	
True vertical depths are referenced to XTREME 12 (RT)	Grid System: NAD83 / Lambert Colorado State Planes, Northern Zone (501), US feet
Measured depths are referenced to XTREME 12 (RT)	North Reference: True north
XTREME 12 (RT) to Mean Sea Level: 5071 feet	Scale: True distance
Mean Sea Level to Mud line (Facility: SEC.08-T1N-R67W): 0 feet	Depths are in feet
Coordinates are in feet referenced to Slot	Created by: bensjacj on 7/27/2010





Actual Wellpath Report

NRC 10-8 AWP

Page 1 of 5



INTEQ

REFERENCE WELLPATH IDENTIFICATION

Operator	KERR MCGEE OIL & GAS ONSHORE LP	Slot	SLOT#03 NRC 10-8 (1043'FSL & 1381'FEL)
Area	COLORADO	Well	NRC 10-8
Field	WELD COUNTY (KERR MCGEE)	Wellbore	NRC 10-8 AWB
Facility	SEC.08-T1N-R67W		

REPORT SETUP INFORMATION

Projection System	NAD83 / Lambert Colorado State Planes, Northern Zone (501), US feet	Software System	WellArchitect® 2.0
North Reference	True	User	Bensjacj
Scale	0.999962	Report Generated	7/27/2010 at 3:46:54 PM
Convergence at slot	0.38° East	Database/Source file	WA_Denver/NRC_10-8_AWB.xml

WELLPATH LOCATION

	Local coordinates		Grid coordinates		Geographic coordinates	
	North[ft]	East[ft]	Easting[USft]	Northing[USft]	Latitude	Longitude
Slot Location	-0.36	32.19	3165132.20	1265676.31	40°03'40.187"N	104°54'36.115"W
Facility Reference Pt			3165100.01	1265676.46	40°03'40.190"N	104°54'36.529"W
Field Reference Pt			3197771.84	1268891.29	40°04'09.600"N	104°47'36.000"W

WELLPATH DATUM

Calculation method	Minimum curvature	XTREME 12 (RT) to Facility Vertical Datum	5071.00ft
Horizontal Reference Pt	Slot	XTREME 12 (RT) to Mean Sea Level	5071.00ft
Vertical Reference Pt	XTREME 12 (RT)	Facility Vertical Datum to Mud Line (Facility)	0.00ft
MD Reference Pt	XTREME 12 (RT)	Section Origin	N 0.00, E 0.00 ft
Field Vertical Reference	Mean Sea Level	Section Azimuth	327.51°



Actual Wellpath Report

NRC 10-8 AWP

Page 2 of 5



INTEQ

REFERENCE WELLPATH IDENTIFICATION

Operator	KERR MCGEE OIL & GAS ONSHORE LP	Slot	SLOT#03 NRC 10-8 (1043'FSL & 1381'FEL)
Area	COLORADO	Well	NRC 10-8
Field	WELD COUNTY (KERR MCGEE)	Wellbore	NRC 10-8 AWP
Facility	SEC.08-T1N-R67W		

WELLPATH DATA (90 stations) † = interpolated/extrapolated station

MD [ft]	Inclination [°]	Azimuth [°]	TVD [ft]	Vert Sect [ft]	North [ft]	East [ft]	DLS [°/100ft]	Comments
0.00†	0.000	318.800	0.00	0.00	0.00	0.00	0.00	
15.00	0.000	318.800	15.00	0.00	0.00	0.00	0.00	
155.00	0.400	318.800	155.00	0.48	0.37	-0.32	0.29	
250.00	0.200	18.200	250.00	0.92	0.77	-0.49	0.36	
345.00	0.400	18.500	345.00	1.23	1.25	-0.33	0.21	
440.00	0.600	48.000	439.99	1.52	1.89	0.14	0.34	
530.00	1.200	62.500	529.98	1.52	2.64	1.33	0.71	
621.00	1.700	122.900	620.96	0.21	2.35	3.31	1.67	
711.00	1.500	142.300	710.92	-2.18	0.69	5.15	0.64	
801.00	0.500	211.500	800.91	-3.53	-0.57	5.66	1.56	
891.00	1.100	158.800	890.90	-4.55	-1.71	5.77	0.99	
970.00	1.000	153.200	969.89	-5.97	-3.04	6.36	0.18	
1067.00	0.500	154.600	1066.88	-7.24	-4.17	6.92	0.52	
1157.00	1.100	315.200	1156.88	-6.78	-3.91	6.48	1.76	
1247.00	3.500	322.600	1246.80	-3.20	-1.12	4.20	2.68	
1337.00	5.200	337.700	1336.54	3.55	4.84	0.99	2.26	
1427.00	7.100	332.800	1426.02	13.10	13.56	-3.10	2.19	
1518.00	9.100	325.400	1516.11	25.90	24.49	-9.76	2.47	
1605.00	11.500	327.500	1601.70	41.45	37.46	-18.33	2.79	
1693.00	13.100	320.500	1687.68	60.12	52.56	-29.39	2.48	
1784.00	14.000	324.000	1776.15	81.34	69.42	-42.42	1.34	
1874.00	15.400	325.800	1863.20	104.15	88.12	-55.54	1.64	
1964.00	16.200	326.100	1949.80	128.65	108.42	-69.25	0.89	
2053.00	16.700	324.700	2035.16	153.83	129.16	-83.57	0.72	
2142.00	17.500	328.200	2120.22	179.99	150.97	-98.01	1.46	
2231.00	17.100	325.400	2205.20	206.45	173.12	-112.49	1.04	
2322.00	16.700	327.900	2292.27	232.89	195.20	-127.04	0.91	
2413.00	16.900	322.600	2379.39	259.14	216.79	-142.02	1.70	
2502.00	17.800	322.600	2464.34	285.59	237.87	-158.14	1.01	
2591.00	17.800	323.000	2549.08	312.70	259.54	-174.59	0.14	
2682.00	17.100	319.500	2635.89	339.82	280.83	-191.65	1.39	
2772.00	17.000	321.900	2721.94	366.01	301.24	-208.36	0.79	
2862.00	16.300	326.100	2808.17	391.74	322.08	-223.52	1.55	
2952.00	16.400	331.400	2894.53	417.04	343.72	-236.65	1.66	
3041.00	16.700	334.900	2979.85	442.26	366.33	-248.09	1.17	
3131.00	15.700	328.900	3066.28	467.26	388.47	-259.87	2.17	
3221.00	16.700	331.700	3152.71	492.33	410.28	-272.29	1.41	
3311.00	18.100	336.700	3238.59	519.03	434.51	-283.95	2.27	
3399.00	18.800	336.700	3322.07	546.52	460.09	-294.97	0.80	
3490.00	20.100	331.700	3407.88	576.59	487.33	-308.18	2.32	
3580.00	19.700	328.900	3492.51	607.18	513.93	-323.35	1.15	
3670.00	19.400	324.100	3577.32	637.27	539.03	-339.95	1.82	
3760.00	19.200	321.900	3662.27	666.92	562.79	-357.84	0.84	
3850.00	19.000	321.900	3747.31	696.23	585.96	-376.02	0.22	
3938.00	17.800	325.100	3830.81	723.92	608.27	-392.55	1.78	



Actual Wellpath Report

NRC 10-8 AWP

Page 3 of 5



REFERENCE WELLPATH IDENTIFICATION

Operator	KERR MCGEE OIL & GAS ONSHORE LP	Slot	SLOT#03 NRC 10-8 (1043'FSL & 1381'FEL)
Area	COLORADO	Well	NRC 10-8
Field	WELD COUNTY (KERR MCGEE)	Wellbore	NRC 10-8 AWP
Facility	SEC.08-T1N-R67W		

WELLPATH DATA (90 stations)

MD [ft]	Inclination [°]	Azimuth [°]	TVD [ft]	Vert Sect [ft]	North [ft]	East [ft]	DLS [°/100ft]	Comments
4028.00	17.400	323.700	3916.60	751.10	630.39	-408.39	0.65	
4118.00	18.000	325.400	4002.34	778.42	652.69	-424.25	0.88	
4209.00	19.200	321.600	4088.59	807.36	675.99	-441.53	1.87	
4299.00	18.700	328.200	4173.72	836.51	699.85	-458.33	2.44	
4389.00	17.900	334.600	4259.18	864.66	724.61	-471.87	2.40	
4480.00	17.400	334.900	4345.89	892.03	749.57	-483.64	0.56	
4570.00	16.200	338.400	4432.05	917.71	773.43	-493.97	1.74	
4660.00	14.700	342.600	4518.80	941.06	796.00	-502.00	2.08	
4748.00	14.000	334.100	4604.06	962.42	816.23	-509.99	2.52	
4838.00	14.800	327.500	4691.24	984.73	835.72	-520.93	2.03	
4929.00	14.900	328.600	4779.20	1008.05	855.51	-533.27	0.33	
5020.00	14.900	328.200	4867.14	1031.45	875.44	-545.53	0.11	
5110.00	14.300	328.400	4954.24	1054.13	894.74	-557.45	0.67	
5201.00	11.300	326.500	5042.96	1074.29	911.75	-568.26	3.33	
5290.00	9.100	319.000	5130.56	1089.97	924.33	-577.69	2.88	
5380.00	7.100	320.900	5219.65	1102.54	934.02	-585.87	2.24	
5470.00	5.700	306.100	5309.10	1112.22	940.97	-592.99	2.39	
5560.00	3.000	305.400	5398.83	1118.57	944.97	-598.52	3.00	
5650.00	1.500	254.100	5488.77	1121.09	946.01	-601.58	2.63	
5740.00	1.000	248.400	5578.74	1121.57	945.40	-603.44	0.57	
5828.00	0.900	260.700	5666.73	1121.99	945.01	-604.84	0.26	
5919.00	1.200	258.600	5757.72	1122.61	944.70	-606.47	0.33	
6008.00	0.900	254.400	5846.70	1123.15	944.33	-608.06	0.35	
6098.00	1.000	244.600	5936.69	1123.45	943.80	-609.45	0.21	
6188.00	0.700	234.400	6026.68	1123.52	943.15	-610.61	0.37	
6321.00	1.000	253.000	6159.66	1123.79	942.34	-612.38	0.30	
6455.00	1.000	256.900	6293.64	1124.49	941.73	-614.64	0.05	
6589.00	0.900	278.000	6427.63	1125.56	941.61	-616.82	0.27	
6724.00	0.900	293.800	6562.61	1127.13	942.19	-618.84	0.18	
6859.00	0.700	268.100	6697.60	1128.43	942.59	-620.63	0.30	
6993.00	0.800	240.400	6831.59	1128.89	942.10	-622.26	0.28	
7127.00	0.800	240.400	6965.57	1128.99	941.17	-623.89	0.00	
7261.00	0.400	207.000	7099.57	1128.80	940.29	-624.91	0.38	
7395.00	0.700	224.500	7233.56	1128.38	939.29	-625.70	0.25	
7530.00	1.000	230.900	7368.54	1128.06	937.96	-627.19	0.23	
7663.00	0.300	209.400	7501.53	1127.76	936.93	-628.26	0.55	
7799.00	0.400	223.100	7637.53	1127.47	936.27	-628.76	0.10	
7933.00	0.200	82.900	7771.53	1127.25	935.96	-628.85	0.42	
8066.00	0.800	85.500	7904.53	1126.72	936.06	-627.70	0.45	
8202.00	1.300	104.700	8040.50	1125.14	935.74	-625.26	0.44	
8337.00	1.500	107.500	8175.46	1122.67	934.82	-622.09	0.16	
8472.00	1.700	107.500	8310.41	1119.78	933.69	-618.50	0.15	
8608.00	0.400	97.600	8446.38	1117.93	933.02	-616.10	0.96	
8664.00	1.200	126.800	8502.38	1117.25	932.64	-615.44	1.56	LAST BHI MWD SURVEY
8714.00	1.200	126.800	8552.37	1116.27	932.01	-614.60	0.00	PROJECTION TO BIT



Actual Wellpath Report

NRC 10-8 AWP

Page 4 of 5



INTEQ

REFERENCE WELLPATH IDENTIFICATION

Operator	KERR MCGEE OIL & GAS ONSHORE LP	Slot	SLOT#03 NRC 10-8 (1043'FSL & 1381'FEL)
Area	COLORADO	Well	NRC 10-8
Field	WELD COUNTY (KERR MCGEE)	Wellbore	NRC 10-8 AWB
Facility	SEC.08-T1N-R67W		

HOLE & CASING SECTIONS Ref Wellbore: NRC 10-8 AWB Ref Wellpath: NRC 10-8 AWP

String/Diameter	Start MD [ft]	End MD [ft]	Interval [ft]	Start TVD [ft]	End TVD [ft]	Start N/S [ft]	Start E/W [ft]	End N/S [ft]	End E/W [ft]
12.25in Open Hole	15.00	1025.00	1010.00	15.00	1024.88	0.00	0.00	-3.77	6.73
8.625in Casing Surface	15.00	1011.00	996.00	15.00	1010.88	0.00	0.00	-3.61	6.64
7.875in Open Hole	1011.00	8714.00	7703.00	1010.88	8552.37	-3.61	6.64	932.01	-614.60

TARGETS

Name	MD [ft]	TVD [ft]	North [ft]	East [ft]	Grid East [srv ft]	Grid North [srv ft]	Latitude	Longitude	Shape
NRC 10-8 GEO TARGET 50' RADIUS (1980'FSL & 1980'FEL, REV-1)		6000.00	942.79	-600.39	3164525.58	1266615.05	40°03'49.504"N	104°54'43.837"W	circle
NRC 10-8 LEGAL BOX (200'N,200'S,200'E,200'W OF GEO TARGET)		6000.00	942.79	-600.39	3164525.58	1266615.05	40°03'49.504"N	104°54'43.837"W	square

WELLPATH COMPOSITION Ref Wellbore: NRC 10-8 AWB Ref Wellpath: NRC 10-8 AWP

Start MD [ft]	End MD [ft]	Positional Uncertainty Model	Log Name/Comment	Wellbore
15.00	8664.00	NaviTrak (Standard)	BHI MWD <155-8664>	NRC 10-8 AWB
8664.00	8714.00	Blind Drilling (std)	Projection to bit	NRC 10-8 AWB



Actual Wellpath Report

NRC 10-8 AWP

Page 5 of 5



INTEQ

REFERENCE WELLPATH IDENTIFICATION

Operator	KERR MCGEE OIL & GAS ONSHORE LP	Slot	SLOT#03 NRC 10-8 (1043'FSL & 1381'FEL)
Area	COLORADO	Well	NRC 10-8
Field	WELD COUNTY (KERR MCGEE)	Wellbore	NRC 10-8 AWB
Facility	SEC.08-T1N-R67W		

WELLPATH COMMENTS

MD [ft]	Inclination [°]	Azimuth [°]	TVD [ft]	Comment
8664.00	1.200	126.800	8502.38	LAST BHI MWD SURVEY
8714.00	1.200	126.800	8552.37	PROJECTION TO BIT