

Encana OIL & GAS (USA) INC.

LOCATION DRAWING FOR

WELL PAD F17 595  
SECTION 17, T5S, R95W, 6th P.M.  
SE 1/4 NW 1/4

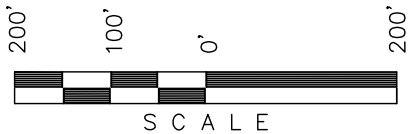

Sheet 7a of 11



SCALE: 1" = 200'  
DATE: 09-28-10  
DRAWN BY: D.R.B.  
Revised: 10-18-10 D.R.B.  
Revised: 10-21-10 D.R.B.



1/4 Section Line

1/16 Section Line

EXXON MOBIL CORPORATION

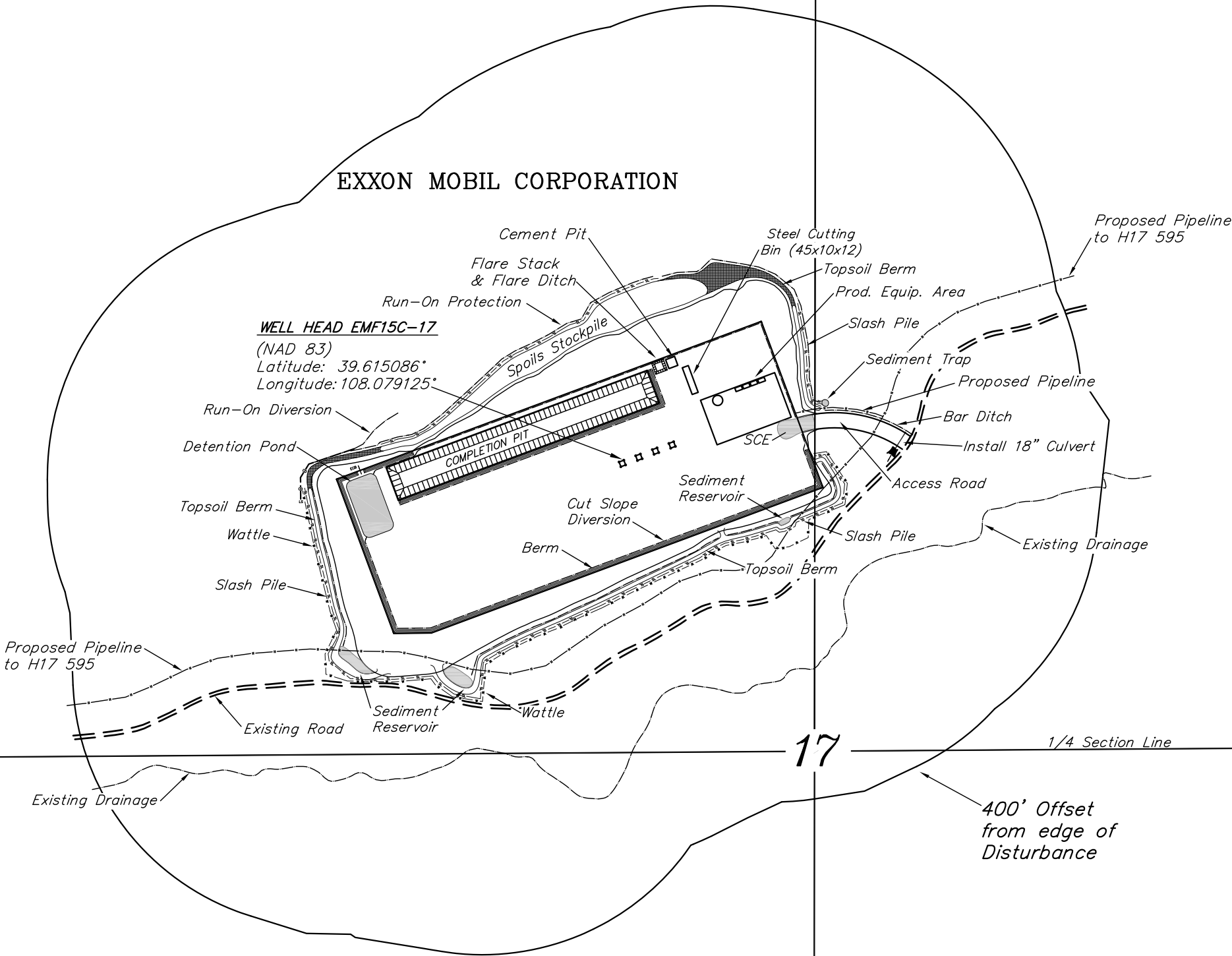

400' Offset  
from edge of  
Disturbance

EXXON MOBIL CORPORATION

**DISTURBANCE ACREAGE:**  
4.589 ± DRILLING OPERATIONS  
2.683 ± INTERIM RECLAIM

CURRENT LAND USE	
CROP LAND:	<input type="checkbox"/> IRRIGATED <input type="checkbox"/> DRY LAND <input type="checkbox"/> IMPROVED PASTURE <input type="checkbox"/> HAY MEADOW <input type="checkbox"/> CRP
NON-CROP LAND:	<input checked="" type="checkbox"/> RANGELAND <input type="checkbox"/> TIMBER <input type="checkbox"/> RECREATIONAL <input type="checkbox"/> OTHER (Describe) _____
SUBDIVIDED:	<input type="checkbox"/> INDUSTRIAL <input type="checkbox"/> COMMERCIAL <input type="checkbox"/> RESIDENTIAL _____

FUTURE LAND USE	
CROP LAND:	<input type="checkbox"/> IRRIGATED <input type="checkbox"/> DRY LAND <input type="checkbox"/> IMPROVED PASTURE <input type="checkbox"/> HAY MEADOW <input type="checkbox"/> CRP
NON-CROP LAND:	<input checked="" type="checkbox"/> RANGELAND <input type="checkbox"/> TIMBER <input type="checkbox"/> RECREATIONAL <input type="checkbox"/> OTHER (Describe) _____
SUBDIVIDED:	<input type="checkbox"/> INDUSTRIAL <input type="checkbox"/> COMMERCIAL <input type="checkbox"/> RESIDENTIAL _____

PLANT COMMUNITY	Existing Features	(Distance from EMF15C-17)
<input type="checkbox"/> DISTURBED GRASSLAND	Building	S30°W 16,450'
<input type="checkbox"/> NATIVE GRASSLAND	Public Road	S28°E 265'
<input type="checkbox"/> SHRUB LAND	Property Line	S41°E 1,670'
<input type="checkbox"/> PLAINS RIPARIAN	Utility	S64°W 7,450'
<input type="checkbox"/> MOUNTAIN RIPARIAN	Surface Water	S14°E 368'
<input checked="" type="checkbox"/> FOREST LAND	Railroad	S03°W 51,570'
<input type="checkbox"/> WETLANDS AQUATIC		
<input type="checkbox"/> ALPINE		
<input type="checkbox"/> OTHER (Describe): _____		

ENCANA OIL & GAS  
(USA) INC.

UINTAH ENGINEERING & LAND SURVEYING  
85 So. 200 East \* Vernal, Utah 84078 \* (435) 789-1017