

# VISIBLE IMPROVEMENTS

SECTION: 16  
TOWNSHIP: 4N  
RANGE: 66W

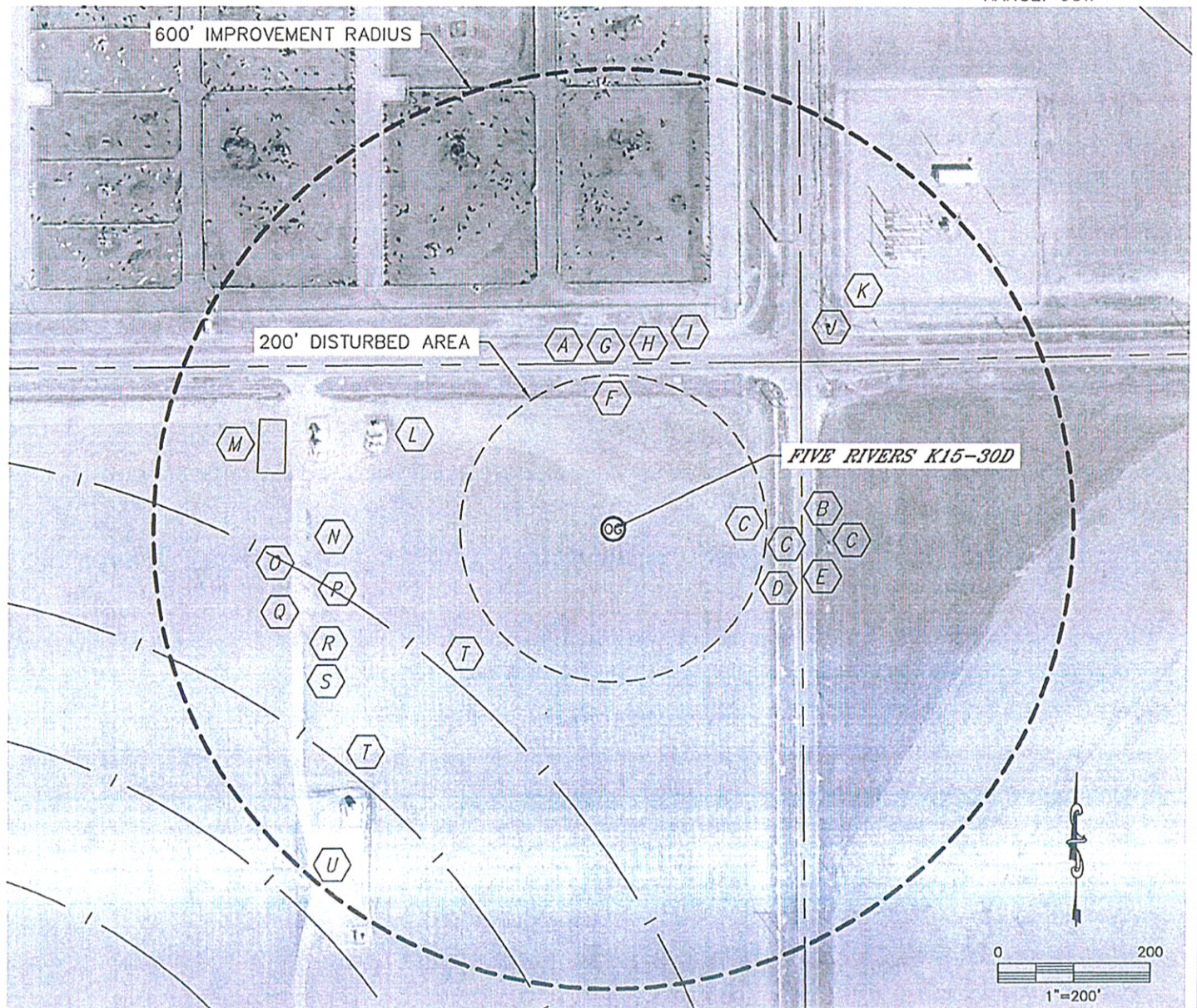

## IMPROVEMENTS:

- |   |   |
|---|---|
| (A) NEAREST PROPERTY LINE 215' NORTH            | (K) SUBSTATION 418' NORTHEAST               |
| (B) PROPERTY LINE 246' EAST                     | (L) SEPARATOR AND BURNER 315' NORTHWEST     |
| (C) OVERHEAD UTILITY LINE 202', 226', 281' EAST | (M) TANKS, SEPARATORS, BURNERS 435' NW      |
| (D) CONCRETE IRRIGATION DITCH 214' EAST         | (N) EX. WELL UPRC 9-10F 399' WEST           |
| (E) CENTERLINE PAVED ROAD 249' EAST             | (O) EX. WELL UPRC 9-9F 402' WEST            |
| (F) DIRT IRRIGATION DITCH 176' NORTH            | (P) EX. WELL UPRC 9-15F 407' SOUTHWEST      |
| (G) CENTERLINE PAVED ROAD 215' NORTH            | (Q) EX. WELL UPRC 9-16F 414' SOUTHWEST      |
| (H) OVERHEAD UTILITY LINE 242' NORTH            | (R) EX. WELL FIVE RIVERS K09-23D 429' SW    |
| (I) FEED LOT FENCE 245' NORTH                   | (S) EX. WELL FIVE RIVERS K16-27D 448' SW    |
| (J) PUMPHOUSE 377' NORTHEAST                    | (T) IRR PIVOT WHEEL TRACK 284', 463' SW     |
|   | (U) EX. WELL MONFORT GILCREST K16-1 609' SW |