

Location Drawing

SMARTT RANCH 33-2

NW¼ SE¼ SECTION 2, TOWNSHIP 22 SOUTH, RANGE 49 WEST OF THE 6TH PRINCIPAL MERIDIAN

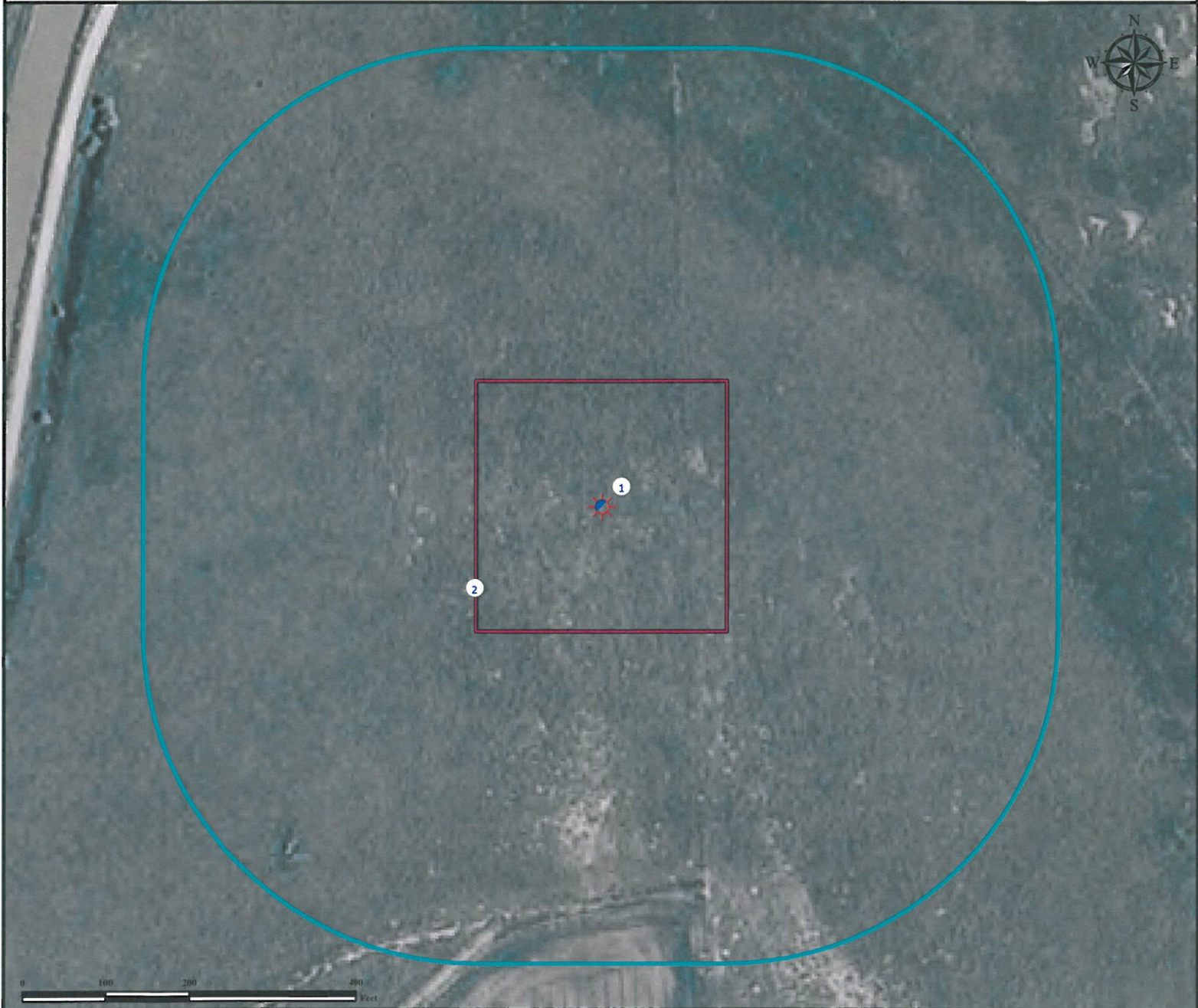

1. Proposed Well SMARTT RANCH 33-2.

2. Operational Disturbance Area.

There are no visible improvements within a 400' radius of the Disturbance Area of the proposed Oil and Gas location.

Legend



Proposed Well



Disturbance Area



400' Radius

Reference Location

** All Measurements are Made from
Reference Well

SMARTT RANCH 33-2 (NAD83) **

LAT: 38.164448° LONG: -102.874682°

Elevation: 3934 Feet

Surface Use: Rangeland



Use our resources to find yours!
www.petro-fs.com
(303) 928-7128

Field Date: 09/09/2010
Drafting Date: 09/10/2010
Drafter: DMM
Checked By: BHF

Data Sources:
- Aerial courtesy of NAIP (2009)

Prepared for:

**Petroleum
Development Corporation**