

ACCESS ROAD MAP
WHIPSAW 18-11-66

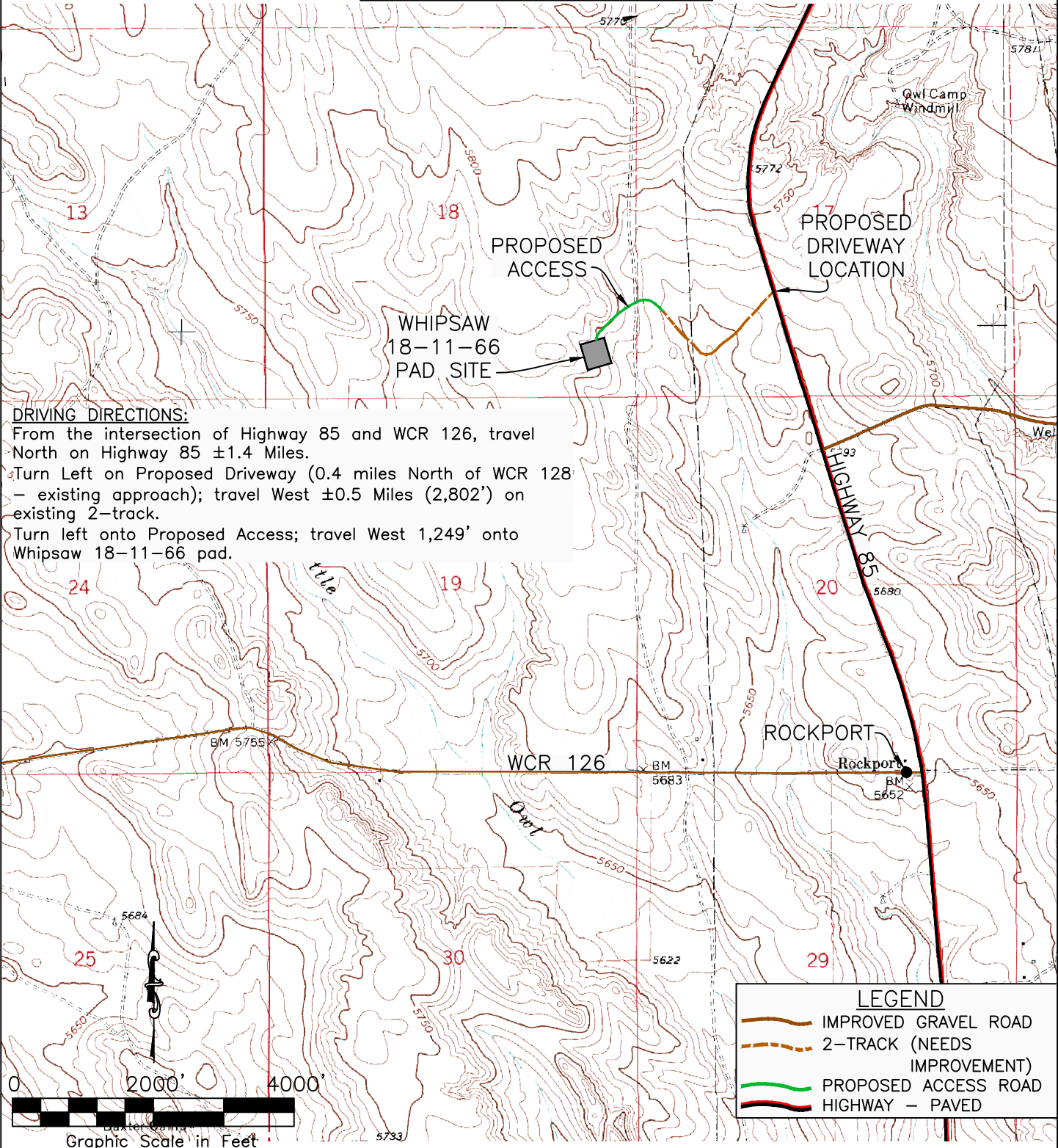

DRIVING DIRECTIONS:

From the intersection of Highway 85 and WCR 126, travel North on Highway 85 ±1.4 Miles.
 Turn Left on Proposed Driveway (0.4 miles North of WCR 128 – existing approach); travel West ±0.5 Miles (2,802') on existing 2-track.
 Turn left onto Proposed Access; travel West 1,249' onto Whipsaw 18-11-66 pad.

LEGEND	
	IMPROVED GRAVEL ROAD
	2-TRACK (NEEDS IMPROVEMENT)
	PROPOSED ACCESS ROAD
	HIGHWAY – PAVED



WESTERN LAND SERVICES
 Sheridan, WY 82801 (307)673-1817

DP: L:\Slawson\Permitting_Booklets\Whipsa...Date: 9/24/2010

SLAWSON EXPLORATION COMPANY, INC
 WHIPSAW 18-11-66

SL: SE1/4 SE1/4, SECTION 18, T11N R66W
 BL: NW1/4 NE1/4, SECTION 18, T11N R66W
 6TH PM, WELD COUNTY, COLORADO