

# ACCESS ROAD MAP

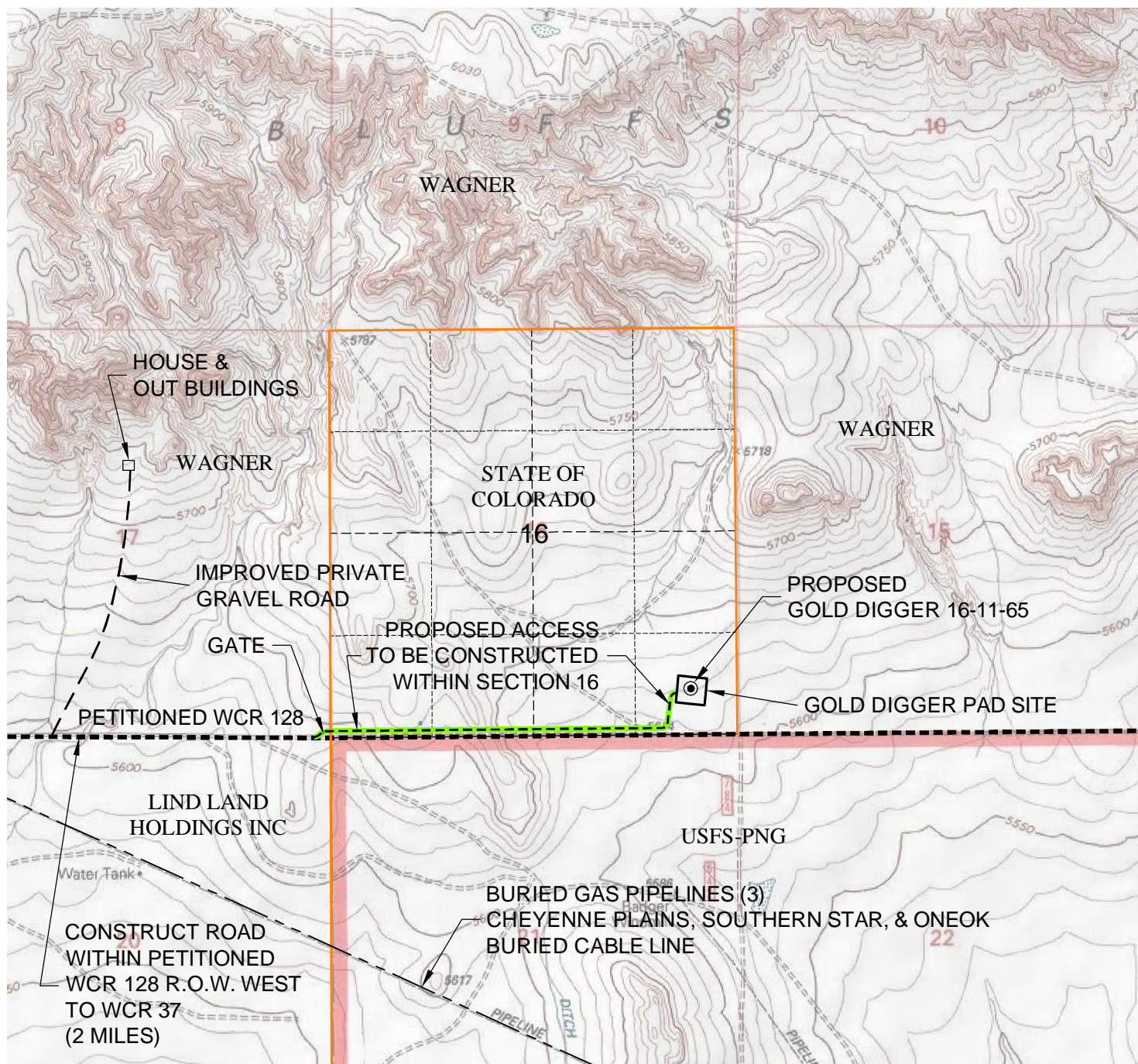

## LEGEND

- PETITIONED COUNTY ROAD DIRT SURFACE
- PROPOSED ACCESS

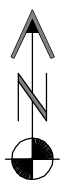

North



Graphic Scale in Feet  
1 inch = 2000 feet

## DRIVING DIRECTIONS:

- MP 0.0 - Intersection of Highway 85 & WCR 126 in Rockport; north along Highway 85
- MP 0.9 - Right on WCR 128; east along WCR 128
- MP 5.6 - Intersection with WCR 37; continue east along petitioned WCR 128
- MP 7.6 - Left on new access to pad
- MP 8.6 - Gold Digger 16-11-65 Pad

9/28/10



LAND SURVEYING AND MAPPING  
LAFAYETTE - WINTER PARK  
Ph 303 666 0379 Fx 303 665 6320

**SLAWSON EXPLORATION CO., INC.**  
**GOLD DIGGER 16-11-65 PAD**

**SE1/4 SE1/4 SEC. 16 T11N R65W**  
**6th PM WELD COUNTY COLORADO**