

Location Drawing

CONRAD 24-05 3N45W

SE¼ SW¼ SECTION 5, TOWNSHIP 3 NORTH, RANGE 45 WEST OF THE 6TH PRINCIPAL MERIDIAN

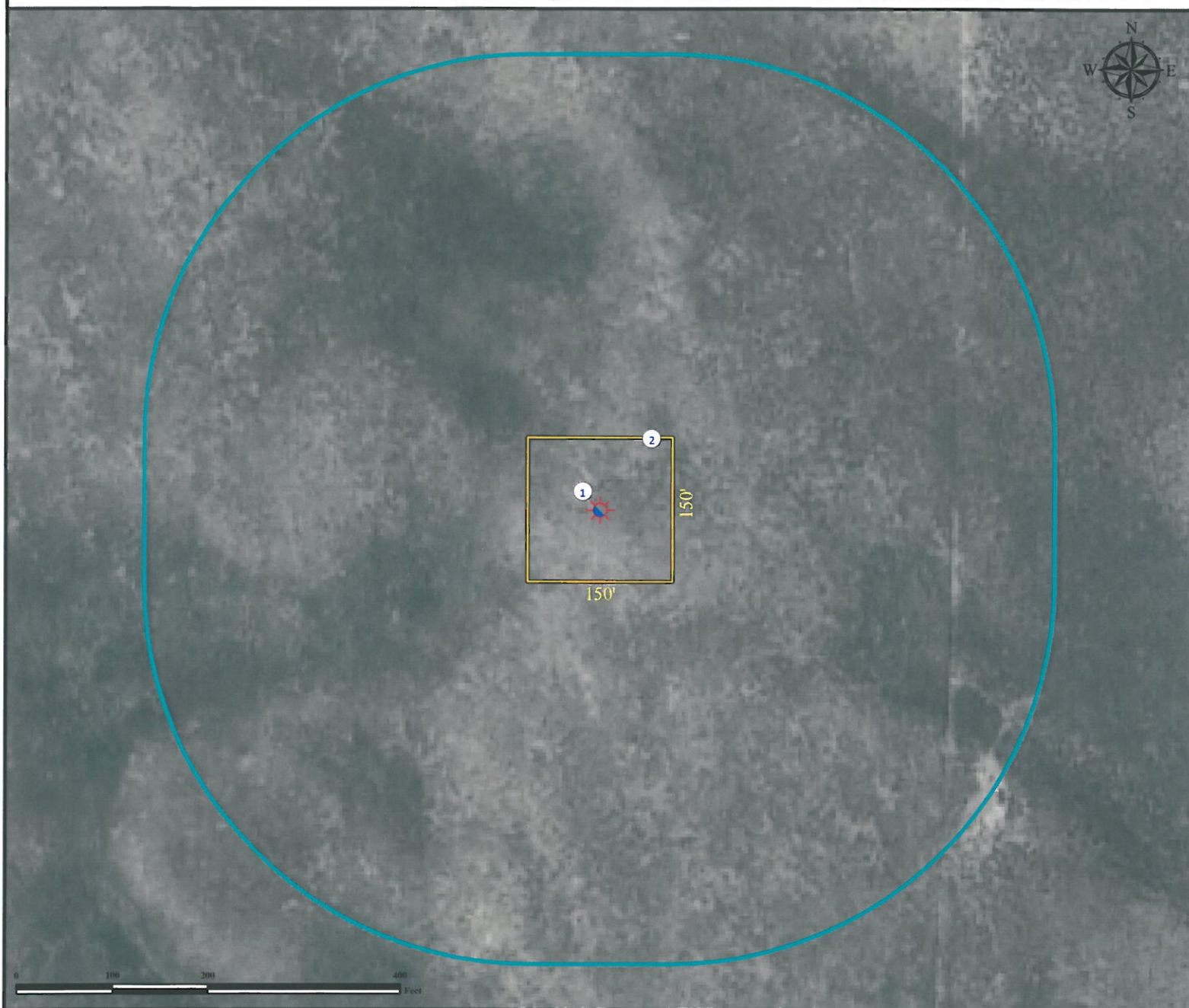

1. Proposed Well CONRAD 24-05 3N45W.

2. Operational Disturbance Area.

There are No Visible Improvements Within the 400' Radius of the Operational Disturbance Area of the Proposed Oil & Gas Location.

Legend



Proposed Well



400' Radius



Disturbance Area

Reference Location

** All Measurements are Made from
Reference Well

CONRAD 24-05 3N45W **

LAT: 40.251479° LONG: -102.425931° (NAD 83)

Elevation: 3845 Feet

Surface Use: Grass



Use our resources to find yours!
www.petro-fs.com
(303) 928-7128

Field Date: 08/24/2010
Drafting Date: 08/28/2010
Drafter: DMM
Checked By: BHF

Data Sources:
- Aerial courtesy of NAIP (2009)

Prepared for:

