

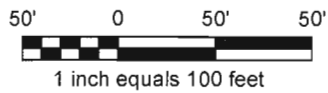

XTO ENERGY INC. - HENRY #2-3
919' FNL, 912' FEL, SECTION 2, T-32-N, R-07-W, N.M.P.M.,
LA PLATA COUNTY, COLORADO ELEVATION AT STAKE = 6,322' NAVD 88

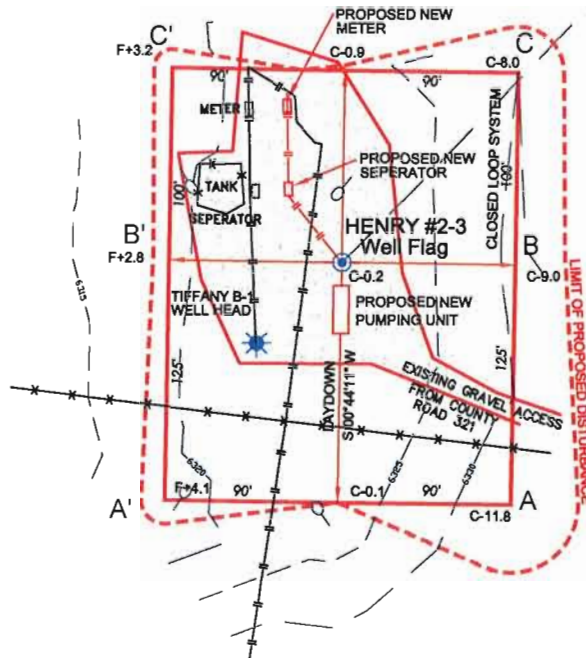

- NOTES:
1. DATE OF FIELD SURVEY 4/07/10
 2. THE LOCATIONS OF UNDERGROUND UTILITIES DEPICTED ARE APPROXIMATE. ACTUAL LOCATIONS OF UNDERGROUND UTILITIES MUST BE FIELD VERIFIED PRIOR TO CONSTRUCTION.
 3. ELEVATION DATUM - NAVD88
 4. CONTOURS SHOWN AT 5' INTERVALS

A-A'

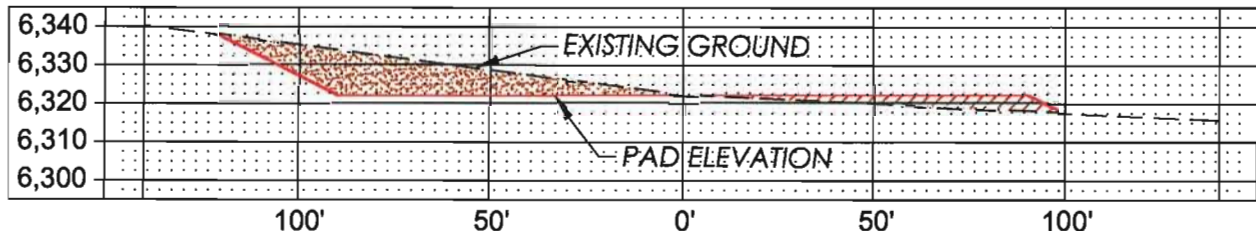

HOR. SCALE: 1"=50'
VER. SCALE: 1"=50'

B-B'

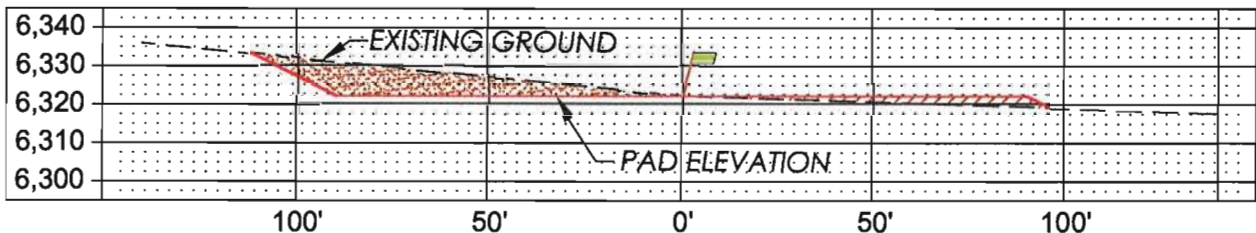

C-C'

