

LOCATION DRAWING  
IGLOO 32-12-66

<u>IGLOO 32-12-66 WELLHEAD</u>
LATITUDE: 40.962904
LONGITUDE: -104.808037
FOOTAGE: 1955' FSL 635' FWL
GROUND ELEV: 6002'
PDOP: 2.6
INSTRUMENT OPERATOR: CLAYTON ROSENLUND

VEGETATION:  
NATIVE GRASSLAND  
SURFACE USE:  
RANGELAND

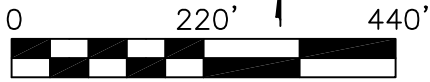

Graphic Scale in Feet  
1 Inch = 220 Feet

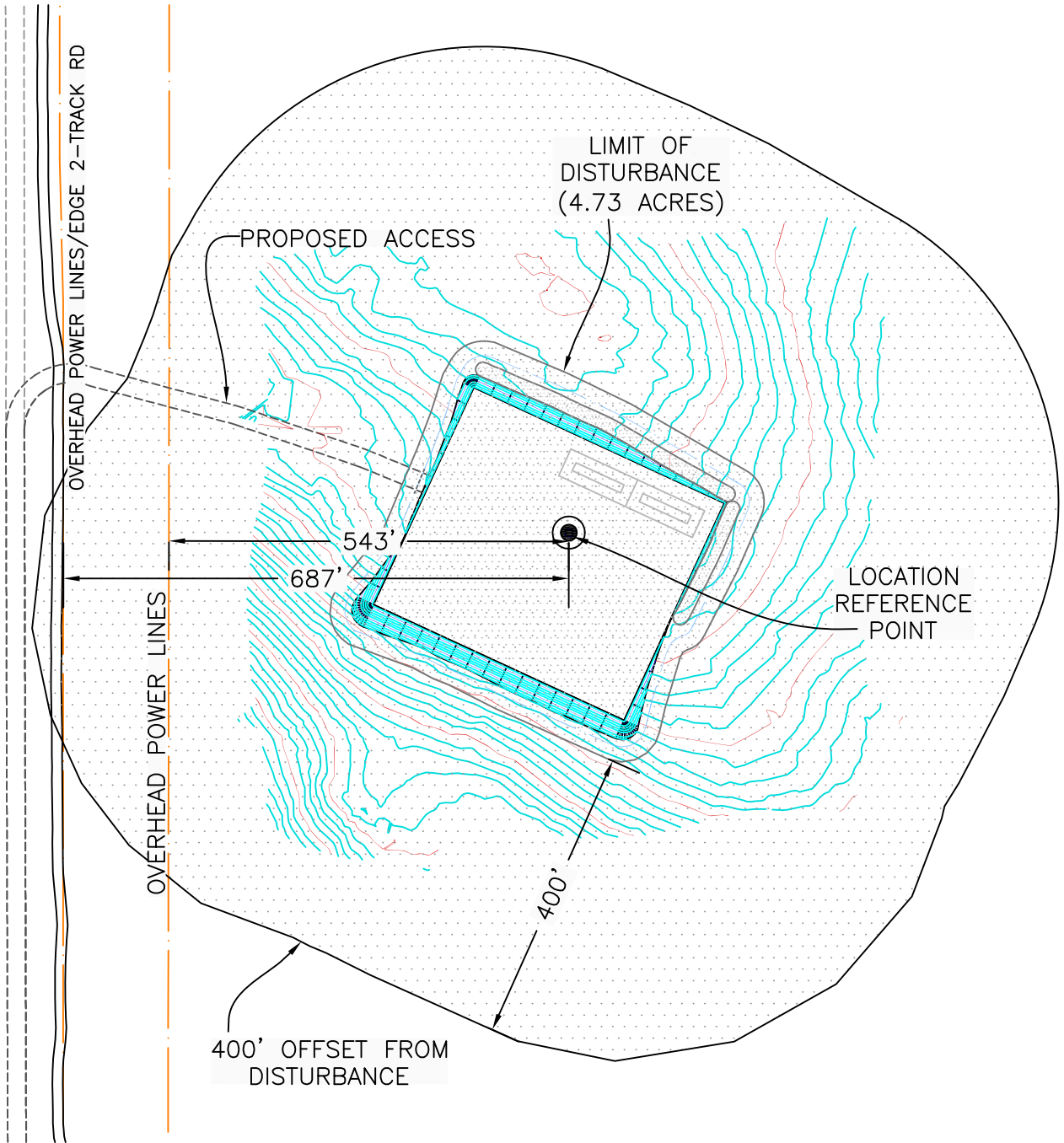

**WESTERN LAND SERVICES**  
Sheridan, WY 82801 (307)673-1817  
DP: L:\...Slawson\Permitting\_Booklets\Igloo... Date: 9/02/2010

SLAWSON EXPLORATION COMPANY, INC  
IGLOO 32-12-66  
SL: NW1/4 SW1/4, SECTION 32, T12N R66W  
BL: SE1/4 SE1/4, SECTION 32, T12N R66W  
6TH PM, WELD COUNTY, COLORADO