

LOCATION

SEC 32, T6N, R65W & SEC 5, T6N, R65W



LEGEND

- SECTION LINE
- QUARTER SECTION LINE
- SIXTEENTH LINE
- (BH) BOTTOM HOLE LOCATION
- PROPOSED
- EXISTING

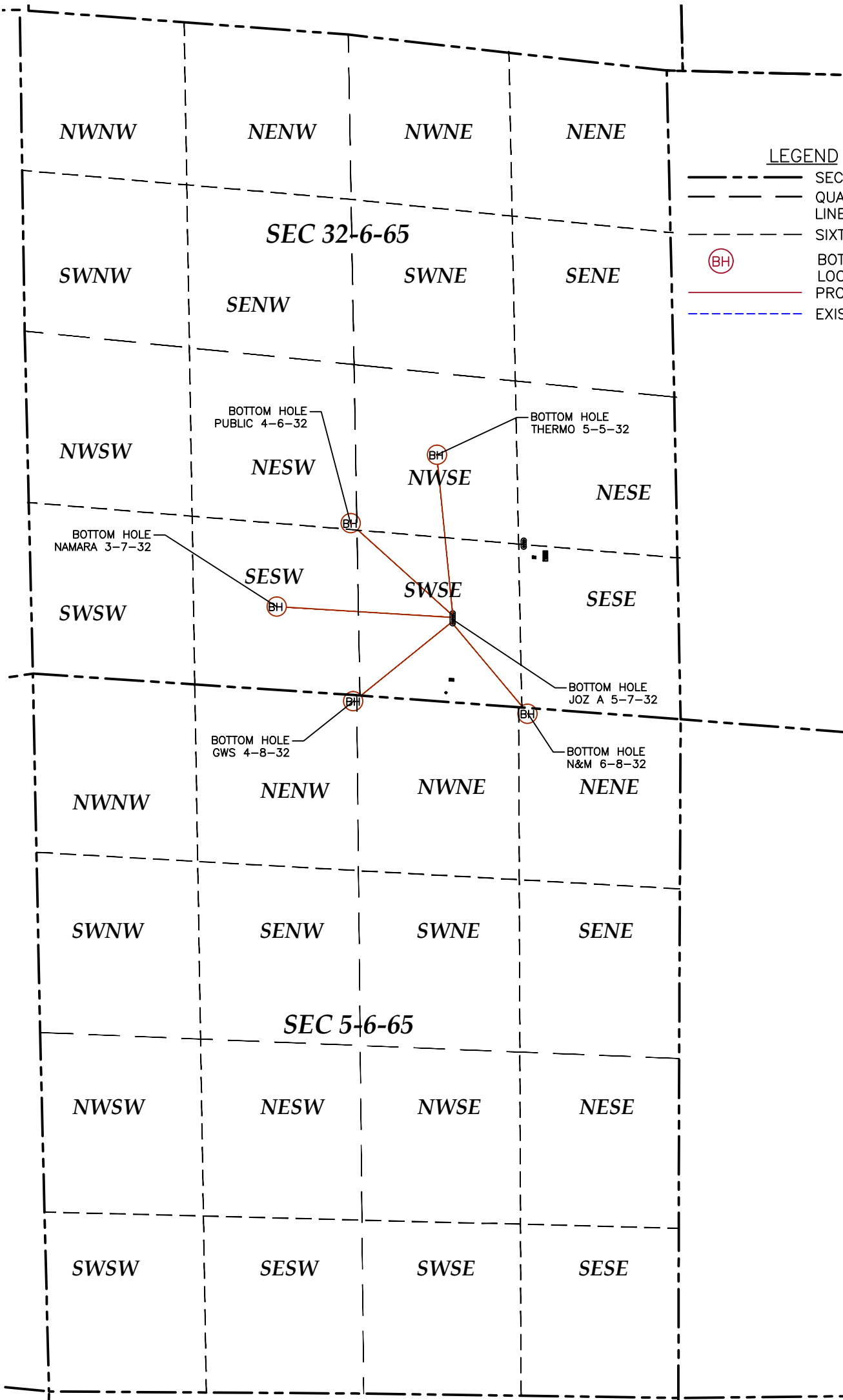

LAMP RYNEARSON
& ASSOCIATES

4715 Innovation Dr.
Fort Collins, Co 80525
www.LRA-Inc.com
970.226.0342 | P
970.226.0879 | F

MULTI-WELL
PLAN MAP

drawn by: EKM
surveyor: DDH
job number-tasks: 0209021.00
date: 08/09/2010
scale: 1" = 1000' page:
Form 2A Exhibits SWSE
file name: Pad.dwg