

APPROX. AREA OF DISTURBANCE: 6.6 ACRES±
UNGRADED ELEVATION: 6575.8'
FINISHED ELEVATION: 6572.6'
CUT/FILL SLOPES = 1.5:1

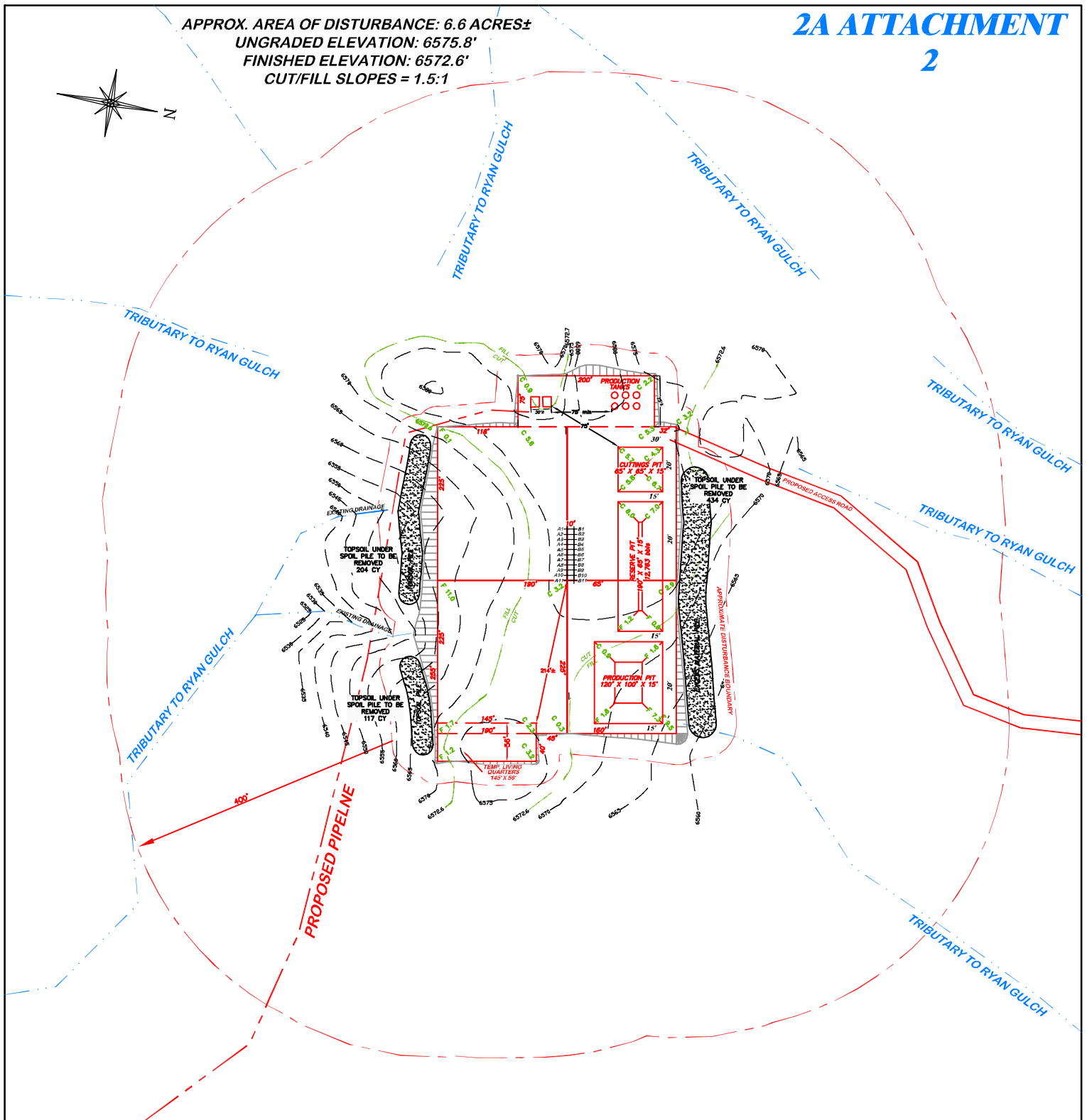

**BEFORE DIGGING
CALL FOR
UTILITY LINE LOCATION**

NOTE: THE EARTH QUANTITIES ON
THIS DRAWING ARE ESTIMATED
AND THE USE OF THIS IS AT THE
RESPONSIBILITY OF THE USER.

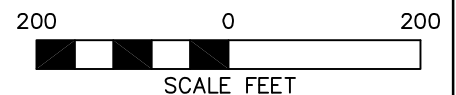

FEDERAL RGU 41-1-298 PAD

DRG RIFFIN & ASSOCIATES, INC.
(307) 362-5028 1414 ELK ST., ROCK SPRINGS, WY 82901

DRAWN: 8/2/10 - SJC

SCALE: 1" = 200'

REVISED: 8/19/10 - DEH

DRG JOB No. 14550

REVISED PITS

EXHIBIT 2D

LOCATION DRAWING

WILLIAMS PRODUCTION RMT COMPANY
FEDERAL RGU 31, 41, 42, 331, 332, 341, 342, 411, 431,
432, 441, 442, 532, 542, 544-1-298, 11, 12, 311, 411,
511-6-297 NENE, SECTION 1, T2S, R98W, 6th P.M.

UNGRADED ELEVATION: 6575.8'
FINISHED ELEVATION: 6572.6'