

**APPROX. EXISTING DISTURBANCE: 5.8± ACRES  
FINISHED ELEVATION: 6543.7'**

**APPROX. NEW AREA OF  
DISTURBANCE: 0.2± ACRES**  
**FINAL TEMPORARY LIVING  
QUARTERS ELEVATION: 6543.7'**  
**CUT: 107 CY**  
**FILL: 2055 CY**  
**SLOPE RATIO: 1:1.5**

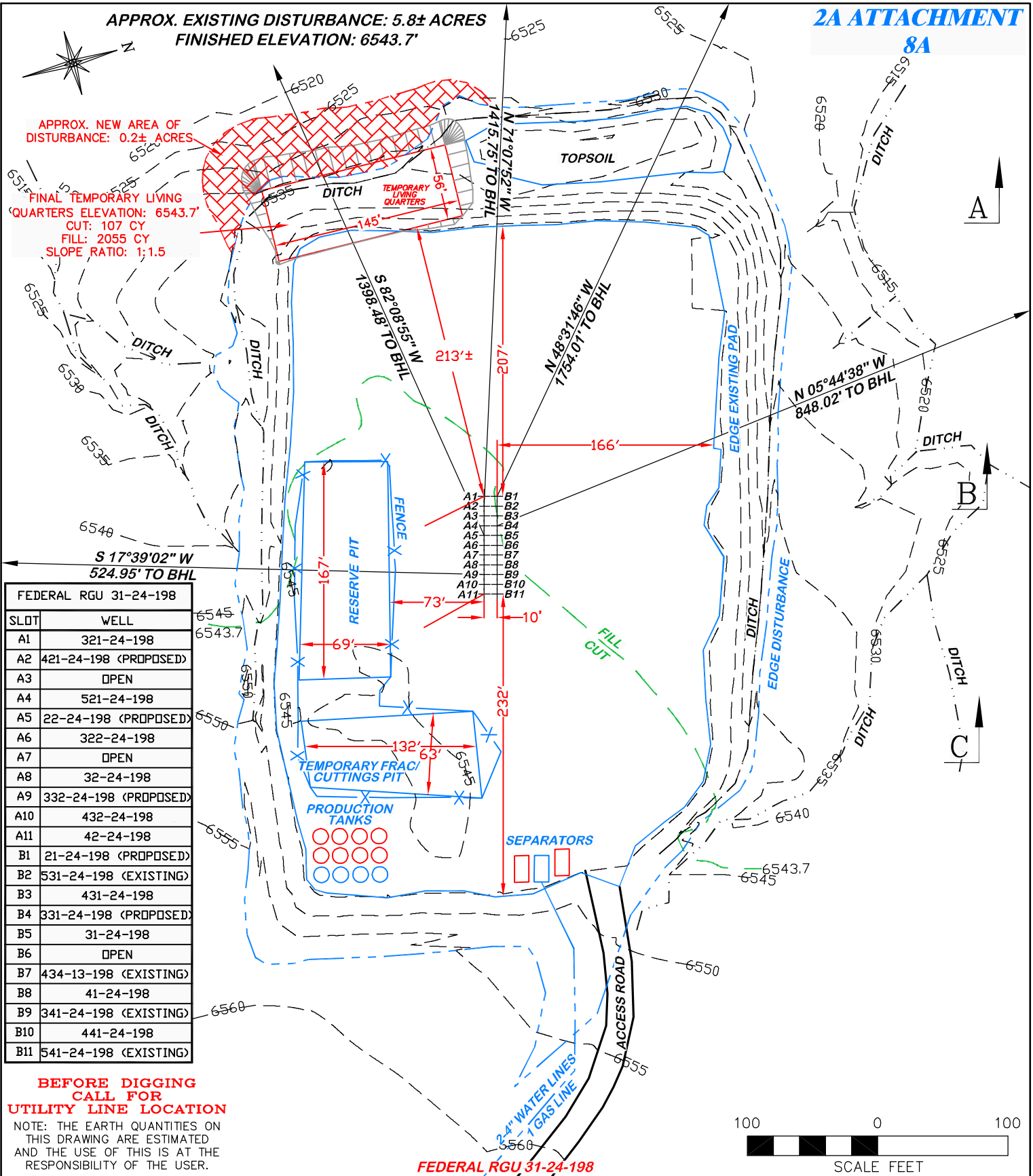

**FEDERAL RGU 31-24-198**

**DRG RIFFIN & ASSOCIATES, INC.**  
1414 ELK ST., ROCK SPRINGS, WY 82901  
(307) 362-5028

**CONSTRUCTION LAYOUT DRAWING 1 OF 4**

**WILLIAMS PRODUCTION RMT COMPANY**  
**FEDERAL RGU 21, 22, 33, 32, 41, 42, 321, 322, 331, 332,**  
**341, 421, 431, 432, 441, 521, 531, 541-24-198 & NRG**  
**434-13-198**  
**NWNE, SECTION 24, T1S, R98W, 6th P.M.**

**FINISHED ELEVATION: 6543.7'**

**DRAWN: 9/30/08 - ADB**

**SCALE: 1" = 100'**

**REVISED: 8/24/10 - DEH**

**DRG JOB No. 17084**

**ADDED LIVING QTRS DIMS**

**EXHIBIT 2 - SHEET 1 OF 2**

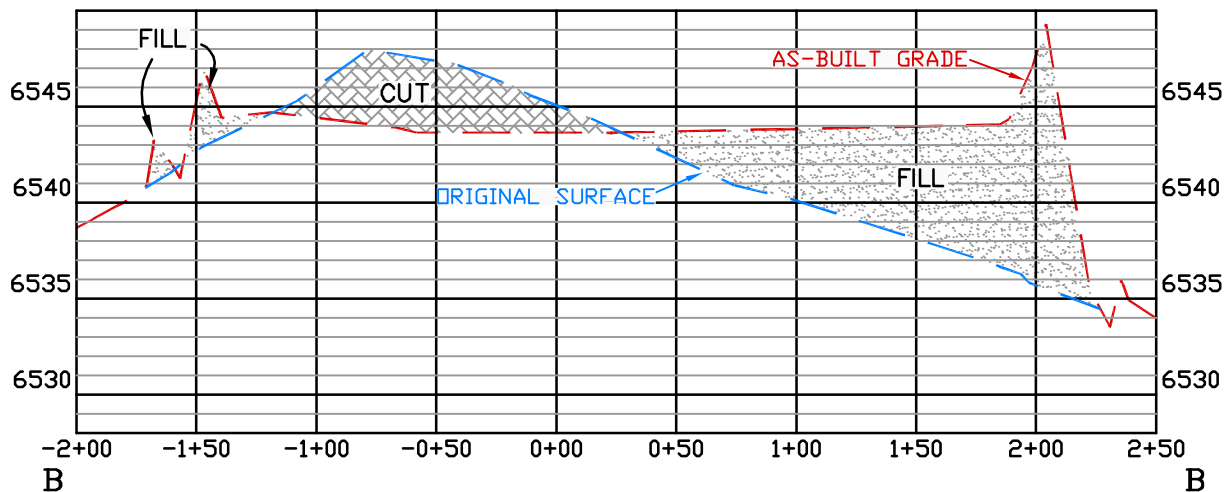
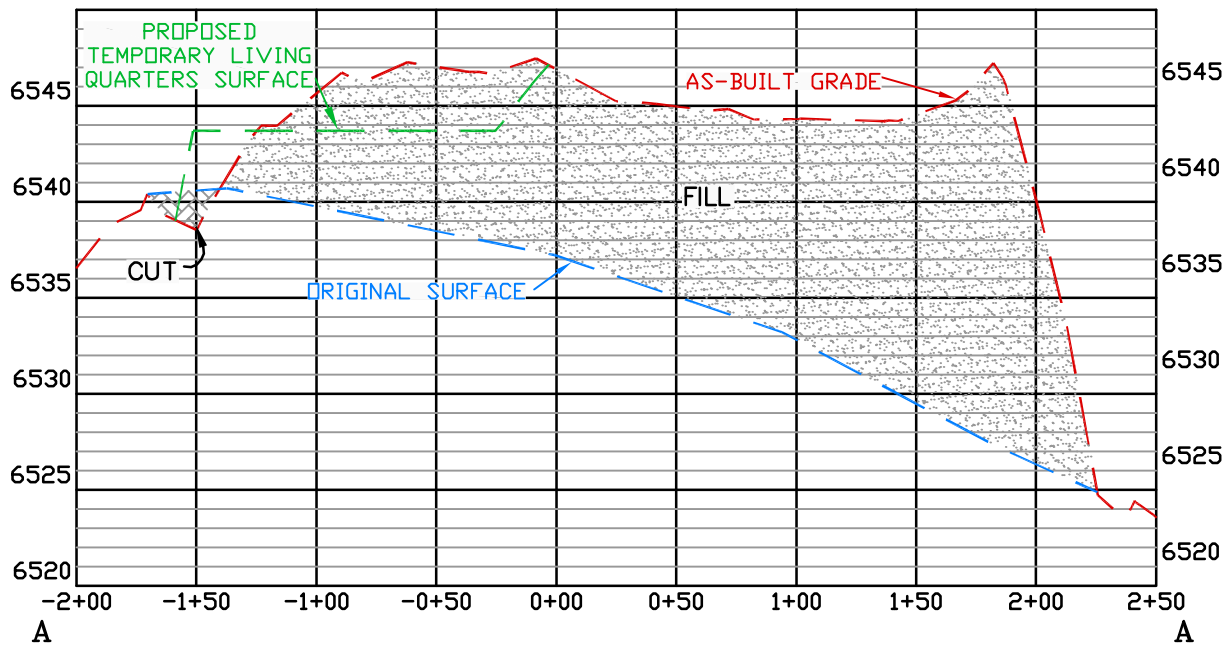

FEDERAL RGU 31-24-198 PAD



**CONSTRUCTION LAYOUT DRAWING 3 OF 4**

**WILLIAMS PRODUCTION RMT COMPANY  
FEDERAL RGU 21, 22, 33, 32, 41, 42, 321, 322, 331,  
332, 341, 421, 431, 432, 441, 521, 531, 541-24-198 &  
NRG 434-13-198**

**NWNE, SECTION 24, T1S, R98W, 6th P.M.**

DRAWN: 10/1/08 - ADB

HORZ. 1" = 80' VERT. 1" = 10'

REVISED: 8/19/10 - DEH

DRG JOB No. 17084

ADDED TEMP LVNG. QTRS.

EXHIBIT 3 - SHEET 1 OF 2

FINISHED ELEVATION: 6543.7'

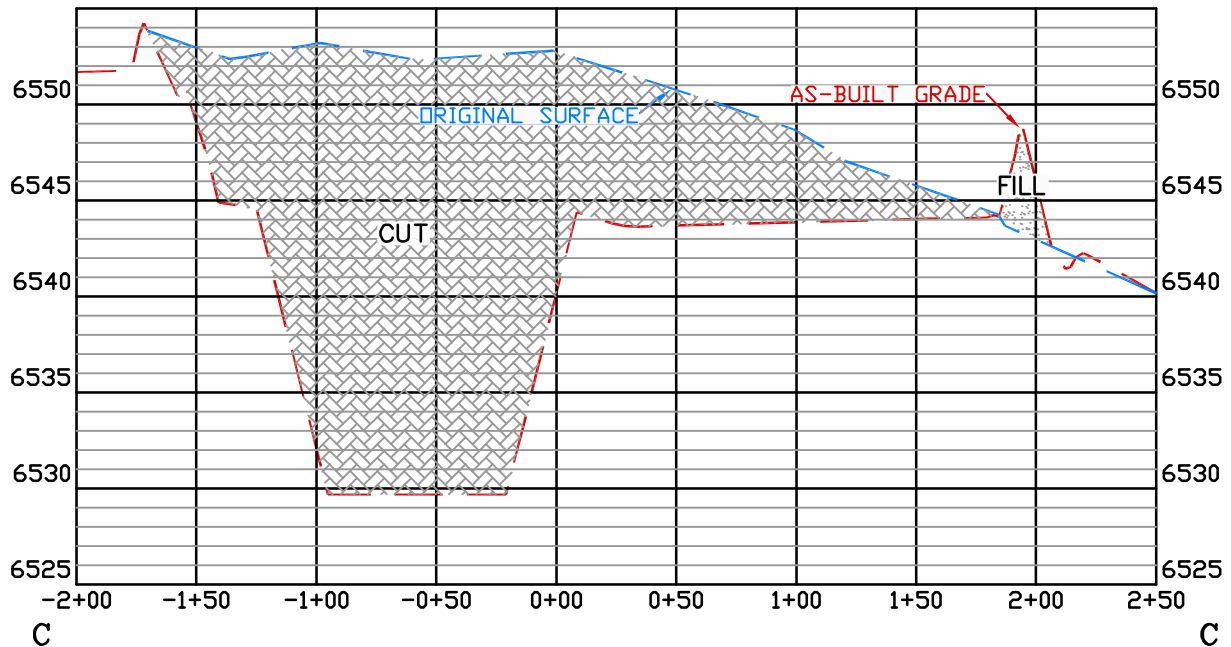

**FEDERAL RGU 31-24-198 PAD**



DRAWN: 10/1/08 - ADB	HORZ. 1" = 80' VERT. 1" = 10'
REVISED: 3/9/10 - MMM	DRG JOB No. 17084
MISC. REVISIONS	EXHIBIT 3 - SHEET 2 OF 2

**CONSTRUCTION LAYOUT DRAWING 4 OF 4**

**WILLIAMS PRODUCTION RMT COMPANY  
FEDERAL RGU 21, 22, 33, 32, 41, 42, 321, 322, 331,  
332, 341, 421, 431, 432, 441, 521, 531, 541-24-198 &  
NRG 434-13-198  
NWNE, SECTION 24, T1S, R98W, 6th P.M.**

**FINISHED ELEVATION: 6543.7'**

APPROX. EXISTING DISTURBANCE: 5.8± ACRES  
FINISHED ELEVATION: 6543.7'

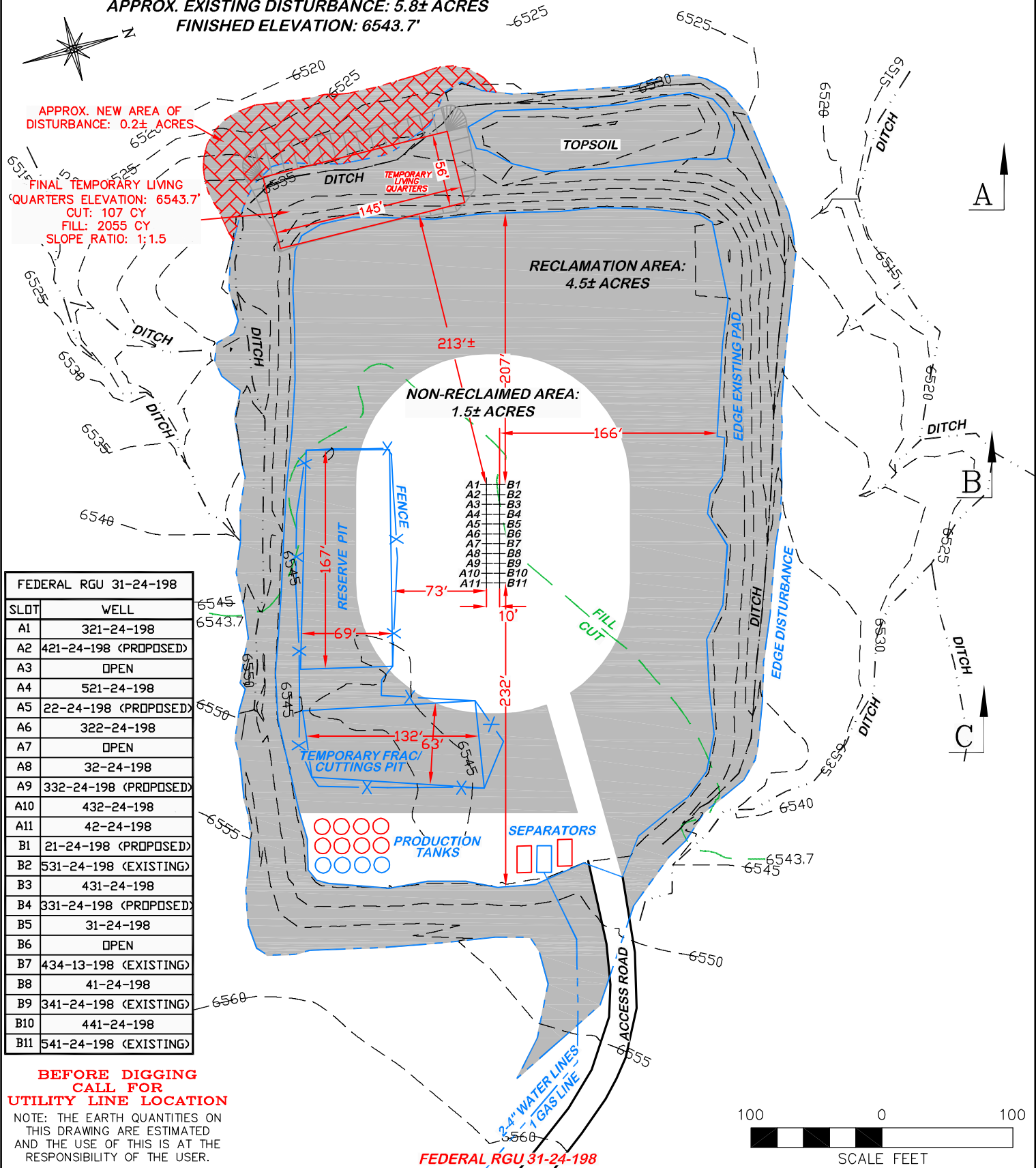

FEDERAL RGU 31-24-198	
SLOT	WELL
A1	321-24-198
A2	421-24-198 (PROPOSED)
A3	OPEN
A4	521-24-198
A5	22-24-198 (PROPOSED)
A6	322-24-198
A7	OPEN
A8	32-24-198
A9	332-24-198 (PROPOSED)
A10	432-24-198
A11	42-24-198
B1	21-24-198 (PROPOSED)
B2	531-24-198 (EXISTING)
B3	431-24-198
B4	331-24-198 (PROPOSED)
B5	31-24-198
B6	OPEN
B7	434-13-198 (EXISTING)
B8	41-24-198
B9	341-24-198 (EXISTING)
B10	441-24-198
B11	541-24-198 (EXISTING)

**BEFORE DIGGING  
CALL FOR  
UTILITY LINE LOCATION**

NOTE: THE EARTH QUANTITIES ON  
THIS DRAWING ARE ESTIMATED  
AND THE USE OF THIS IS AT THE  
RESPONSIBILITY OF THE USER.

FEDERAL RGU 31-24-198

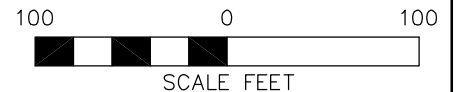

**DRG** RIFFIN & ASSOCIATES, INC.  
1414 ELK ST., ROCK SPRINGS, WY 82901  
(307) 362-5028

### INTERIM RECLAMATION DRAWING

**WILLIAMS PRODUCTION RMT COMPANY**  
**FEDERAL RGU 21, 22, 33, 32, 41, 42, 321, 322, 331, 332,**  
**341, 421, 431, 432, 441, 521, 531, 541-24-198 & NRG**  
**434-13-198**  
**NWNE, SECTION 24, T1S, R98W, 6th P.M.**

FINISHED ELEVATION: 6543.7'

DRAWN: 3/9/10 - MMM

SCALE: 1" = 100'

REVISED: 8/24/10 - DEH

DRG JOB No. 17084

ADDED LIVING QTRS DIMS

EXHIBIT 2C