

EXISTING DISTURBANCE AREA: 7.0 ACRES±
 PROPOSED NEW DISTURBANCE: 0.7 ACRES±
 EXISTING ELEVATION: 6778.4'

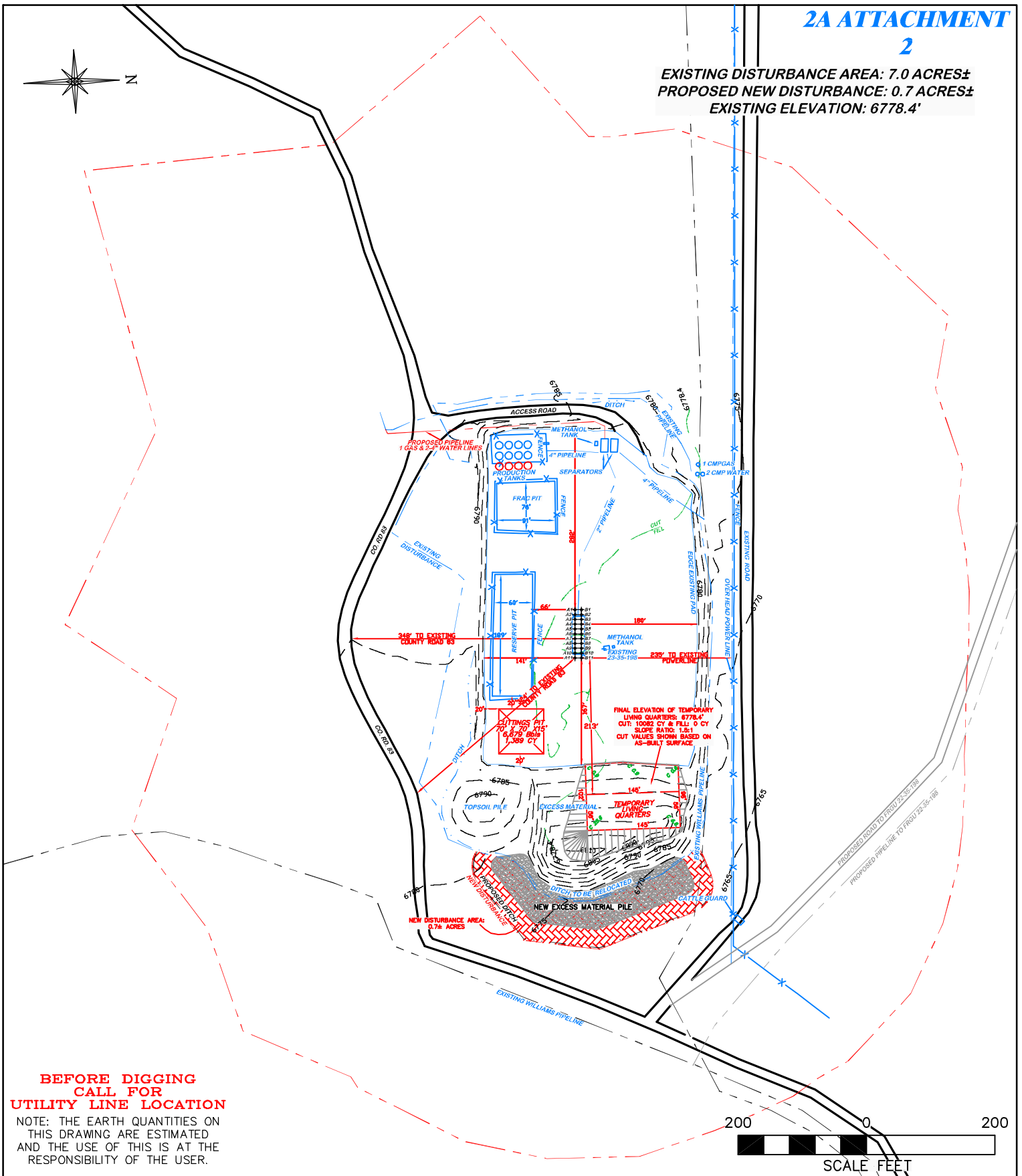

RIFFIN & ASSOCIATES, INC.

(307) 362-5028

1414 ELK ST., ROCK SPRINGS, WY 82901

DRAWN: 2/5/10 - MMM

SCALE: 1" = 200'

REVISED: 8/23/10 - DEH

DRG JOB No. 14054

REVISED NEW EXCESS PILE

EXHIBIT 2D

LOCATION DRAWING

**WILLIAMS RMT PRODUCTION COMPANY
 FEDERAL RGU 13, 33, 313, 322, 323, 333, 412, 413,
 422, 423, 433, 512, 522, 523, 532-35-198 NESW,
 SECTION 35, T1S, R98W, 6th, P.M.**

EXISTING ELEVATION: 6778.4'