

# KERR MCGEE OIL & GAS ONSHORE LP

Location: COLORADO Slot: SLOT#04 NRC 37-8 (1043'FSL & 1365'FEL)  
 Field: WELD COUNTY (KERR MCGEE) Well: NRC 37-8  
 Facility: SEC.08-T1N-R67W Wellbore: NRC 37-8 PWB

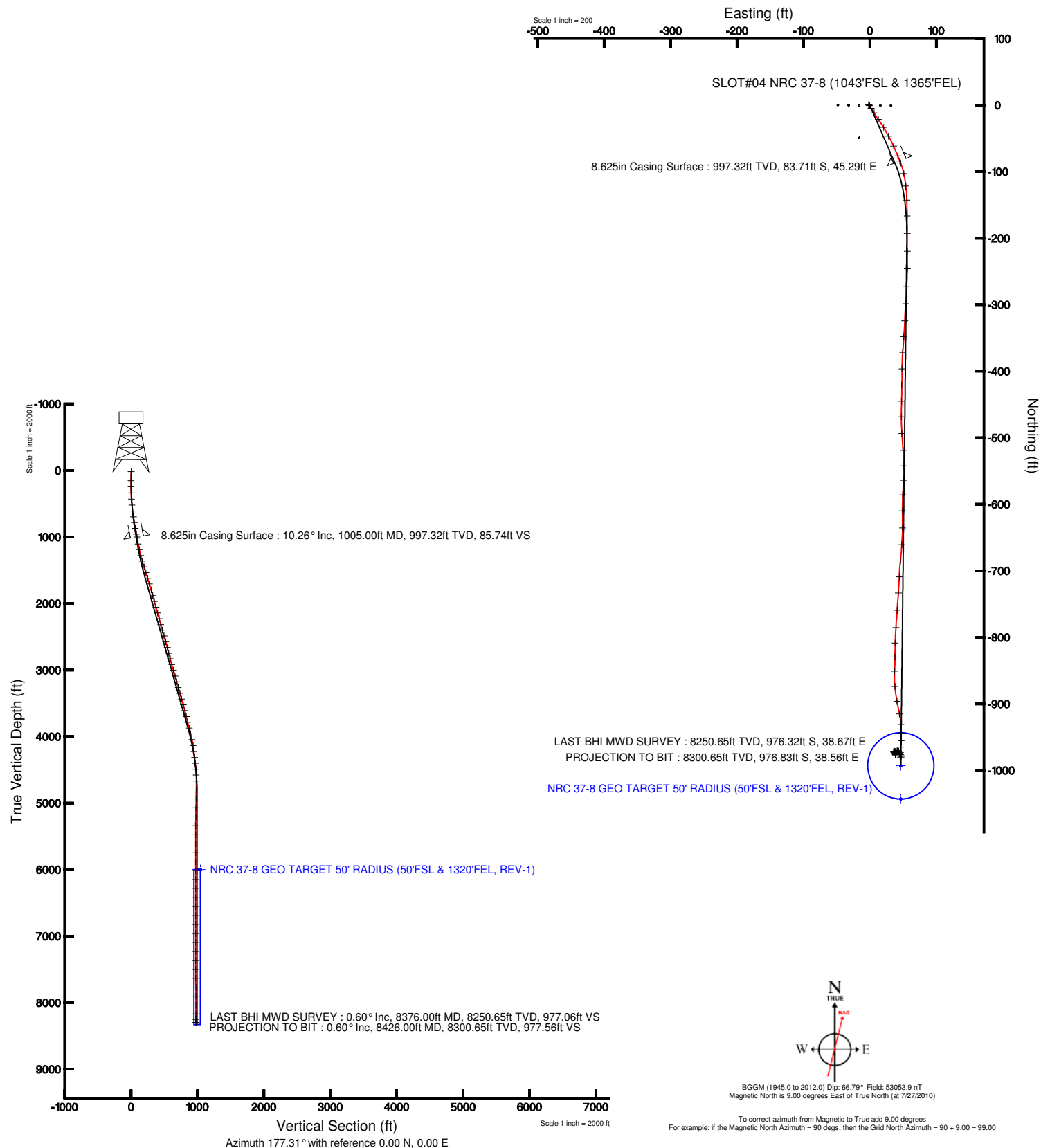

Plot reference wellpath is NRC 37-8 (REV-B.0) PWP	
True vertical depths are referenced to XTREME 12 (RT)	Grid System: NAD83 / Lambert Colorado State Planes, Northern Zone (501), US feet
Measured depths are referenced to XTREME 12 (RT)	North Reference: True north
XTREME 12 (RT) to Mean Sea Level: 5071 feet	Scale: True distance
Mean Sea Level to Mud line (Facility: SEC.08-T1N-R67W): 0 feet	Depths are in feet
Coordinates are in feet referenced to Slot	Created by: bensjacj on 7/28/2010





# Actual Wellpath Report

NRC 37-8 AWP

Page 1 of 5



INTEQ

## REFERENCE WELLPATH IDENTIFICATION

Operator	KERR MCGEE OIL & GAS ONSHORE LP	Slot	SLOT#04 NRC 37-8 (1043'FSL & 1365'FEL)
Area	COLORADO	Well	NRC 37-8
Field	WELD COUNTY (KERR MCGEE)	Wellbore	NRC 37-8 AWB
Facility	SEC.08-T1N-R67W		

## REPORT SETUP INFORMATION

Projection System	NAD83 / Lambert Colorado State Planes, Northern Zone (501), US feet	Software System	WellArchitect® 2.0
North Reference	True	User	Bensjacj
Scale	0.999962	Report Generated	7/28/2010 at 10:23:59 AM
Convergence at slot	0.38° East	Database/Source file	WA_Denver/NRC_37-8_AWB.xml

## WELLPATH LOCATION

	Local coordinates		Grid coordinates		Geographic coordinates	
	North[ft]	East[ft]	Easting[USft]	Northing[USft]	Latitude	Longitude
Slot Location	-0.36	48.15	3165148.16	1265676.42	40°03'40.187"N	104°54'35.910"W
Facility Reference Pt			3165100.01	1265676.46	40°03'40.190"N	104°54'36.529"W
Field Reference Pt			3197771.84	1268891.29	40°04'09.600"N	104°47'36.000"W

## WELLPATH DATUM

Calculation method	Minimum curvature	XTREME 12 (RT) to Facility Vertical Datum	5071.00ft
Horizontal Reference Pt	Slot	XTREME 12 (RT) to Mean Sea Level	5071.00ft
Vertical Reference Pt	XTREME 12 (RT)	Facility Vertical Datum to Mud Line (Facility)	0.00ft
MD Reference Pt	XTREME 12 (RT)	Section Origin	N 0.00, E 0.00 ft
Field Vertical Reference	Mean Sea Level	Section Azimuth	177.31°



# Actual Wellpath Report

NRC 37-8 AWP

Page 2 of 5



INTEQ

## REFERENCE WELLPATH IDENTIFICATION

Operator	KERR MCGEE OIL & GAS ONSHORE LP	Slot	SLOT#04 NRC 37-8 (1043'FSL & 1365'FEL)
Area	COLORADO	Well	NRC 37-8
Field	WELD COUNTY (KERR MCGEE)	Wellbore	NRC 37-8 AWB
Facility	SEC.08-T1N-R67W		

## WELLPATH DATA (83 stations) † = interpolated/extrapolated station

MD [ft]	Inclination [°]	Azimuth [°]	TVD [ft]	Vert Sect [ft]	North [ft]	East [ft]	DLS [°/100ft]	Comments
0.00†	0.000	294.100	0.00	0.00	0.00	0.00	0.00	
15.00	0.000	294.100	15.00	0.00	0.00	0.00	0.00	
151.00	1.100	294.100	150.99	-0.59	0.53	-1.19	0.81	
243.00	0.100	138.000	242.99	-0.92	0.83	-1.94	1.30	
335.00	2.100	138.000	334.96	0.44	-0.48	-0.76	2.17	
427.00	3.900	148.200	426.84	4.48	-4.39	2.01	2.03	
519.00	6.600	148.600	518.44	11.85	-11.56	6.42	2.94	
608.00	8.500	144.000	606.67	21.84	-21.25	12.95	2.24	
698.00	9.700	148.900	695.53	34.07	-33.13	20.78	1.59	
786.00	10.500	151.800	782.17	47.82	-46.54	28.40	1.08	
875.00	10.900	154.900	869.62	62.92	-61.31	35.80	0.79	
960.00	10.900	158.100	953.09	77.94	-76.04	42.20	0.71	
1023.00	10.000	158.100	1015.04	88.73	-86.64	46.47	1.43	
1113.00	11.700	167.900	1103.44	105.12	-102.82	51.29	2.78	
1201.00	13.200	173.200	1189.37	123.94	-121.52	54.35	2.14	
1291.00	14.200	178.800	1276.81	145.23	-142.76	55.80	1.84	
1380.00	16.600	178.800	1362.61	168.85	-166.39	56.30	2.70	
1470.00	17.300	180.600	1448.70	195.07	-192.63	56.43	0.97	
1560.00	17.500	178.800	1534.58	221.95	-219.54	56.57	0.64	
1649.00	17.200	181.300	1619.54	248.46	-246.07	56.55	0.90	
1739.00	16.700	182.300	1705.63	274.61	-272.30	55.73	0.64	
1830.00	17.100	184.100	1792.70	300.92	-298.70	54.25	0.72	
1920.00	15.900	182.300	1878.99	326.35	-324.22	52.81	1.45	
2010.00	14.800	184.500	1965.78	350.03	-348.00	51.41	1.38	
2100.00	15.600	184.100	2052.63	373.45	-371.53	49.64	0.90	
2192.00	15.800	180.600	2141.20	398.24	-396.39	48.63	1.05	
2282.00	15.500	180.600	2227.86	422.48	-420.67	48.37	0.33	
2373.00	15.500	181.300	2315.55	446.75	-444.99	47.97	0.21	
2461.00	15.300	180.200	2400.39	470.08	-468.35	47.66	0.40	
2551.00	17.300	176.700	2486.77	495.32	-493.59	48.39	2.47	
2641.00	15.700	175.000	2573.06	520.87	-519.08	50.22	1.86	
2731.00	14.400	180.200	2659.98	544.21	-542.41	51.25	2.08	
2819.00	14.100	182.300	2745.27	565.82	-564.06	50.78	0.68	
2907.00	14.700	183.000	2830.51	587.61	-585.92	49.76	0.71	
2997.00	16.400	179.900	2917.21	611.67	-610.03	49.19	2.10	
3087.00	16.500	179.900	3003.53	637.13	-635.52	49.23	0.11	
3177.00	16.200	184.100	3089.89	662.36	-660.82	48.36	1.36	
3266.00	15.600	186.200	3175.49	686.51	-685.10	46.18	0.93	
3356.00	15.500	182.000	3262.19	710.46	-709.15	44.45	1.26	
3446.00	16.100	184.400	3348.79	734.83	-733.61	43.07	0.99	
3536.00	17.400	183.800	3434.97	760.58	-759.48	41.22	1.46	
3627.00	15.700	184.100	3522.20	786.33	-785.34	39.44	1.87	
3718.00	14.200	181.300	3610.12	809.69	-808.78	38.31	1.83	
3808.00	12.900	180.200	3697.61	830.74	-829.87	38.02	1.47	
3897.00	14.500	183.000	3784.08	851.75	-850.93	37.41	1.95	



# Actual Wellpath Report

NRC 37-8 AWP

Page 3 of 5



INTEQ

## REFERENCE WELLPATH IDENTIFICATION

Operator	KERR MCGEE OIL & GAS ONSHORE LP	Slot	SLOT#04 NRC 37-8 (1043'FSL & 1365'FEL)
Area	COLORADO	Well	NRC 37-8
Field	WELD COUNTY (KERR MCGEE)	Wellbore	NRC 37-8 AWB
Facility	SEC.08-T1N-R67W		

## WELLPATH DATA (83 stations)

MD [ft]	Inclination [°]	Azimuth [°]	TVD [ft]	Vert Sect [ft]	North [ft]	East [ft]	DLS [°/100ft]	Comments
3987.00	15.500	174.600	3871.02	874.97	-874.16	37.95	2.66	
4077.00	13.600	169.300	3958.13	897.47	-896.53	41.04	2.58	
4168.00	10.800	167.900	4047.07	916.48	-915.38	44.82	3.09	
4258.00	9.800	178.100	4135.63	932.46	-931.28	46.84	2.31	
4349.00	7.300	178.500	4225.61	945.98	-944.81	47.25	2.75	
4438.00	6.600	182.700	4313.95	956.73	-955.57	47.16	0.97	
4526.00	6.100	182.300	4401.41	966.42	-965.29	46.73	0.57	
4616.00	4.400	185.800	4491.03	974.60	-973.50	46.19	1.92	
4704.00	2.800	186.200	4578.86	980.06	-979.00	45.62	1.82	
4794.00	0.800	90.200	4668.82	982.27	-981.19	46.01	3.32	
4928.00	0.800	27.300	4802.81	981.50	-980.36	47.37	0.62	
5062.00	1.000	345.800	4936.79	979.55	-978.40	47.51	0.50	
5198.00	1.000	295.500	5072.78	977.82	-976.73	46.15	0.62	
5334.00	1.400	345.500	5208.75	975.64	-974.61	44.66	0.79	
5468.00	1.200	330.000	5342.71	972.79	-971.81	43.55	0.30	
5604.00	0.700	191.000	5478.71	972.33	-971.40	42.68	1.31	
5739.00	0.400	92.000	5613.70	973.17	-972.22	43.00	0.64	
5874.00	0.300	321.100	5748.70	972.92	-971.96	43.24	0.47	
6009.00	0.100	327.200	5883.70	972.54	-971.59	42.96	0.15	
6142.00	0.200	268.500	6016.70	972.43	-971.50	42.66	0.13	
6277.00	0.200	307.900	6151.70	972.27	-971.36	42.24	0.10	
6413.00	0.300	313.500	6287.70	971.86	-970.97	41.80	0.08	
6548.00	0.400	247.000	6422.69	971.77	-970.91	41.11	0.29	
6682.00	0.600	260.000	6556.69	972.02	-971.21	39.98	0.17	
6817.00	0.400	243.900	6691.68	972.30	-971.54	38.87	0.18	
6952.00	0.400	240.400	6826.68	972.70	-971.98	38.03	0.02	
7087.00	0.300	334.200	6961.68	972.59	-971.90	37.47	0.38	
7223.00	0.300	292.000	7097.68	972.11	-971.45	36.98	0.16	
7358.00	0.400	218.900	7232.68	972.31	-971.68	36.36	0.31	
7494.00	0.300	191.100	7368.67	973.02	-972.40	35.99	0.14	
7627.00	0.200	132.800	7501.67	973.52	-972.90	36.10	0.19	
7761.00	0.600	117.600	7635.67	974.04	-973.38	36.89	0.31	
7896.00	0.300	117.300	7770.66	974.57	-973.87	37.83	0.22	
8031.00	0.300	116.600	7905.66	974.92	-974.19	38.46	0.00	
8166.00	0.300	165.100	8040.66	975.44	-974.69	38.87	0.18	
8298.00	0.500	192.500	8172.66	976.33	-975.59	38.83	0.21	
8376.00	0.600	192.500	8250.65	977.06	-976.32	38.67	0.13	LAST BHI MWD SURVEY
8426.00	0.600	192.500	8300.65	977.56	-976.83	38.56	0.00	PROJECTION TO BIT



# Actual Wellpath Report

NRC 37-8 AWP

Page 4 of 5



INTEQ

## REFERENCE WELLPATH IDENTIFICATION

Operator	KERR MCGEE OIL & GAS ONSHORE LP	Slot	SLOT#04 NRC 37-8 (1043'FSL & 1365'FEL)
Area	COLORADO	Well	NRC 37-8
Field	WELD COUNTY (KERR MCGEE)	Wellbore	NRC 37-8 AWB
Facility	SEC.08-T1N-R67W		

## HOLE & CASING SECTIONS Ref Wellbore: NRC 37-8 AWB Ref Wellpath: NRC 37-8 AWP

String/Diameter	Start MD [ft]	End MD [ft]	Interval [ft]	Start TVD [ft]	End TVD [ft]	Start N/S [ft]	Start E/W [ft]	End N/S [ft]	End E/W [ft]
12.25in Open Hole	15.00	1015.00	1000.00	15.00	1007.17	0.00	0.00	-85.35	45.94
8.625in Casing Surface	15.00	1005.00	990.00	15.00	997.32	0.00	0.00	-83.71	45.29
7.875in Open Hole	1005.00	8426.00	7421.00	997.32	8300.65	-83.71	45.29	-976.83	38.56

## TARGETS

Name	MD [ft]	TVD [ft]	North [ft]	East [ft]	Grid East [srv ft]	Grid North [srv ft]	Latitude	Longitude	Shape
NRC 37-8 GEO TARGET 50' RADIUS (50'FSL & 1320'FEL, REV-1)		6000.00	-993.42	46.75	3165201.51	1264683.37	40°03'30.370"N	104°54'35.309"W	circle
NRC 37-8 HARDLINE 50'S OF GEO TARGET		6000.00	-1043.42	46.75	3165201.85	1264633.37	40°03'29.875"N	104°54'35.309"W	point

## WELLPATH COMPOSITION Ref Wellbore: NRC 37-8 AWB Ref Wellpath: NRC 37-8 AWP

Start MD [ft]	End MD [ft]	Positional Uncertainty Model	Log Name/Comment	Wellbore
15.00	8376.00	NaviTrak (Standard)	BHI MWD SURVEYS <151-8376>	NRC 37-8 AWB
8376.00	8426.00	Blind Drilling (std)	Projection to bit	NRC 37-8 AWB



# Actual Wellpath Report

NRC 37-8 AWP

Page 5 of 5



**INTEQ**

## REFERENCE WELLPATH IDENTIFICATION

Operator	KERR MCGEE OIL & GAS ONSHORE LP	Slot	SLOT#04 NRC 37-8 (1043'FSL & 1365'FEL)
Area	COLORADO	Well	NRC 37-8
Field	WELD COUNTY (KERR MCGEE)	Wellbore	NRC 37-8 AWB
Facility	SEC.08-T1N-R67W		

## WELLPATH COMMENTS

MD [ft]	Inclination [°]	Azimuth [°]	TVD [ft]	Comment
8376.00	0.600	192.500	8250.65	LAST BHI MWD SURVEY
8426.00	0.600	192.500	8300.65	PROJECTION TO BIT