

**T 6 S**

**R 97 W**

**GARFIELD COUNTY, COLORADO**

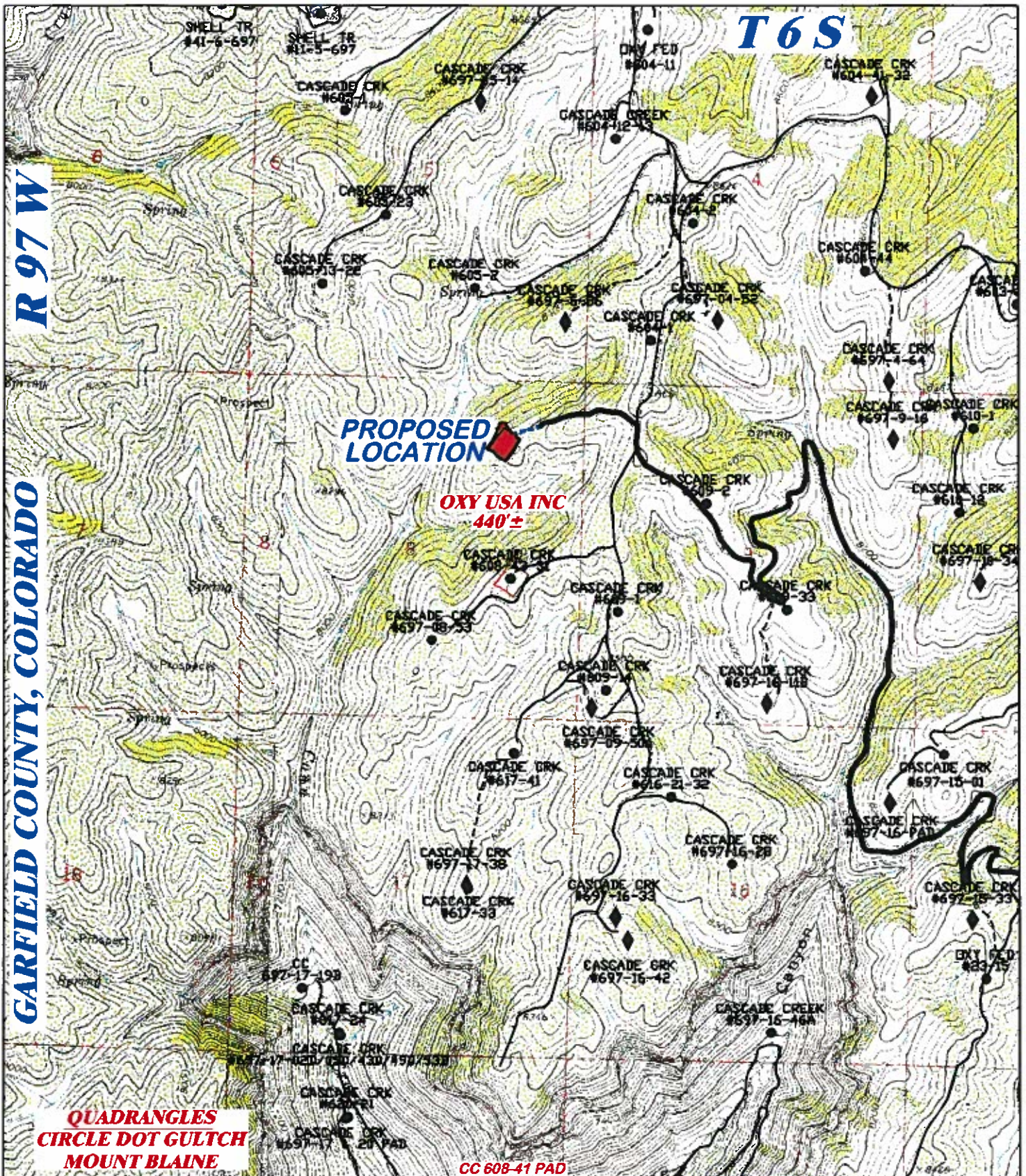

**QUADRANGLES  
CIRCLE DOT GULCH  
MOUNT BLAINE**

**CC 608-41 PAD**



**RIFFIN & ASSOCIATES, INC.**  
1414 ELK ST., ROCK SPRINGS, WY 82901

(307) 382-5028

**DRAWN: 10/31/08 - RCR**

**SCALE: 1" = 2000'**

**REVISED: 8/4/10 - DEH**

**DRG JOB No. 16569**

**UPDATED TITLE BLOCK**

**EXHIBIT/TOPO MAP 4**

**PROPOSED ACCESS MAP**

**OXY USA WTP LP**

**CASCADE CREEK 697-05-69, 70, 71, 72, 78A, 78B, 80A, 80B,  
697-08-06A, 06B, 08A, 08B, 14, 16, 23A, 697-09-02B, 09, 10A, 10B,  
17A, 17B, 19A, NENE, SECTION 8, T. 6 S., R. 97 W., 6th P.M.,  
GARFIELD COUNTY, COLORADO**

**PROPOSED ACCESS LENGTH: 440±**

**PROPOSED ACCESS** ■■■■■■■■■■

**EXISTING ROAD** —————