

# HYDROLOGY MAP

Western Land Surveying of Sheridan, Wyoming, in accordance with a request from Slawson Exploration Company, Inc., has determined the location of Corral 22-11-67 to be 605 feet FNL, and 605 feet FWL, (90° off Section Lines) of Section 22, Township 11 North, Range 67 West, of the 6th Principal Meridian, Weld County, Colorado.

Date: Staked on 5/27/2010, drawn on 7/27/2010

Staked by: Nick Roadifer

Drawn by: Heather Hairston

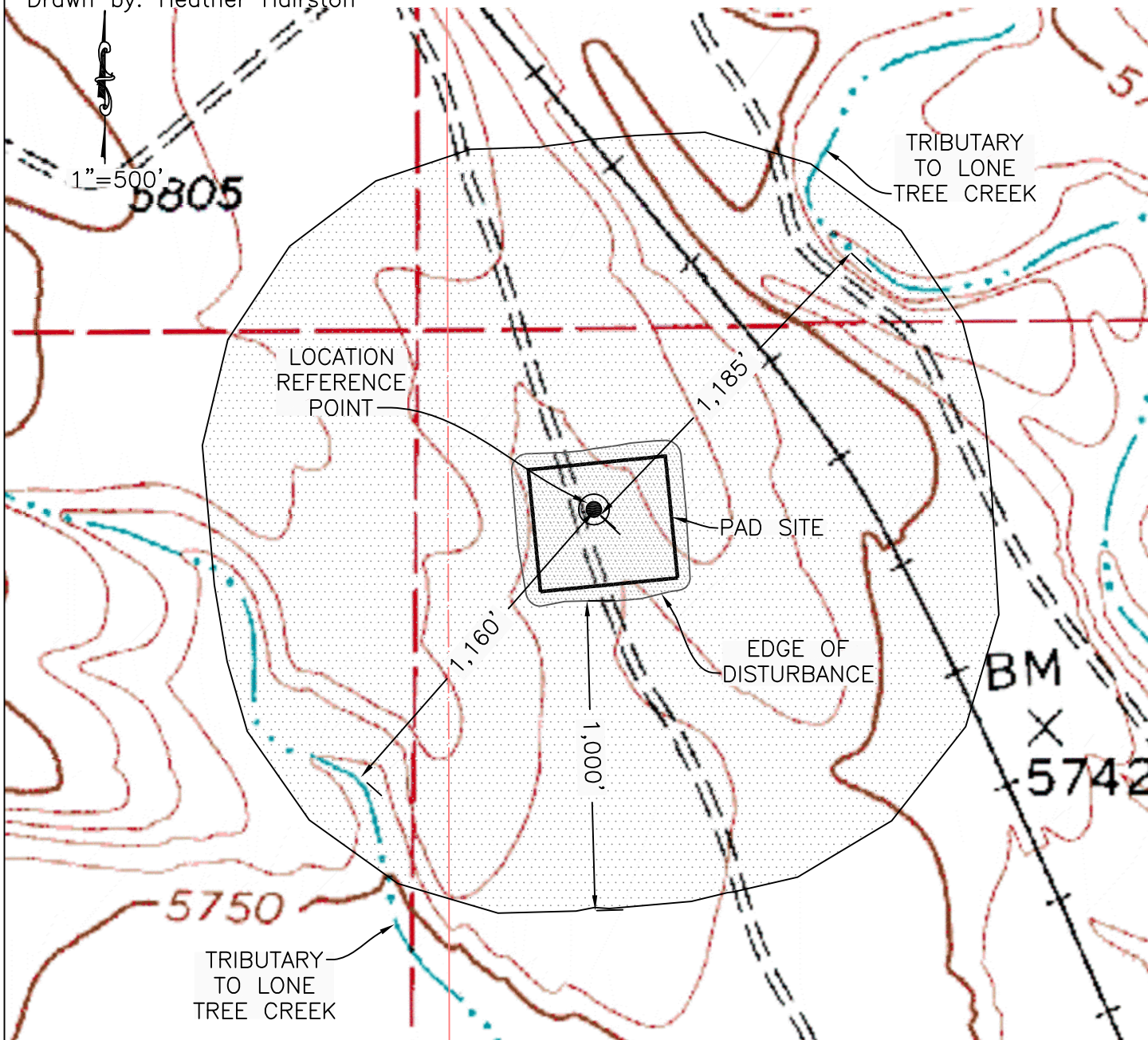

**WESTERN LAND SERVICES**

Sheridan, WY 82801 (307)673-1817

DP: L...\Slawson\Permitting\_Packets\Corral\_22 Date: 7/27/2010

Slawson Exploration Company, Inc.  
Corral 22-11-67

SL: NW 1/4 NW1/4 SECTION 22, T11N R67W  
BL: SE 1/4 NE1/4 SECTION 22, T11N R67W  
6TH PM, WELD COUNTY, COLORADO