

PERMANENT PAD AREA = 1.06 ACRES
APPROXIMATE EXISTING PAD = 0.62 ACRES
PAD EXPANSION = 0.44 ACRES

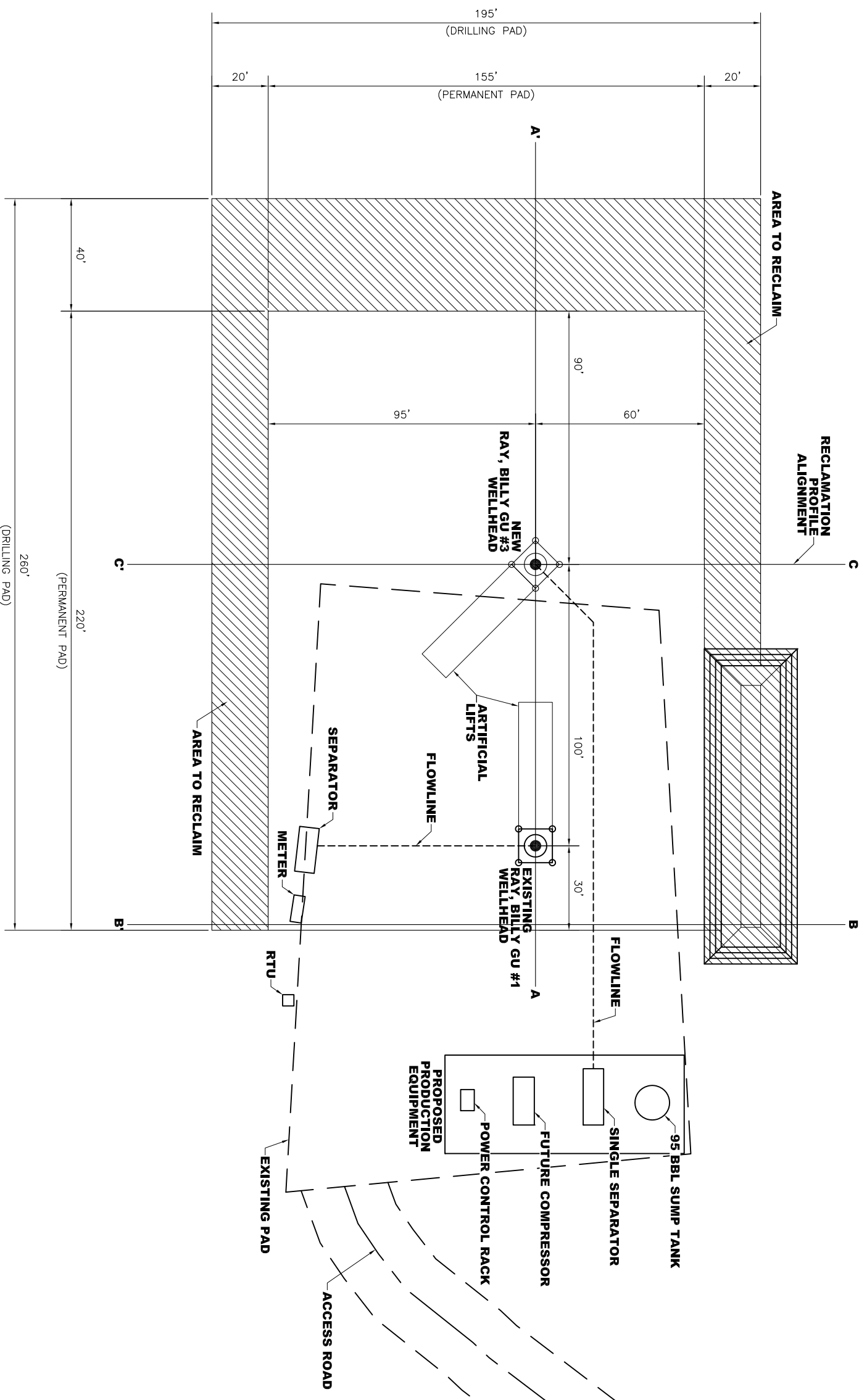

NOTES:

This document is the exclusive property of URS Corp. and/or client. It has not been prepared and is confidential. It is not to be copied, reproduced, exhibited, loaned or otherwise published for which it is specifically published without the written permission of URS Corp. and/or client, or to use the same in any advertisement or promotional copy, study or other.

REV	BY	DATE	REVISION	DATE	DESIGNED	CHECKED	DATE	DATE
0	LJB	6/16	ISSUED FOR CONSTRUCTION		SM	SM	6/16	

THIS DRAWING IS THE PROPERTY OF BP AND SHALL NOT BE REPRODUCED, DISTRIBUTED OR OTHERWISE MADE PUBLIC IN ANY MANNER WITHOUT THE WRITTEN PERMISSION OF BP. ANY REPRODUCTION OR DISTRIBUTION OF THIS DOCUMENT SHALL BE AT THE USER'S RISK AND WITHOUT LIABILITY TO BP.

BP America
 San Juan North
 Durango, Colorado

RAY, BILLY GU #3 RECLAMATION PAD PLAN

DATE DRAWN: 6/16/10
 DRAWN BY: KFEIR
 SCALE: 1" = 20'
 FILE: RAYBILLYGU#3-DRILLING PAD
 PROJ. NO.: 12059-A
 DWG. NO.: RAY, BILLY GU #3-0010
 REV: 0

URS
 211 Rock Point Dr. Suite # 101
 Durango, CO 81301 (970) 375-5767