

Map Unit Description

Weld County, Colorado, Southern Part

3 Aquolls and Aquents, gravelly substratum

Setting

Elevation: 4000 to 7200 feet
Mean annual precipitation: 12 to 18 inches
Mean annual air temperature: 45 to 55 degrees F
Frost-free period: 80 to 155 days

Composition

Aquolls and similar soils: 55 percent
Aquents, gravelly substratum, and similar soils: 30 percent

Description of Aquolls

Setting

Landform: Swales, streams, flood plains
Down-slope shape: Linear
Across-slope shape: Linear
Parent material: Recent alluvium

Properties and Qualities

Slope: 0 to 3 percent
Drainage class: Poorly drained
Capacity of the most limiting layer to transmit water (Ksat): Moderately high or high (0.20 to 2.00 in/hr)
Depth to water table: About 6 to 48 inches
Frequency of flooding: Frequent
Frequency of ponding: None
Calcium carbonate maximum: 0 percent
Gypsum maximum: 0 percent
Available water capacity: Moderate (about 8.0 inches)

Interpretive Groups

Land capability (non irrigated): 6w
Ecological site: Salt Meadow (R067BY035CO)

Typical Profile

0 to 48 inches: loam
48 to 60 inches: gravelly sand

Description of Aquents, gravelly substratum

Setting

Landform: Stream terraces
Down-slope shape: Linear
Across-slope shape: Linear
Parent material: Recent alluvium

Properties and Qualities

Slope: 0 to 3 percent
Drainage class: Poorly drained
Capacity of the most limiting layer to transmit water (Ksat): Moderately high or very high (0.57 to 19.98 in/hr)
Depth to water table: About 6 to 24 inches
Frequency of flooding: Frequent
Frequency of ponding: None
Calcium carbonate maximum: 10 percent
Gypsum maximum: 0 percent
Available water capacity: Moderate (about 6.6 inches)

Interpretive Groups

Land capability classification (irrigated): 6w
Land capability (non irrigated): 6w
Ecological site: Salt Meadow (R067BY035CO)

Typical Profile

0 to 48 inches: variable
48 to 60 inches: very gravelly sand

Map Unit Description

Weld County, Colorado, Southern Part

Map Unit Description

Weld County, Colorado, Southern Part

68 Ustic Torriorthents, moderately steep

Setting

Elevation: 4450 to 5100 feet
Mean annual precipitation: 10 to 16 inches
Mean annual air temperature: 46 to 54 degrees F
Frost-free period: 120 to 160 days

Composition

Ustic torriorthents and similar soils: 85 percent

Description of Ustic torriorthents

Setting

Landform: Escarpments, breaks
Down-slope shape: Linear
Across-slope shape: Linear
Parent material: Gravelly alluvium

Properties and Qualities

Slope: 9 to 15 percent
Drainage class: Excessively drained
Capacity of the most limiting layer to transmit water (Ksat): High or very high (5.95 to 19.98 in/hr)
Frequency of flooding: None
Frequency of ponding: None
Calcium carbonate maximum: 5 percent
Gypsum maximum: 0 percent
Available water capacity: Very low (about 1.8 inches)

Interpretive Groups

Land capability (non irrigated): 7s

Typical Profile

0 to 10 inches: gravelly sand
10 to 60 inches: gravelly sand

Map Unit Description

Weld County, Colorado, Southern Part

76 Vona sandy loam, 1 to 3 percent slopes

Setting

Elevation: 4600 to 5200 feet
Mean annual precipitation: 13 to 15 inches
Mean annual air temperature: 48 to 55 degrees F
Frost-free period: 130 to 160 days

Composition

Vona and similar soils: 85 percent
Minor components: 1 percent

Description of Vona

Setting

Landform: Terraces, plains
Down-slope shape: Linear
Across-slope shape: Linear
Parent material: Alluvium and/or eolian deposits

Properties and Qualities

Slope: 1 to 3 percent
Drainage class: Well drained
Capacity of the most limiting layer to transmit water (Ksat): High (1.98 to 6.00 in/hr)
Frequency of flooding: None
Frequency of ponding: None
Calcium carbonate maximum: 15 percent
Gypsum maximum: 0 percent
Available water capacity: Moderate (about 6.8 inches)

Interpretive Groups

Land capability classification (irrigated): 3e
Land capability (non irrigated): 4e
Ecological site: Sandy Plains (R067BY024CO)

Typical Profile

0 to 6 inches: sandy loam
6 to 28 inches: fine sandy loam
28 to 60 inches: sandy loam

Minor Components

Aquic haplustolls
Percent of map unit: 1 percent
Landform: Swales

3, Aquolls and Aquents, gravelly substratum, 0 to 3% slopes; 68, Ustic Torriorthents, moderately steep, 9 to 15% slopes; 76, Vona sandy loam, 1 to 3 percent slopes

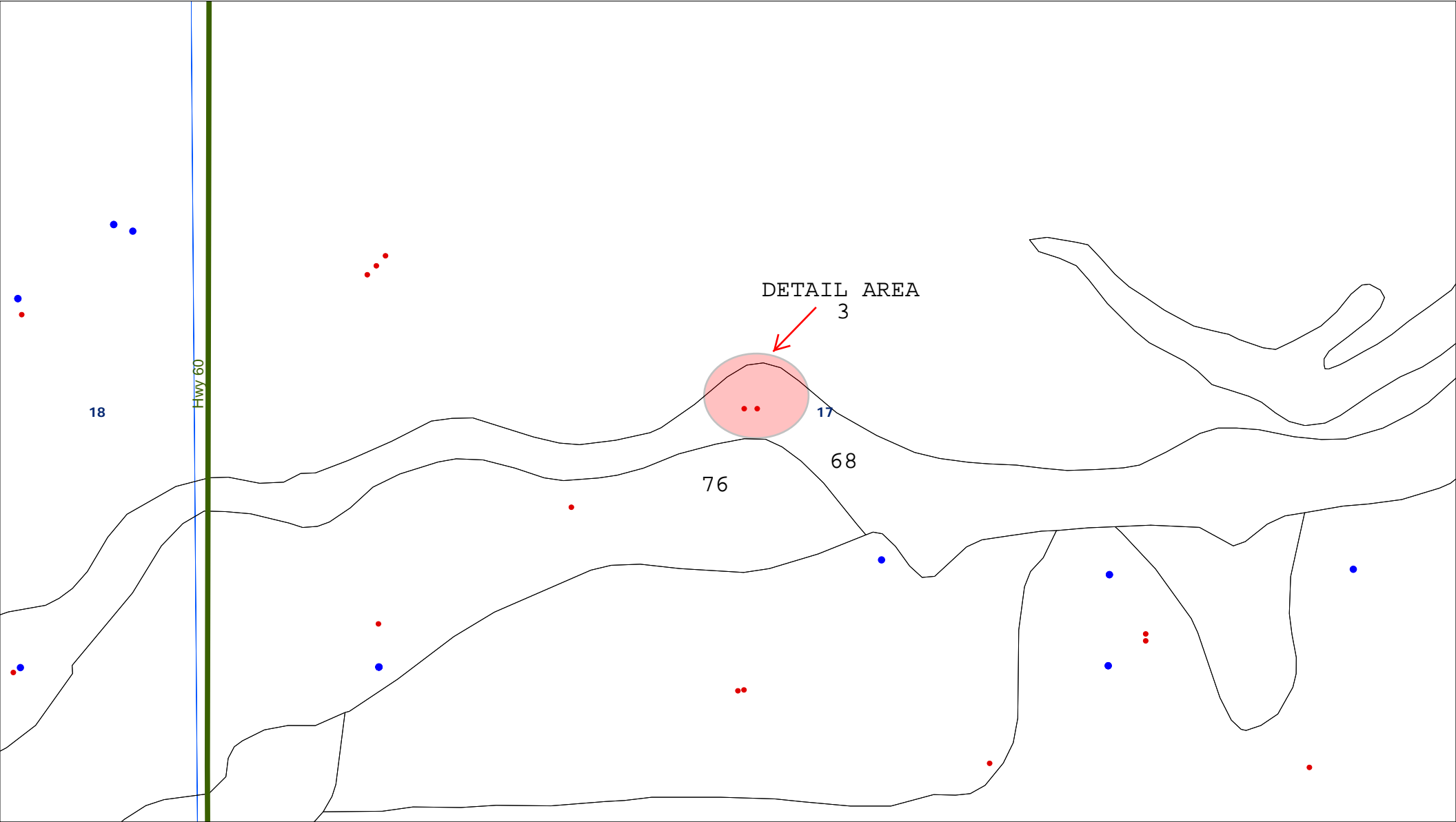

SCALE 1 : 5,831

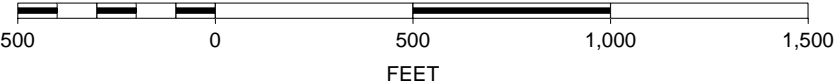

K. P. Kauffman Company, Inc.
Front Range #11-17 well pad soils map
NESW section 17-T4N-R66W
Weld Co., Colorado

