

July 23, 2010

Noble Energy Production, Inc.
1625 Broadway, Ste 2000
Denver, CO 80202

Re: Notice of Proposed Well (318A.e. FRONT RANGE #11-17-24)
Surface Location: 1505' FSL and 2084' FWL Sec. 17, T4N, R66W, 6th P.M.,
Weld County, Colorado.
Bottom Hole Location: 2506' FNL and 1349' FEL Sec. 17, T4N, R66W,
Weld County, Colorado.

To Whom It May Concern:

K.P. Kauffman Company, Inc. hereby gives twenty (20) day notice in accordance with Colorado Oil and Gas Conservation Commission rule 318A.e.(6) of a proposed BOUNDARY well or wellbore spacing unit to all owners in the proposed wellbore spacing unit. The Niobrara-Codell-J-sand completion and spacing unit will comprise 160 acres including the S/2NE/4 and N/2SE/4 Sec. 17, T4N, R66W, Weld County, Colorado. Our records indicate that Noble Energy Production, Inc. operates the RANGE K #17-9 located in the NE/4SE/4 Sec. 17, T4N, R66W, 6th P.M., Weld County, Colorado.

According to COGCC rules and policies, Noble Energy Production, Inc. shall have a twenty (20) day period after receipt of such notice to object in writing to the K.P. Kauffman Company, Inc. regarding the well location, proposed spacing unit, or any additional producing formation. If a timely objection is received, the matter shall be set on the docket at the next available Commission hearing. If you have any questions or comments please contact me either in writing or at the above phone listing.

Thank you,

Sherry Glass
Engineering Technician

THIS MAP IS A GIS EXHIBIT AND DOES NOT REPRESENT A BOUNDARY SURVEY.



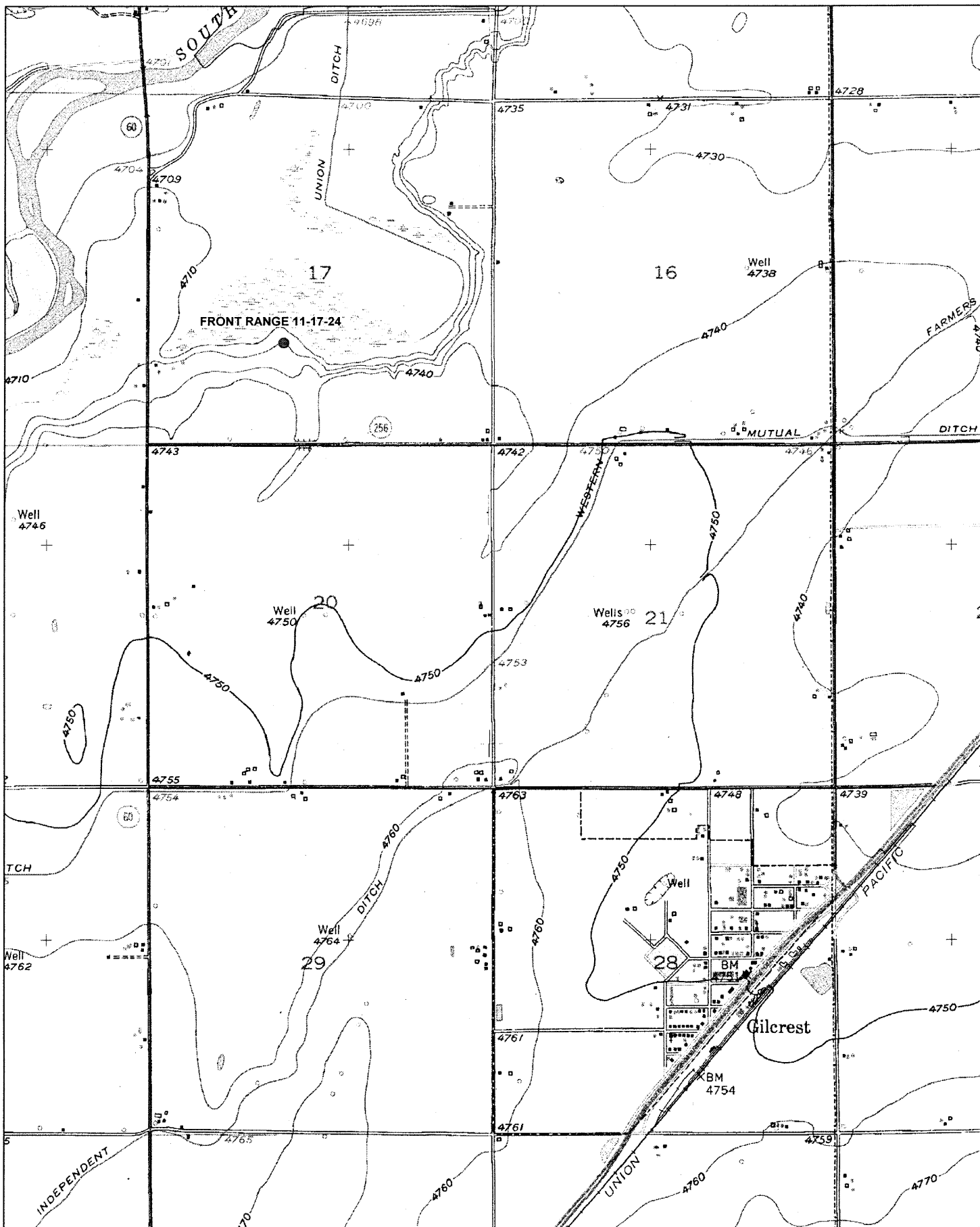

K. P. Kauffman Company, Inc.
1675 Broadway, Ste 2800
Denver, CO 80202
Undrilled acreage
SW/4NE/4, NW/4SE/4 , SE/4NE/4
section 17 4N 66W
NIOBRARA-CODELL-J SAND

FRONT RANGE
LAND &
LIVESTOCK LLC

FRONT RANGE
LAND &
LIVESTOCK LLC

KNUTSON
RANDALL C &

FIVE RIVERS
RANCH CATTLE
FEEDING LLC

FIVE RIVERS
RANCH CATTLE
FEEDING LLC

WESTERN
EQUIPMENT &
TRUCK INC

FRONT RANGE
LAND &
LIVESTOCK LLC

OWENS
TOMM S &

HAREN
THOMAS M

Noble Energy Production,
Inc.
1625 Broadway, Ste 2000
Denver, CO 80202
RANGE K #17-9
API #05-123-23406
NESE 17 4N 66W
CODELL

ZABKA
FARMS INC
1/2 INT &

RAYMOND
MARTIAL
TRUST 1/2

FRONT RANGE #11-17-24 UNIT CONFIGURATION
(Outlined by black dashed line)

NW/4SE/4, SE/4NE/4, SW/4NE/4 , NE/4SE/4, SEC. 17,
T4N, R66W, WELD COUNTY, CO.

Surface Location: 1505' FSL, 2084' FWL of the SW/4 sec
17, T4N, R66W

Bottomhole Location: 2506' FNL, 1349' FEL of the NE/4,
Sec. 17, T4N, R66W, Weld County, Colorado

U.S. Postal Service
CERTIFIED MAIL™ RECEIPT
 (Domestic Mail Only; No Insurance Coverage Provided)

For delivery information visit our website at www.usps.com

OFFICIAL USE

Postage	\$
Certified Fee	
Return Receipt Fee (Endorsement Required)	
Restricted Delivery Fee (Endorsement Required)	
Total Postage & Fees	\$

Postmark
Here

Sent To Noble
 Street, Apt. No., or PO Box No. 1625 Broadway, Ste 2000
 City, State, ZIP+4 Denver, CO 80202

PS Form 3800, August 2006

See Reverse for Instructions

Re:

SENDER: COMPLETE THIS SECTION

- Complete items 1, 2, and 3. Also complete item 4 if Restricted Delivery is desired.
- Print your name and address on the reverse so that we can return the card to you.
- Attach this card to the back of the mailpiece, or on the front if space permits.

1. Article Addressed to:

Noble Energy, Inc.
1625 Broadway, Ste 2000
Denver, CO 80202

2. Article Number
 (Transfer from service label)

7009 3410 0000 2503 3933

COMPLETE THIS SECTION ON DELIVERY

- A. Signature Kangel ☐ Agent ☐ Addressee
- B. Received by (Printed Name) KANGEL
- C. Date of Delivery 7/26/10
- D. Is delivery address different from item 1? ☐ Yes ☐ No
 If YES, enter delivery address below:

3. Service Type
- ☒ Certified Mail ☐ Express Mail
- ☐ Registered ☒ Return Receipt for Merchandise
- ☐ Insured Mail ☐ C.O.D.

4. Restricted Delivery? (Extra Fee) ☐ Yes

PS Form 3811, February 2004

Domestic Return Receipt

102595-02-M-1540

According to COGCC rules and policies, NOBLE Energy Production, Inc. shall have a twenty (20) day period after receipt of such notice to object in writing to the K.P. Kauffman Company, Inc. regarding the well location, proposed spacing unit, or any additional producing formation. If a timely objection is received, the matter shall be set on the docket at the next available Commission hearing. If you have any questions or comments please contact me either in writing or at the above phone listing.

Thank you,

Sherry Glass
 Engineering Technician