

Encana OIL & GAS (USA) INC.

ADDENDUM TO LEGAL PLAT FOR

KIMBALL MTN. B07 799

SECTION 7, T7S, R99W, 6th P.M.

NW 1/4 NE 1/4

SCALE: 1" = 60'

DATE: 03-11-10

DRAWN BY: D.R.B.

Revised: 05-14-10 D.R.B.

Revised: 07-08-10 D.R.B.

Revised: 07-15-10 D.R.B.

Revised: 07-21-10 D.R.B.

Revised: 08-03-10 D.R.B.

Existing Drainage

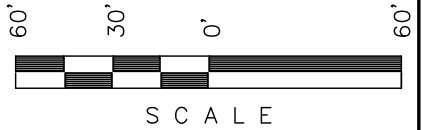

Sheet 1c of 11



Total Pit Capacity
W/2' of Freeboard
= 27,600 Bbls. ±
Total Pit Volume
= 6,770 Cu. Yds.

Existing Pad

Existing Fenceline

Section Line Sec. 6
Sec. 7

Gate

Access Road

SUMP LEGEND:

SCE - STABILIZED
CONSTRUCTION
ENTRANCE

UINTAH ENGINEERING & LAND SURVEYING

85 So. 200 East * Vernal, Utah 84078 * (435) 789-1017



SCALE: 1" = 60'

DATE: 03-11-10

DRAWN BY: D.R.B.

Revised: 03-19-10 D.R.B.

Revised: 05-14-10 D.R.B.

Revised: 07-08-10 D.R.B.

Revised: 07-15-10 D.R.B.

Revised: 07-21-10 D.R.B.

Encana OIL & GAS (USA) INC.

PRE-CONSTRUCTION LAYOUT FOR

KIMBALL MTN. B07 799

SECTION 7, T7S, R99W, 6th P.M.

NW 1/4 NE 1/4

60' 30' 0' 60'



SCALE

Sheet 3a of 11

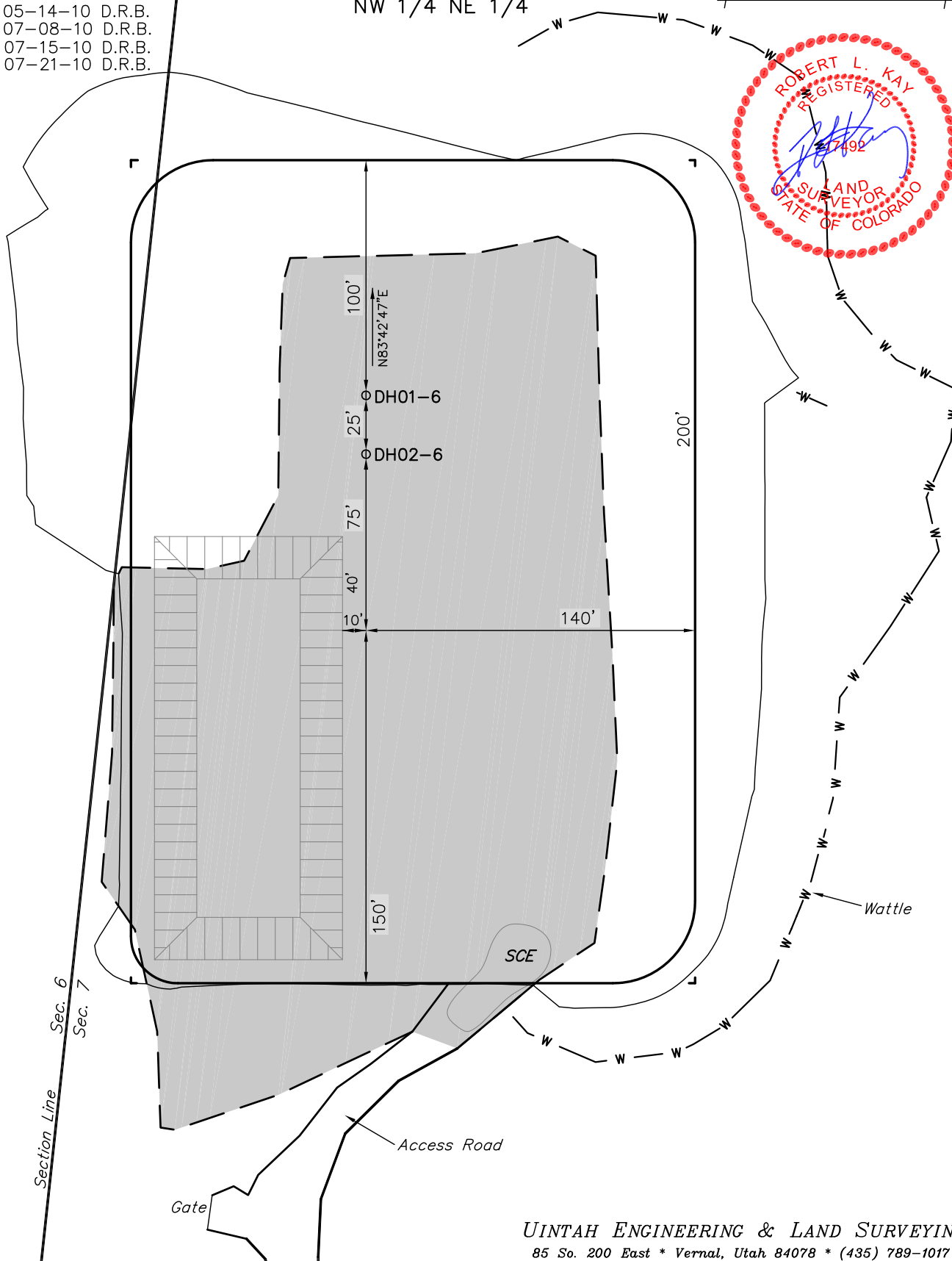

UINTAH ENGINEERING & LAND SURVEYING

85 So. 200 East * Vernal, Utah 84078 * (435) 789-1017

Encana OIL & GAS (USA) INC.

Sheet 4 of 11

CONSTRUCTION LAYOUT CROSS SECTION FOR

KIMBALL MTN. B07 799

SECTION 7, T7S, R99W, 6th P.M.

NW 1/4 NE 1/4

1" = 40'
X-Section
Scale
1" = 100'

DATE: 03-11-10

DRAWN BY: D.R.B.

Revised: 03-19-10 D.R.B.

Revised: 05-14-10 D.R.B.

Revised: 07-08-10 D.R.B.

Revised: 07-15-10 D.R.B.

Topsoil Berm
Erosion Control
Blanket infilled
w/Flexterra

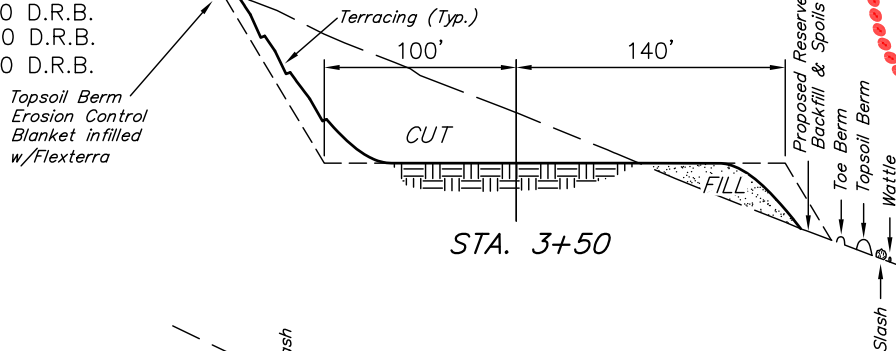

STA. 3+50

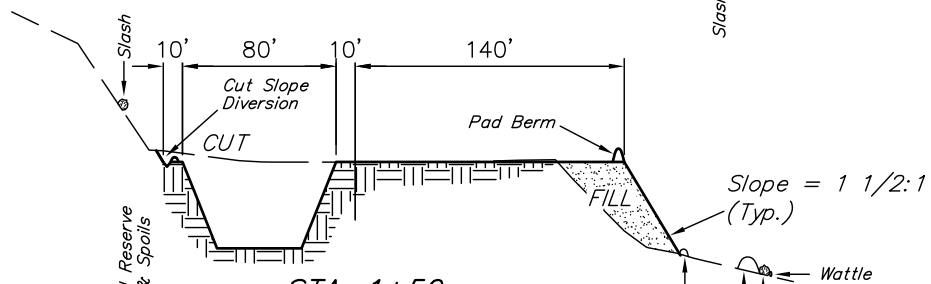

STA. 1+50

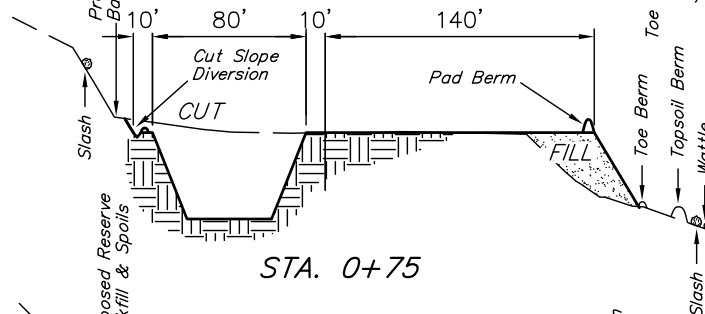

STA. 0+75

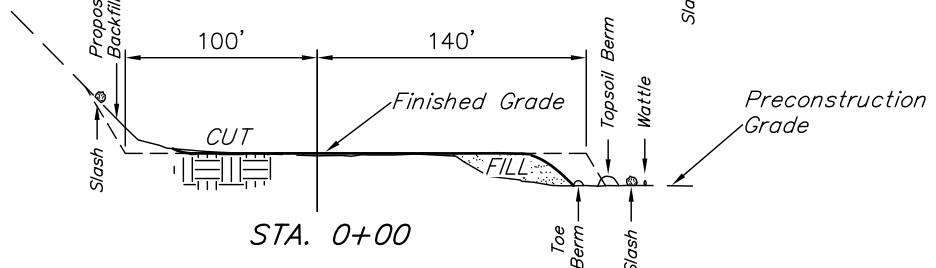

STA. 0+00

* NOTE:
FILL QUANTITY INCLUDES
5% FOR COMPACTION

* NOTE:
USE EXCESS MATERIAL
FOR BERM AROUND PAD.

APPROXIMATE YARDAGES

(6") Topsoil Stripping	= 1,000 Cu. Yds.
(New Construction Only)	
Remaining Location	= 18,340 Cu. Yds.
TOTAL CUT	= 19,340 CU.YDS.
FILL	= 6,960 CU.YDS.

EXCESS MATERIAL	= 12,380 Cu. Yds.
Topsoil & Pit Backfill (1/2 Pit Vol.)	= 4,380 Cu. Yds.
EXCESS UNBALANCE (After Interim Rehabilitation)	= 8,000 Cu. Yds.

UINTAH ENGINEERING & LAND SURVEYING
85 So. 200 East * Vernal, Utah 84078 * (435) 789-1017



SCALE: 1" = 60'
DATE: 03-11-10
DRAWN BY: D.R.B.

Revised: 03-19-10 D.R.B.
Revised: 05-14-10 D.R.B.
Revised: 07-08-10 D.R.B.
Revised: 07-15-10 D.R.B.
Revised: 07-21-10 D.R.B.
Revised: 08-03-10 D.R.B.

Encana OIL & GAS (USA) INC.

TYPICAL RIG LAYOUT FOR
KIMBALL MTN. B07 799
SECTION 7, T7S, R99W, 6th P.M.
NW 1/4 NE 1/4

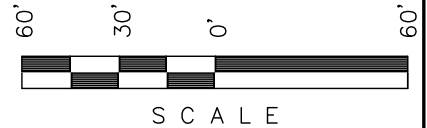

Sheet 5 of 11



NOTE:
Flare Pit is to
be located a min.
of 100' from the
Well Head.

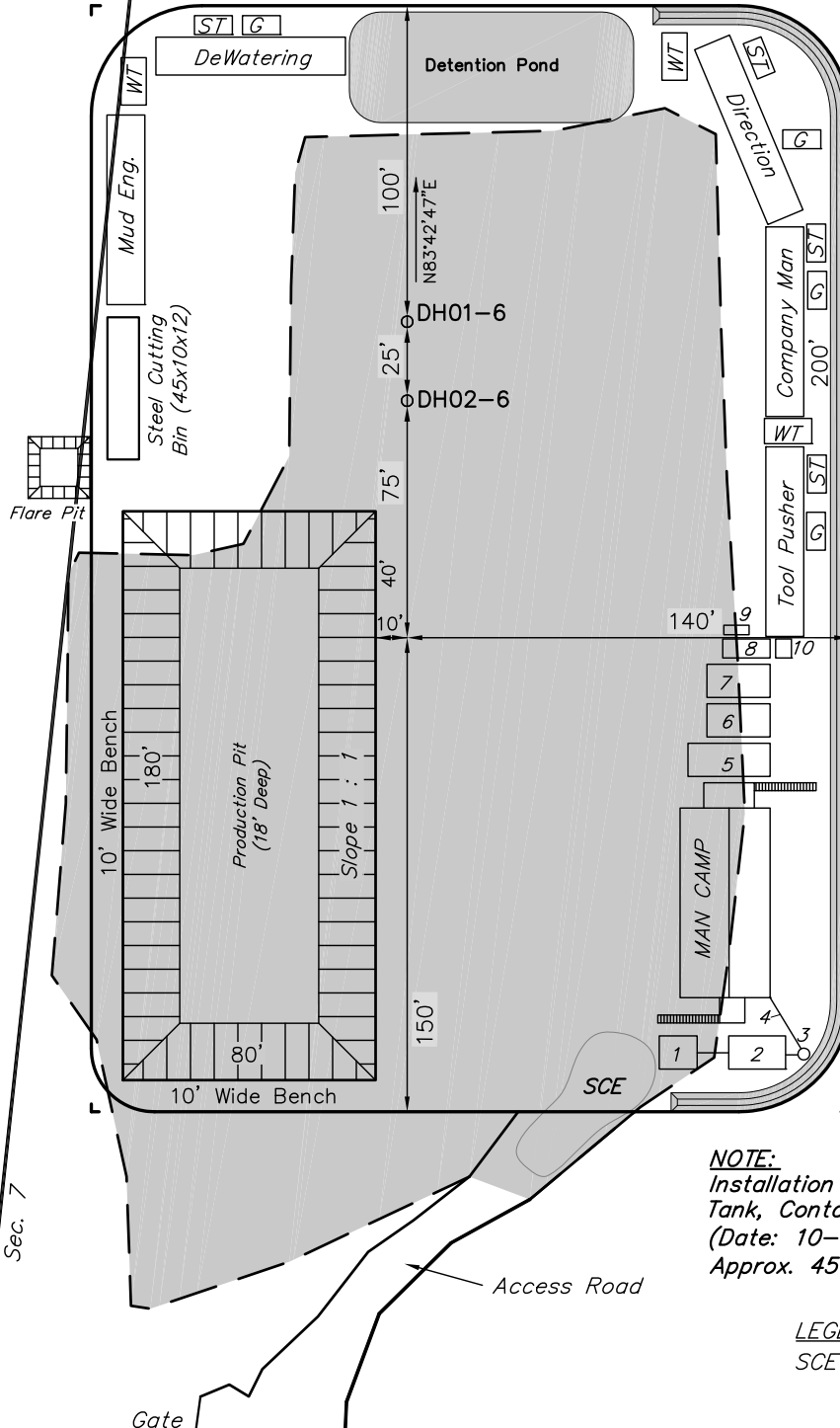

Total Pit Capacity
W/2' of Freeboard
= 27,600 Bbbls. ±
Total Pit Volume
= 6,770 Cu. Yds.

LEGEND:
ST - Septic Tank
G - Generator
WT - Water Tank

LEGEND:
1 - OVERFLOW
2 - SEWER TANK
3 - LIFT STATION
4 - SEWER LINE
5 - WATER TANK
6 - FREEZER
7 - STORAGE
8 - GENERATOR
9 - FUEL
10 - TRANSFORMER

NOTE:
Installation & Removal of Water
Tank, Containers, Sewage Storage
(Date: 10-01-10 thru 11-15-10
Approx. 45 days)

LEGEND:
SCE - STABILIZED
CONSTRUCTION
ENTRANCE



SCALE: 1" = 60'
DATE: 03-11-10
DRAWN BY: D.R.B.

Revised: 03-19-10 D.R.B.
Revised: 05-14-10 D.R.B.
Revised: 07-08-10 D.R.B.
Revised: 07-15-10 D.R.B.
Revised: 07-21-10 D.R.B.

Encana OIL & GAS (USA) INC.

PRODUCTION SCHEMATIC FOR
KIMBALL MTN. B07 799
SECTION 7, T7S, R99W, 6th P.M.
NW 1/4 NE 1/4

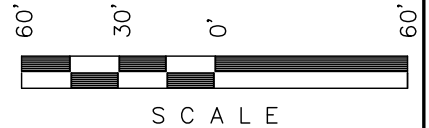

Sheet 6 of 11

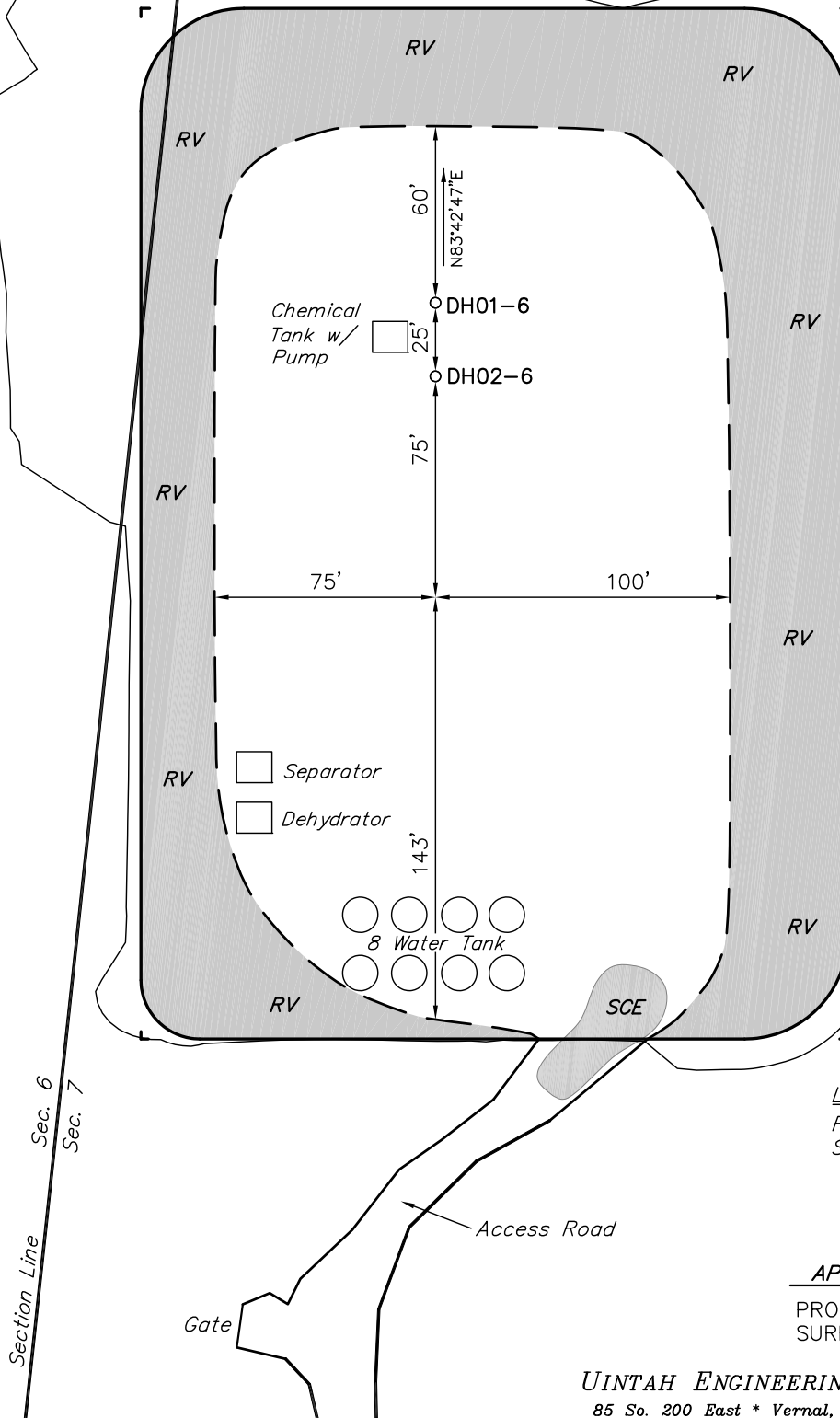

LEGEND:
RV - REVEGETATION
SCE - STABILIZED
CONSTRUCTION
ENTRANCE

APPROXIMATE ACREAGES
PROPOSED RECLAIMED PAD
SURFACE = ± 1.155 ACRES

Encana OIL & GAS (USA) INC.

SURFACE DISTURBANCE AREA FOR

KIMBALL MTN. B07 799

SECTION 7, T7S, R99W, 6th P.M.

NW 1/4 NE 1/4

SCALE: 1" = 80'

DATE: 03-11-10

DRAWN BY: D.R.B.

Revised: 05-14-10 D.R.B.

Revised: 07-08-10 D.R.B.

Revised: 07-15-10 D.R.B.

Revised: 07-21-10 D.R.B.

Revised: 08-03-10 D.R.B.

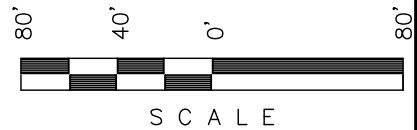

SCALE

Sheet 7 of 11

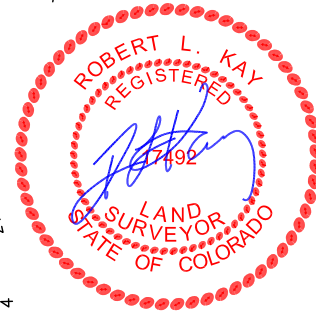

LEGEND:

ST - Septic Tank
G - Generator
WT - Water Tank

LEGEND:

- 1 - OVERFLOW
- 2 - SEWER TANK
- 3 - LIFT STATION
- 4 - SEWER LINE
- 5 - WATER TANK
- 6 - FREEZER
- 7 - STORAGE
- 8 - GENERATOR
- 9 - FUEL
- 10 - TRANSFORMER

LINE TABLE		
LINE	BEARING	LENGTH
L1	N27°57'16"W	16.26'
L2	N49°11'44"E	51.46'
L3	N80°22'43"E	48.59'
L4	N59°28'56"E	51.47'
L5	N67°15'33"E	14.72'
L6	N29°00'16"E	33.52'
L7	N62°19'07"E	20.05'
L8	N84°31'55"E	55.62'
L9	S44°29'57"W	44.43'
L10	S44°59'32"E	36.00'
L11	S06°21'53"W	78.59'
L12	S22°27'23"W	40.20'
L13	S71°23'03"W	43.21'
L14	S82°24'42"W	35.28'
L15	S61°54'26"W	19.97'
L16	S43°03'15"W	32.12'
L17	S20°30'14"W	29.38'
L18	S87°23'13"W	24.75'
L19	N73°42'34"W	25.52'
L20	S70°57'55"W	22.81'
L21	S86°07'41"W	37.74'
L22	N80°25'17"W	50.38'
L23	N73°06'42"W	36.42'
L24	N52°16'08"W	32.41'
L25	N39°00'42"W	17.63'
L26	N11°55'14"W	40.46'
L27	N18°28'45"E	45.51'
L28	N17°04'43"W	37.00'
L29	N30°52'06"W	61.83'
L30	N53°28'52"W	33.93'
L31	N86°53'28"W	34.09'

SWMP LEGEND:

CD - CHECK DAM
ECB - EROSION CONTROL BLANKET
LS - LEVEL SPREADER
SCE - STABILIZED CONSTRUCTION ENTRANCE
SedR - SEDIMENT RESERVOIR
SL - SLASH
ST - SEDIMENT TRAP
T - TERRACING
TB - TOE BERM
VB - VEGETATED BUFFER
W - WATTLE
- ECB INFILLED WITH FLEXTERA

Total Pit Capacity
W/2' of Freeboard
= 27,600 Bbls. ±
Total Pit Volume
= 6,770 Cu. Yds.

Section Line Sec. 6
Section Line Sec. 7

APPROXIMATE ACREAGES

APPROX. WELL DISTURBANCE = ±3.696 ACRES
ACCESS ROAD DISTURBANCE = ±1.273 ACRES
TOTAL = ±4.969 ACRES

UINTAH ENGINEERING & LAND SURVEYING

85 So. 200 East * Vernal, Utah 84078 * (435) 789-1017