

1" = 1200'

Scale in feet

1200 600 0 1200

END STONE
GLO
NAD 83 2711.26' N88°35'11"W

N39.487904°
W108.104042°

2663.24' S00°52'29"W

EXXON-MOBIL GM 541-34

WELL PAD GM 331-34
GRADED ELEVATION: 5597.50'

T6S, R96W

34

LS 27925
2 1/2" AC
NAD 83

N39.487933°
W108.094435°

2611.10' N88°19'19"W

1102' FNL

1168' FNL

1022' FEL

1163.28'
S85°02'37"E

2183' FEL

1912 BC
GLO
NAD 83

N39.487927°
W108.085184°

2638.98' N01°40'30"E

LS 16835
AC
NAD 83

N39.480682°
W108.085191°

2663.24' S00°52'29"W

1912 BC
GLO
NAD 83
N39.473281°
W108.103789°

S88°18'59"E 2598.90'

1912 BC
GLO
NAD 83
N39.473276°
W108.094583°

SHL GM 541-34 LAT./LONG. (NAD83)

N39°29'05.66663" (N39.484907°)
W108°05'34.52255" (W108.092923°)
CSP (NAD 83)
N=1611949.80
E=2268259.97

BHL GM 541-34 LAT./LONG. (NAD83)

N39°29'05.00032" (N39.484722°)
W108°05'19.70999" (W108.088808°)
CSP (NAD 83)
N=1611849.30
E=2269418.90



LEGEND

- FOUND MONUMENT
- CALCULATED MONUMENT
- ◆ WELL LOCATION
- BOTTOM HOLE
- SHL - SURFACE HOLE LOCATION
- BHL - BOTTOM HOLE LOCATION
- BC - BRASS CAP
- GLO - GENERAL LAND OFFICE SURVEY

NOTES:

- 1) GPS OPERATOR Kurt Shepherd OBSERVED A PDOP OF 2.021.
- 2) ALL GPS OBSERVATIONS ARE IN COMPLIANCE WITH COGCC RULE 215.
- 3) ALL DISTANCES ARE NAD83 COLORADO STATE PLANE, CENTRAL ZONE (SEA LEVEL).
- 4) THIS PLAT COMPLIES WITH COGCC RULE 303c.
- 5) NO VISIBLE IMPROVEMENTS WITHIN 400' OF WELL HEAD.
- 6) VEGETATION: SCRUB OAK, SAGE, NATIVE SHRUBS & GRASSES
- 7) BOTTOM HOLE LOCATION COORDINATES PROVIDED BY WILLIAMS PRODUCTION, RMT

BASIS OF BEARING/DATUM

A GPS OBSERVATION FROM NGS PID AJ3465 (FABER)

BASIS OF ELEVATION

A GPS OBSERVATION FROM NGS PID AJ3465 (FABER). SAID ELEVATION IS 5186.22'

DIMENSIONAL TIES

ALL DIMENSIONAL TIES TO SECTION LINES ARE MEASURED AT A 90° ANGLE TO THE SECTION LINE.

SURVEYORS CERTIFICATE:

This is to certify that this exhibit was prepared and location as shown was staked on the ground from actual surveys made by me or under my direct supervision.

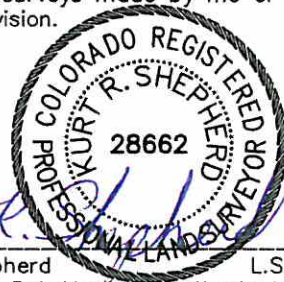

Kurt R. Shepherd L.S. 28662
On behalf of Del-Mont Consultants Inc.

DATE REVISED 2010-06-17

DEL-MONT CONSULTANTS IS PROVIDING GRADING DESIGN FOR THIS PROJECT THAT PROVIDES DIMENSIONS AND VOLUME INFORMATION FOR CONSTRUCTION.



DEL-MONT CONSULTANTS, INC.
ENGINEERING • SURVEYING • PLANNING
125 Colorado Ave. • Montrose, CO 81401 • (970) 249-2231 • (970) 249-2242 • www.delmont.com • service@delmont.com

NW1/4 NE1/4 S34, T6S, R96W, 6TH P.M.

WELL LOCATION PLAT
GM 541-34

WELL PAD GM 331-34

GARFIELD COUNTY, CO

WILLIAMS PRODUCTION, RMT

DMC JOB NO: 10030

DATE ISSUED 2008-12-10

DATE SURVEYED 2008-11-19

PLAT 1 of 9

DESIGNED BY	SCALE
MGW	1"=100'
CHECKED BY	FILE NAME
KS	10030-GM_331-34-SITE