

PETROLEUM DEVELOPMENT CORP.

CONSTRUCTION LAYOUT FOR

PUCKETT #22B2-1D, #22C-1D,
#22D-1D, #23C-1D & #23A-1D
SECTION 1, T7S, R97W, 6th
P.M. TRACT 63

60' 30' 0' 60'



SCALE

Sheet 2 of 9

SCALE: 1" = 60'

DATE: 11-09-09

Drawn By: K.G.

Revised: 01-29-10

Revised: 04-13-10

Revised: 06-01-10

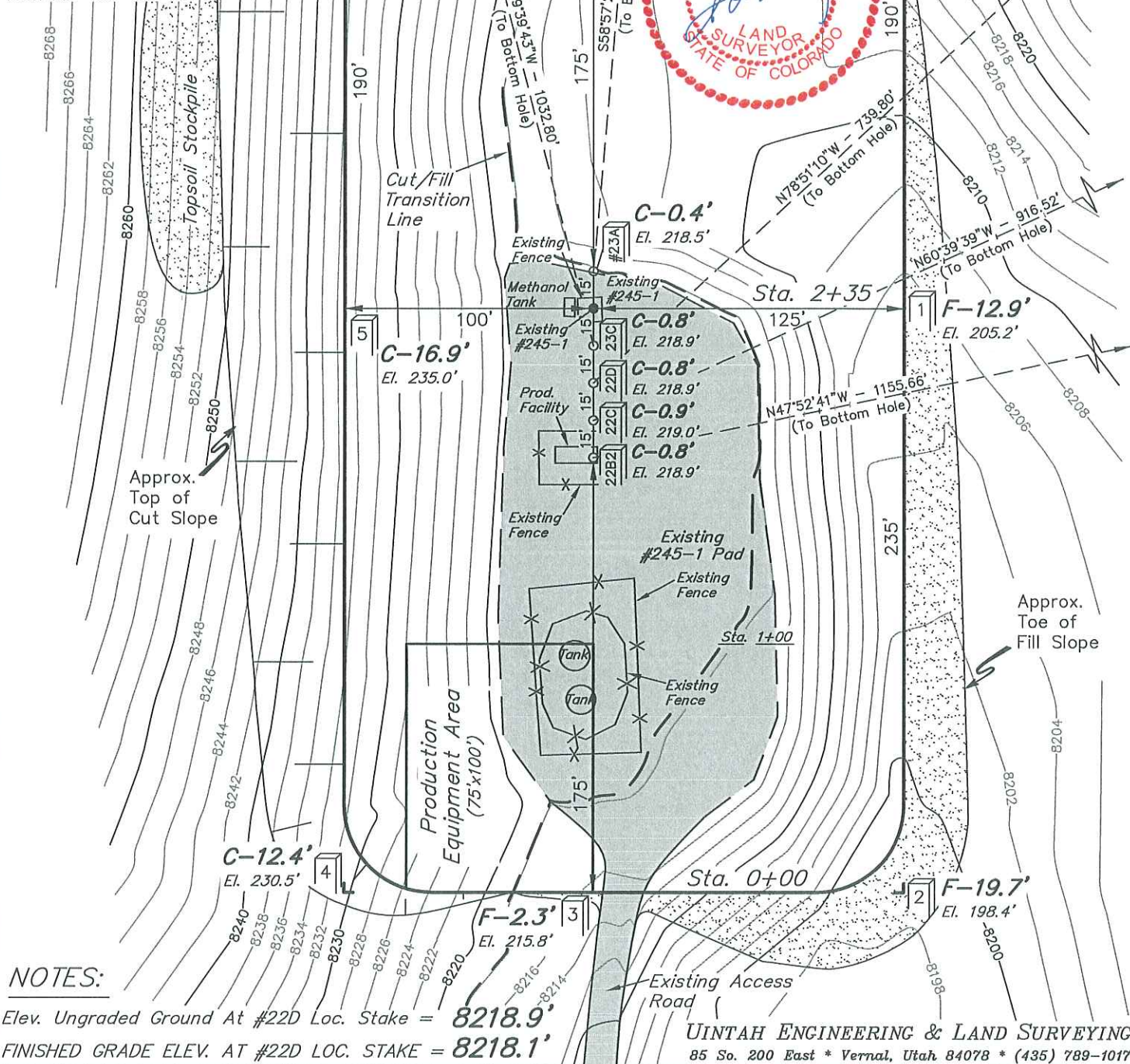

NOTES:

Elev. Ungraded Ground At #22D Loc. Stake = 8218.9'

FINISHED GRADE ELEV. AT #22D LOC. STAKE = 8218.1'

UINTAH ENGINEERING & LAND SURVEYING

85 So. 200 East * Vernal, Utah 84078 * (435) 789-1017

PETROLEUM DEVELOPMENT CORP.
CONSTRUCTION LAYOUT CROSS SECTIONS FOR

Sheet 3 of 9

PUCKETT #22B2-1D, #22C-1D,
#22D-1D, #23C-1D & #23A-1D
SECTION 1, T7S, R97W, 6th
P.M. TRACT 63

1" = 40'
X-Section
Scale
1" = 100'
DATE: 11-09-09
Drawn By: K.G.
Revised: 01-29-10
Revised: 04-13-10

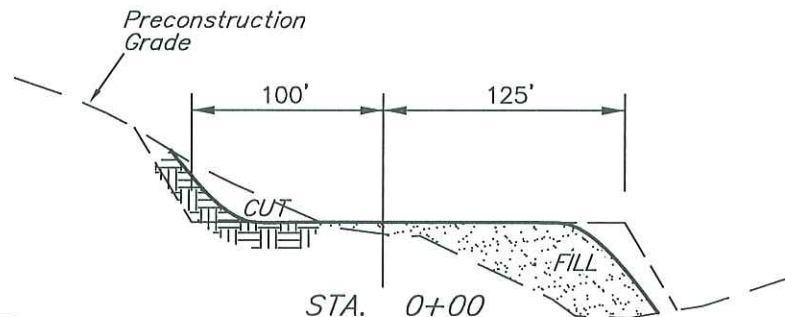
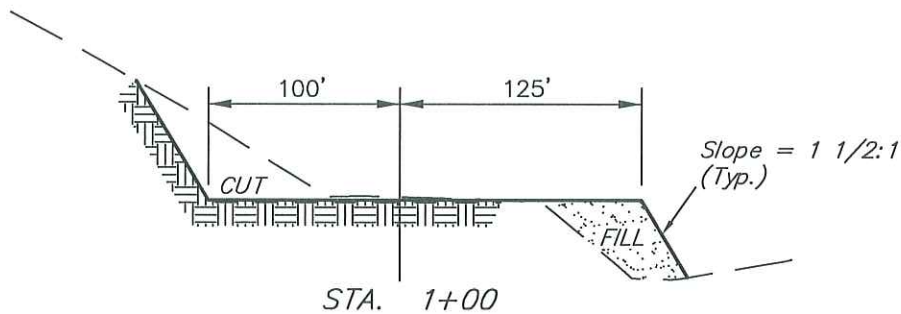
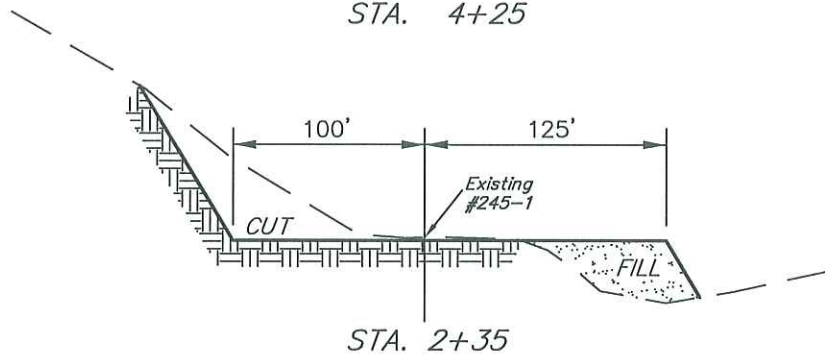
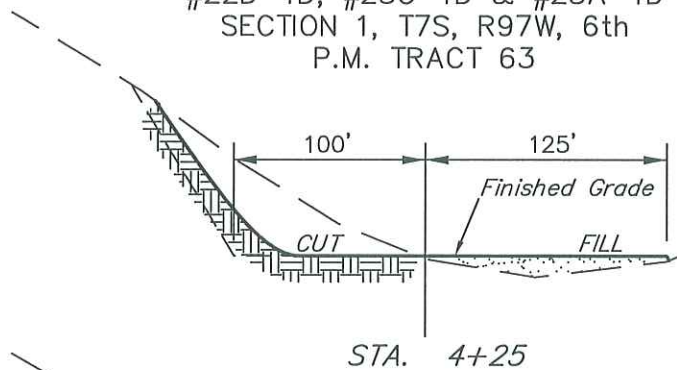

APPROXIMATE ACREAGES

EXISTING DISTURBANCE = ±0.501 ACRES
PROPOSED DISTURBANCE = ±2.510 ACRES
TOTAL = ±3.011 ACRES

APPROXIMATE YARDAGES

CUT
(6") Topsoil Stripping = 1,240 Cu. Yds.
(New Construction Only)
Remaining Location = 14,910 Cu. Yds.
TOTAL CUT = 16,150 CU.YDS.
FILL = 14,910 CU.YDS.

EXCESS MATERIAL = 1,240 Cu. Yds.
Topsoil = 1,240 Cu. Yds.
EXCESS UNBALANCE = 0 Cu. Yds.
(After Interim Rehabilitation)

* NOTE:
FILL QUANTITY INCLUDES
5% FOR COMPACTION

UINTAH ENGINEERING & LAND SURVEYING
85 So. 200 East * Vernal, Utah 84078 * (435) 789-1017