

## VISIBLE IMPROVEMENTS SKETCH COLEMAN C22-18D

SECTION 22, TOWNSHIP 4 NORTH, RANGE 64 WEST OF THE 6TH PRINCIPAL MERIDIAN

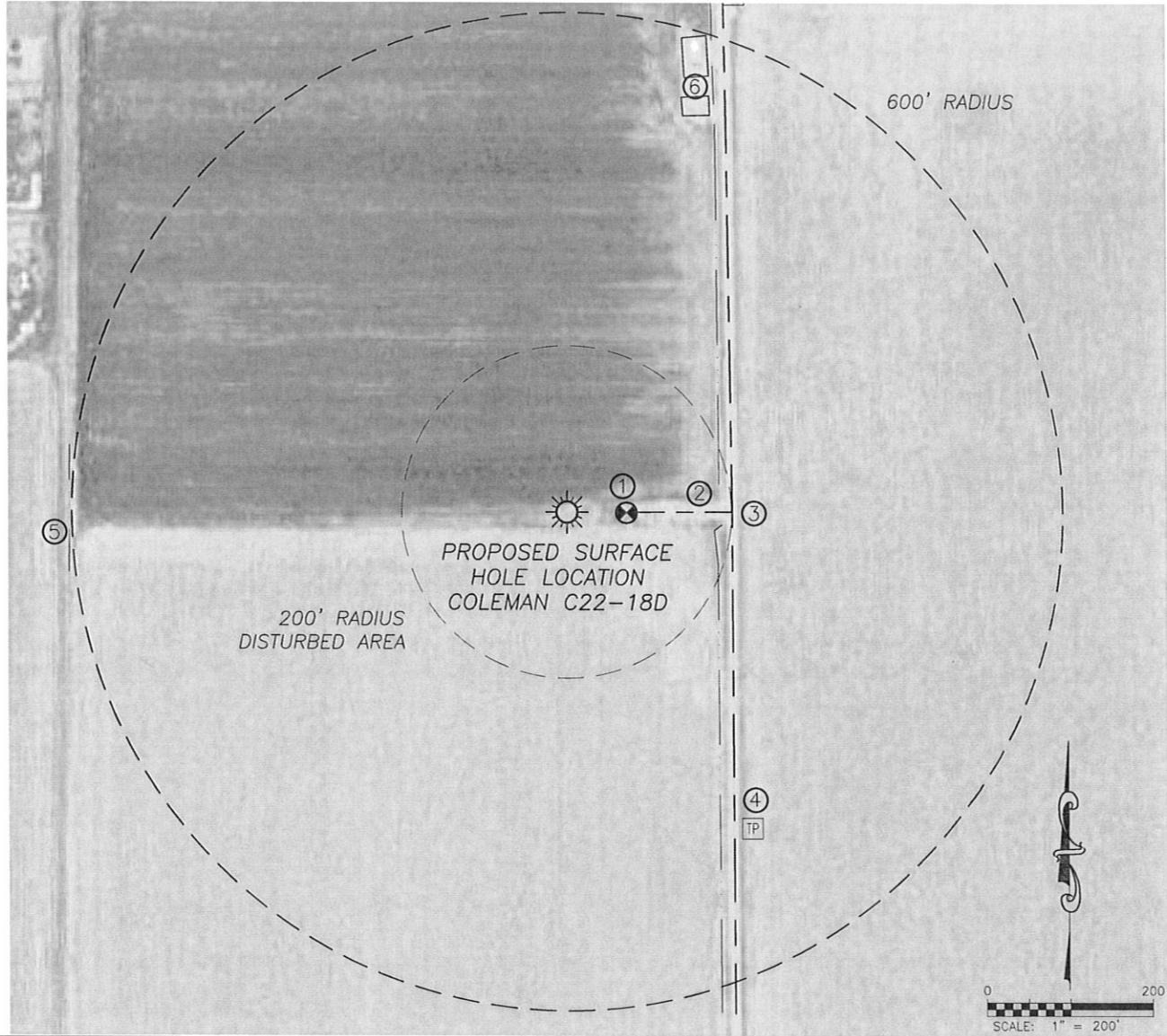

①

WELL:  
VOLKENS 31-22  
72'± E

②

IRRIG. DITCH  
180'± E

③

CENTERLINE  
FIELD ROAD  
200' E

④

TELE. PED  
435'± SE

⑤

IRRIG. DITCH  
600'± W

⑥

PROD. FACILITY  
520'± NE

NEAREST OVERHEAD POWER 690'± N