

# PRODUCTION FACILITY VISIBLE IMPROVEMENTS SKETCH CRICKET C22-30D

SECTION 21, TOWNSHIP 4 NORTH, RANGE 64 WEST OF THE 6TH PRINCIPAL MERIDIAN

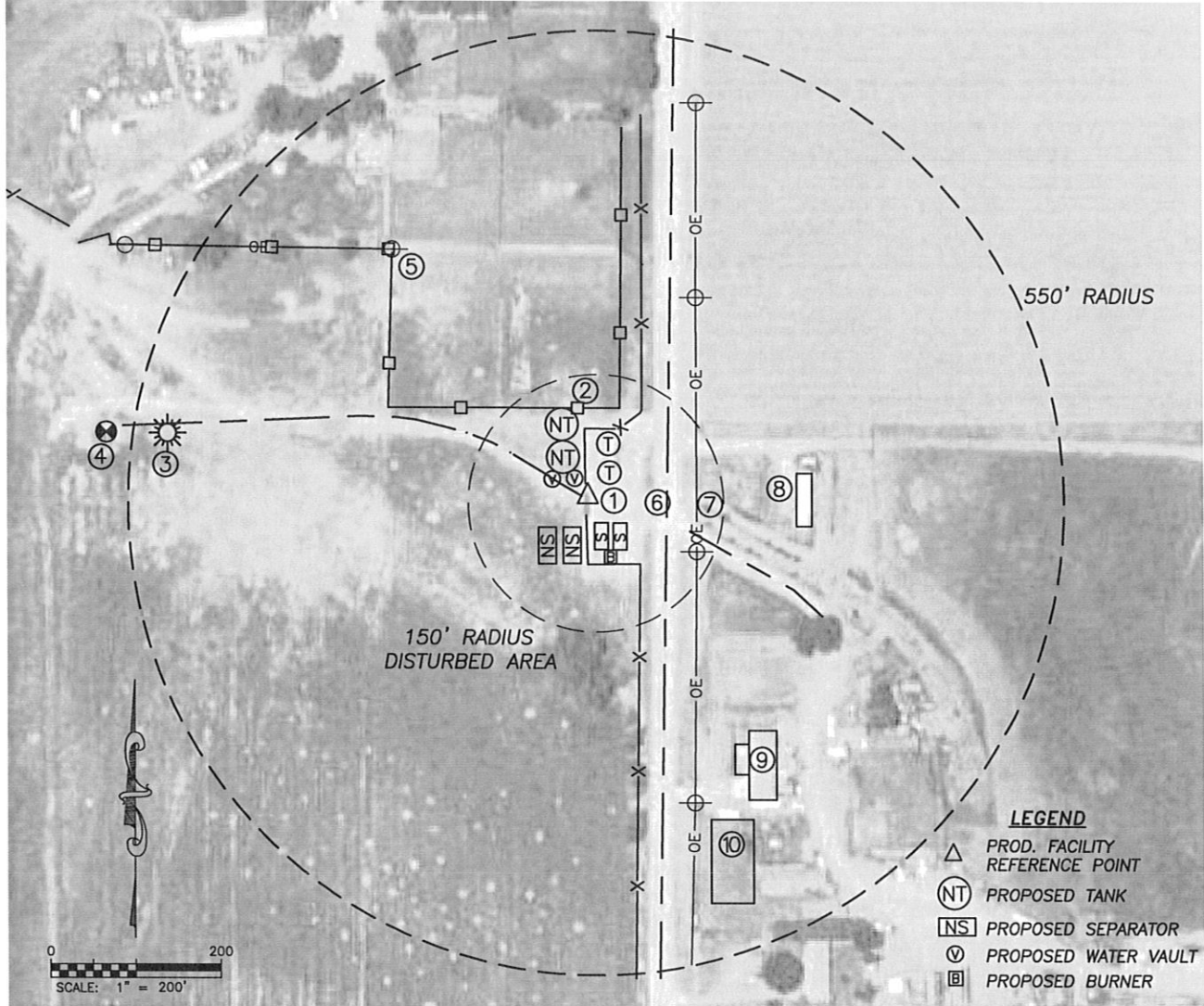

**REFERENCE POINT LOCATION:**  
 LATITUDE: N40.30297°  
 LONGITUDE: W104.54656°  
 PDOP. 1.4

NE4/NE4 SEC 21

**ASSOCIATED EXISTING WELLS:**  
 TRAVELERS 21-814  
 THOUTT 1

**ASSOCIATED NEW WELLS:**  
 CRICKET C22-30D  
 CRICKET C22-31D

- |  |   |  |  |
|--|---|--|--|
| ①<br><u>PROD. FACILITY</u><br>30'± NE & SE       | ②<br><u>WOOD FENCE</u><br>105'± N                 | ③<br><u>PROPOSED WELL</u><br><u>CRICKET C22-31D</u><br>500'± W | ④<br><u>WELL</u><br><u>THOUTT 1</u><br>572'± W |
| ⑤<br><u>OVERHEAD</u><br><u>POWER</u><br>365'± NW | ⑥<br><u>CENTERLINE</u><br><u>WCR 55</u><br>95'± E | ⑦<br><u>OVERHEAD</u><br><u>POWER</u><br>130'± E                | ⑧<br><u>TRAILER HOUSE</u><br>245'± E           |
| ⑨<br><u>BRICK HOUSE</u><br>335'± SE              | ⑩<br><u>STEEL BUILDING</u><br>405'± SE            |  |  |