

PRODUCTION FACILITY VISIBLE IMPROVEMENTS

SECTION: 22
TOWNSHIP: 7N
RANGE: 64W

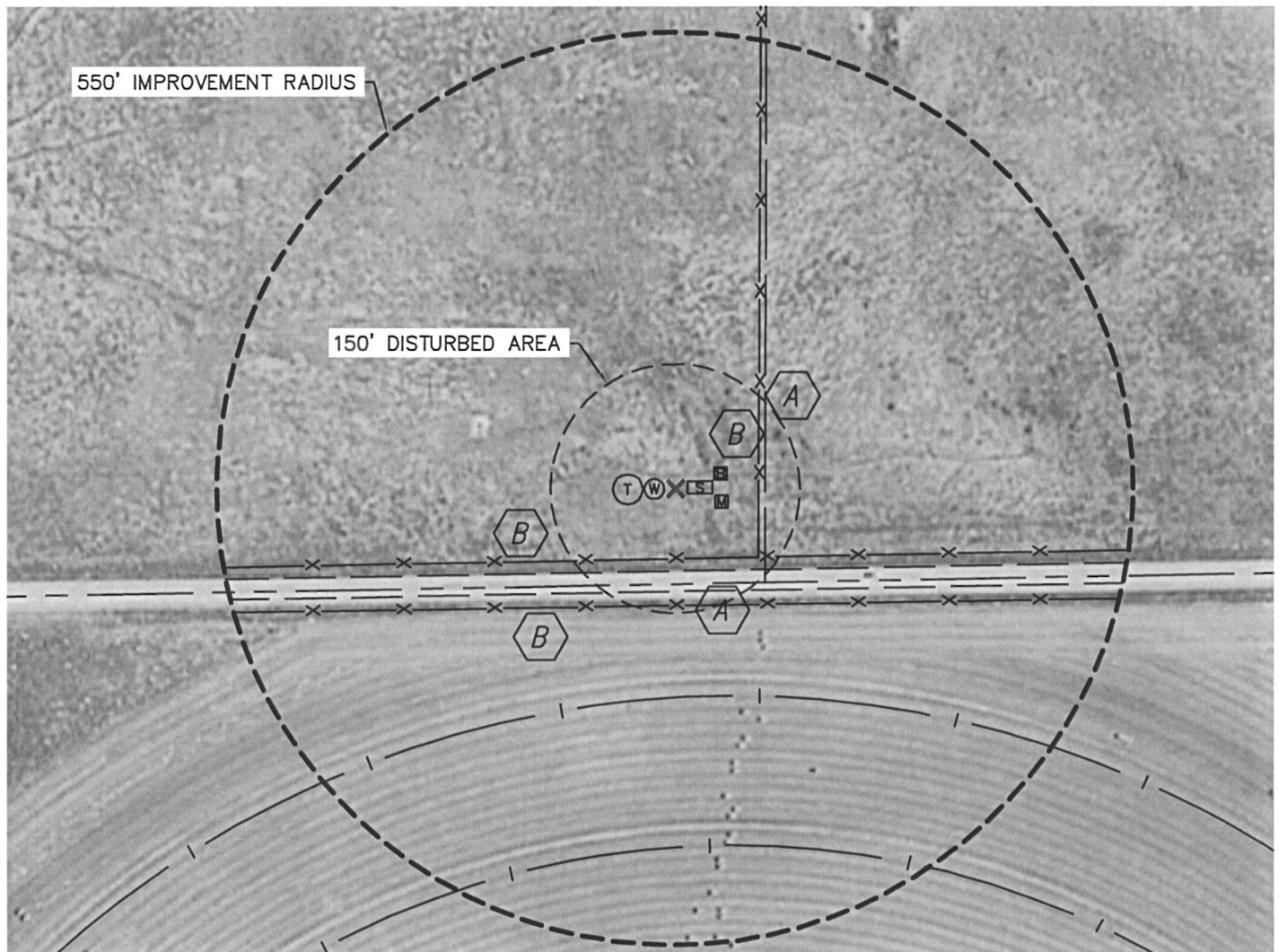

REFERENCE POINT LOCATION:

LATITUDE: 40.55181°N
LONGITUDE: 104.53135°W
PDOP: 2.0
DATE: 6-21-10
1/41/4: SW1/4SE1/4
FSL: 115'
FEL: 1423'
DISTANCE TO WELL: 1842'
ASSOCIATED NEW WELLS:
IRVINE PC AB22-10
ASSOCIATED EXISTING WELLS:
NONE

IMPROVEMENTS:

- A** PROPERTY LINE 108' E, 112' S
- B** FENCE 100' E, 85' S, 141' S
- C** COUNTY ROAD 78 99' S
- D** IRRIGATION PIVOT TRACK 251' S, 431' S

LEGEND

- X** - REFERENCE POINT
- T** - PROPOSED TANK
- W** - PROPOSED WATER VAULT
- LS** - PROPOSED SEPARATOR
- B** - PROPOSED BURNER
- M** - PROPOSED METER

ALL DISTANCES ARE APPROXIMATE.

