

PRODUCTION FACILITY VISIBLE IMPROVEMENTS

THIS MAP DOES NOT REPRESENT A BOUNDARY SURVEY

SECTION 17
TOWNSHIP 11 NORTH
RANGE 61 WEST

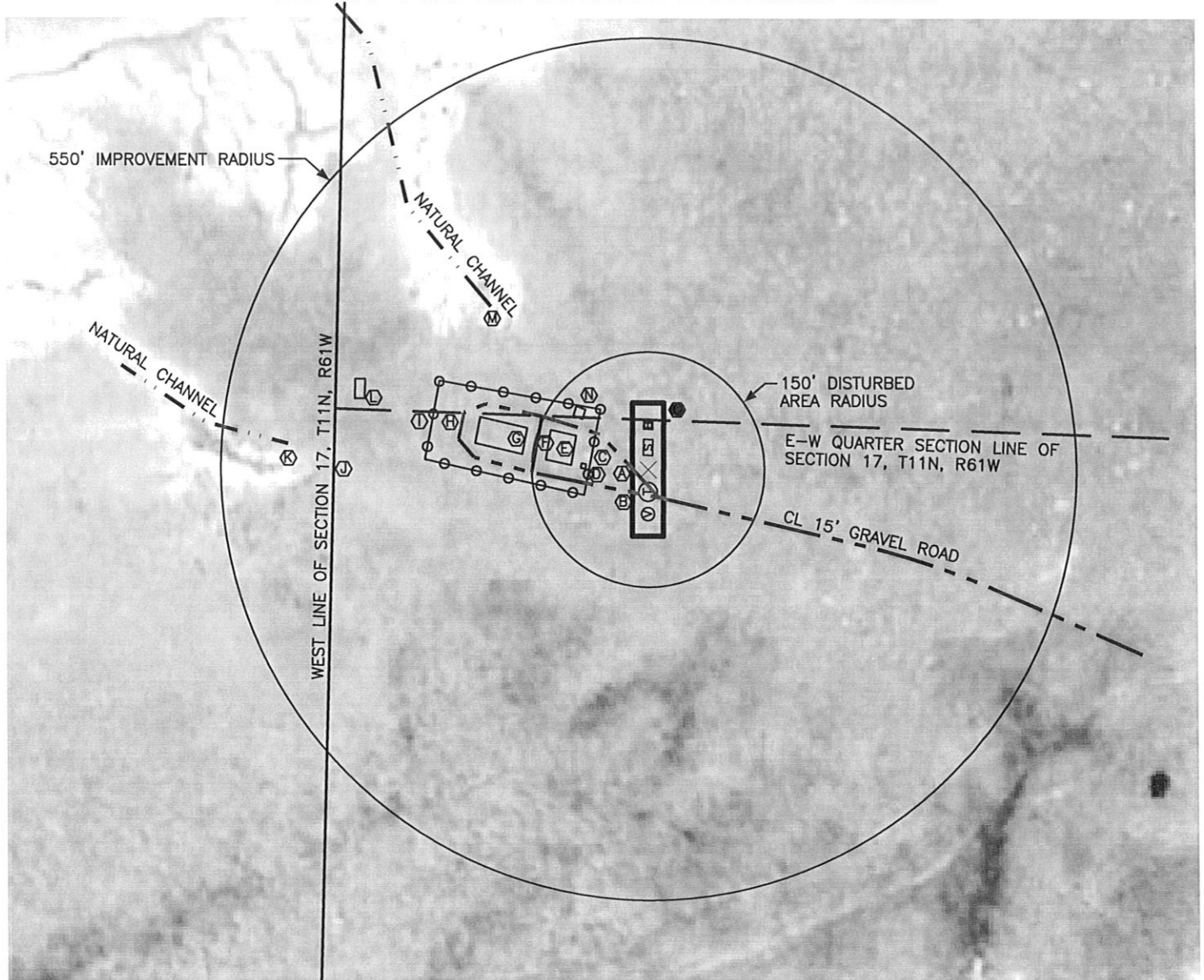

REFERENCE POINT LOCATION:
LATITUDE: 40.92160N
LONGITUDE: 104.23799W
PDOP: 3.2
DATE: 5/14/10
W1/2
FSL: 2565'
FWL: 405'
DISTANCE TO WELL: 2570' NE
ASSOCIATED NEW WELLS:
DF RANCH PC GK17-99HZ
ASSOCIATED EXISTING WELLS:
NONE

LEGEND:

- ✕ REFERENCE POINT
- ① PROPOSED TANK
- ⊙ PROPOSED WATER VAULT
- ▣ PROPOSED SEPARATOR
- PROPOSED BURNER

IMPROVEMENTS:

- Ⓐ CL 8' 2-TRACK DIRT TRAIL 14' SW
- Ⓑ CL 15' GRAVEL ROAD 32' SW
- Ⓒ CHAINLINK FENCE W/3-STRAND BARBED WIRE 75' NW
- Ⓓ CONCRETE BURNER PAD 80' NW
- Ⓔ SEPARATOR CONTAINMENT 99' NW
- Ⓕ CL 15' GRAVEL ROAD 147' NW
- Ⓖ TANK CONTAINMENT 163' NW
- Ⓗ CL 15' GRAVEL ROAD 251' NW
- Ⓘ CHAINLINK FENCE W/3-STRAND BARBED WIRE 285' NW
- Ⓢ PROPERTY LINE 405' WEST
- Ⓚ NATURAL CHANNEL 465' WEST
- Ⓛ FENCED VALVE AREA 376' NW
- Ⓜ NATURAL CHANNEL 290' NW
- Ⓝ FENCED VALVE AREA 106' NW

THE NEAREST OVERHEAD POWER LINE IS 5121' SOUTHEAST



SCALE: 1"=200'
0 100 200
SCALE IN FEET

ALL DISTANCES ARE APPROXIMATE