

Pit and Pad Layout for
Robert L. Bayless, Producer LLC
Weaver Ridge #13-9H
2075' FSL & 879' FEL
Sec.13, T1S, R104W, 6th PM
Rio Blanco Co., CO

Exhibit 5

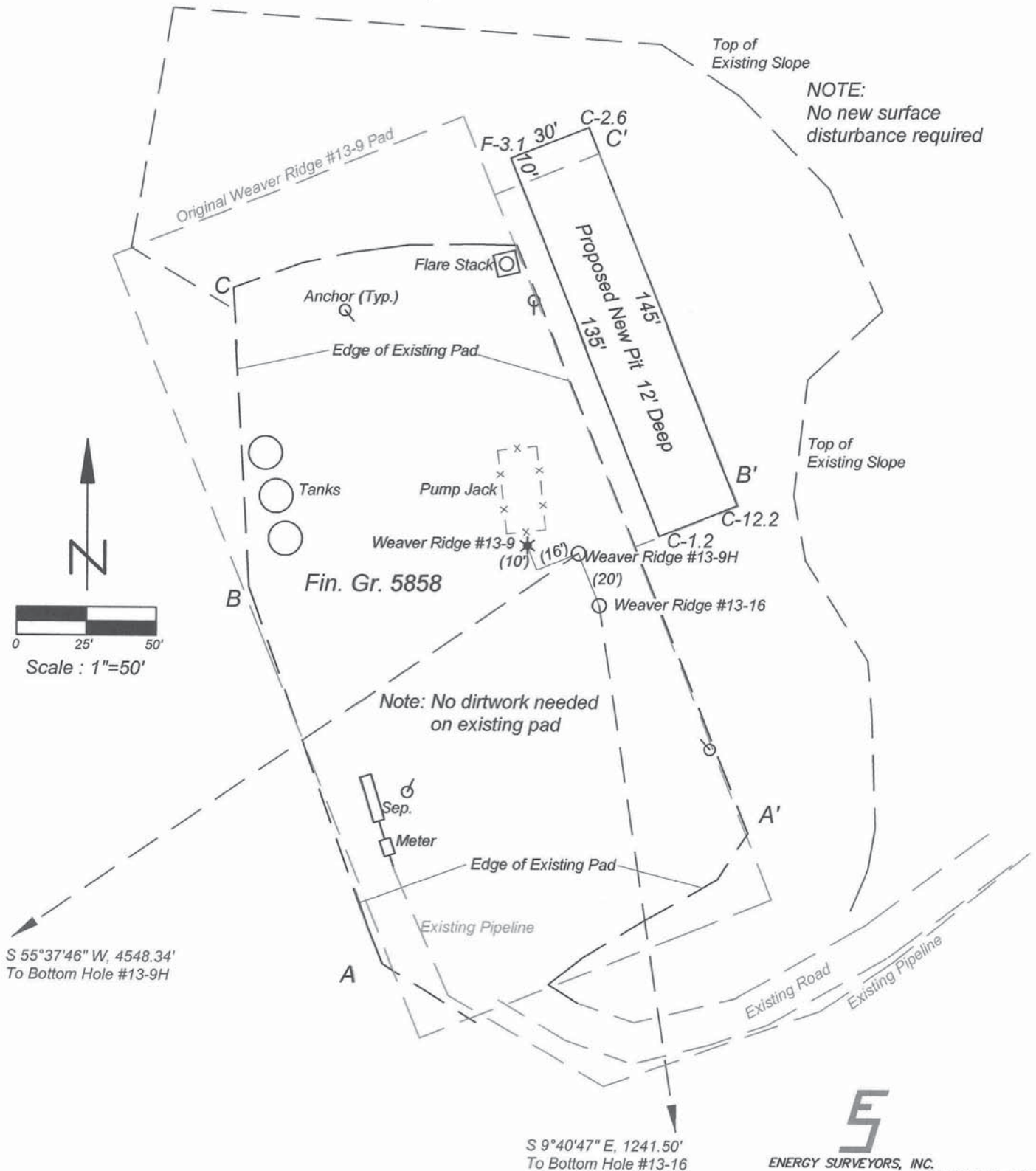

E
ENERGY SURVEYORS, INC.

P.O. BOX 991
FARMINGTON, NM 87499

FAX: 801-659-4246
OFFICE: 505-325-4005
CELL: 505-360-8142

Pit and Pad Layout for
Robert L. Bayless, Producer LLC
Weaver Ridge #13-9H
2075' FSL & 879' FEL
Sec. 13, T1S, R104W, 6th PM
Rio Blanco Co., CO

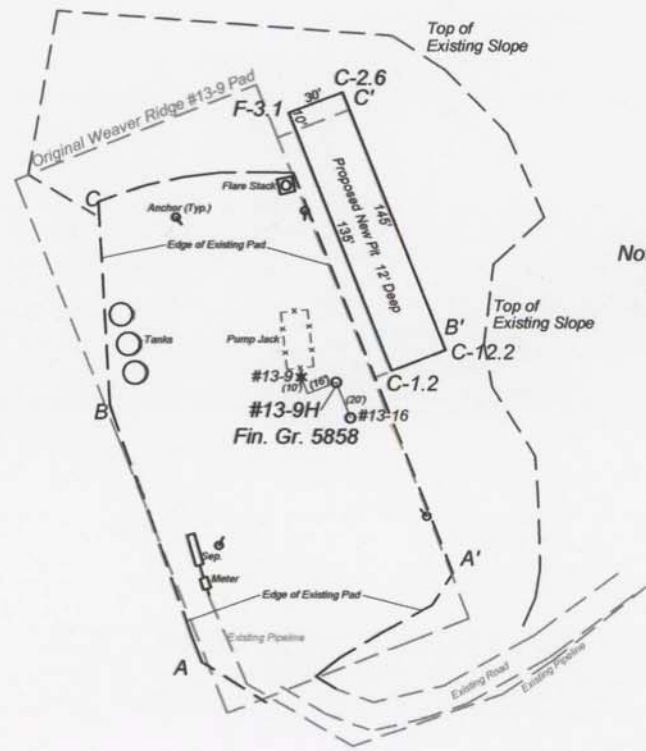
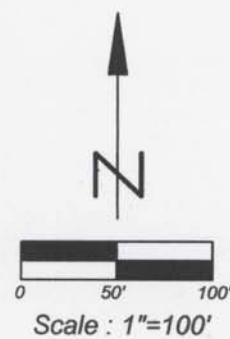

Note: Existing pad to be utilized as-is.
Pits to be cut with no new disturbance
outside of previous top of cut slope.

Cut: ± 684 CY
Fill: ± 27 CY
Pit Vol.: ± 1064 CY

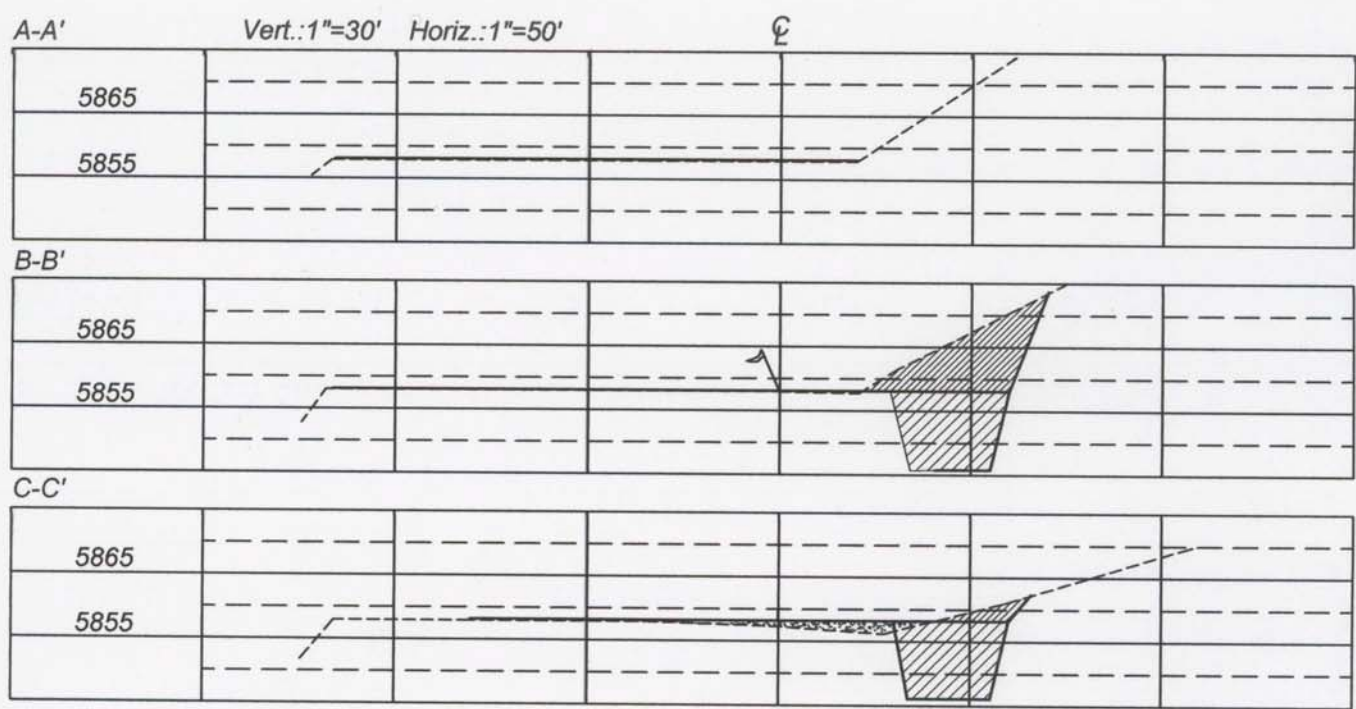

Proposed Layout for
Robert L. Bayless, Producer LLC
Weaver Ridge #13-9, 13-9H, & 13-16
NE/4 SE/4
Sec. 13, T1S, R104W, 6th PM
Rio Blanco Co., CO

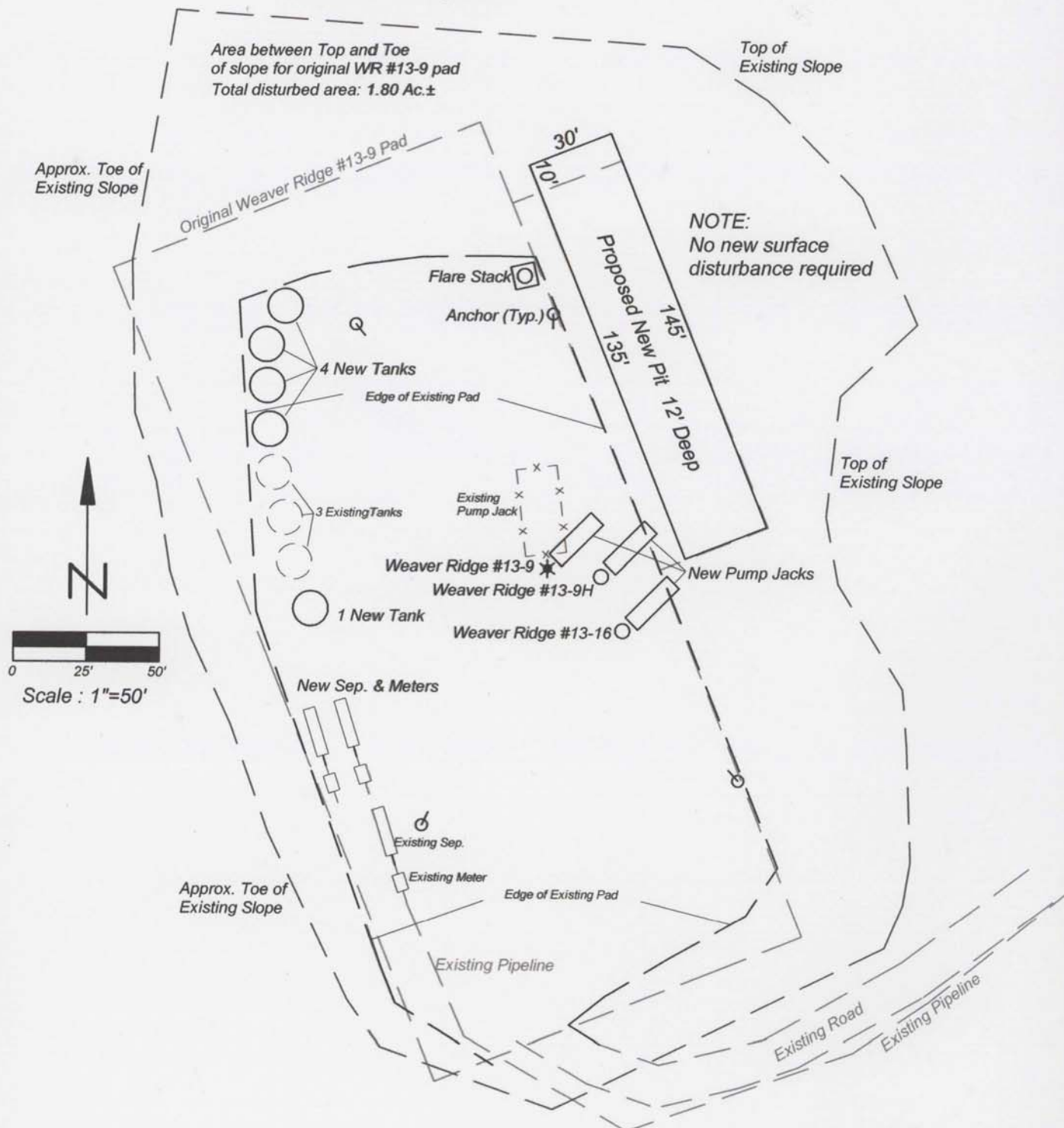

ENERGY SURVEYORS, INC.

P.O. BOX 991
 FARMINGTON, NM 87499

FAX: 801-659-4246
 OFFICE: 505-325-4005
 CELL: 505-360-8142

EXHIBIT 6

Drilling Rig Layout
Robert L. Bayless, Producer LLC
Weaver Ridge # 13-9 H

