

WELL DETAILS: 13-16

EXHIBIT 8

Ground Elevation: 5856.00
RKB Elevation: WELL @ 5867.00ft (11' KB Correction)
Rig Name: 11' KB Correction

+N/-S	+E/-W	Northing	Easting	Latitude	Longitude
0.00	0.00	1247664.167	2016301.324	39° 57' 35.172 N	109° 0' 36.468 W

SECTION DETAILS										
Sec	MD	Inc	Azi	TVD	+N/-S	+E/-W	DLeg	TFace	VSec	Target
1	0.00	0.00	0.00	0.00	0.00	0.00	0.00	0.00	0.00	
2	700.00	0.00	0.00	700.00	0.00	0.00	0.00	0.00	0.00	
3	1509.74	24.29	170.29	1485.69	-166.68	28.51	3.00	170.29	169.10	
4	3704.09	24.29	170.29	3485.76	-1056.49	180.71	0.00	0.00	1071.83	
5	4347.16	5.00	170.29	4105.00	-1216.00	208.00	3.00	180.00	1233.66	TGT Mancos B(13-16)
6	4513.83	0.00	0.00	4271.46	-1223.16	209.23	3.00	180.00	1240.93	
7	4669.37	0.00	0.00	4427.00	-1223.16	209.23	0.00	0.00	1240.93	BHL(WR13-16)

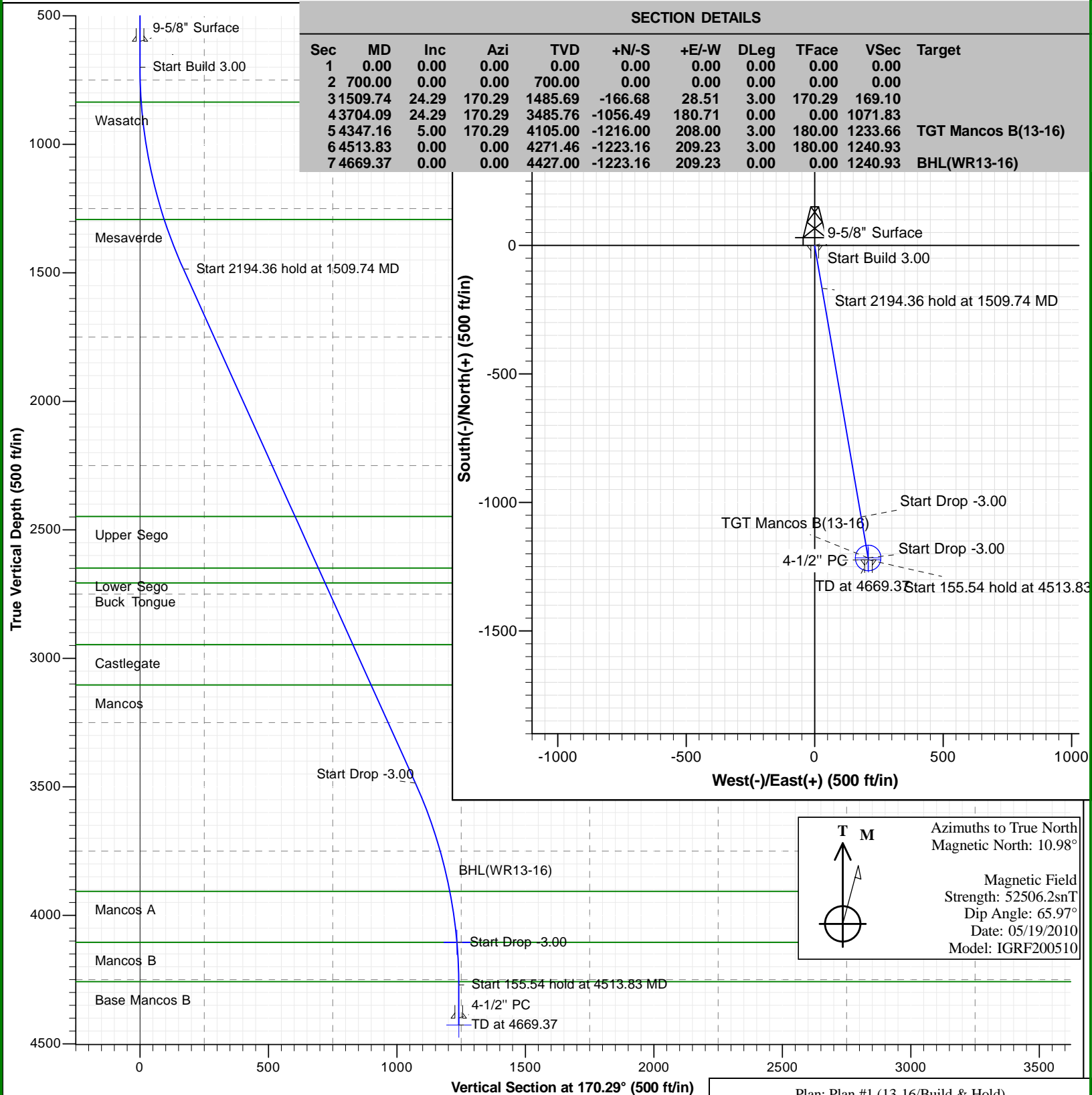

Robert L. Bayless, Producer LLC

Rio Blanco County
Weaver Ridge
13-16
Build & Hold

Plan: Plan #1

Pathfinder X & Y Planning Report

21 June, 2010



Pathfinder
Pathfinder X & Y Planning Report



Company:	Robert L. Bayless, Producer LLC	Local Co-ordinate Reference:	Well 13-16
Project:	Rio Blanco County	TVD Reference:	WELL @ 5867.00ft (11' KB Correction)
Site:	Weaver Ridge	MD Reference:	WELL @ 5867.00ft (11' KB Correction)
Well:	13-16	North Reference:	True
Wellbore:	Build & Hold	Survey Calculation Method:	Minimum Curvature
Design:	Plan #1	Database:	Midland Database

Project	Rio Blanco County		
Map System:	US State Plane 1983	System Datum:	Mean Sea Level
Geo Datum:	North American Datum 1983		
Map Zone:	Colorado Northern Zone		

Site	Weaver Ridge		
Site Position:		Northing:	1,247,664.167 ft
From:	Lat/Long	Easting:	2,016,301.324 ft
Position Uncertainty:	0.00 ft	Slot Radius:	"
		Latitude:	39° 57' 35.172 N
		Longitude:	109° 0' 36.468 W
		Grid Convergence:	-2.27 °

Well		13-16				
Well Position	+N-S	0.00 ft	Northing:	1,247,664.167 ft	Latitude:	39° 57' 35.172 N
	+E-W	0.00 ft	Easting:	2,016,301.324 ft	Longitude:	109° 0' 36.468 W
Position Uncertainty		0.00 ft	Wellhead Elevation:	ft	Ground Level:	5,856.00 ft

Wellbore	Build & Hold				
Magnetics	Model Name	Sample Date	Declination (°)	Dip Angle (°)	Field Strength (nT)
	IGRF200510	05/19/2010	10.98	65.97	52,506

Design		Plan #1		
Audit Notes:				
Version:	Phase:	PLAN	Tie On Depth:	0.00
Vertical Section:	Depth From (TVD) (ft)	+N/-S (ft)	+E/-W (ft)	Direction (°)
	0.00	0.00	0.00	170.29

Survey Tool Program		Date 06/21/2010			
From (ft)	To (ft)	Survey (Wellbore)	Tool Name	Description	
0.00	4,669.37	Plan #1 (Build & Hold)	MWD	MWD - Standard	

Pathfinder
Pathfinder X & Y Planning Report



Company:	Robert L. Bayless, Producer LLC	Local Co-ordinate Reference:	Well 13-16
Project:	Rio Blanco County	TVD Reference:	WELL @ 5867.00ft (11' KB Correction)
Site:	Weaver Ridge	MD Reference:	WELL @ 5867.00ft (11' KB Correction)
Well:	13-16	North Reference:	True
Wellbore:	Build & Hold	Survey Calculation Method:	Minimum Curvature
Design:	Plan #1	Database:	Midland Database

Planned Survey

MD (ft)	Inc (°)	Azi (°)	TVD (ft)	TVDSS (ft)	N/S (ft)	E/W (ft)	V. Sec (ft)	DLeg (°/100ft)	Northing (ft)	Easting (ft)
0.00	0.00	0.00	0.00	-5,867.00	0.00	0.00	0.00	0.00	1,247,664.17	2,016,301.32
100.00	0.00	0.00	100.00	-5,767.00	0.00	0.00	0.00	0.00	1,247,664.17	2,016,301.32
200.00	0.00	0.00	200.00	-5,667.00	0.00	0.00	0.00	0.00	1,247,664.17	2,016,301.32
300.00	0.00	0.00	300.00	-5,567.00	0.00	0.00	0.00	0.00	1,247,664.17	2,016,301.32
400.00	0.00	0.00	400.00	-5,467.00	0.00	0.00	0.00	0.00	1,247,664.17	2,016,301.32
500.00	0.00	0.00	500.00	-5,367.00	0.00	0.00	0.00	0.00	1,247,664.17	2,016,301.32
600.00	0.00	0.00	600.00	-5,267.00	0.00	0.00	0.00	0.00	1,247,664.17	2,016,301.32
700.00	0.00	0.00	700.00	-5,167.00	0.00	0.00	0.00	0.00	1,247,664.17	2,016,301.32
800.00	3.00	170.29	799.95	-5,067.05	-2.58	0.44	2.62	3.00	1,247,661.57	2,016,301.66
836.12	4.08	170.29	836.00	-5,031.00	-4.78	0.82	4.85	3.00	1,247,659.36	2,016,301.95
Wasatch										
900.00	6.00	170.29	899.63	-4,967.37	-10.31	1.76	10.46	3.00	1,247,653.79	2,016,302.68
1,000.00	9.00	170.29	998.77	-4,868.23	-23.18	3.96	23.51	3.00	1,247,640.85	2,016,304.37
1,100.00	12.00	170.29	1,097.08	-4,769.92	-41.14	7.04	41.74	3.00	1,247,622.78	2,016,306.73
1,200.00	15.00	170.29	1,194.31	-4,672.69	-64.15	10.97	65.08	3.00	1,247,599.64	2,016,309.75
1,300.00	18.00	170.29	1,290.18	-4,576.82	-92.14	15.76	93.48	3.00	1,247,571.48	2,016,313.43
1,302.97	18.09	170.29	1,293.00	-4,574.00	-93.04	15.92	94.39	3.00	1,247,570.57	2,016,313.55
Mesaverde										
1,400.00	21.00	170.29	1,384.43	-4,482.57	-125.04	21.39	126.85	3.00	1,247,538.38	2,016,317.75
1,509.74	24.29	170.29	1,485.69	-4,381.31	-166.68	28.51	169.10	3.00	1,247,496.49	2,016,323.22
1,600.00	24.29	170.29	1,567.97	-4,299.03	-203.28	34.77	206.23	0.00	1,247,459.67	2,016,328.02
1,700.00	24.29	170.29	1,659.11	-4,207.89	-243.83	41.71	247.37	0.00	1,247,418.88	2,016,333.35
1,800.00	24.29	170.29	1,750.26	-4,116.74	-284.38	48.64	288.51	0.00	1,247,378.09	2,016,338.68
1,900.00	24.29	170.29	1,841.40	-4,025.60	-324.93	55.58	329.65	0.00	1,247,337.29	2,016,344.00
2,000.00	24.29	170.29	1,932.55	-3,934.45	-365.48	62.52	370.79	0.00	1,247,296.50	2,016,349.33
2,100.00	24.29	170.29	2,023.70	-3,843.30	-406.03	69.45	411.93	0.00	1,247,255.71	2,016,354.65
2,200.00	24.29	170.29	2,114.84	-3,752.16	-446.58	76.39	453.07	0.00	1,247,214.92	2,016,359.98

Pathfinder
Pathfinder X & Y Planning Report



Company:	Robert L. Bayless, Producer LLC	Local Co-ordinate Reference:	Well 13-16
Project:	Rio Blanco County	TVD Reference:	WELL @ 5867.00ft (11' KB Correction)
Site:	Weaver Ridge	MD Reference:	WELL @ 5867.00ft (11' KB Correction)
Well:	13-16	North Reference:	True
Wellbore:	Build & Hold	Survey Calculation Method:	Minimum Curvature
Design:	Plan #1	Database:	Midland Database

Planned Survey

MD (ft)	Inc (°)	Azi (°)	TVD (ft)	TVDSS (ft)	N/S (ft)	E/W (ft)	V. Sec (ft)	DLeg (°/100ft)	Northing (ft)	Easting (ft)
2,300.00	24.29	170.29	2,205.99	-3,661.01	-487.13	83.32	494.20	0.00	1,247,174.12	2,016,365.31
2,400.00	24.29	170.29	2,297.13	-3,569.87	-527.68	90.26	535.34	0.00	1,247,133.33	2,016,370.63
2,500.00	24.29	170.29	2,388.28	-3,478.72	-568.23	97.20	576.48	0.00	1,247,092.54	2,016,375.96
2,565.52	24.29	170.29	2,448.00	-3,419.00	-594.80	101.74	603.44	0.00	1,247,065.81	2,016,379.45
Upper Sego										
2,600.00	24.29	170.29	2,479.43	-3,387.57	-608.78	104.13	617.62	0.00	1,247,051.74	2,016,381.28
2,700.00	24.29	170.29	2,570.57	-3,296.43	-649.33	111.07	658.76	0.00	1,247,010.95	2,016,386.61
2,786.05	24.29	170.29	2,649.00	-3,218.00	-684.22	117.04	694.16	0.00	1,246,975.85	2,016,391.19
Lower Sego										
2,800.00	24.29	170.29	2,661.72	-3,205.28	-689.88	118.01	699.90	0.00	1,246,970.16	2,016,391.94
2,849.68	24.29	170.29	2,707.00	-3,160.00	-710.02	121.45	720.34	0.00	1,246,949.89	2,016,394.58
Buck Tongue										
2,900.00	24.29	170.29	2,752.86	-3,114.14	-730.43	124.94	741.04	0.00	1,246,929.37	2,016,397.26
3,000.00	24.29	170.29	2,844.01	-3,022.99	-770.98	131.88	782.18	0.00	1,246,888.57	2,016,402.59
3,100.00	24.29	170.29	2,935.16	-2,931.84	-811.53	138.81	823.31	0.00	1,246,847.78	2,016,407.91
3,112.99	24.29	170.29	2,947.00	-2,920.00	-816.80	139.72	828.66	0.00	1,246,842.48	2,016,408.61
Castlegate										
3,200.00	24.29	170.29	3,026.30	-2,840.70	-852.08	145.75	864.45	0.00	1,246,806.99	2,016,413.24
3,285.25	24.29	170.29	3,104.00	-2,763.00	-886.64	151.66	899.52	0.00	1,246,772.22	2,016,417.78
Mancos										
3,300.00	24.29	170.29	3,117.45	-2,749.55	-892.63	152.69	905.59	0.00	1,246,766.20	2,016,418.57
3,400.00	24.29	170.29	3,208.59	-2,658.41	-933.18	159.62	946.73	0.00	1,246,725.40	2,016,423.89
3,500.00	24.29	170.29	3,299.74	-2,567.26	-973.73	166.56	987.87	0.00	1,246,684.61	2,016,429.22
3,600.00	24.29	170.29	3,390.89	-2,476.11	-1,014.28	173.49	1,029.01	0.00	1,246,643.82	2,016,434.54
3,704.09	24.29	170.29	3,485.76	-2,381.24	-1,056.49	180.71	1,071.83	0.00	1,246,601.36	2,016,440.09
3,800.00	21.41	170.29	3,574.13	-2,292.87	-1,093.20	186.99	1,109.07	3.00	1,246,564.43	2,016,444.91
3,900.00	18.41	170.29	3,668.14	-2,198.86	-1,126.77	192.74	1,143.13	3.00	1,246,530.65	2,016,449.32
4,000.00	15.41	170.29	3,763.80	-2,103.20	-1,155.44	197.64	1,172.22	3.00	1,246,501.81	2,016,453.09

Pathfinder
Pathfinder X & Y Planning Report



Company:	Robert L. Bayless, Producer LLC	Local Co-ordinate Reference:	Well 13-16
Project:	Rio Blanco County	TVD Reference:	WELL @ 5867.00ft (11' KB Correction)
Site:	Weaver Ridge	MD Reference:	WELL @ 5867.00ft (11' KB Correction)
Well:	13-16	North Reference:	True
Wellbore:	Build & Hold	Survey Calculation Method:	Minimum Curvature
Design:	Plan #1	Database:	Midland Database

Planned Survey

MD (ft)	Inc (°)	Azi (°)	TVD (ft)	TVDSS (ft)	N/S (ft)	E/W (ft)	V. Sec (ft)	DLeg (°/100ft)	Northing (ft)	Easting (ft)
4,100.00	12.41	170.29	3,860.86	-2,006.14	-1,179.14	201.70	1,196.27	3.00	1,246,477.96	2,016,456.20
4,147.12	11.00	170.29	3,907.00	-1,960.00	-1,188.57	203.31	1,205.83	3.00	1,246,468.48	2,016,457.44
Mancos A										
4,200.00	9.41	170.29	3,959.04	-1,907.96	-1,197.81	204.89	1,215.20	3.00	1,246,459.19	2,016,458.65
4,300.00	6.41	170.29	4,058.07	-1,808.93	-1,211.38	207.21	1,228.97	3.00	1,246,445.54	2,016,460.43
4,347.16	5.00	170.29	4,105.00	-1,762.00	-1,216.00	208.00	1,233.66	3.00	1,246,440.89	2,016,461.04
Mancos B - TGT Mancos B(13-16)										
4,400.00	3.41	170.29	4,157.70	-1,709.30	-1,219.82	208.65	1,237.54	3.00	1,246,437.04	2,016,461.54
4,500.00	0.41	170.29	4,257.63	-1,609.37	-1,223.11	209.22	1,240.88	3.00	1,246,433.73	2,016,461.97
4,500.37	0.40	170.29	4,258.00	-1,609.00	-1,223.12	209.22	1,240.88	3.00	1,246,433.73	2,016,461.97
Base Mancos B										
4,513.83	0.00	0.00	4,271.46	-1,595.54	-1,223.16	209.23	1,240.93	3.00	1,246,433.68	2,016,461.98
4,600.00	0.00	0.00	4,357.63	-1,509.37	-1,223.16	209.23	1,240.93	0.00	1,246,433.68	2,016,461.98
4,669.37	0.00	0.00	4,427.00	-1,440.00	-1,223.16	209.23	1,240.93	0.00	1,246,433.68	2,016,461.98
BHL(WR13-16)										

Targets

Target Name - hit/miss target - Shape	Dip Angle (°)	Dip Dir. (°)	TVD (ft)	+N/-S (ft)	+E/-W (ft)	Northing (ft)	Easting (ft)	Latitude	Longitude
BHL(WR13-16) - plan hits target center - Point	0.00	0.00	4,427.00	-1,223.26	209.23	1,246,433.585	2,016,461.981	39° 57' 23.083 N	109° 0' 33.781 W
TGT Mancos B(13-16) - plan hits target center - Circle (radius 50.00)	0.00	0.00	4,105.00	-1,216.00	208.00	1,246,440.888	2,016,461.039	39° 57' 23.155 N	109° 0' 33.797 W

Pathfinder
Pathfinder X & Y Planning Report



Company:	Robert L. Bayless, Producer LLC	Local Co-ordinate Reference:	Well 13-16
Project:	Rio Blanco County	TVD Reference:	WELL @ 5867.00ft (11' KB Correction)
Site:	Weaver Ridge	MD Reference:	WELL @ 5867.00ft (11' KB Correction)
Well:	13-16	North Reference:	True
Wellbore:	Build & Hold	Survey Calculation Method:	Minimum Curvature
Design:	Plan #1	Database:	Midland Database

Casing Points

Measured Depth (ft)	Vertical Depth (ft)	Name	Casing Diameter (")	Hole Diameter (")
600.00	600.00	9-5/8" Surface	9-5/8	12-1/4
4,642.37	4,400.00	4-1/2" PC	4-1/2	8-3/4

Formations

Measured Depth (ft)	Vertical Depth (ft)	Name	Lithology	Dip (°)	Dip Direction (°)
4,347.16	4,105.00	Mancos B		0.00	
2,786.05	2,649.00	Lower Sego		0.00	
4,147.12	3,907.00	Mancos A		0.00	
3,112.99	2,947.00	Castlegate		0.00	
3,285.25	3,104.00	Mancos		0.00	
2,565.52	2,448.00	Upper Sego		0.00	
1,302.97	1,293.00	Mesaverde		0.00	
2,849.68	2,707.00	Buck Tongue		0.00	
836.12	836.00	Wasatch		0.00	
4,500.37	4,258.00	Base Mancos B		0.00	

Checked By: _____	Approved By: _____	Date: _____
-------------------	--------------------	-------------