

# LOCATION DRAWING

VEGETATION:  
NATIVE GRASSLAND  
SURFACE USE:  
RANGELAND

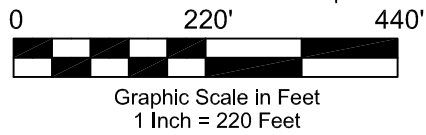

OUTLAW 16-11-66 WELLHEAD
LATITUDE: 40.91550°N
LONGITUDE: -104.77429°W
FOOTAGE: 605' FSL 605' FEL
GROUND ELEVATION: 5653.65'
PDOP: 1.3 DATE: 4/14/10
INSTRUMENT OPERATOR: JASON LEVANEN

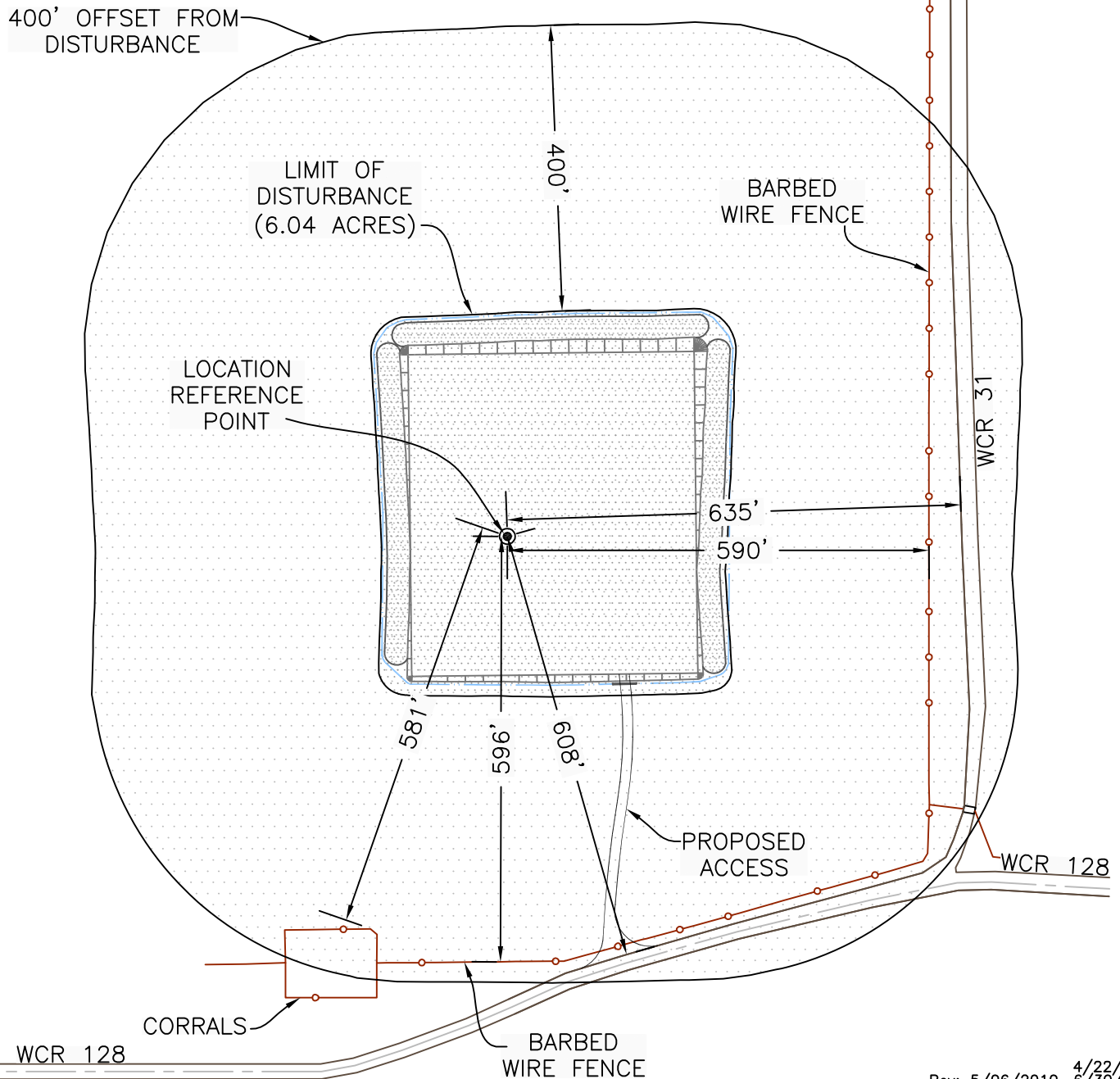

Rev: 5/06/2010, 4/22/2010  
6/30/2010

  
**WESTERN LAND SERVICES**  
Sheridan, WY 82801 (307)673-1817

**SLAWSON EXPLORATION COMPANY, INC**  
OUTLAW 16-11-66

SE1/4 SE1/4 SECTION 16, T11N R66W  
6TH PM, WELD COUNTY, COLORADO